

# TE series isolation transformer



## Model: TE8630

### Characteristics:

Sub-plate mount, Vacuum Epoxy Encapsulated, Crimping terminal output

### Technical Index:

Technical Index: PCB

Flame resistance : UL94-V0

Insulation class: B

Operation temperature: -30℃ ~ +40℃

Work frequency: 50Hz~60Hz

Dielectric strength: 3.5KV 50Hz 1min



### Technical Parameters table:

Primary voltage	110/220/230/380	V
Primary voltage range	± 10	%
Voltage regulation	≤10	%
Power	100	VA
Temperature rising	≤40	℃
No load loss	≤3.5	W
weight	1.8	Kg

次级输出电压		次级空载电压		次级满载电流	
单路	双路	单路	双路	单路	双路
6V	6V×2	6.7V	6.7V×2	16.66A	8.33A×2
7.5V	7.5V×2	8.4V	8.4V×2	13.33A	6.66A×2
9V	9V×2	10.2V	10.2V×2	11.11A	5.55A×2
12V	12V×2	13.5V	13.5V×2	8.33A	4.165A×2
15V	15V×2	16.9V	16.9V×2	6.66A	3.33A×2
18V	18V×2	20.3V	20.3V×2	5.55A	2.775A×2
24V	24V×2	27.1V	27.1V×2	4.16A	2.08A×2

### Schematic Diagram:

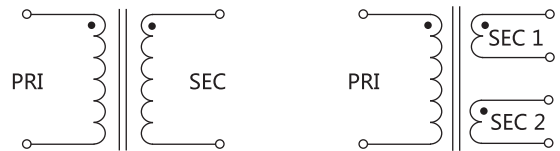

Single output

Double output

### Dimensions (in mm) ±0.5mm:

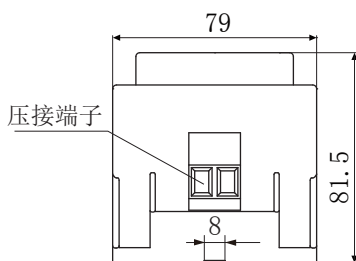

Front view

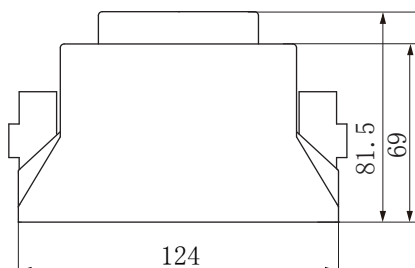

Side view

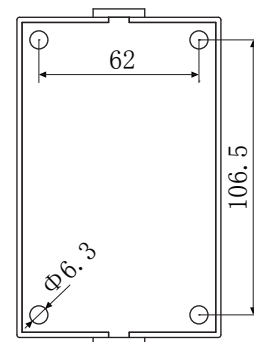

Top View