

Model: TE7640

Characteristics:

Sub-plate mount, Vacuum Epoxy Encapsulated, Crimping terminal output



Technical Index:

Technical Index: PCB

Flame resistance : UL94-V0

Insulation class: B

Operation temperature: $-30^{\circ}\text{C} \sim +40^{\circ}\text{C}$

Work frequency: 50Hz~60Hz

Dielectric strength: 3.5KV 50Hz 1min

Technical Parameters table:

Primary voltage	110/220/230/380	V
Primary voltage range	± 10	%
Voltage regulation	≤ 10	%
Power	100	VA
Temperature rising	≤ 40	$^{\circ}\text{C}$
No load loss	≤ 3	W
weight		g

Secondary output voltage		Secondary No-load Voltage		Secondary full load current	
Single	Double	Single	Double	single	Double
6V	6V×2	7.2V	7.2V×2	16.66A	8.33A
7.5V	7.5V×2	8.7V	8.7V×2	13.33A	6.66A
9V	9V×2	10.4V	10.4V×2	11.11A	5.55A
12V	12V×2	14.2V	14.2V×2	8.33A	4.165A
15V	15V×2	17.3V	17.3V×2	6.66A	3.33A
18V	18V×2	21.6V	21.6V×2	5.55A	2.775A
24V	24V×2	27V	27V×2	4.16A	2.08A

Schematic Diagram :

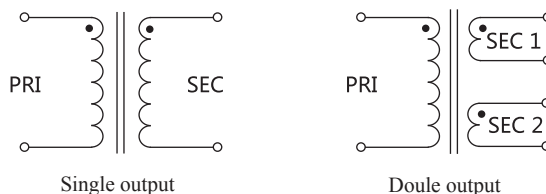

Dimensions (in mm) $\pm 0.5\text{mm}$

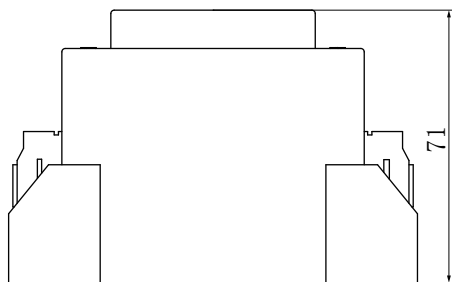

Front view

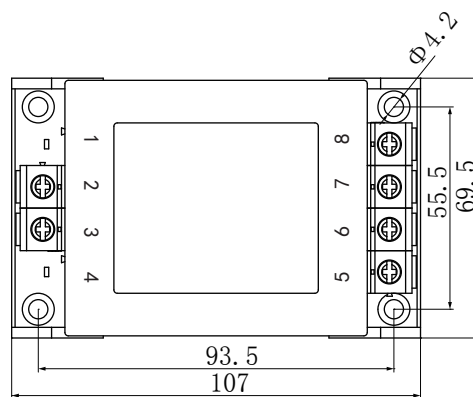

Vertical view