

Suspended type current transformer

Model:TA8420L

Characteristics:

Suspended mounting, high overload capacity. Electronics, electric power equipment current monitoring. Electric control system of current signal input. Phase loss monitoring. Monitoring the motor working condition.

Technical index:

Material of the core: Silicon steel sheet

Flame resistance: UL94-V0

Execution standard: GB1208-2006

Operating temperature: -20℃~+75℃

Storage temperature: -30℃~+80℃

Frequency range: 50Hz~60Hz

Dielectric strength: 6KV 50Hz 1min

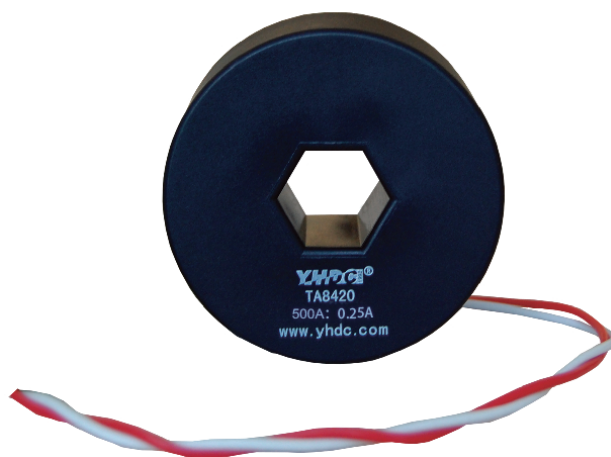

Electrical parameters:

Rated input	0-500	A
Max.input		A
Rated output	0-0.25	A
Turns ratio	1: 2000	
Accuracy	±1	%
Linearity	0.5	%
Phase difference		
max: Max. sampling resistance	100	Ω
Weight		g

Schematic diagram:

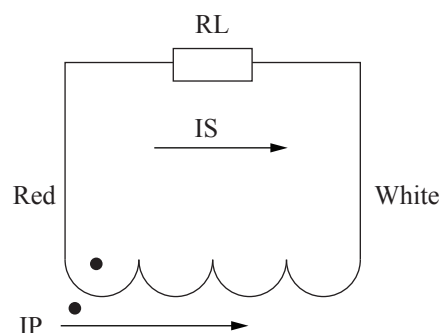

0.3 was red, white and soft line, lead to 40 cm

Dimensions (in mm) :

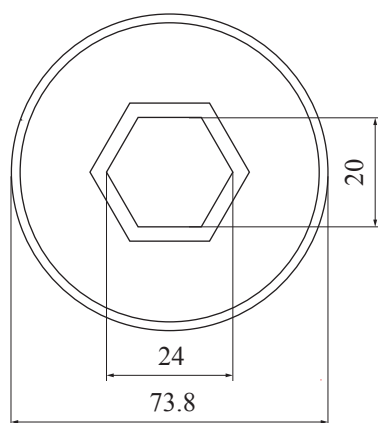

Front view

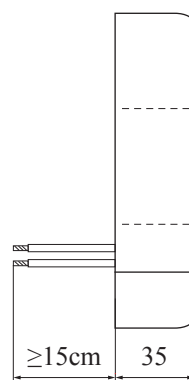

Side view