

# TA16E Primary core built-in type current transformer



## Characteristics:

Epoxy potting, permalloy core, small size, fully enclosed, electrical load remote monitoring, as the input signal of the electronic control system, phase loss indication, electricity measurement, motor running state monitoring.

## Technical index:

- Mounting type: PCB
- Material of the core: Permalloy
- Flame resistance: UL94-V0
- Execution standard: GB20840-2014
- Operating temperature: -20°C ~ +70°C
- Storage temperature: -30°C ~ +80°C
- Frequency range: 20Hz-20KHz
- Dielectric strength: 2KV 50Hz 1min

Product picture : (the printed words are for reference only, subject to the actual product)



## Electrical parameters: ( The following parameters are typical values and actual values will be subject to product testing )

Model	TA16E-01	TA16E-02	TA16E-03	Unit
Rated input	5	5	0.1	A
Rated output	5	2.5	2.5	mA
Turns ratio	1: 1000	1: 2000	20: 800	
Linearity	≤0.1	≤0.1	≤0.1	%
sampling resistance	100	400	200	Ω
Weight	13			g

## Schematic diagram:

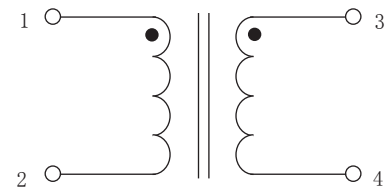

current output type.

the secondary is not allowed to open.

## Dimensions (in mm±0.5) :

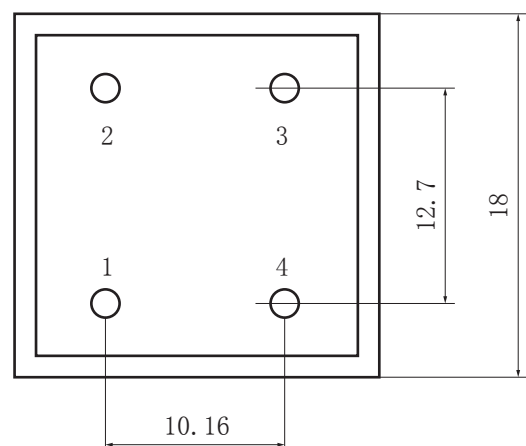
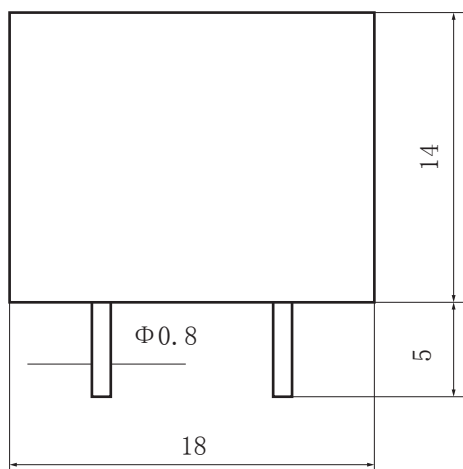

Bottom View