

TA16E Primary core built-in type current transformer



Characteristics:

Epoxy potting, permalloy core, small size, fully enclosed, electrical load remote monitoring, as the input signal of the electronic control system, phase loss indication, electricity measurement, motor running state monitoring.

Technical index:

- Mounting type: PCB
- Material of the core: Permalloy
- Flame resistance: UL94-V0
- Execution standard: GB20840-2014
- Operating temperature: -20°C~+70°C
- Storage temperature: -30°C~+80°C
- Frequency range: 20Hz-20KHz
- Dielectric strength: 2KV 50Hz 1min

Product picture : (the printed words are for reference only, subject to the actual product)



Electrical parameters: (The following parameters are typical values and actual values will be subject to product testing)

Model	TA16E-01	TA16E-02	TA16E-03	Unit
Rated input	5	5	0.1	A
Rated output	5	2.5	2.5	mA
Turns ratio	1: 1000	1: 2000	20: 800	
Linearity	≤0.1	≤0.1	≤0.1	%
sampling resistance	100	400	200	Ω
Weight	13			g

Schematic diagram:

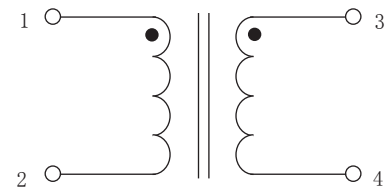

current output type.

the secondary is not allowed to open.

Dimensions (in mm±0.5) :

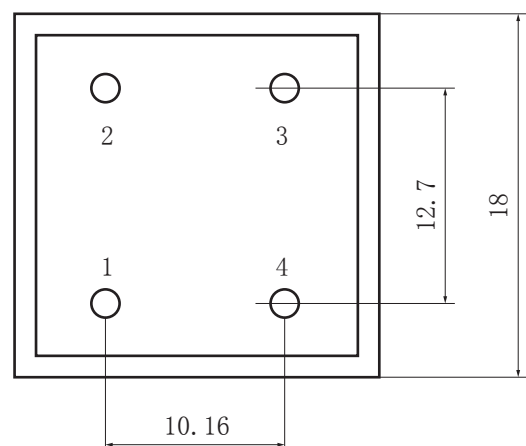
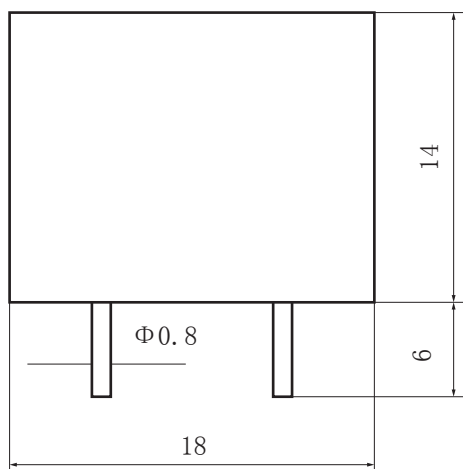

Bottom View