

Primary core built-in type current transformer



Model:TA16E-02

Characteristics:

primary coil built-in, PCB welding, Epoxy resin encapsulated, permalloy core.

Technical index:

- Mounting type: PCB
- Material of the core: Permalloy
- Flame resistance: UL94-V0
- Execution standard: GB1208-2006
- Operating temperature: -20°C ~ +75°C
- Storage temperature: -30°C ~ +80°C
- Frequency range: 20Hz-20KHz
- Dielectric strength: 2KV 50Hz 1min

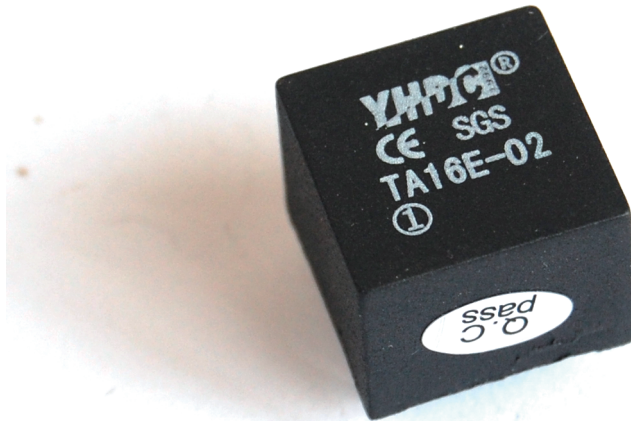

Electrical parameters:

Rated input	0-5	A
Max.input	18	A
Rated output	0-2.5	mA
Turns ratio	1: 2000	
Accuracy	±1	%
Linearity	≤0.1	%
Phase difference	≤30'	
max: Max. sampling resistance	400	Ω
Weight	13	g

Schematic diagram:

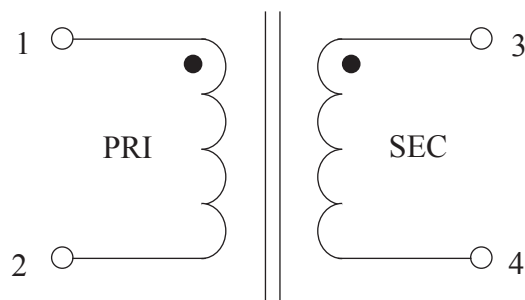

Dimensions (in mm) :

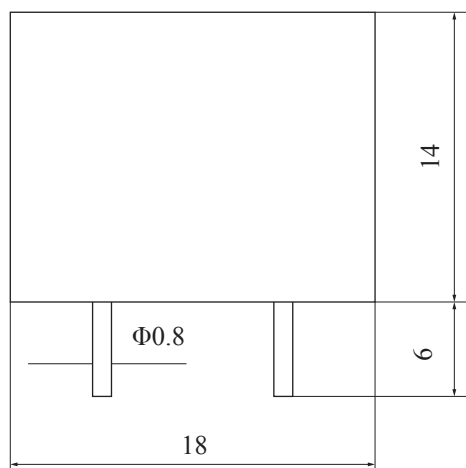

Front view

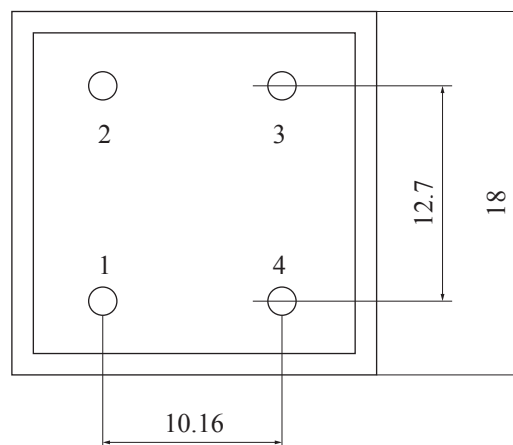

Bottom view