

Primary core built-in type current transformer



Model:TA16E-01

Characteristics:

primary coil built-in, PCB welding, Epoxy resin encapsulated, permalloy core.

Technical index:

Mounting type: PCB
Material of the core: Permalloy
Flame resistance: UL94-V0
Execution standard: GB1208-2006
Operating temperature: $-20^{\circ}\text{C} \sim +75^{\circ}\text{C}$
Storage temperature: $-30^{\circ}\text{C} \sim +80^{\circ}\text{C}$
Frequency range: 20Hz-20KHz
Dielectric strength: 2KV 50Hz 1min



Electrical parameters:

Rated input	0-5	A
Max.input	10	A
Rated output	0-5	mA
Turns ratio	1: 1000	
Accuracy	± 1	%
Linearity	≤ 0.1	%
Phase difference	$\leq 25'$	
max: Max. sampling resistance	100	Ω
Weight	13	g

Schematic diagram:

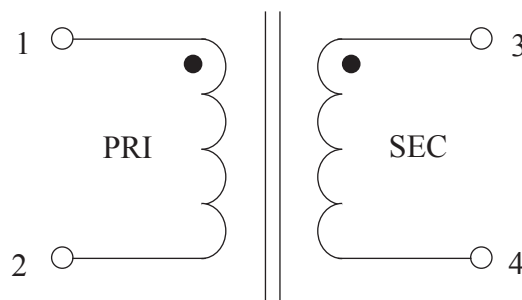

Dimensions (in mm) :

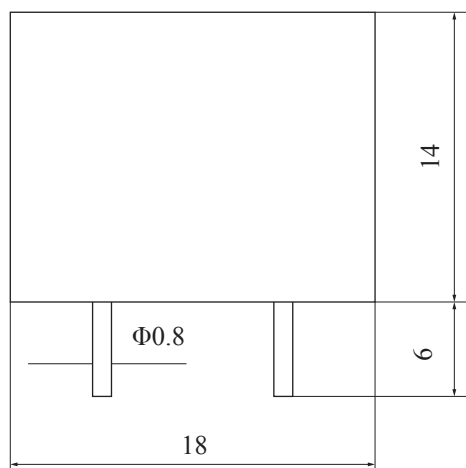

Front view

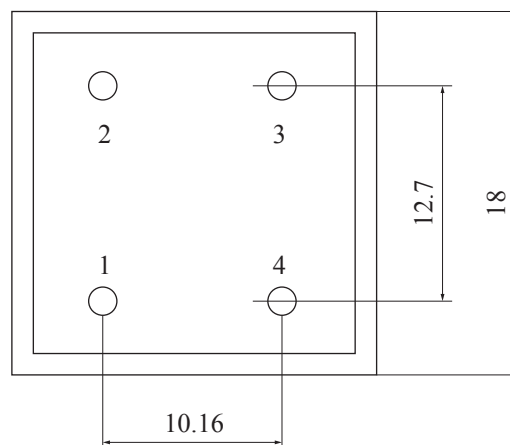

Bottom view