

TA1610FP Through core type precision current transformer **YHDC**® 1992

Characteristics:

Epoxy potting, silicon steel core, small size, fully enclosed, electrical load remote monitoring, as the input signal of the electronic control system, phase loss indication, electricity measurement, motor running state monitoring.

Technical index:

Mounting type: Plate installation
 Material of the core: Silicon steel sheet
 Flame resistance: UL94-V0
 Execution standard: GB20840-2014
 Operating temperature: $-20^{\circ}\text{C} \sim +70^{\circ}\text{C}$
 Storage temperature: $-30^{\circ}\text{C} \sim +80^{\circ}\text{C}$
 Frequency range: 50Hz-60Hz
 Dielectric strength: 3.5KV 50Hz 1min

Product picture : (the printed words are for reference only, subject to the actual product)



Electrical parameters: (The following parameters are typical values and actual values will be subject to product testing)

Model	TA1610FP	Unit
Rated input	80	A
Rated output	100	mA
Turns ratio	1: 800	
Linearity	≤ 0.5	%
Sampling resistance	50	Ω
Weight	12	g

Schematic diagram:

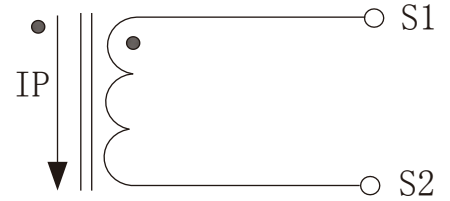

current output type.
 the secondary is not allowed to open.

Dimensions (in mm ± 0.5) :

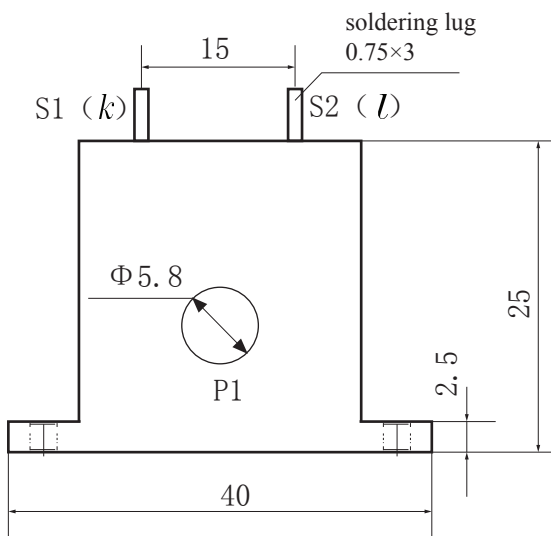

Front view

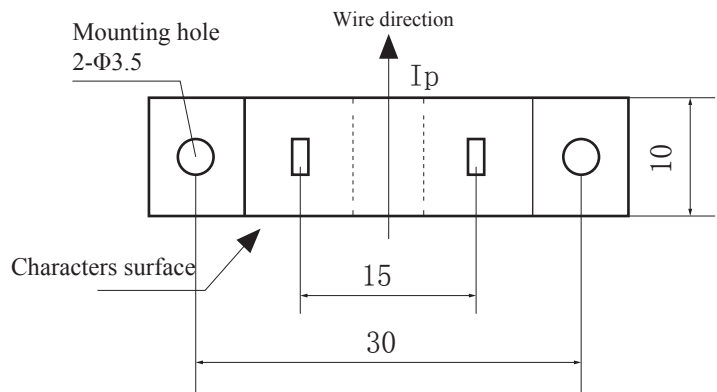

Top view