

KMG288 High Isolated Voltage SCR Trigger Transformer **YHDC** 1992

Characteristics:

Vacuum epoxy potting, High isolation voltage, used for the main circuit voltage above 660V.

Technical Index:

- Installation method: PCB
- Flame resistance : UL94-V0
- Operation temperature: -20℃ ~+50℃
- Storage temperature: -30℃ ~+85℃
- Work frequency: 1KHz~10KHz
- Dielectric strength: Pri/Sec 15KV 50Hz 1min

Electrical parameters: (The following parameters are typical values and actual values will be subject to product testing)

Project	Parameter	Model	KMG288-101	KMG288-201	KMG288-301	Unit
	Vout microsecond integral		800	1600	2400	μVs
	Input pulse amplitude		8	15	24	V
	Output pulse amplitude		≥6.2	≥6	≥6.8	V
	Turns ratio		1:1	2:1	3:1	
	Load resistance		7	7	7	Ω
	duty ratio		1:2	1:2	1:2	
	Pulse width		100	100	100	μs
	Leading edge time		3	3	3	μs
	Main circuit operating voltage		3	3	3	KV
	Weight		71	71	71	g

Product picture print for reference only, subject to the actual product



Schematic Diagram :

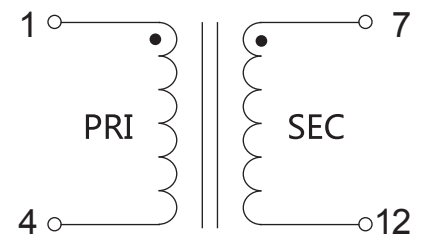

Dimensions (in mm±0.5) :

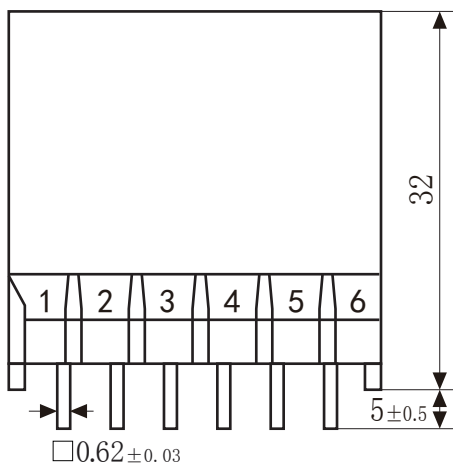

Front view

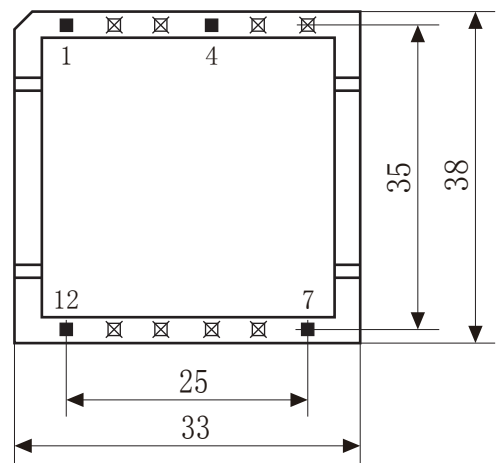

Bottom view