



USER GUIDE

The ONE Keyboard NEX



www.smartpiano.com





Parts List

Thanks for purchasing The ONE Keyboard NEX. First, please unpack the shipping carton and check all items carefully. If any item contained is damaged or missing, please contact <support@smartpiano.com>. Also, you may want to keep the packing materials in case you need to ship the unit in the future. The package should contain the following items:

- Piano Bobby

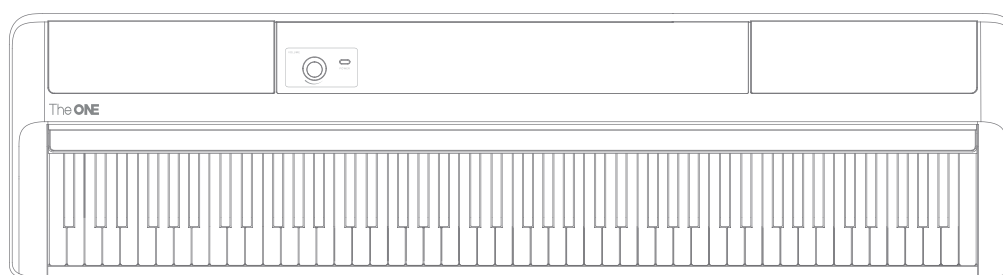

- Power Source
DC 15V

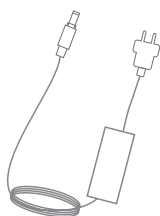

- User guide



- Music Stand Panel



- Cables

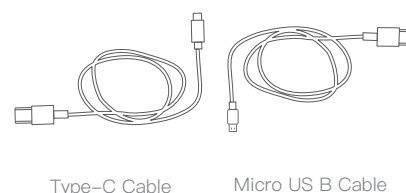

Type-C Cable

Micro US B Cable



Search "The ONE Smart Piano"
on App Store or Google Play

For more information please visit:
<https://www.smartpiano.com/pages/sheet-music>

Product Introduction

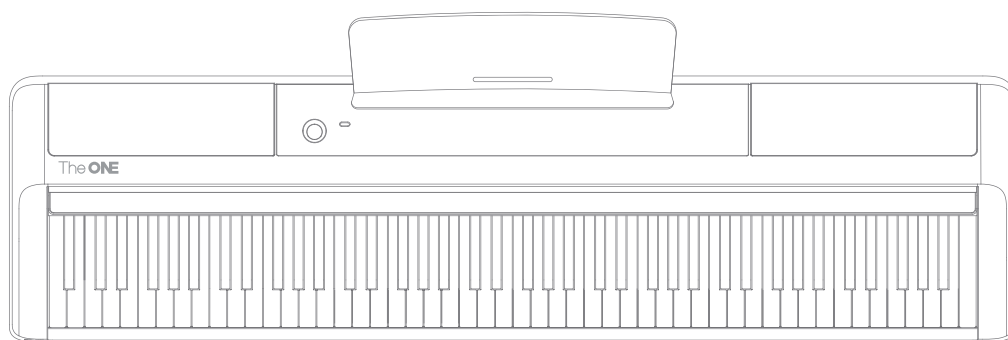

The ONE Keyboard NEX is an 88-key portable keyboard instrument that can teach you to play. It is designed for both beginners and experienced players. When you connect the keyboard with your mobile device, via Bluetooth or dedicated cables. you'll unlock additional features. Supported devices include Android5.0+ with USB Host / OTG or iOS 10+ is required, iPad 1 is not support.

Setup

This section contains information about setting up your instrument and preparing to play. Please read through this carefully before turning the power on.

Power Supply

Before turning the power on or off, please set the volume level of instrument and connected audio device to the minimum volume.

1. Connect the AC/DC power adaptor to the DC jack.
2. Plug the AC/DC power adaptor into an appropriate AC outlet (100V–240V) .
3. Press the [POWER] button. The indicator of volume knob is lighted indicating the instrument is powered on.
4. Press the [POWER] button again. The power will be turned off.

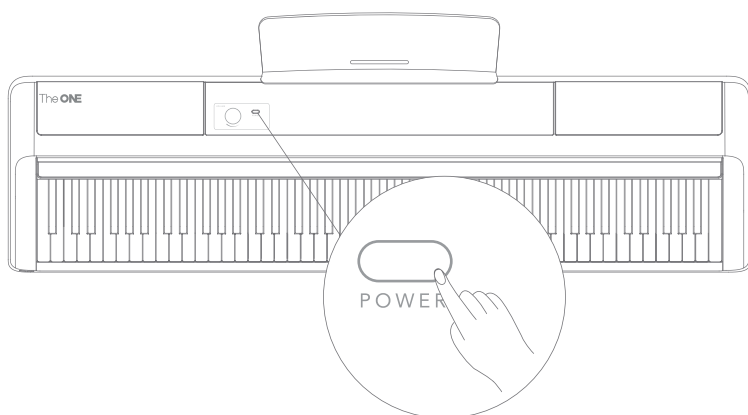
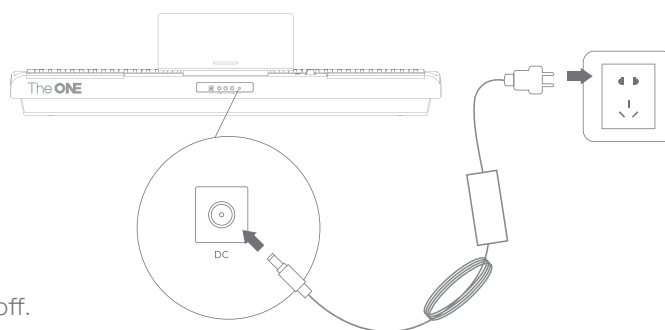

! Note:

For your safety, please unplug the instrument when it is not in use or during the thunderstorm.

Using the Music Stand

Simply insert the music stand panel into the slot on the keyboard. You can use this stand to place smart device or sheet music.

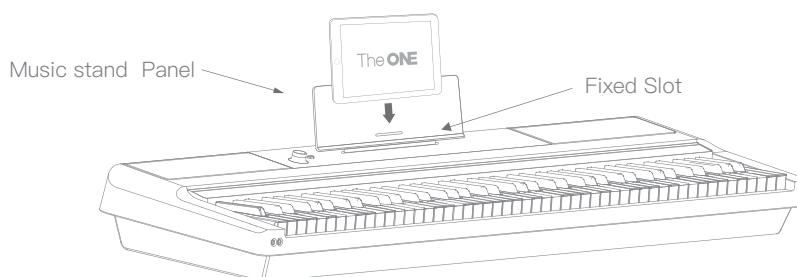

Panel Control

Main Panel

1 Master Volume/ Sound Selection Button.

Pressing the button can switch two modes:
Master Volume control and selection.

The initial state is Master Volume control.
Turn the knob to the right to increase and
to the left to decrease the Volume.

In the Sound selection mode, 88 timbres
can be switched by rotating the button.
The LED light corresponding to each timbre
on the keyboard will light up.

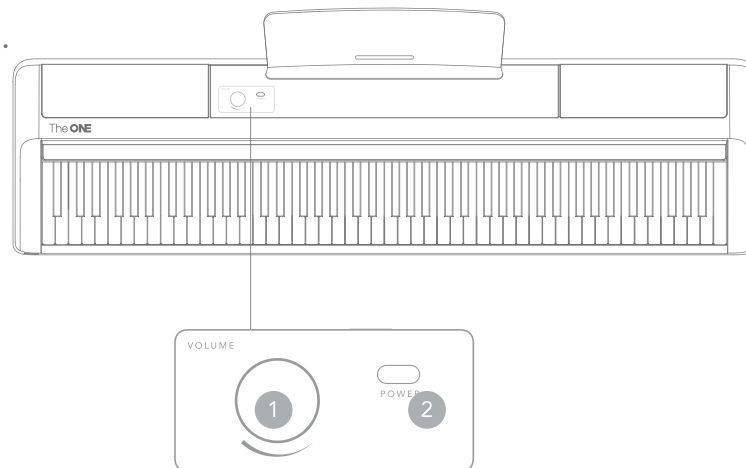

2 Power Button

Turn the power on or off. When the power
is on, the volume indicator will light up.

Rear panel

3 iOS/ Android Device Jack

iOS / Android smart devices can be connected
via dedicated cables.

4 Sustain Pedal Jack

Add the pedal effect by connecting to an external pedal.

5 6.35mm AUX OUT Jack

Connect to external audio output devices, to stream
audio from the keyboard.

6 6.35mm AUX IN Jack

Connect to external audio source, to play the audio
through the keyboard's speakers.

7 DC IN (15V)

Connect the DC 15V power.

8 Pedal Jack

Soft, sostenuto and sustain with half pedal can be used
by connecting pedals.

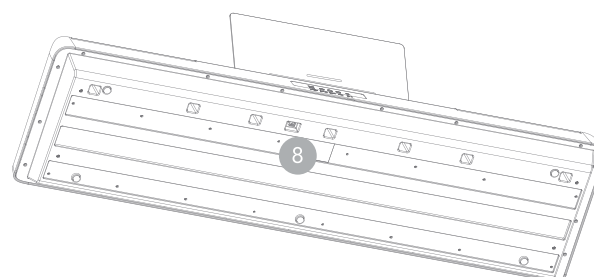
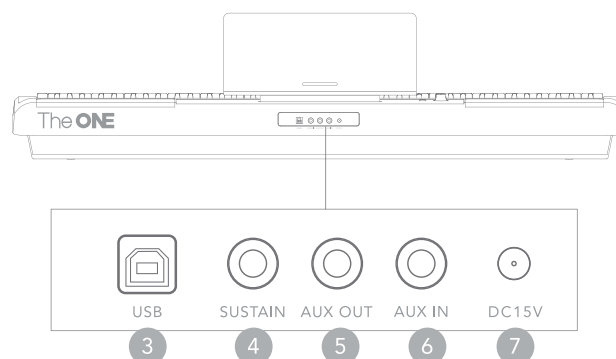

External Connectivity

Connecting the Smart Deices

To bring endless fun to music playing, we are integrating smart devices, entertainment, and music learning into The ONE Keyboard NEX. You can connect the keyboard with your mobile device, via Bluetooth or dedicated cables. Support devices which have Bluetooth 4.0+(Android 5.0+ with USB Host / OTG or iOS 10+ is required, iPad 1 is not support).

Two – way USB MIDI Data Transmission

Once The ONE Keyboard NEX is connected to your smart device, you can record sounds from your smart device. You can also use it as a speaker for your smart device to play stored MIDI files

USB Audio Playback

Use The ONE Keyboard NEX external speaker to stream music from your smart device by simply connecting it.

Download APP to get more functions

We created The ONE Smart Piano by The ONE to provide various additional features.

Method 1: Connection by cable Recommended for Android devices

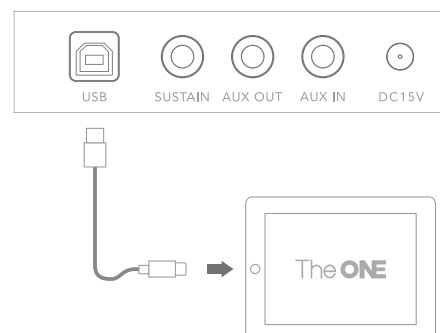

Method 2: Connection via Bluetooth Recommended for iOS devices

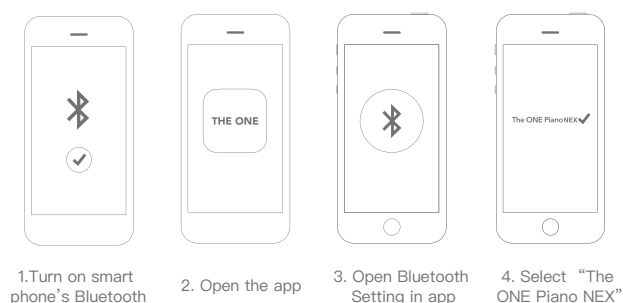

! Note:

Before connecting other devices, please make sure that all the power is off. And set all the volume level to them minimum volume before turning the power on.

Connecting Headphones

When you need to practice in silence, a pair of headphone can be plugged in as illustrated.

Once plugged in, the instrument sound can only be heard through the headphone instead of the speaker.

! Note:

1. Please avoid using the headphone in high volume for a long time, since it may cause the auditory fatigue, even permanent hearing loss.
2. The Headphone jack is standard 3.5mm size.

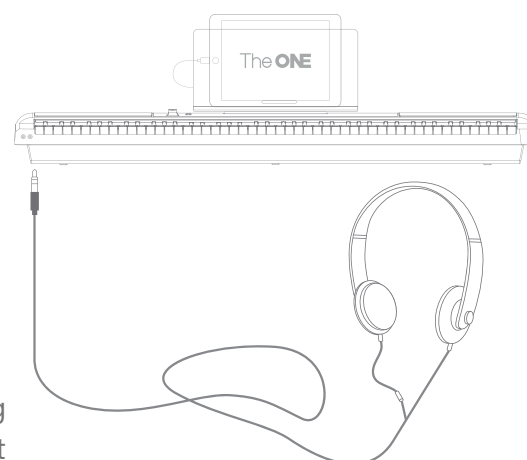

External Connectivity

Connecting to Audio Equipment

The keyboard amplifier, stereo sound system, mixing console, or other audio devices can be connected via 6.35mm AUX OUT jack.

! Note:

Before connecting other devices, please make sure that all the power is off. And set all the Volume level to the minimum volume before turning the power on.

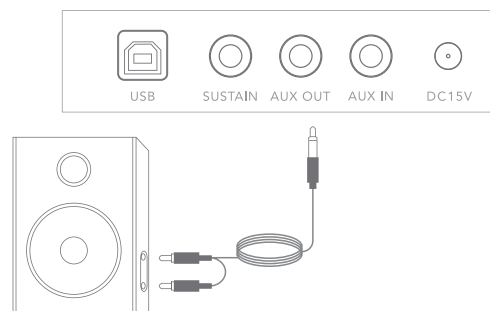

Connecting the MP3/CD Player

MP3/CD player or other audio source can be connected to your instrument via the 6.35m AUX IN jack on the rear panel.

Connect one end of the audio cable to the 6.35mm AUX IN jack, the other end to the MP3/CD player. Then you can enjoy your favorite music played from the keyboard speaker.

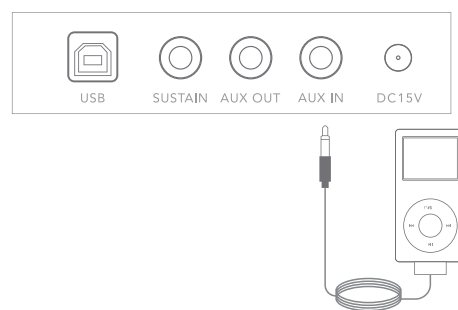

Connecting the MP3/CD Player

MP3/CD player or other audio source can be connected to your instrument via the 6.35m AUX IN jack on the rear panel.

Insert the pedal plug into the jack as shown, and use it to turn on or off the sustain effect.

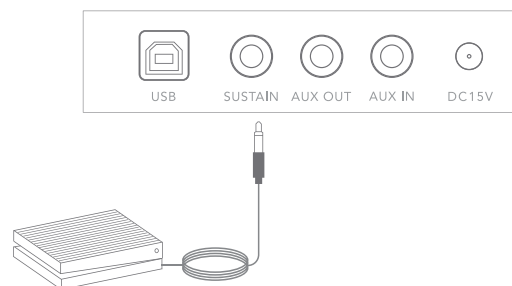

Connecting the Sustain Pedal

The sustain pedal can make the notes sustain more naturally and enrich the ambiance, which is available as an optional purchase.

Connecting the Pedal

The pedal is not included in the package. However, you may purchase the keyboard pedal to produce sustain effects. Insert the pedal plug into the jack as shown, and use its sustain effect.

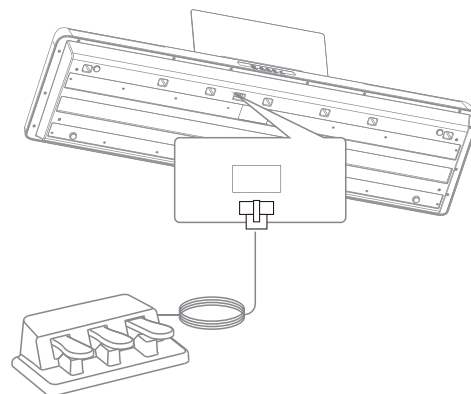



Basic Operations

Power switch

Use the Power Adapter

1. First, make sure the AC adapter is correctly connected.
2. Press <POWER> button. The indicator around the volume button will light up, and enter the Master volume control mode in the initial value, which means the power is on.
3. Press the button to enter the 88 timbres selection mode
And rotate the button to switch. After selecting the timbre. press the button to switch to Master volume control mode.

! Note:

If the indicator is not lighted after you press <POWER> button, please check whether the adapter is correctly connected.





Function Extension

! Note:

This page only lists the function your instrument can Achieve. Please refer to the instruction of APP for more details.

Selecting More Sounds

426 different timbres, including 16 folk instruments, 9 types of percussion, 256 MIDI tones and more can be selected when connected to “The ONE Smart Piano” App.

! Note:

1. Please refer to the instruction of APP to get the information of setting up the smart device.
2. The instrument will switch to grand piano sound when it works independently.

Transpose

You can set the tune in semitone via smart devices without changing the way you play. The adjustable range is ± 12 .
(Go to My Account > Sound settings > Sound setting > Transpose settings)

Octave

You can set the entire keyboard sound in octave via smart devices. The adjustable range is ± 1 .
(Go to My Account > Sound settings > Sound setting)



Function Extension

Please read carefully before proceeding.
Please keep this manual for future reference

Warning

Functions of the product may be subject to strong electromagnetic interference.
If it happens, simply follow the user manual to restore the initial settings. If the functions still cannot work after rebooting, try to use the product in another location.

Power

When you unplug the power cord from the outlet, please grasp it by the head to take it out. Don't pull the cord out or it will risk getting damaged. Avoid using with a power strip, as it may overheat the socket.
If you're using a different power adaptor with this product, you may risk causing a fire or electric shock.
For safety, disconnect the power plug when not in use or during a thunderstorm.

Connection

Before connection the product to other devices, turn off the power on all devices.
This will prevent equipment failure and damage.

Location

In order to prevent deformation, discoloration or more serious damage, avoid exposing the instrument to the following condition:

- Direct sunlight Extreme temperature or humidity
- Excessive dust or dirt
- Strong vibrations or shocks
- Strong magnetic fields

Interference with other electrical devices

When this product is placed around TV's, radios or cellphones, it can cause interference. When using this product, please keep a distance from TV's, radios and cellphones

Cleaning

To clean the device, use a soft and dry cloth. Do not use paint thinners, solvents, cleaning fluids or chemicals on the cleaning cloth.

Do not apply too much force on the On/Off button.

The piano is best stored in the following conditions: 15–35 degrees Celsius and a humidity level of 75%

Handling caution

Avoid getting paper, metal and other debris into the device. If it happens, unplug the power cord from the wall. Follow up with a professional to inspect the equipment. Before moving the product around, please disconnect the power supply.



Specifications

Keyboard	88-key hammer action piano keyboard
Polyphony	64
Timbres	88 preset timbres in the keyboard 426 different timbres, including 16 folk instruments, 9 types of percussion, 256 MIDI tones and more can be selected when connected to “The ONE Smart Piano” App.
LED	88 red and blue two color LED lights
Pedal	Sustain Pedal
Supported Devices	Android 5.0+, support USB Host / OTG iOS 10+, excluding iPad 1 Bluetooth 4.0+
Headphones	Two 3.5mm headphone jacks
AUX IN	6.35mm AUX IN jack
AUX OUT	6.35mm AUX OUT jack
Pedals	Sustain(with half pedal), Sostenuto, Soft

Note: Specifications are subject to change.
Please refer to the machine for actual data

Trouble shooting

Problem	Possible cause and solution
A noise is heard when tuning on or off the keyboard	A slight humming noise is normal when start or turn off the keyboard
Speakers do no work when playing the keyboard	Check if the volume is too low or completely turned off. Then check if anything is plugged into headphone jack.

Please contact < support@smartpiano.com> if you have more questions.



Preset Timbres

NO.	Timbres
1	Acoustic Grand Piano
2	Warm Acoustic Piano /wide
3	Bright Acoustic Piano
4	Warm Acoustic Piano
5	Bright Acoustic Piano /wide
6	Electric Grand Piano
7	Honky Tonk Piano
8	Honky Tonk Piano /wide
9	Harpsichord
10	Harpsichord /wide
11	Electric Piano 1
12	Electric Piano 2
13	Detuned Electric Piano 1
14	Choir EP
15	EP & Strings 1
16	Pulse Clavi
17	Wah Clavi
18	Drawbar Organ
19	Percussive Organ
20	Church Organ
21	Reed Organ
22	Accordion

NO.	Timbres
23	Harmonica
24	Acoustic Guitar /nylon
25	Acoustic Guitar /steel
26	Electric Guitar /jazz
27	Overdriven Guitar
28	Distortion Guitar
29	Acoustic Bass
30	Electric Bass /finger
31	Violin
32	Violin 2
33	Viola
34	Cello
35	Contrabass
36	Tremolo Strings
37	Pizzicato Strings
38	Orchestral Harp
39	String Ensembles 1
40	Strings & Brass
41	Choir Aahs
42	Orchestra Hit
43	Trumpet
44	Trombone





Preset Timbres

NO.	Timbres
45	Tuba
46	French Horn
47	Brass Section
48	Alto Sax
49	Sax Band
50	Oboe
51	English Horn
52	Bassoon
53	Clarinet
54	Piccolo
55	Flute
56	Recorder
57	Pan Flute
58	Shakuhachi
59	Whistle
60	Lead 1 /square
61	Lead 1b /sine
62	Lead 2 /sawtooth
63	Lead 2c /double sawtooth
64	Fifth Lead
65	Prelude
66	FX 7a /echo bell

NO.	Timbres
67	FX 8 /sci-fi
68	Sitar
69	Banjo
70	Shamisen
71	Koto
72	Kalimba
73	Bag Pipe
74	Shanai
75	Gu Zheng
76	Yue Qin
77	Yang Qin
78	Pi Pa
79	Er Hu 1
80	Qu Di
81	Xiao
82	Suo Na
83	Music Box
84	Marimba
85	Tinkle Bell
86	ConcertBass Drum
87	Jazz Set
88	SFX Set





The ONE
—MUSIC GROUP—
NO.2101004

