

æevgoer

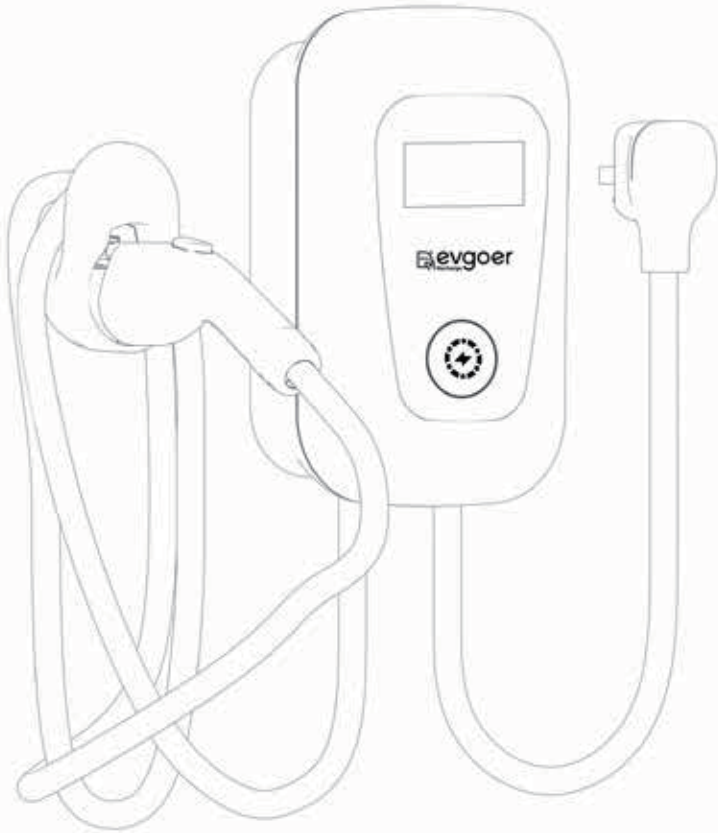

EG evgoer Recharge

40/48/50A
Electric Vehicle Charger

TABLE OF CONTENTS

IMPORTANT SAFETY INSTRUCTIONS 3

BEFORE FIRST USE 5

INTENDED USE 6

PARTS AND FEATURES 7

OPERATING INSTRUCTIONS 9

INSTALLATION STEPS 15

SPECIFICATIONS 16

TROUBLESHOOTING 17

LIGHT INDICATOR CODES 18

CONNECTOR TYPE 19

WARRANTY CONDITIONS 19

IMPORTANT SAFETY INSTRUCTIONS

CAUTION

INSTRUCTIONS PERTAINING TO A RISK OF FIRE OR ELECTRIC SHOCK: To reduce the risk of fire, connect only to a circuit provided with 60 amperes maximum branch circuit over current protection.

WARNING

When using electric products, basic precautions should always be followed, including the following. This manual contains important instructions that shall be followed during operation and maintenance of the unit.

- a) Read all the instructions before using this product.
- b) This device should be supervised when used around children.
- c) Do not put fingers into the electric vehicle connector.
- d) Do not use this product if the flexible power cord or EV cable is frayed, has broken insulation, or any other signs of damage.
- e) Do not use the product if the enclosure or the EV connector is broken, cracked, open, or shows any other indication of damage.
- f) To avoid a risk of fire or electric shock, do not use this unit with an extension cord.

WARNING

Risk of electric shock! Do Not Disconnect Under Load.

WARNING

This product is intended only for charging vehicles not requiring ventilation during charging.

CAUTION

Do not expose to liquid, vapor or rain.

CAUTION

Do not use this product if there is any damage to the unit. Send the unit back to the manufacturer in the event the unit is not operational.

- g) This product must be plugged in or hardwired. If you have any questions, please consult a local electrician.
- h) Do not touch the terminals or other current-carrying parts when your hands are wet.
- i) Do not trample or drive over the product's cables.
- j) Do not put any foreign objects into the enclosure.
- k) Do not start the engine when the charging gun is still connected.
- l) Do not use power generators as a power source for charging electric vehicles.
- m) Do not plug the product into a damaged, loose or worn outlet. Ensure that the prongs on the plug fit snugly into the outlet.
- n) Do not disconnect the product from the outlet when the vehicle is charging.
- o) Do not use the product with adapters other than those indicated in this manual.
- p) Do not use or expose the product to flammable or harsh chemicals or vapors.
- q) Do not use or store the product in a recessed area or below the floor level. Position the product main unit at least 18 inches (46 cm) above the floor level.



The lightning flash with arrowhead within a triangle is intended to tell the user that parts inside the product are a risk of shock to persons.

SAVE THESE INSTRUCTIONS

BEFORE FIRST USE

DANGER

Keep any packaging materials away from children and pets – these materials are a potential source of danger, e.g. suffocation.

- Remove all the packing materials.
- Remove and review all components before use.

INTENDED USE

WARNING

Do not use the product when either you, the vehicle or the product is exposed to severe rain, snow, electrical storm or other inclement weather.

WARNING

If rain falls during charging, do not allow rain water to run along the length of the charging cable. It may cause the electrical outlet or charging port to become wet.

- This product is intended to charge electric vehicles compatible with SAE J1772 AC Level 2 charging standard.
- This product is intended for household use only. Not for use in commercial garages where a COMMERCIAL GARAGE is defined as a facility, or portion of a facility, used to repair of internal combustion engine vehicles, in which the area may be classified due to vapors of flammable liquids (gasoline) being present.
- This product is not intended to work with electric vehicles that require an external ventilation system.
- No liability will be accepted for damages resulting from improper use or non-compliance with these instructions.

PARTS AND FEATURES

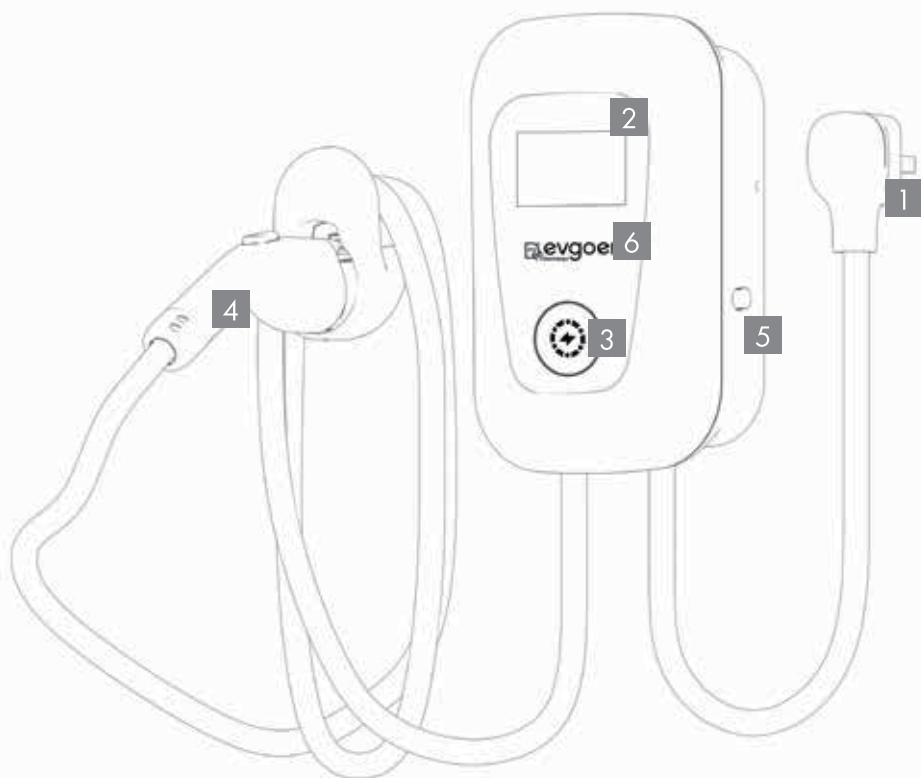

Note: When the maximum current of the product is 50A and it is hardwired, there is no plug.

1	Grounded power plug (40A power plug: 14-50P 48A power plug: 14-60P)	4	Charging gun (for J1772)
2	Display	5	Emergency stop button
3	Indicator light	6	Card swipe

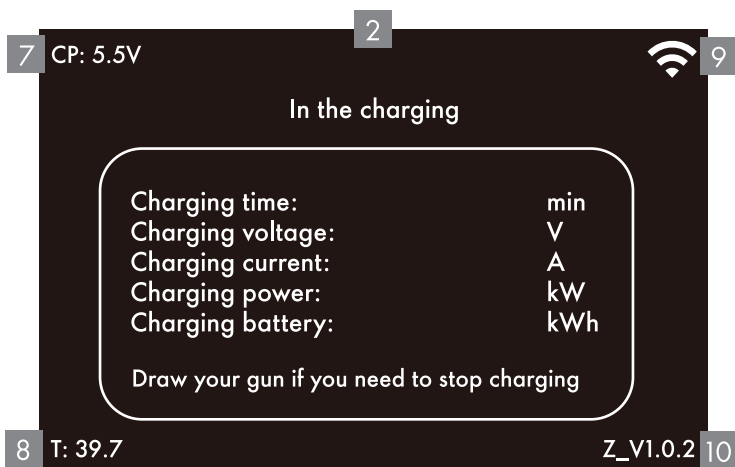

2	Display
7	Input voltage (CP)
8	Main unit's temperature
9	Wifi
10	Mainboard Version Number

OPERATING INSTRUCTIONS

Connecting to the outlet

CAUTION

- The product's maximum working current is 40A (40A EV charger with 14-50P plug), 48A (48A EV charger with 14-60P plug) or 50A (50A EV charger with hardwired installation).
- Ensure the outlet is of NEMA 14-50 or NEMA 14-60 type.
- Fully plug the power plug  into the outlet.

Electrical Installation

1. In order to ensure safe charging, the front stage of the charging pile must be equipped with 60A leakage.
2. When the wiring is installed, the power supply cable cannot be energized.
3. The selection of power supply cables must meet the requirements.
4. If the cable length exceeds 50m, it is recommended to increase one model for every 50 meters. Please consult the electrician for details.
5. When connecting the input cable, the wire
6. must be wiring strictly in accordance with the phase sequence requirements of the charging pile identification, and it must be guaranteed. The equipment is effectively grounded.

Cable name	Cable specifications	Remarks
Power supply cable	Used for 48A 2*8AWG+1*10AWG And above copper core cable	It is subject to the construction situation.

Charging Method

- 1. The EV charger has two charging methods: card swipe charging and plug-and-charge.
- 2. Default charging method is card swipe. First, the EV charger's plug 1 needs to be powered, then the charging gun 4 should be connected to the vehicle, and finally, swipe the card to start charging. To stop charging, swipe the card again.

Charging process (swipe card to start and stop)



- 3. To switch to the plug-and-play mode, place the card in the card swipe area for 5 seconds, and it will automatically switch to plug-and-play mode.

Charging process (plug-and-charge)



Smart Charging: Wi-Fi Setup

NOTICE

1. Whether it's plug-and-charge charging or card swipe charging, you can adjust charging current, schedule charging, and other settings through the app.
2. Make sure that your smart device is connected to a secure 2.4GHz network and Bluetooth is enabled.
3. Make sure that the charging station is connected to the powered NEMA 14-50R outlet.
4. You can charge your vehicle with RFID Card or download APP for more customizable options.
5. The charging station is controllable by only one user at a time. You can reset it by pressing the emergency stop button 5 and pair it again with another device.

1. **Scan QR code or search to download and install the Smart Life app.**



2. Open App, register or login as instructed.
After logged in, tap Add Device.

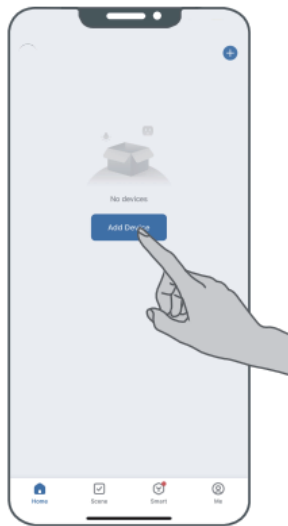

3. Wait for searching and select the device to be added.

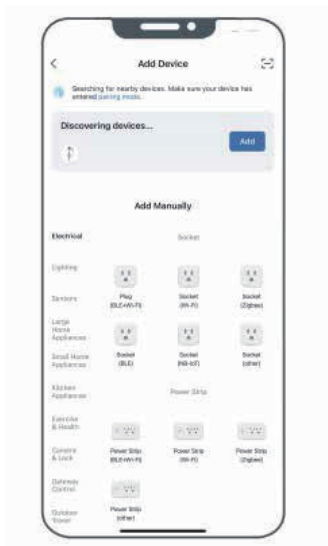

4. Select a 2.4GHz Wi-Fi and enter password.

Tap Next to complete connection. USING WITH APP

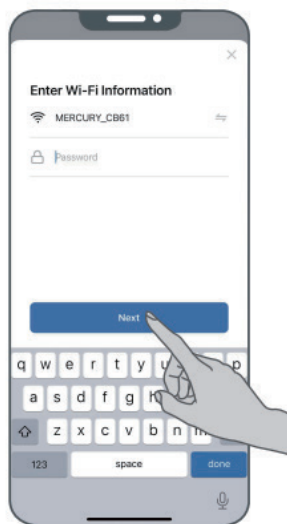

5. Slide to start charging

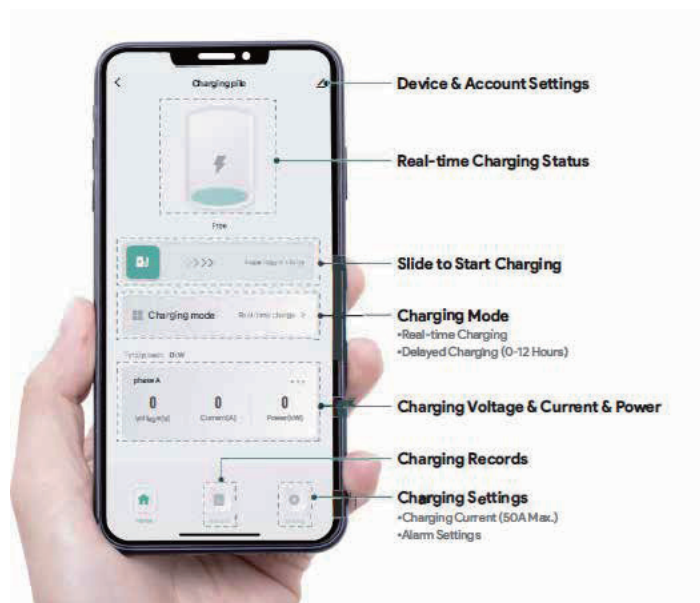

Setting the delayed charging time

Display 2

Operation



This mode allows to schedule a charge at night when the electricity rates are lower.

*In the "Delayed charging" section under "Home," you can set the time. The range for scheduled charging is 0-12 hours, divided into 13 levels. Each swipe decreases or increases by one hour.

*Select "Cancel" or "Confirm" to retract or affirm the timing you need.

Setting the output current

Display 2

Operation



*On the app, the adjustable range for current is from 8 to 60A, but the actual charging range is as follows: 8-40A for EV chargers with 14-50P plugs, 8-48A for EV chargers with 14-60P plugs, or 8-50A for hardwired EV chargers.

Please choose the appropriate current based on the product and actual situation.

*Each slide allows for an adjustment of the current by 1A.

NOTICE:

When switching from card swipe to plug-and-charge charging, the default current for plug-and-charge is the same as the last setting used during card swipe charging. Adjustments to the current can be made in the app if necessary.

INSTALLATION STEPS

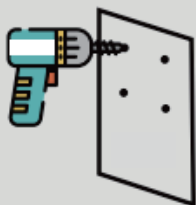

1. Drill holes using the drilling template.

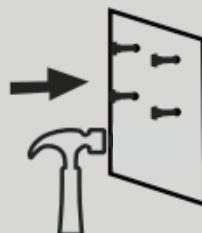

2. Hammer the M8*80 expansion screw tube into the wall hole.

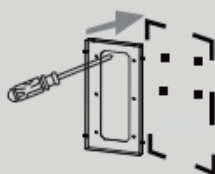

3. Use the screwdriver to fix the M8 self-tapping screws to the backplane on the wall.

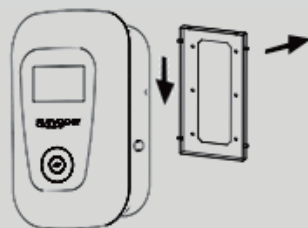

4. Open the rear cover panel and connect according to the markings.
Input wires L/N/PE. Install the charging pile on the backplane on the wall.

Moving and storage instructions

CAUTION

Do not store the product in hot place exposed to direct sunlight.

- Never lift or carry the product by the flexible power cord or the EV cable.
- Handle the product with care to prevent damage to any of its components. Do not subject the product to strong force or impact. Do not pull, twist, tangle, drag or step on the product or any of its components.

SPECIFICATIONS

Rated input/output voltage	240V AC single-phase
Rated frequency	60 Hz
Rated current	40/48/50A
Charging connector	for J1772
Charging Control	RFID Card / APP
Power plug type	NEMA Type 14-50/14-60/Hardwire
Cable length	approx. 21.6 ft (6.6m)
Operating temperature	-22°F ~ 122°F (-30 to 50°C)
Relative humidity	5%RH ~ 95%RH, non-condensing
Enclosure Rating	Charging station: NEMA Type 4
Charging gun	Type 3s
Protection class	Class 1
IP degree of protection	IP66
Net weight	19.4lb (8.8kg)
Dimension (H*W*D)	14.1*8.9*3.9in

* The weight and dimensions may vary due to measurement errors. Please refer to the actual measurements.

Universal accessories		
Product description	AC pile instruction manual	1 pc
Certificate of qualification	Factory qualification certificate	1 pc
Card	M1 card (limited credit card function)	2 pcs
Wall mounting		
Expansion screw	M8*80 expansion screw	4 pcs
Couple	Charging gun hook	1 pc

TROUBLESHOOTING

Problem	Solution
LED indicator light is not on	Re-close the AC input switch. If it keeps tripping, please check if the equipment is wired correctly, with L or N wires connected to the PE terminal
Display screen shows no response	Press the device's emergency stop button, wait 5 seconds, then release it. If the display screen remains unresponsive, open the electrical cabinet, toggle the air switch off and on again.
Controller guiding fault	Reinsert the charging gun into position; strengthen supervision after normal charging to prevent anyone from pressing the handle button during charging.
Lock the charging gun at the vehicle end	Turn off the vehicle ignition key to lock the car, then restart the car. If the issue persists, please contact customer support

LIGHT INDICATOR CODES

Status	Light Indicator	Solution
Standby	Blue light continuously illuminated	
Connected	Green light continuously illuminated	
Charging	Green light flashing	
Voltage fault	Red light continuously illuminated	Wait until the voltage returns to optimal range, then use the product again.
Over Vin or Low Vin	Red light flashes once	The product will automatically stop charging. Wait until the voltage returns to optimal range, then use the product again.
Outlet is not properly grounded	Red light flashes twice	Ensure the outlet is properly grounded Contact qualified electrician if in doubt.
Emergency stop charging	Red light flashes four times	Press the button again. In plug-and-play mode, you need to reconnect the charging gun. In card swipe charging mode, you need to restart charging via the app or swipe the card again.
Output over current	Red light on for 3 seconds, off for 3 seconds.	Unplug the product from the vehicle and then from the outlet. Connect the product to the vehicle and the outlet. Set the correct output current.
Leakage current	Blue and red mixed color flashing once for 1 second	Check whether the output line of EV charger is damaged or has low impedance to the ground
Over-temperature	Blue and red mixed color flashing once for 2 seconds.	The product will automatically stop charging. Wait until the product cools down, then use the product again.
Relay Error	Blue and red mixed color flashing once for 4 seconds.	Please contact customer support for assistance.

CONNECTOR TYPE

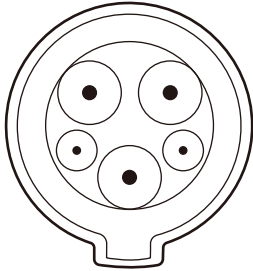

The product is compatible with connector type 1 (J1772) only.

WARRANTY CONDITIONS

- a) We will, at our discretion, repair any product that proves to be defective in material or workmanship during the warranty period of 12 months.
- b) A valid proof of purchase must be presented upon request for warranty service;
- c) The warranty shall not apply if:
 - the product was modified or repaired in any way by persons other than our technicians
 - the product has been damaged through misuse, negligence or inflow of any liquid
 - the product was not used according to user manual
 - losses or damages are caused by force majeure or natural disasters
- d) The warranty terms and conditions are subject to change without prior notice.
- e) Product specifications are subject to change without prior notice.
- f) evgoer shall not be liable for technical or editorial errors or omissions contained herein.

evgoer



EG evgoer Recharge

40/48/50A
Electric Vehicle Charger