

Buy website address: <https://reissopto-led.com/products/vdwall-ds2-4-dvi-splitter-sending-card-signal-amplifying-controller-box>

**DS2-4**  
**Splitter + Sending Cards Box Two In One**  
**Product User Manual**



## **Contents**

<b>Chapter1</b>	<b>Safety Precautions.....</b>	<b>03</b>
<b>Chapter2</b>	<b>Item List.....</b>	<b>04</b>
<b>Chapter3</b>	<b>Product Introduction.....</b>	<b>05</b>
<b>Chapter4</b>	<b>Hardware Connections.....</b>	<b>06</b>
41	1 Rear Panel Signal Port Diagram.....	06
42	Typical Application Connection Diagram.....	06
4-3	Sending Cards Installation Instruction.....	07
4-4	Specifications.....	07
4-5	Installation Dimension Diagram.....	08
<b>Appendix</b>	<b>Manual Modification Record List.....</b>	<b>11</b>

## Chapter1 Safety Precautions



### Danger

There is high voltage in the processor, to prevent any unexpected hazard, unless you are maintenance personnel, please do not open the cover of the device.



### Warning

1. This device shall not encounter water sprinkle or splash, please do not place anything containing water on this device.
2. To prevent fire, keep this device far from any fire source.
3. If this device gives out any strange noise, smoke or smell, please immediately unplug the power cord from receptacle, and contact local dealer.
4. **Please do not plug or unplug DVI signal cable if the device is powered on.**



### Caution

1. Please thoroughly read this manual before using this device, and keep it safe.
2. In the event of lighting or when you are not going to use the device for a long time, please pull the power plug out of receptacle.
3. Nobody other than professional technicians can operate the device, unless they have been appropriately trained or under guidance of technicians.
4. To prevent equipment damage or electric shock, please don't fill in anything in the vent of the device.
5. Do not place the device near any water source or anywhere damp.
6. Do not place the device near any radiator or anywhere under high temperature.
7. To prevent rupture or damage of power cords, please handle and keep them properly.
8. Please immediately unplug power cord and have the device repaired, when
  - 1) Liquid splashes to the device.
  - 2) The device is dropped down or cabinet is damaged.
  - 3) Obvious malpractice is found or performance degrades.

## **Chapter2 Item List**

Please unpack the product carefully, then check whether all the following things are included in the package. If anything is found missing, please contact the dealer.

### **Standard accessories**

The accessories supplied with this DVI distributor may differ from the figures contained in the User's Manual, but they are applicable for the regions where you live.

		
1.5m power cord * 1	0.5m DVI cable *2	User manual * 1

## **Chapter3 Product Introduction**

The DS2-4 is a two-in-one product that combined DVI splitter and sending cards box. It is built-in two one-in-two-out ultra HD DVI splitters, it supports any DVI input signal with dot frequency below 165MHz; the DS2-4 also has sending cards installation position, it can be built-in four pcs of two network ports sending cards. The DS2-4 is very suitable for matching with VDWall splicing equipment such as LVP8601, LVP909, etc, it provides stable and reliable DVI signal for the cascading of dual sending cards. Every DVI input of DS2-4 contains DVI EDID, it can also be used for the distribution applications of graphics card DVI signal.

## Chapter4 Hardware Connections

### 4-1 Rear Panel Signal Port Diagram

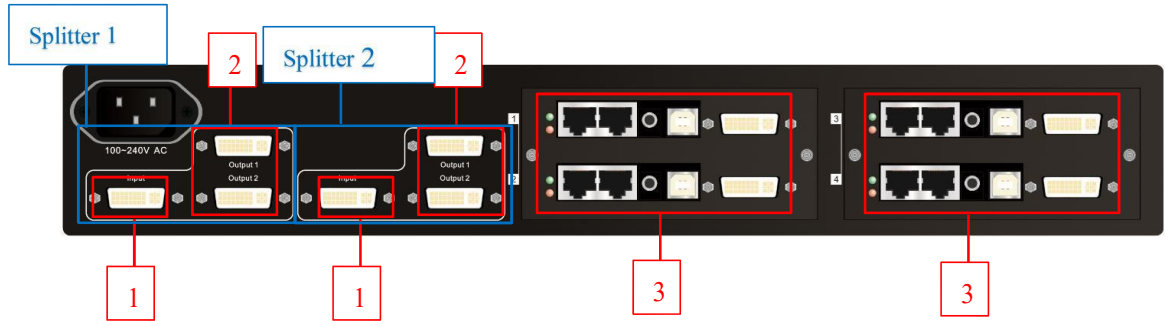

Diagram 4-1 Rear Panel Signal Port Diagram

1: DVI Input Port 2: Two DVI Output Ports 3: Sending Cards Installation Position

### 4-2 Typical Application Connection Diagram

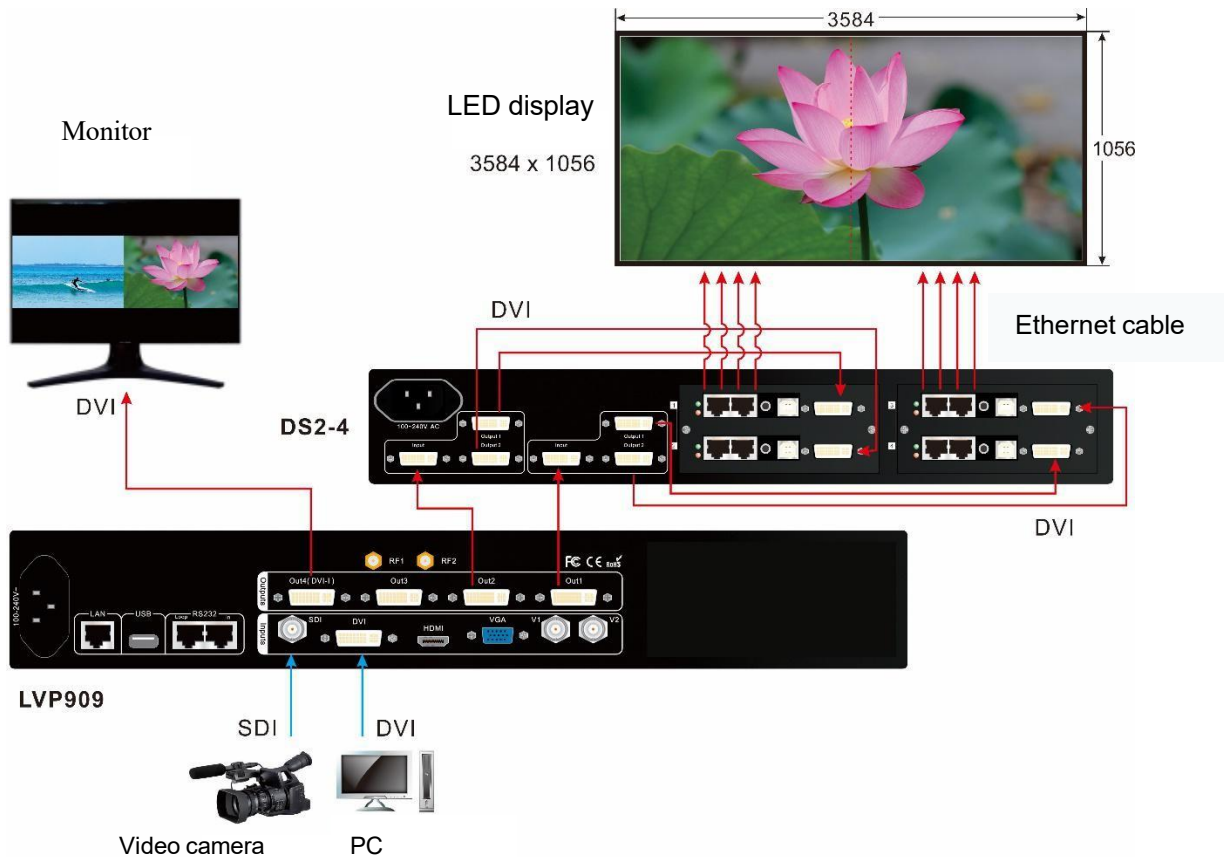
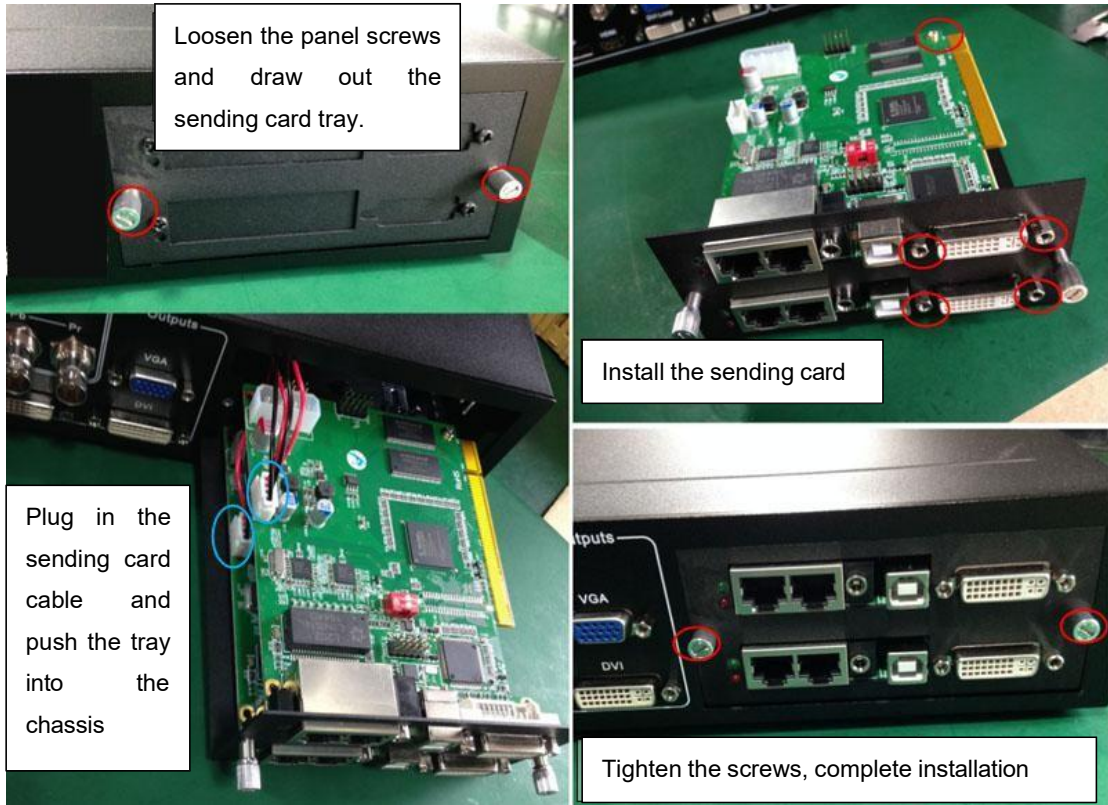

Diagram 4-2 Typical Application Connection Diagram

### 4-3 Sending Cards Installation Instruction



### 4-4 Specifications

Input signal index		
Quantity / type	2×DVI (VESA)	
DVI format	PC (VESA standard )	Dot frequency < 165MHz
Input port	DVI: 24+1 DVI_D	
Signal amplitude impedance	TMDS= 0.5 V (p_p) / 75Ω	
DVI EDID format	640x480_60/72/75 800x600_60/72/75 1024x768_60/70/75 1152x870_75 1280x720_60 1280x800_60	1280x1024_60/75 1366x768_60 1440x900_60 1600x1200_60 1680x1050_60 1920x1080_50/60

## DS2-4 User Manual

	1280x960_60	1920x1200_60
Output signal index		
Quantity / type	4×DVI	
DVI format	PC (VESA standard) Dot frequency < 165MHz	
Output port	DVI OUT: 24+1 DVI_D	
Others		
Input voltage	100-240VAC 50/60Hz	
Power consumption	≤25W	
Environment Temperature	0-45 °C	
Environment Humidity	15-85%	
Dimension	483(L)X150(W)X44(H) mm	
Weight	G.W: Kg, N.W: 1.9Kg	

## 4-5 Installation Dimension

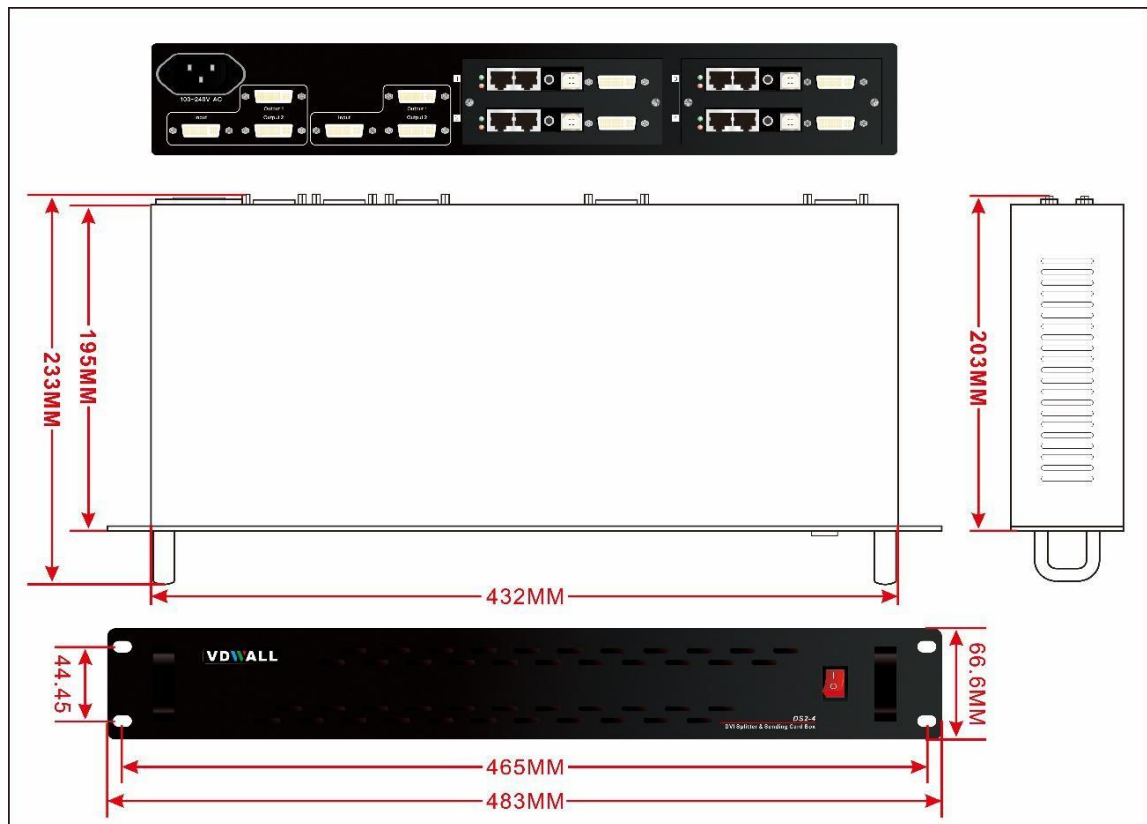

Diagram 4-4 Installation Dimension Diagram