



TRANSDUCERS

Echo Sounder Transducers & Fish Finder Transducers
& NMEA Transducers & Speed Log Transducer

Support Customization

OVA TECHNOLOGY
www.ova.technology

Transducer

*Optional depth + temperature ( Marked product)

A-TD25B

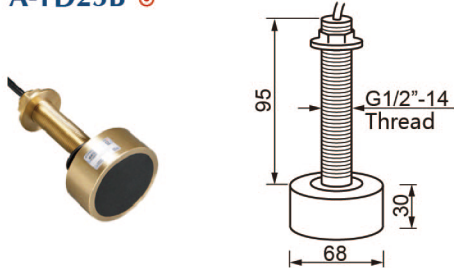

Frequency/Power:50&200KHz/600W
 Beamwidth/Impedance:45° &12°
 200Ω &300Ω ± 30%
 Cable Length/Pin:10M/3P
 Material:Bronze

A-TD26B

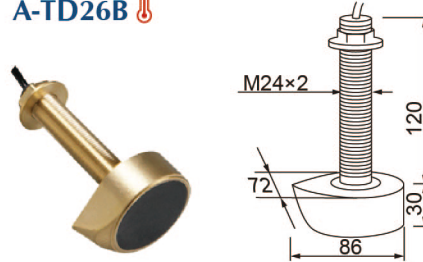

Frequency/Power:50&200KHz/600W
 Beamwidth/Impedance:55° &14°
 200Ω &300Ω ± 30%
 Cable Length/Pin:10M/3P
 Material:Bronze

A-TD254B/ A-TD354B-50/ A-TD354B-200

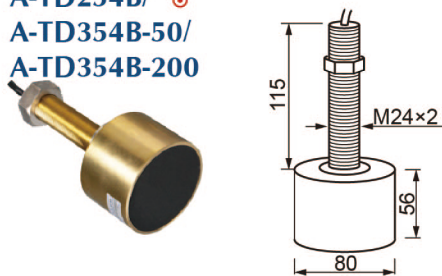

Frequency/Power :50&200KHz/600W
 50KHz/1KW 200KHz/1KW
 Beamwidth/Impedance: 35° &11°
 380Ω &350Ω ± 30%
 28° /150Ω ± 30%
 10° /200Ω ± 30%
 Cable Length/Pin:10M/3P
 Material: Bronze

A-TD25P

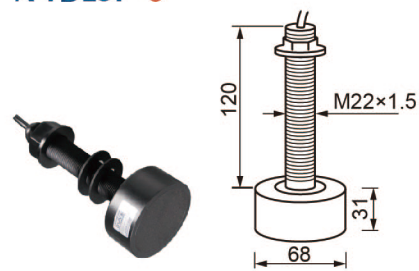

Frequency/Power :50&200KHz/600W
 Beamwidth/Impedance:45° &12°
 200Ω &300Ω ± 30%
 Cable Length/Pin:10M/3P
 Material: Plastic

A-TD252P



Frequency/Power :50&200KHz/600W
 Beamwidth/Impedance:40° &14°
 200Ω &300Ω ± 30%
 Cable Length/Pin:10M/Z108-8A
 Material: Plastic

A-TD252B

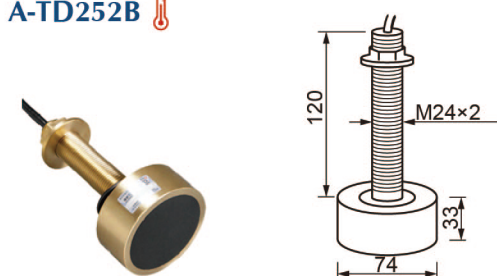

Frequency/Power:50&200KHz/600W
 Beamwidth/Impedance:40° &14°
 200Ω &300Ω ± 30%
 Cable Length/Pin:10M/Z108-8A
 Material:Bronze



A-TD22B

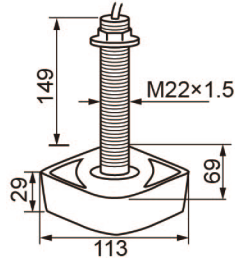

Frequency/Power: 50&200KHz/600W
 Beamwidth/Impedance: 40° & 11°
 200Ω & 300Ω ± 30%
 Cable Length/Pin: 10M/Z108-8A
 Material: Bronze

A-TD25S

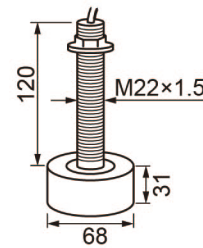

Frequency/Power: 50&200KHz/600W
 Beamwidth/Impedance: 45° & 12°
 200Ω & 300Ω ± 30%
 Cable Length/Pin: 10M/Z108-8A
 Material: Stainless steel

A-TD232B

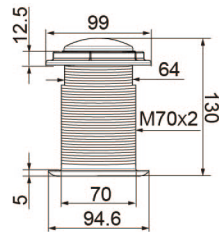

Frequency/Power: 50&200KHz/600W
 Beamwidth/Impedance: 24° & 16°
 200Ω & 300Ω ± 30%
 Cable Length/Pin: 12M/3P
 Tilt: 0°, 12°, 20°
 Material: Bronze

A-TD29P(With water temperature and flow rate)

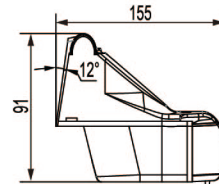

Frequency/Power: 50KHz&200KHz/600W
 Beamwidth/Impedance: 45° & 11°
 100Ω & 200Ω ± 30%
 Cable length: 8M
 Mount: Transom
 Material: Plastic

Water temperature transducer

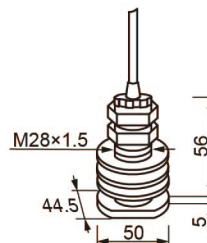

Cable length: 10M/15M
 Pin: 8P
 Material: Bronze

Transducer

A-TD34R-200-D

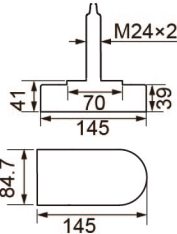

Frequency/Power:
200KHz/1KW
Beamwidth/Impedance:
11°
300Ω ± 30%
Cable Length/Pin:
10M/3P
Material: Bronze

A-TD38R-200-D

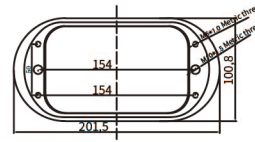
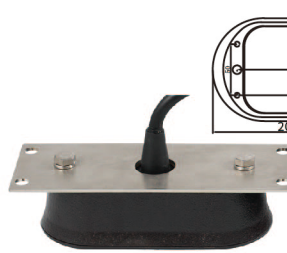

Frequency/Power:
200KHz/1.5KW
Cable length/Pin:
10M/3P
Mount: Thru-hull
Material: Rubber

A-TD32B

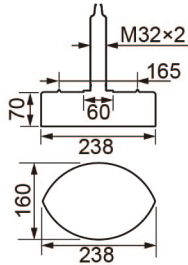

Frequency/Power:
50KHz/1.8KW
& 200KHz/1KW
Beamwidth/Impedance:
14° * 14° & 10°
50Ω & 300Ω ± 30%
Cable Length/Pin:
15M/5P
Material: Bronze

A-TD38R-200

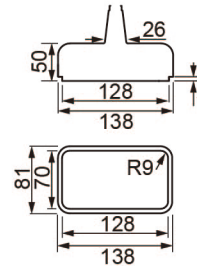

Frequency/Power :
200KHz/1.5KW
Beamwidth/Impedance:
6° * 10°
150Ω ± 30%
Cable Length/Pin:
15M/3P
Material: Rubber

A-TD88R-50

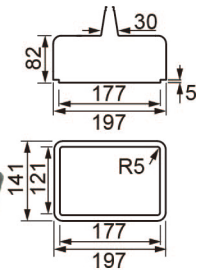

Frequency/Power :
50KHz/3KW
Beamwidth/Impedance:
12° * 20°
100Ω ± 30%
Cable Length:
15M
Material: Rubber

A-TD68R

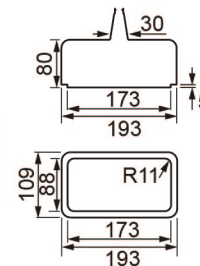

Frequency/Power :
50KHz/2KW
& 200KHz/1KW
Beamwidth/Impedance:
16° * 12° & 6° * 12°
60Ω & 250Ω ± 30%
Cable Length/Pin:
15M/5P
Material: Rubber

A-TD372R

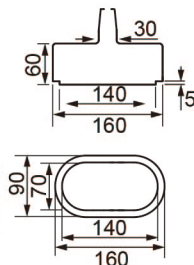

Frequency/Power :
50KHz/1.5KW
Beamwidth/Impedance:
12° * 28°
100Ω ± 30%
Cable Length:
15M
Material: Rubber

A-TD353R-200

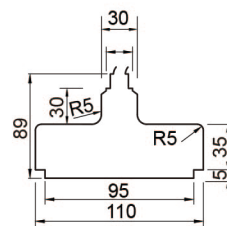

Frequency/Power :
200KHz/2KW
Beamwidth/Impedance:
5.5°
160Ω ± 30%
Cable Length:
20M
Material: Rubber



Keel-Mount



Tank-Mount



Thru-Hull

A-TD37B

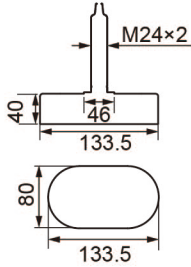

Frequency/Power:
50&200KHz/1KW
Beamwidth/Impedance:
18° *18° &6° *12°
100Ω &200Ω ±30%
Cable Length/Pin:
10M/3P
Material:Bronze

A-TD372B

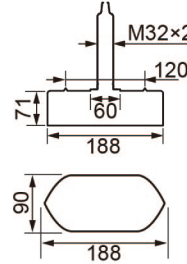

Frequency/Power:
50&200KHz/1.2KW
Beamwidth/Impedance:
28° &10°
150Ω &300Ω ±30%
Cable Length/Pin:
15M/5P
Material:Bronze

A-TD38R

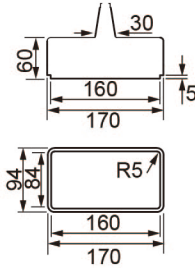

Frequency/Power :
50KHz&200KHz/1KW
Beamwidth/Impedance:
28° *10°
150Ω&300Ω ±30%
Cable Length/Pin:
15M/5P
Material: Rubber

A-TD382R

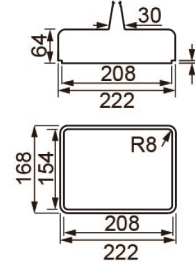

Frequency/Power :
50KHz/1.8KW
&200KHz/1KW
Beamwidth/Impedance:
14° *14° &10°
50Ω&300Ω ±30%
Cable Length/Pin:
15M/5P
Material: Rubber

A-TD882R

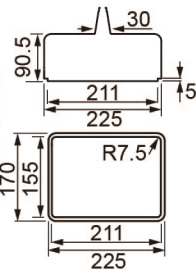

Frequency/Power :
50KHz/3KW
&200KHz/1KW
Beamwidth/Impedance:
12° *20° &6° *12°
100Ω&250Ω ±30%
Cable Length/Pin:
15M/5P
Material:Rubber

A-TD98R

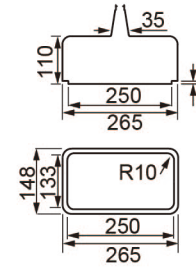

Frequency/Power :
40&75KHz/5KW
Beamwidth:
13° *18°
&10° *16°
Cable Length/Pin:
15M/3P
Material: Rubber

A-TD35R-40

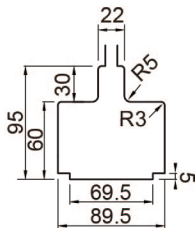

Frequency/Power :
40KHz/1KW
Beamwidth/Impedance:
50°
300Ω ±40%
Cable Length:
10M
Material: Rubber

A-TD35R-50

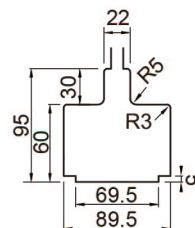

Frequency/Power :
50KHz/1KW
Beamwidth/Impedance:
44°
250Ω ±40%
Cable Length:
12M
Material: Rubber

Transducer

A-TD35R-200

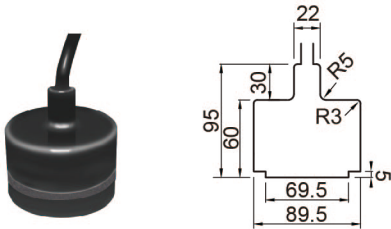

Frequency/Power :200KHz/1KW
 Beamwidth/Impedance:11°
 250Ω ± 40%
 Cable Length:12M
 Material: Rubber

A-TD352R-200

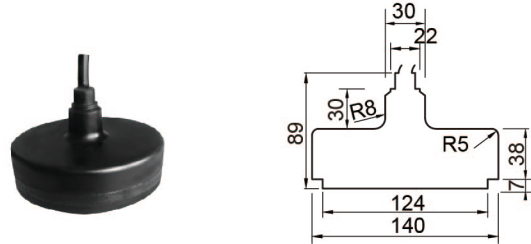

Frequency/Power :200KHz/1KW
 Beamwidth/Impedance:6°
 60Ω ± 40%
 Cable Length:20M
 Material: Rubber

A-TD683P-28

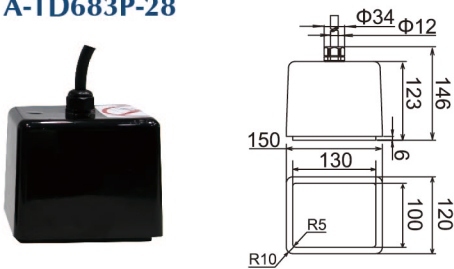

Frequency/Power: 28KHz/2KW
 Beamwidth/Impedance:22° * 32°
 60Ω ± 30%
 Cable length:15M
 Mount: External
 Material: Plastic

A-TD884P-28

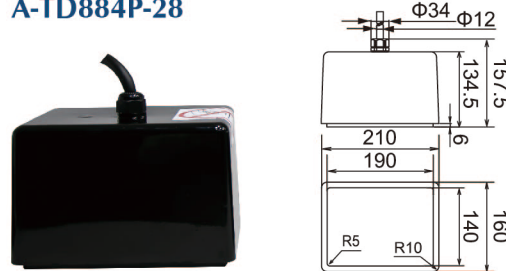

Frequency/Power: 28KHz/3KW
 Beamwidth/Impedance: 16° * 21.5°
 60Ω ± 30%
 Cable length:15M
 Mount: External
 Material: Plastic

A-TD682P-50

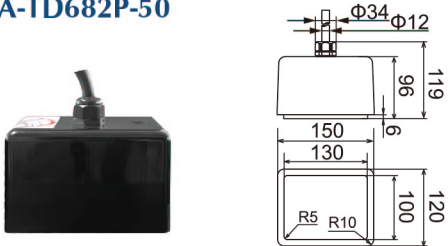

Frequency/Power: 50KHz/2KW
 Beamwidth/Impedance:14° * 18.5°
 70Ω ± 30%
 Cable length:15M
 Mount: External
 Material: Plastic

A-TD883P-50

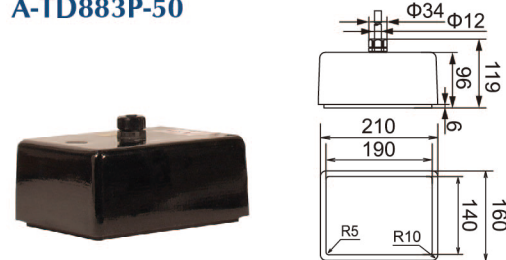

Frequency/Power: 50KHz/3KW
 Beamwidth/Impedance: 9° * 14°
 70Ω ± 30%
 Cable length:15M
 Mount: External
 Material: Plastic

Fairings

The following models are available with fairing:

A-TD25B A-TD25P A-TD254B A-TD352R-200
 A-TD372B A-TD32B A-TD882R A-TD35R-200

For A-TD25B



For A-TD254B



For A-TD35R-50/
A-TD35R-200



For A-TD352R-200



Connector

Support Customization



3pin



8pin



3pin



5pin



6pin



8pin



9pin



10pin

Doppler Speed Log Transducer & Tank & Gate Valve



Model: A-TP820S

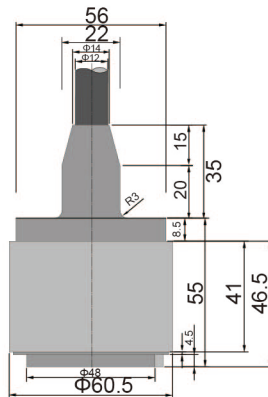

Electromagnetic Speed Log Sensor

Model: A-TE571S

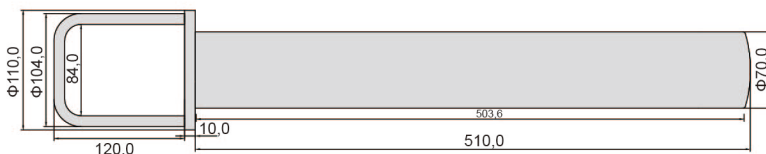
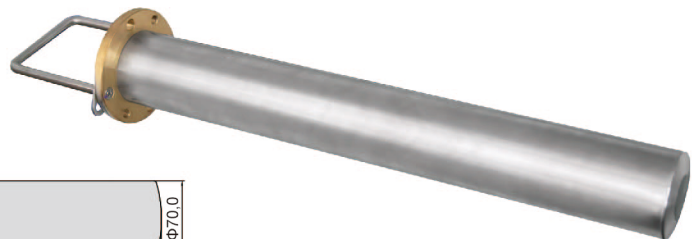



www.ova.technology