

Installation Guidelines

- LED Flat Panel

To users:

Thank you for purchasing our products, please read this manual carefully before installation for ensuring your correct use.

Applications

Led flat panel light uses LED light source which is a new green energy-saving lighting and can fully replace Traditional Medallions. It is widely used in home, office, hotel, factory and other occasions.

Features

1. Work with 0-10V dimmer
2. LED flat panel light has good appearance, and uses aluminum material structure
3. The light uses high quality LED light source with high light transmittance of PMMA light cover. This in turn brings soft, healthy and comfortable light.
4. No mercury, no ultraviolet, no splash, green, environmental protection.
5. Good luminous flux and color rendering, high luminous efficiency, long lifespan.
6. Use high quality constant current driver which has the protective function in abnormal state (no-load, over current, short circuit, under voltage, etc.) and it has good stability and reliability.

Technical Parameters

Power	Rated Voltage	PF	CCT	Ra	Size
30W	100-277V AC50/60Hz	0.9	3000K/4000K/5000K	80	603*603mm
30W	100-277V AC50/60Hz	0.9	3000K/4000K/5000K	80	303*1212mm
36W	100-277V AC50/60Hz	0.9	3000K/4000K/5000K	80	603*603mm
36W	100-277V AC50/60Hz	0.9	3000K/4000K/5000K	80	303*1212mm
40W	100-277V AC50/60Hz	0.9	3000K/4000K/5000K	80	600*600mm
40W	100-277V AC50/60Hz	0.9	3000K/4000K/5000K	80	603*1212mm
48W	100-277V AC50/60Hz	0.9	3000K/4000K/5000K	80	603*1212mm
60W	100-277V AC50/60Hz	0.9	3000K/4000K/5000K	80	603*1212mm

Installation Way

Please open the package before installation, take out fixtures, and install the goods refer to the instruction.

Embedded installation

(make sure the keel has good bearing, if any, a safety rope is needed.)

- 1) When installing panel light, remove the corresponding plasterboard.
- 2) According the picture 1,2,3 order, firstly connect the driver input line with mains, and then insert the light into the ceiling, place the light to the original plasterboard location from top to the bottom,
- 3) According the picture 4,5,6 order, please put the hook stand on the back panel and then go with 90° turning, hang the hooks on the channels as the diagrams shown.
- 4) Finally open the mains, the power lights complete, then connects the power and the light turns on, thus completes the installation.

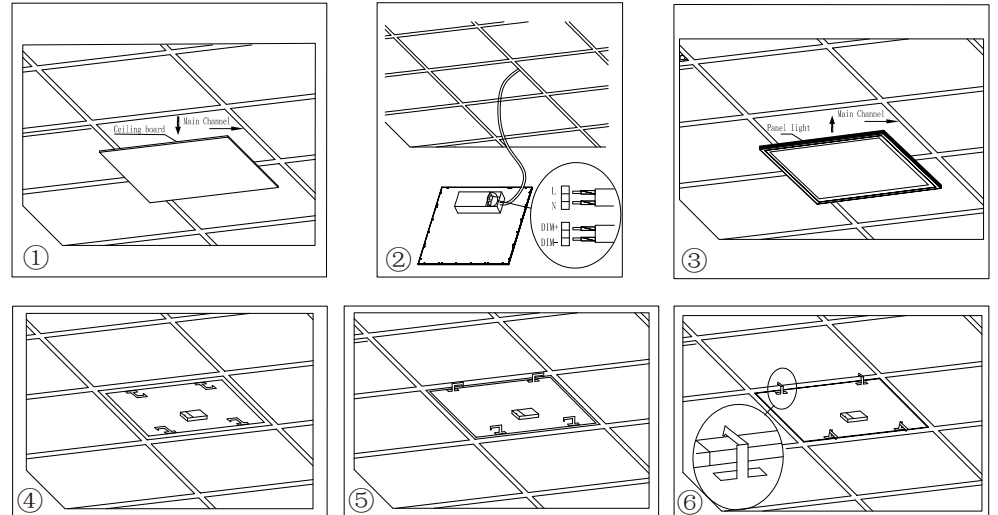

Notice:

1. Must be installed by the professional electrician.
2. Installation and maintenance must be operated in the condition of power off.
3. The lamp body should keep off from direct contact with water and other liquids so as to avoid the occurrence of leakage, electric shock, etc..
4. Prohibition of the product long-term exposure to high temperature and humidity environment
5. Make sure that the lamp input voltage is 100-277VAC 50/60Hz, or it may damage the power supply
6. Non transformation lamps, the loss of this is out off the company's responsibility.