

# LED ARCHITECTURE WALL PACK LIGHT

## Installation Guide

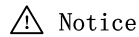

Notice

### PLEASE READ ALL INSTRUCTIONS BEFORE ATTEMPTING INSTALLATION

- To prevent personal injury or product damage only licensed electricians should install.
- To avoid electric shock or component damage disconnect power before attempting installation or servicing.
- This product must be installed in accordance with the national electric code (NEC) and all applicable federal, state and local electric codes and safety standards.
- Disconnect product and allow cooling prior to servicing.
- Any alteration or modification of this product is expressly forbidden as it may cause serious personal injury, death, property damage and/or product malfunction.
- To prevent product malfunction and/or electrical shock this product must be properly grounded.
- This luminaire is designed to operate in ambient temperatures ranging from -30°C to 45°C and to be horizontally mounted with the LEDs facing down.

## 1. Unpacking

Thoroughly check the damage to the fixture. Damage to the goods shall be reported to the carrier

## 2. Install

A

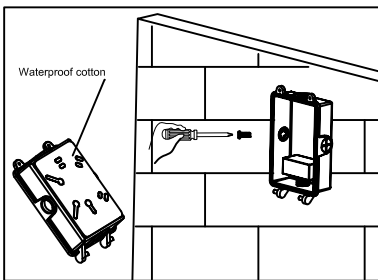

1. stick the waterproof cotton on the bottom of the lower cover, and the lower cover is fixed on the wall with screws. The light control is assembled to the lower cover of the power supply box (as shown in the picture).

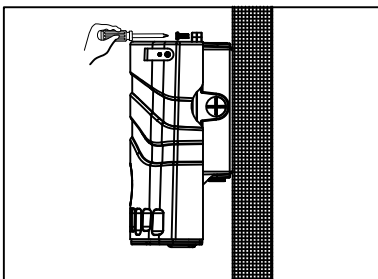

3. after the AC power cord is connected, the upper cover and the lower cover are locked by screws (as shown in the picture).

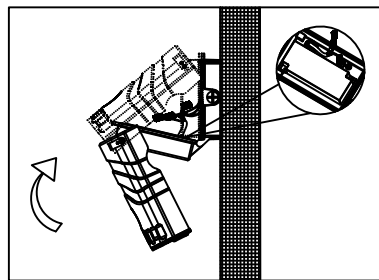

2. the upper cover and the radiator (assembly) are assembled into the shaft hole through the rotating shaft. Connect the AC power line.(as shown in the picture).

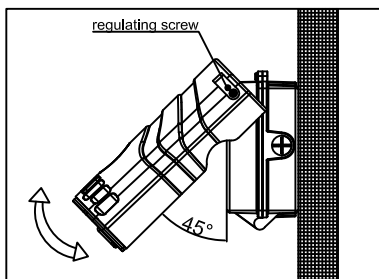

4. Customers adjust the two adjusting screw of the lamp according to their own needs Fixed the angle of the lamp(as shown in the picture).

B

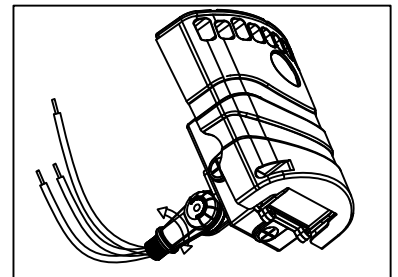

1. Remove the lamp from the package and check whether the lamp is damaged during transportation. If there is no damage, adjust the ideal installation angle of the K-shaped bracket (positive or negative 90 degrees)(as shown in the picture).

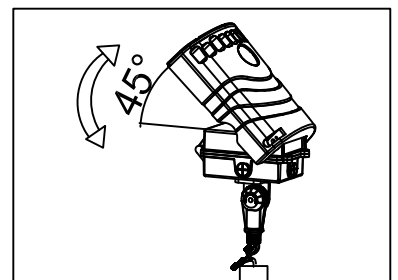

2. Connect the AC power line and install the lamp on the base. Customers can adjust the angle of two adjusting screw lamps according to their own needs (as shown in the picture).

## Diagram of connection

