

GAHLERI

QUICK START GUIDE

For Gaahleri Airbrush CS-30 , GHPM-65

ATTENTION

1. Please do some test on paper before painting. Use a tiny bits of paint or water.
2. DO NOT spray noxious, flammable, explosive material.
3. After finishing the work, please clean the airbrush (use airbrush cleaner).
4. Please take care when cleaning the needle and nozzle. Otherwise it may cause poor spraying effect, or even hurt yourself.
5. When not using Gaahleri airbrush for a long time, please clean it totally and place in good conditions.
6. Gaahleri airbrush is already pre-installed and full tested. If you have any question, please contact us through the email address provided at the end of manual.

1 BEGIN

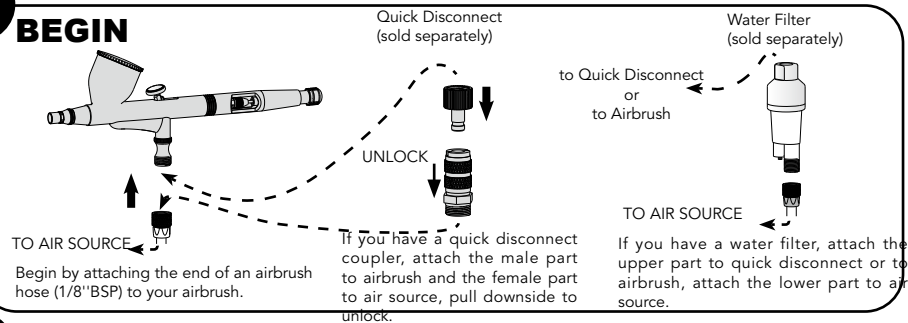

2 PAINT

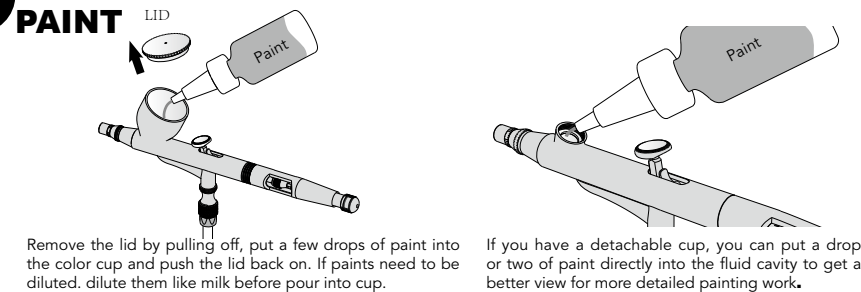

3 START AIRBRUSHING

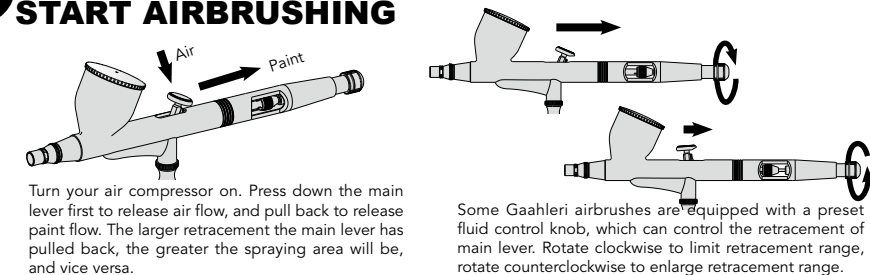

4

PERFECT SPRAYING EFFECT

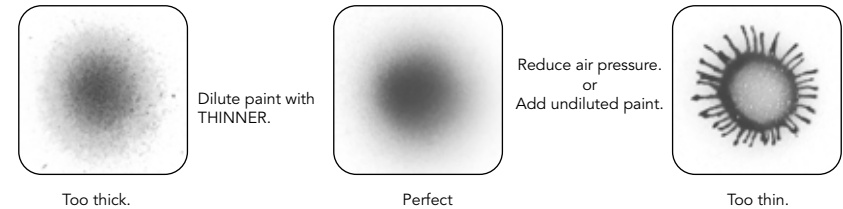

Q&A.

CONTENTS

- a** HOW TO SWITCH COLOR
- b** LARGE PARTICLES OF PAINT FLY APART
- c** WHEN AIR REVERSE FLOW INTO THE CUP
- d** UNABLE TO SPRAY PAINT
- e** WHEN THE TRIGGER CANNOT BE PULLED BACKWARDS
- f** DEEP CLEANING
- g** ADD LUBE

a HOW TO SWITCH COLOR

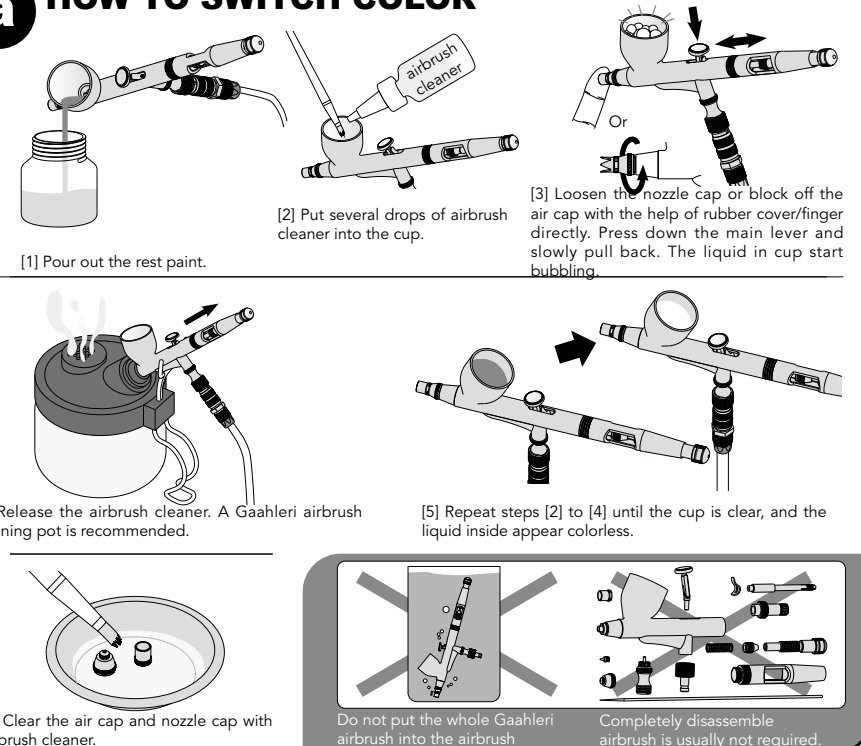

b LARGE PARTICLES OF PAINT FLY APART

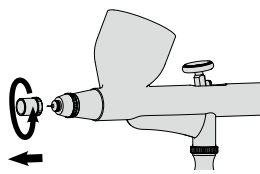
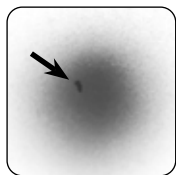

[1] Remove the air cap by rotate counterclockwise.

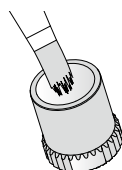

[2] Put a few drops of airbrush cleaner and clear inside of air cap.

c WHEN AIR REVERSE FLOW INTO THE CUP

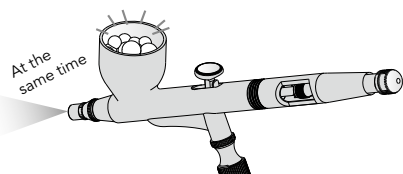

[1] When the main lever is pulled, the paint in pot start to bubble and even come out of the cup.

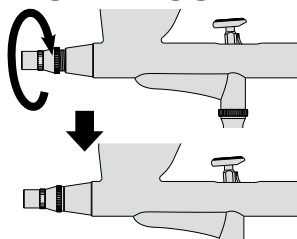

[2] Please try tighten the nozzle cap.

d UNABLE TO SPRAY PAINT

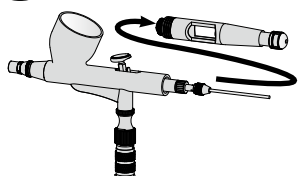

[1] Remove the handle.

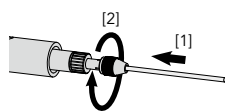

[2] Push the needle to the leading end with a little pressure but not like jabbing, then tighten the needle chucking nut.

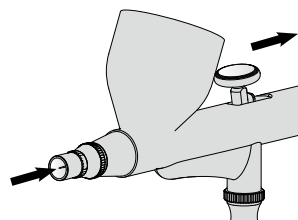

[3] Pull back the main lever to check whether the needle has moved.

e WHEN THE MAIN LEVER CANNOT BE PULLED BACKWARDS

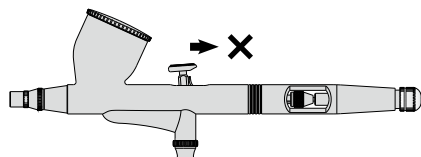

[1] Check whether the preset fluid control knob is too tight, rotate counterclockwise to enlarge retraction range.

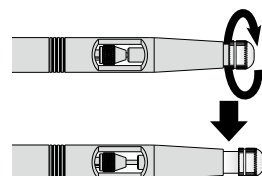

[2] If it still cannot be pulled, the paint may have dried inside the airbrush because it was not cleaned after last use. Deep cleaning is needed at this time.



f DEEP CLEANING Please be careful !

According **a** to clear.

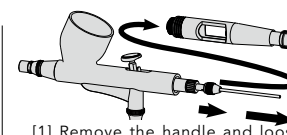

[1] Remove the handle and loosen the needle chucking nut that allows the needle to be pulled out (please take care when doing it).

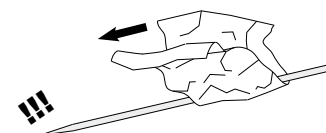

[2] Using tissue dipped with some airbrush cleaner, clean the needle several times from back to front until there is no residual paint on the needle.

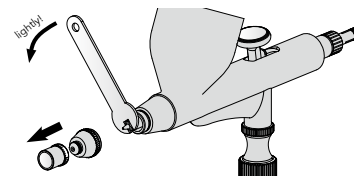

[3] Remove the air cap and nozzle cap, then use wrench to remove the nozzle.

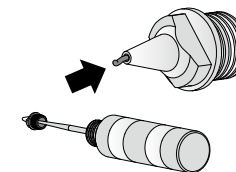

[4] Use the cleaning needle to clean the dry paint inside the nozzle.

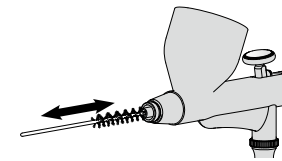

[5] Clean the inside of the airbrush by using cleaning brush with airbrush cleaner.

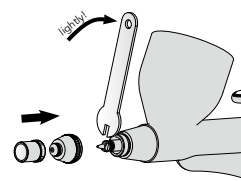

[6] Put the nozzle, nozzle cap and air cap back and tighten it carefully !

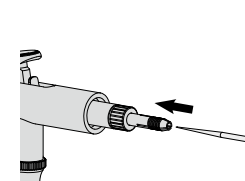

[7] Gently reinstall the needle to avoid hitting the needle's front end. Water spray test is recommended after assembly.

g ADD LUBE

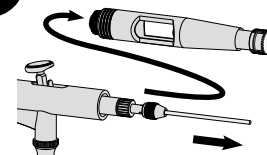

[1] Remove the handle and loosen the needle chucking nut that allows the needle to be pulled out (please take care when doing it).

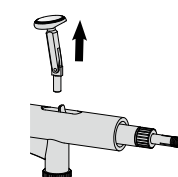

[2] Pull up the main lever and apply a few drop of lube to the bottom part.

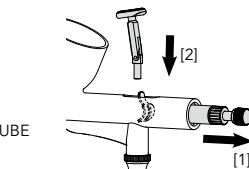
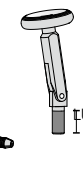

[3] Put the needle chucking nut back and load the main lever back, do not tip the lever guide. Install the needle and handle back after lubrication test.

Brand: Gaahleri
Product Name: Gravity Feed Airbrush
Company Name: Ningbo Gaile Network Technology Co., Ltd.
Store: Gaahleri airbrush store
Email Address: gaahlerilab@outlook.com

FOLLOW US ON Twitter/Instagram/Facebook/Youtube: Gaahleri Studio

GAHLERI