

GA AHLERİ GRAVITY FEED AIRBRUSH

Quick Start Guide

www.gaahleri.com

1

BEGIN

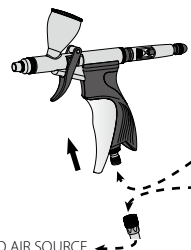

Begin by attaching the end of an airbrush hose (1/8" BSP) to your airbrush.

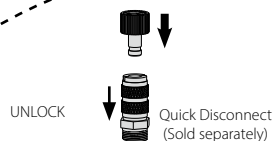

Attach the male part to airbrush and the female part to air source, pull downside to unlock.

2

PAINT

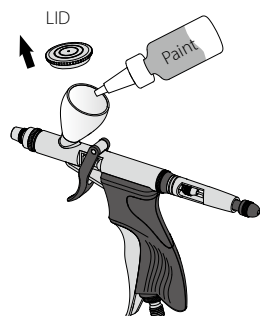

Put a few drops of paint in cup, dilute paints to look like milk if needed before pour into cup.

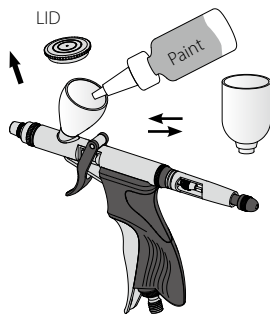

Some series of Gaahleri airbrush can be installed with different capacity cups to meet various spraying needs.

3

START AIRBRUSHING

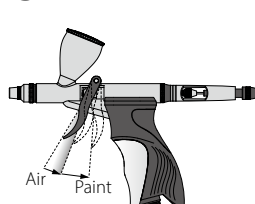

Turn your air compressor on. Pull back the trigger to release air flow, continue pulling to release paint flow.

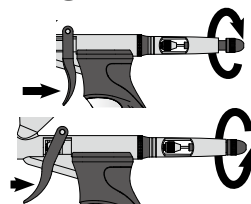

The preset fluid control knob (if equipped) can control the retracement of main lever.

4

PERFECT SPRAYING EFFECT

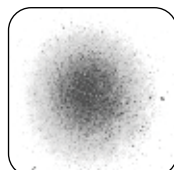

Too thick.

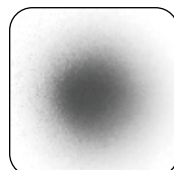

Perfect

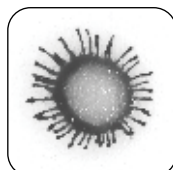

Too thin.



ATTENTION

1. Please do some test on paper before painting. Use a tiny bits of paint or water.
2. DO NOT spray noxious, flammable, explosive material.
3. After finishing the work, please clean the airbrush as soon as possible (use airbrush cleaner).
4. Please take care when cleaning the needle and nozzle. Otherwise it may cause poor spraying effect, or even hurt yourself.
5. When not using Gaahleri airbrush for a long time, please clean it totally and place in good conditions.
6. Gaahleri airbrush is already pre-installed and full tested. If you have any question, please contact us through the email address provided at the end of manual.

Q&A.

a

HOW TO CHANGE THE CALIBER

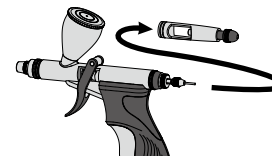

[1] Remove the handle.

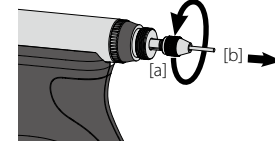

[2] Loosen the needle chucking nut[a], pull out the needle[b].

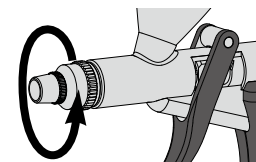

[3] Remove the air cap and nozzle cap.

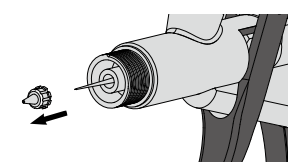

[4] Remove the nozzle.

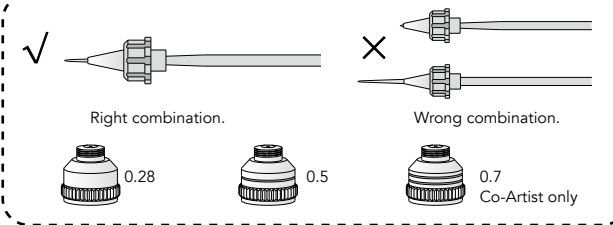

The package includes multiple sets of needles and nozzles of different sizes. Incorrect matching may result in either excessive needle exposure or inadequate exposure. Please ensure to store them separately.

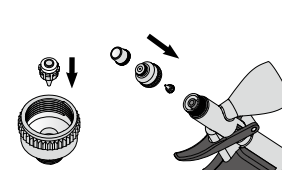

[5] Put the nozzle, nozzle cap and air cap back.

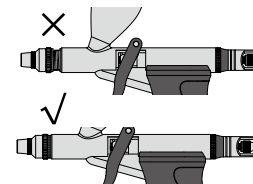

[6] Please tighten the nozzle cap.

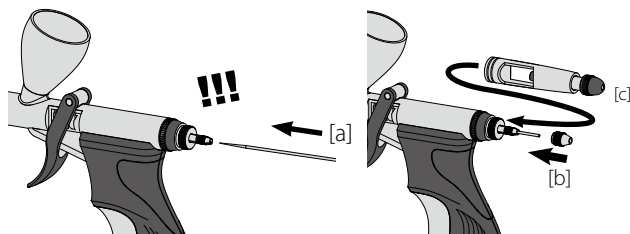

[7] Reinstall the needle[a], needle chucking nut[b] and handle[c]. Please avoid hitting the needle's front end.

b

WHEN AIR REVERSE FLOW INTO THE CUP



[1] The paint in cup start to bubble and even come out of the cup.

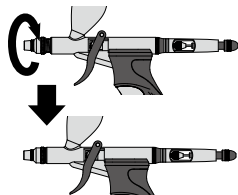

[2] Please try tighten the nozzle cap.

c

UNABLE TO SPRAY PAINT

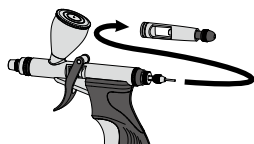

[1] Remove the handle.

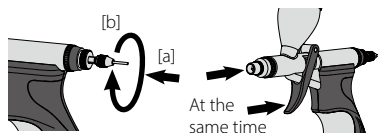

[2] Push the needle[a] to the leading end, then tighten the needle chucking nut[b]. Pull back the trigger to check whether the needle has moved.

d

WHEN THE MAIN LEVER CANNOT BE PULLED BACKWARDS

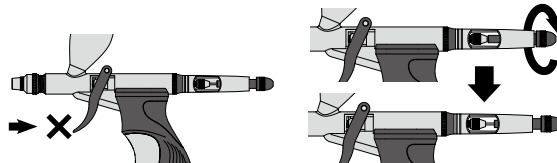

[1] Check whether the preset fluid control knob is too tight.

[2] If it still cannot be pulled, the paint may has dried inside. Deep cleaning is needed at this time.

e

e

DEEP CLEANING Please be careful !

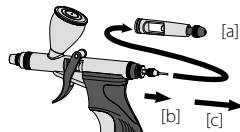

[1] Remove the handle[a] and loosen the needle chucking nut[b], pull out the needle[c].

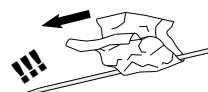

[2] Using airbrush cleaner to clean the needle.

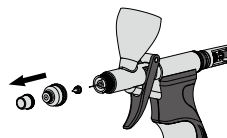

[3] Remove the air cap, nozzle cap and nozzle.

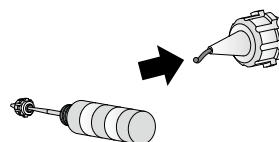

[4] Use the cleaning needle to clean the dry paint inside the nozzle.

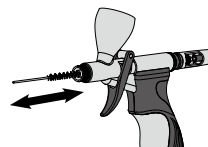

[5] Clean the inside of the airbrush.

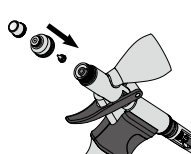

[6] Put the nozzle, nozzle cap and air cap back.

f

ADD LUBE

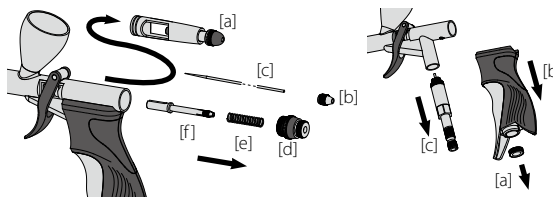

[1] Remove part[a] ~part[f]

[2] Unscrew the fixing nut[a] plastic handle[b], and valve[c].

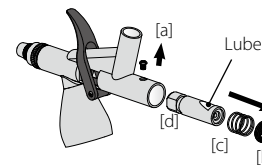

[3] Unscrew the small screw[a], spring case[b], spring[c] and slider[d], then apply a few drops of lube to the slider, then reassemble all parts in order.

Brand: Gaahleri
Product Name: Gravity Feed Airbrush
Company Name: Ningbo Gaile Network Technology Co., Ltd.
Store: Gaahleri airbrush store
Email Address: support@gaahleri.com

FOLLOW US on Twitter/Instagram/Facebook/YouTube: Gaahleri Studio

GAAHLERI