

# QUICK START GUIDE

Air Compressor GT-918

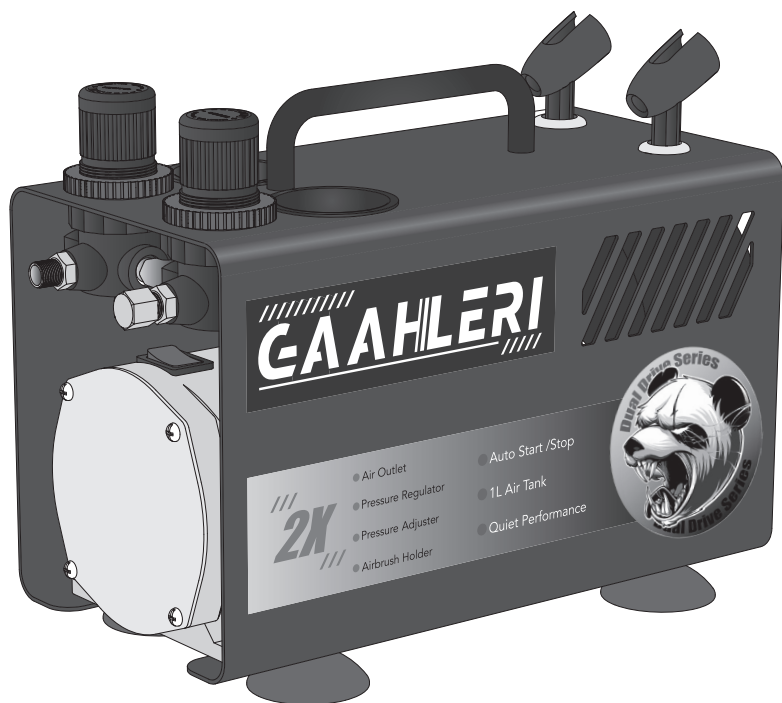

**GAHLERI**  
Dual Drive series

# CATALOGUE

## 01-PREPRATION

Safety Precautions	-----	1
Precautions for use	-----	1
Tool Accessories	-----	1

## 02-OPERATIONS

Operation for Air Compressor Set	-----	2
Featurse of Air Compressor Set	-----	2
Tool Features	-----	2

## 03-HOW TO USE

(1)Preparatory work	-----	3
(2)Connect the airbrush	-----	3
(3)Adjust pressure	-----	4
(4)Maximum pressure & Working pressure	-----	4
(5)Install / remove airbursh holder	-----	5
(6)Release water for the filter	-----	5

## 04-SPECIFICATIONS

Technical information	-----	6
-----------------------	-------	---

# PREPRATION



## SAFETY PRECAUTIONS

1. Do not touch the electrical source with wet hand.
2. Please follow local electrical rule and safety rule. Must use the grounded socket.
3. Never allow the children to touch the working machine ( NOT suitable for children under 13 years old. ), Never insert the stick into the machine.
4. Do not incinerate or mutilate Air Compressor Set, it may burst or release toxic material.
5. Do not attempt to disassemble the machine by yourself, if you have any questions, please contact the professionals to repair.
6. If the user don't use this product in a right way, it will damage the air compressor, and may hurt the user.



## PRECAUTIONS FOR USE

1. This air compressor is suitable for indoor use only. Never leave the appliance exposed to dust, acids, vapors, explosive or flammable gasses or atmospheric agents (rain, sun, fog, snow).
2. The air compressor must be used in suitable environments (well-ventilated, with an ambient temperature between +5°C and +40°C)
3. When finish the use of the air compressor, please turn it off.
4. After finishing the work, please clean the airbrush. Empty the moisture in air hose. And store all the tools in a ventilated and dry place.
5. After a long time of continuous using, the partial surface of air compressor will be hot. And it may be accompanied by peculiar smell. This is normal, do not worry. Do not touch the partial surface covered with Heat Warning. Especially for children.
6. If there is something abnormal happens, please disconnect the device and power supply immediately and contact our after-service with the Email address provided at the end of English Manual, we will respond the message as soon as possible.

## TOOL ACCESSORIES

- Gaahleri Air Compressor GT-918
- 1/8" BSP Hose with Length 6 Feet
- Airbrush Holder

# OPERATIONS

## OPERATION FOR AIR COMPRESSOR SET

1. Press the Power Switch to turn on/off the Air Compressor.
2. Auto start at 3BAR (43psi) & auto stop at 4BAR (57psi), air flow is up to 20-23L/min. Suitable for airbrush nozzle: 0.2mm~1.0mm.
3. GT-918 is equipped with 2 pressure regulators, which means you can install two airbrushes at the same time and adjust the air pressure for them separately.
4. Pull the Pressure Adjuster Knob up and rotate. Read from the Gauge and choose the level you need. Press the knob down to secure the pressure regulator.

## FEATURES OF AIR COMPRESSOR SET

- [1] Air Outlet Piston: GT-918 Air Compressor is equipped with 2 Pressure Adjusters, that means you could install two airbrushes on two air outlet pistons.
- [2] Pressure Gauge: This is a measuring instrument for knowing the instant working air pressure of Gaahleri Air compressor.
- [3] Pressure Adjuster: By pulling the knob up and rotating, you can adjust the air pressure required by each airbrush separately and read it from the instrument.
- [4] Air tank: GT-918 Air Compressor is equipped with an 1-Liter-Air tank, so the air flow could be more stable and durable.
- [5] Water Valve : Release the water in the air tank after use
- [6] Airbrush Holder : These holders can support one airbrush each.
- [7] Handle : Lightweight portable handle, it is convenient to carry or transport. The airbrush is suitable for indoor or outdoor use - anywhere you need it.
- [8] Anti-slip Base: Made with a rubber sucker design, the anti-slip base keeps the airbrush in place while reducing shaking and noise during operation.

## TOOL FEATURES

### Dual Drive series GT-918

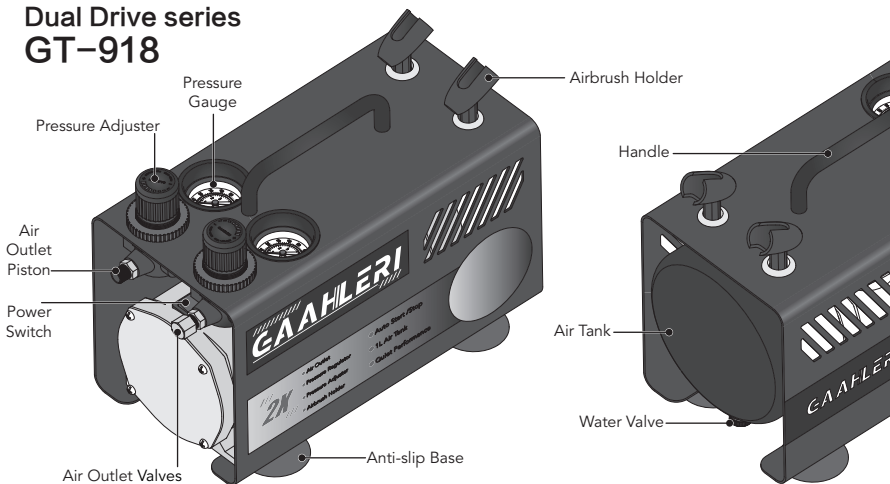

# HOW TO USE

1

## PREPARATORY WORK

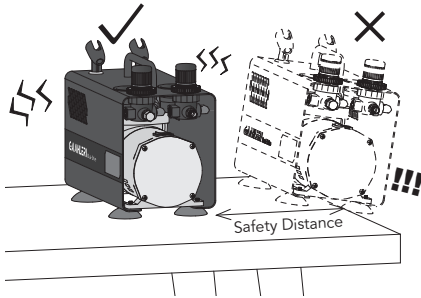

Place the Air Compressor on the ground. If you have to place it on the desktop, please keep away from the edge of the desktop to prevent the machine from accidentally falling by shaking.

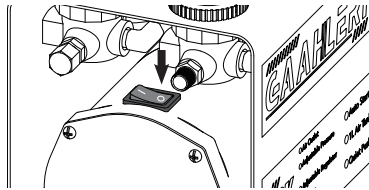

Make sure the switch is in the OFF. Plug into the mains supply. Please do not touch the electrical source with wet hand. Follow local electrical rule and safety rule. Must use the grounded socket .

2

## CONNECT THE AIRBRUSH

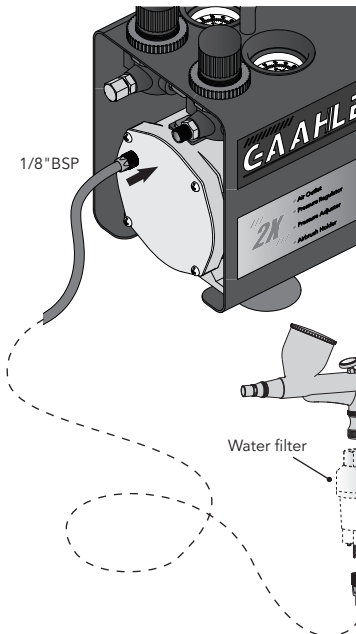

Note: Please keep the valves after unscrewing it to avoid loss.

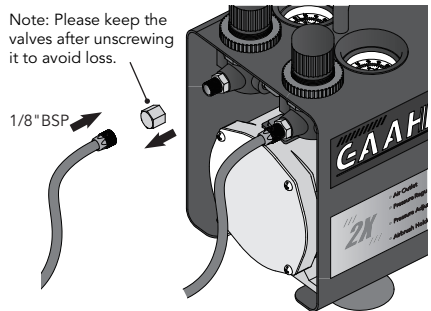

Connect the air compressor to airbrush with air hose. When only one airbrush is connected, please make sure that the another air outlet piston is bolted well with the valve. If you have a water filter, it can filter moisture from the air.

# 3

## ADJUST PRESSURE

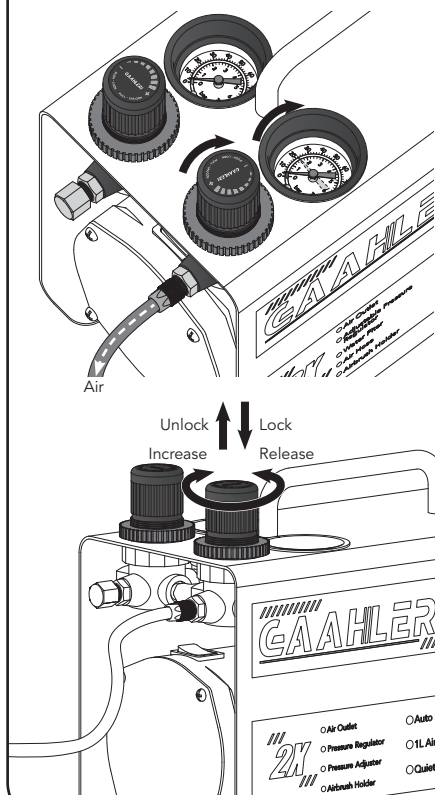

Turn on the switch, and then the air compressor will start work. The pressure gauge will show the current maximum pressure. This machine has automatic start & stop function to reduce heating and save energy.

Pull the Knob up to unlock pressure regulator. Turn clockwise to increase the pressure; Turn counter-clockwise to reduce the pressure. Press the Knob down to lock the pressure regulator. Do not turn the button when it cannot be adjusted.

If the pressure gauge value does not increase, check whether the air hose is tightened or whether the rubber ring inside the air hose connector has removed. When only one airbrush is connected, please make sure that the another air outlet piston is bolted well with the valve.

# 4

## MAXIMUM PRESSURE & WORKING PRESSURE

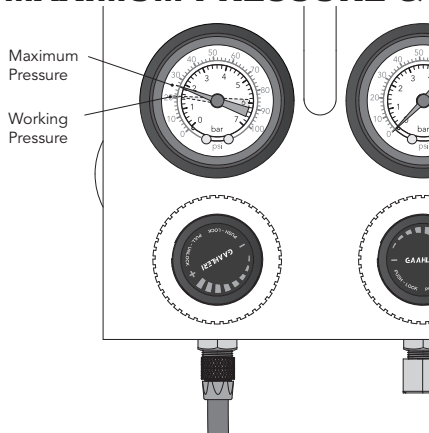

The "Maximum Pressure" is the highest pressure it can provide. When a connected airbrush is launching, the "MAXIMUM PRESSURE" is the pressure at which the compressed air is initially ejected through the airbrush. The "Working Pressure" is the constant pressure the compressor can maintain during airbrushing.

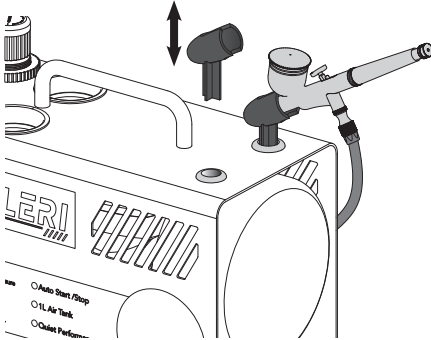
**5****INSTALL/REMOVE AIRBURSH HOLDER**

On the top of the Gaahleri GT-918 Air Compressor, you would find two places for installing the airbrush holder. You could choose to install the holders or not. This compact design saves space and makes your outdoor using or displacement of Air Compressor more comfortable and convenient.

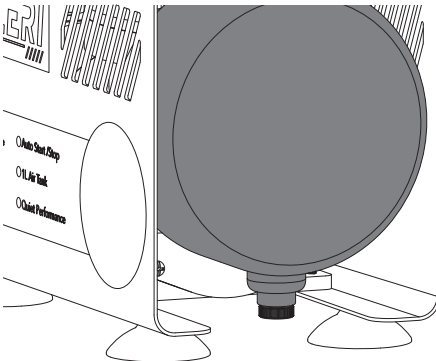
**6****RELEASE WATER FOR THE FILTER**

After a long term of using with Gaahleri Air Compressor GT-918, some water may accumulate in the Air Tank. Be careful, every time you want to loose the water valve, please make sure that the Pressure Air is already out of the air tank. ( We must turn off the compressor and than loose the air outlet piston )

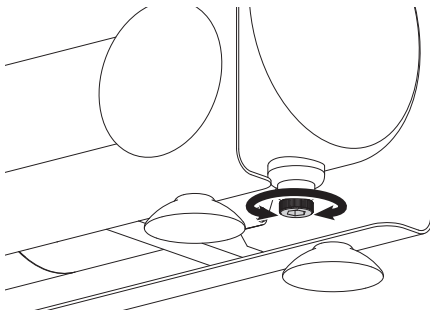

We suggest that loose the water valve at least one time every week or after a heavy duty use. Because too much water in the air tank would reduce the capacity of air tank. And too much water would also damage the air tank by rusting it from inside.

**Note:** A small allen wrench is recommended for screwing or unscrewing the water valve.

# SPECIFICATIONS

## TECHNICAL INFORMATION

---

TYPE: Double Pistons Air Compressor

POWER: 1/5 HP

SPEED: 1750 r.p.m

VOLTAGE: 110-120V/ 60Hz

PRESSURE:Auto start at 3BAR(43psi)

Auto stop at 4BAR(57psi)

AIR OUTPUT: 20-23L/min

SUITABLE FOR AIRBRUSH NOZZLE:0.2mm~1.0mm

LOW NOISE: 47 db

---



CE ROHS

# GAAHLERI

Brand : Gaahleri

Product Name: Double Pistons Air Compressor GT-918

Model:GT-918

Company Name: Ningbo Gaile Network Technology Co., Ltd.

Store: Gaahleri airbrush store

Email Adress : gaahleri@outlook.com

Follow Us on:Twitter/Instagram/Facebook/Youtube:

Gaahleri Airbrush