

QUICK START GUIDE

Air Compressor GT-820

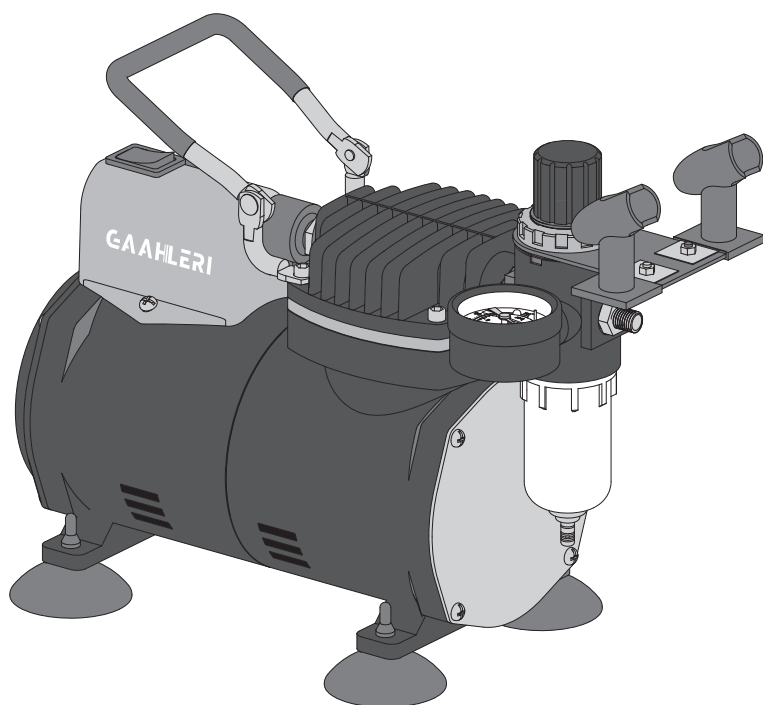

GAAHLERI
Ambition series

CATALOGUE

01-PREPRATION

Safety Precautions	-----	1
Precautions for use	-----	1
Tool Accessories	-----	1

02-OPERATIONS

Operation for Air Compressor Set	-----	2
Featurse of Air Compressor Set	-----	2
Tool Features	-----	2

03-HOW TO USE

(1)Preparatory work	-----	3
(2)Connect the airbrush	-----	3
(3)Adjust pressure	-----	4
(4)Maximum pressure & Working pressure	-----	4
(5)Install / remove airbursh holder	-----	5
(6)Release water for the filter	-----	5

04-SPECIFICATIONS

Technical information	-----	5
-----------------------	-------	---

PREPRATION



SAFETY PRECAUTIONS

1. Do not touch the electrical source with wet hand.
2. Please follow local electrical rule and safety rule, and must use the grounded socket.
3. Never allow the children to touch the working machine (NOT suitable for children under 13 years old.), Never insert the stick into the machine.
4. Do not incinerate or mutilate Air Compressor Set, it may burst or release toxic material.
5. Do not attempt to disassemble the machine by yourself, if you have any questions, please contact the professionals to repair.
6. If the user don't use this product in a right way, it will damage the airbrush compressor, and may hurt the user.



PRECAUTIONS FOR USE

1. This airbrush compressor is suitable for indoor use only. Never leave the appliance exposed to dust, acids, vapors, explosive or flammable gasses or atmospheric agents (rain, sun, fog, snow).
2. The air compressor must be used in suitable environments (well-ventilated, with an ambient temperature between +5°C and +40°C)
3. When finish the use of the air compressor, please turn it off.
4. After finishing the work, please clean the airbrush. Empty the moisture in air hose. And store all the tools in a ventilated and dry place.
5. If there is something abnormal happens, please disconnect the device and power supply immediately and contact our after-service with the Email address provided at the end of English Manual, we will respond the message as soon as possible.

TOOL ACCESSORIES

- Gaahleri Air Compressor GT-820
- 1/8" BSP Hose with Length 6 Feet
- Airbrush Water Filter
- Airbrush Holder

OPERATIONS

OPERATION FOR AIR COMPRESSOR SET

1. Press the [7] Power Switch to turn on/off the Air Compressor.
2. Auto start at 3BAR (43psi) & auto stop at 4BAR (57psi), air flow is up to 20-23L/min. Suitable for airbrush nozzle: 0.2mm~1.0mm.
3. Pull the [8] Knob up and rotate. Read from the [9] Gauge and choose the level you need. Press the knob down to secure the pressure regulator.

FEATURES OF AIR COMPRESSOR SET

1. Connection (1/8" BSP)
Connect the air compressor to airbrush with air hose. This air compressor outlet is 1/8" BSP.
2. Water Filter
The Filter assisting in furnishing clean, dry and regulated air.
3. Airbrush Holder
This holder can be affixed to the pressure valve and supports two airbrushes.
4. Dissipation Fan
Equipped with a dissipation fan to release the heat and reduce the temperature when the machine is working.
5. Portable Handle
Lightweight with a 180° portable handle, it is convenient to carry or transport. The airbrush is suitable for indoor or outdoor use--anywhere you need it.
6. Anti-slip Base
Made with a rubber sucker design, the anti-slip base keeps the airbrush in place while reducing shaking and noise during operation.

TOOL FEATURES

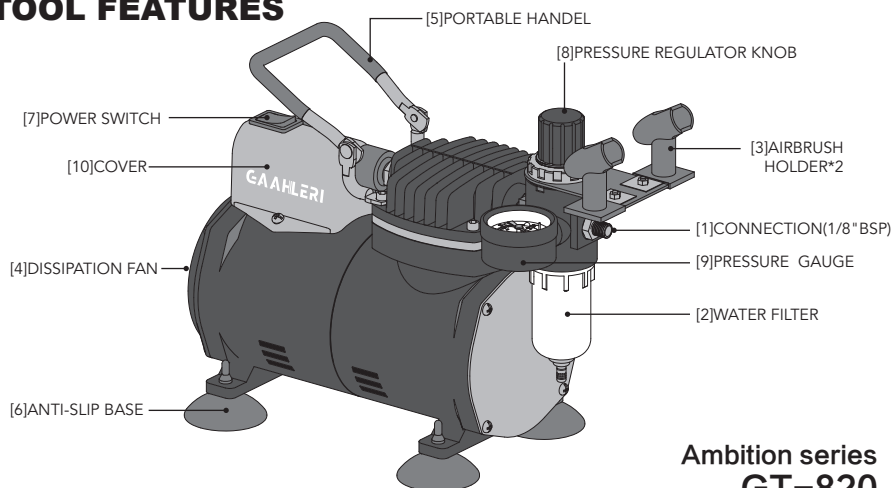

**Ambition series
GT-820**

HOW TO USE

1

PREPARATORY WORK

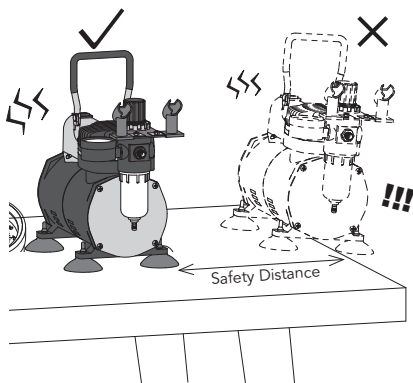

Place the Air Compressor on the ground. If you have to place it on the desktop, please keep away from the edge of the desktop to prevent the machine from accidentally falling by shaking.

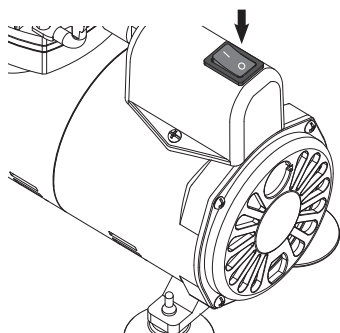
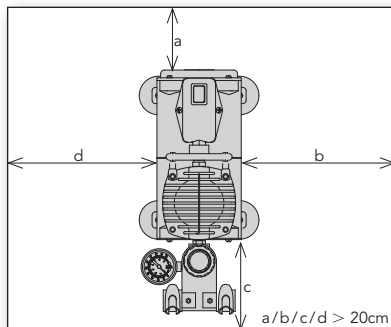

Make sure the switch is in the OFF. Plug into the mains supply. Please do not touch the electrical source with wet hand. Follow local electrical rule and safety rule. Must use the grounded socket.

2

CONNECT THE AIRBRUSH

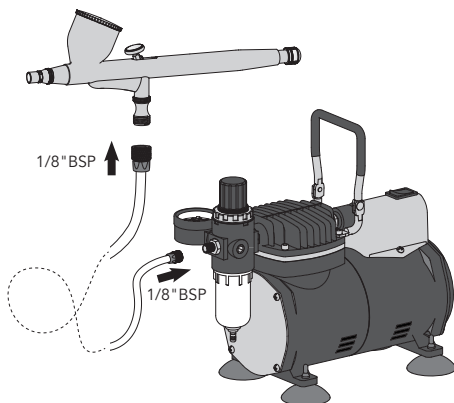

Connect the air compressor to airbrush with air hose. Usually our air compressor outlet is 1/8" BSP. If you want 1/4" BSP or other NPT screw thread, you may need other adapters attach to the outlet. Then you can connect with different air hoses.

3

ADJUST PRESSURE

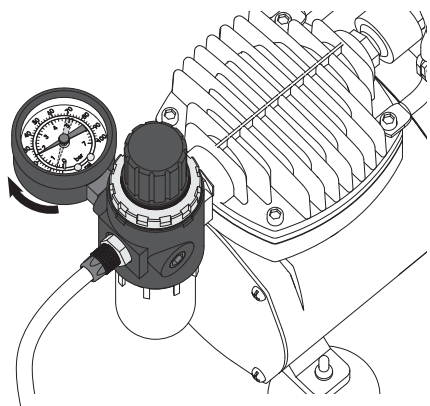

Turn on the switch, and then the air compressor will start work. The pressure gauge will show the current maximum pressure. This machine has automatic start & stop function to reduce heating and save energy.

If the pressure gauge value does not increase, check whether the air hose is tightened or whether the rubber ring inside the air hose connector has removed.

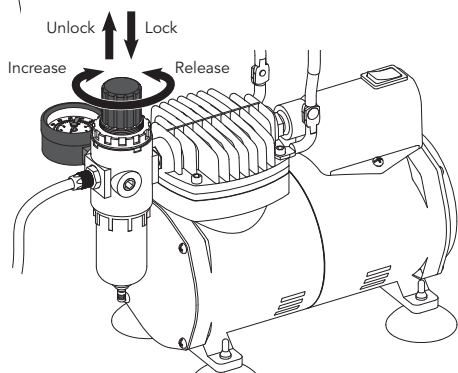

Pull the Knob up to unlock pressure regulator. Turn clockwise to increase the pressure; Turn counter-clockwise to reduce the pressure. Press the Knob down to lock the pressure regulator. Do not turn the button when it cannot be adjusted.

4

MAXIMUM PRESSURE & WORKING PRESSURE

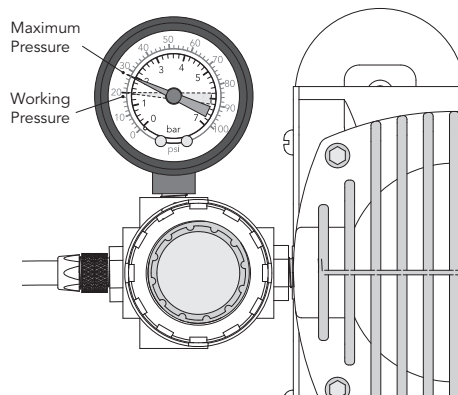

The "Maximum Pressure" is the highest pressure it can provide. When a connected airbrush is launching, the "MAXIMUM PRESSURE" is the pressure at which the compressed air is initially ejected through the airbrush. The "Working Pressure" is the constant pressure the compressor can maintain during airbrushing.

5

INSTALL/REMOVE AIRBURSH HOLDER

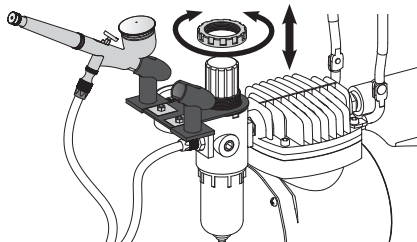

This holder can be affixed to the pressure valve and supports two airbrushes. This compact design saves space and makes it convenient to use and is a necessary accessory for all users.

6

RELEASE WATER FOR THE FILTER

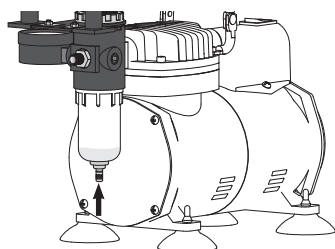

The Filter assisting in furnishing clean, dry and regulated air. If there is some water in the Filter, press the bottom button to release the water. Please note that this operation can only be done after the power supply of the air compressor is turned off and the air pressure is discharged.

SPECIFICATIONS

TECHNICAL INFORMATION

TYPE: Single Cylinder Piston Compressor

POWER: 1/5 HP

SPEED: 1750 r.p.m

VOLTAGE: 110-120V/ 60Hz

PRESSURE: Auto start at 3BAR(43psi)

Auto stop at 4BAR(57psi)

AIR OUTPUT: 20-23L/min

SUITABLE FOR AIRBRUSH NOZZLE: 0.2mm~1.0mm

LOW NOISE: 47 db



CE ROHS

GAAHLERI

Brand : Gaahleri

Product Name : Single Cylinder Piston Compressor GT-820

Company Name : Ningbo Gaile Network Technology Co., Ltd.

Store : Gaahleri airbrush store

Email Adress : gaahleri@outlook.com

Follow Us on : [Twitter](#)/[Instagram](#)/[Facebook](#)/[Youtube](#):

Gaahleri Airbrush