

SPECIFICATION

NEXLEDS[®]
NEXLEDS LTD

4"



Intertek
5019904



WIFI
ENABLED



APP
CONTROL



LUMINOUS



RGB+
WW+CW



APP
DIMMER



CRI(Ra)
80+



Damp
Location

COLOR Changing
RGB+2700~6500K



Smart LED Gimbal Downlight

NXW504WE1WH-10 10W

Specification

Product Name :	Smart LED Gimbal Downlight
Model NO. :	NXW504WE1WH-10
Specification :	AC120V,60Hz;92mA;10W
Working Temp :	-20-40(°C)
Power Factor :	0.9
CRI(ra) :	>80
Body Color :	White
Light Source :	San'an SMD Chip
Lumen :	800 lm
Life Time :	35000 hrs
Beam Angle :	40°
Adjustable Angle:	360°
Product Size :	4 inch
Cut Out :	108mm~110mm
IP :	Damp Location
Application :	Home, Shop, Hotel
Warranty :	5 years
Standard :	ETL
Dimmable :	5%~10% dimming
Color Temp :	RGB+2700K-6500K



www.nexleds.ca



Email: sales@nexleds.ca

NEXLEDS[®]

NEXLEDS LTD

Feature:

1. Mobile phone voiced intelligent control home light-ing,light scene optional choice Changing the tempera-ture and luminance of light by APP.
2. Cell-phone Control: Open the remote control APP, enjoy a new lifestyle instead of "get up to turn off lights"or"forget to turn off lights".
3. On/off, timing, brightness adjustment, mode selection,color switching.
4. Wireless module connection, safe and reliable, ultralow power consumption.
5. Built-in global cloud service , extremely reliable system deployment architecture, uninterrupted continuous service time 99 . 99%.
6. Top level information security.

Product Dimension

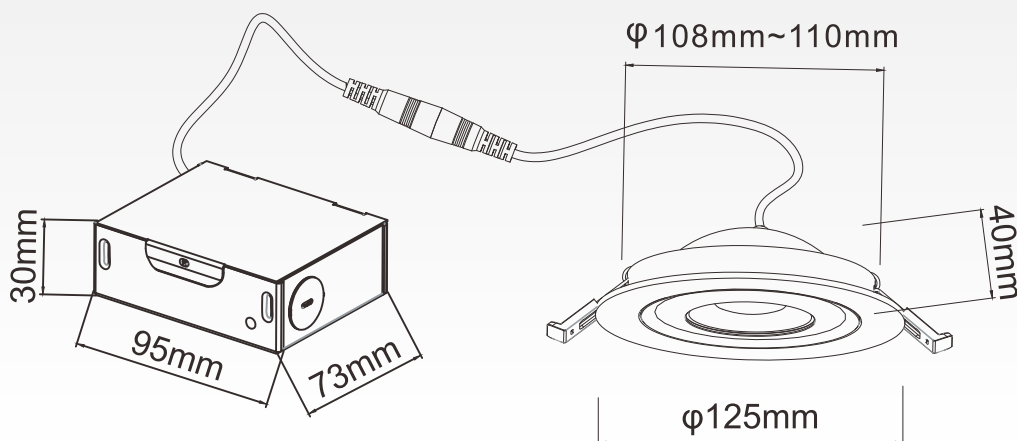

Description:



This ultra thin recess light is a 10 watt 4" slim profile light fixture for recess retrofit application. It is a high performance, easy to install residential grade downlight solution that offers good light output, energy efficiency and stream lined design, Suitable for damp locations.

APP Control:



- APP CONTROL
- WIFI ENABLED
- 16 MILLION COLORS
- COOL & WARM
- TIMER
- INTELLIGENT SCENE
- VOICE CONTROL
- SHARE ACCESS



- APP CONTROL
- WIFI ENABLED
- 5-100% DIMMING
- COOL & WARM
- TIMER
- INTELLIGENT SCENE
- VOICE CONTROL
- SHARE ACCESS

Installation:



Find out the template (for the hole size installation) back of the box. Use the circle template to measure the size of holes. Then cut out holes.

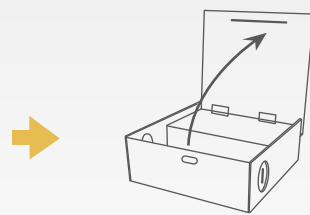

Open the box. Take out accessory of wire clip.

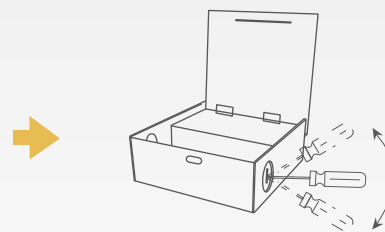

Use suitable tool to remove one of the knockouts of the side plate.

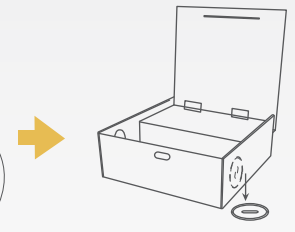

Remove one of the knockouts on the side plate. Put wires through the hole.

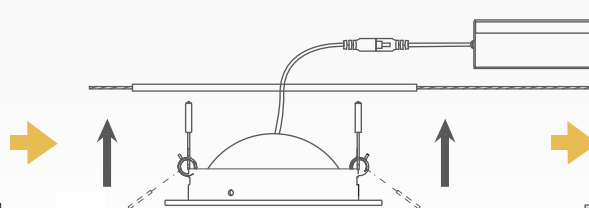
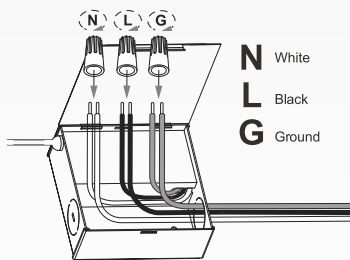

Holdin g the clips, and push the fixture into installation hole.

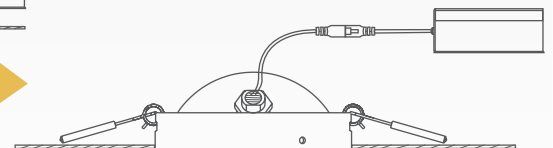

Release spring clips and push into place.