

# ELETRICAL KETTLE

CEK-206

## Quick Start Guide

This Quick Start Guide is designed for first time use.  
For safety and more information, refer to your USER MANUAL.

### A PRODUCT DIAGRAM

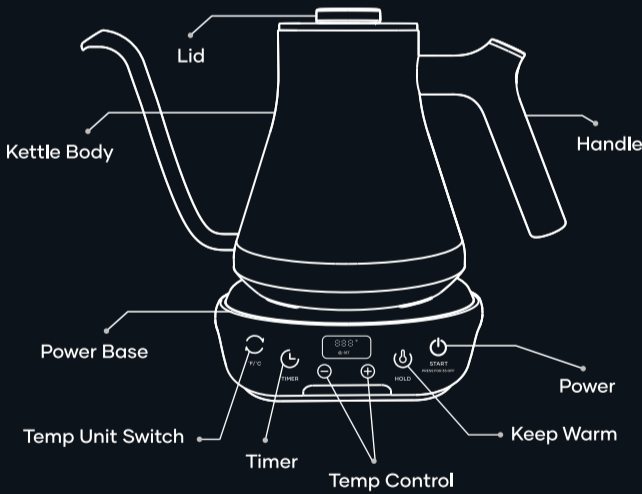

#### Package Contents

- Gooseneck Kettle × 1
- Power Base × 1
- Quick Start Guide × 1
- Warranty Card × 1



Do not wash jug exterior under running water.



Never immerse jug in water or place in dishwasher.



To prevent an electrical hazard, please refer to the cleaning instructions in the USER MANUAL.

### B OPERATION GUIDE

#### NOTE:

Please clean the kettle by boiling water 3 times before using it.



1. Add water to the kettle. Do not exceed the maximum water mark.

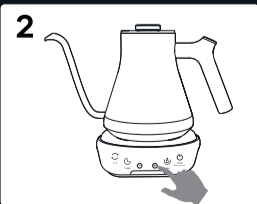

2. Click "+" "-" to adjust the preset temperature to the temperature you need.



3. Press the "START" to start. The power button lights up red when heating.

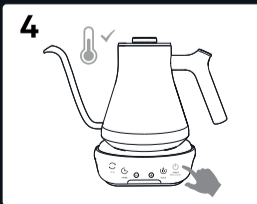

4. Once desired temperature is reached, the power button light will turn back to white.