

COMPONENT

1



X8

2



X10

3



X4

4



X14

5



X4

6



X6

7



X4

8



X1

P1



X2

P2



X1

P3



X2

P4



X2

P5



X2

P6



X1

P7



X2

P8



X2

P9

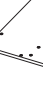

X1

P10



X1

P11

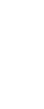

X2

P12

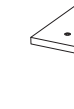

X1

Caution: This instruction manual is intended for universal reference, slight variations in part dimensions are normal.
(Manual Number:602-09-0605)

1

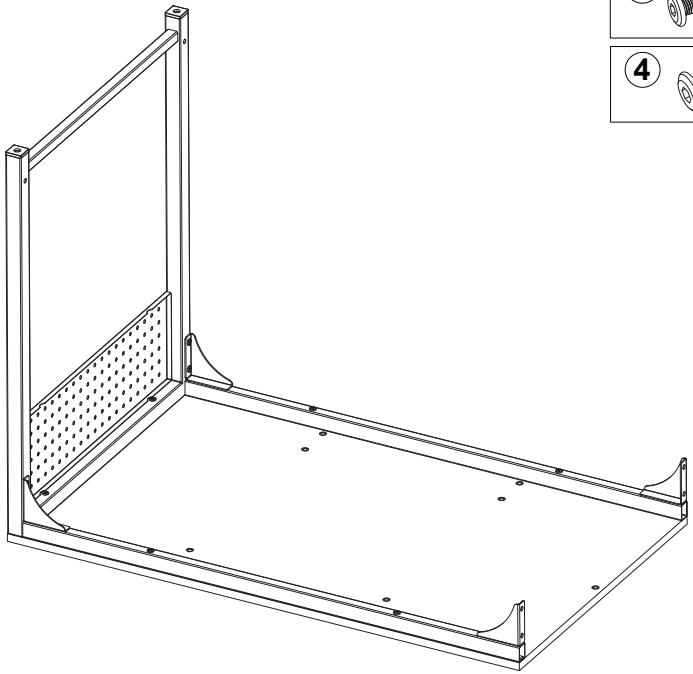
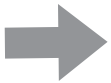
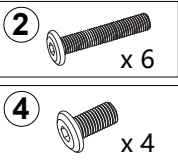
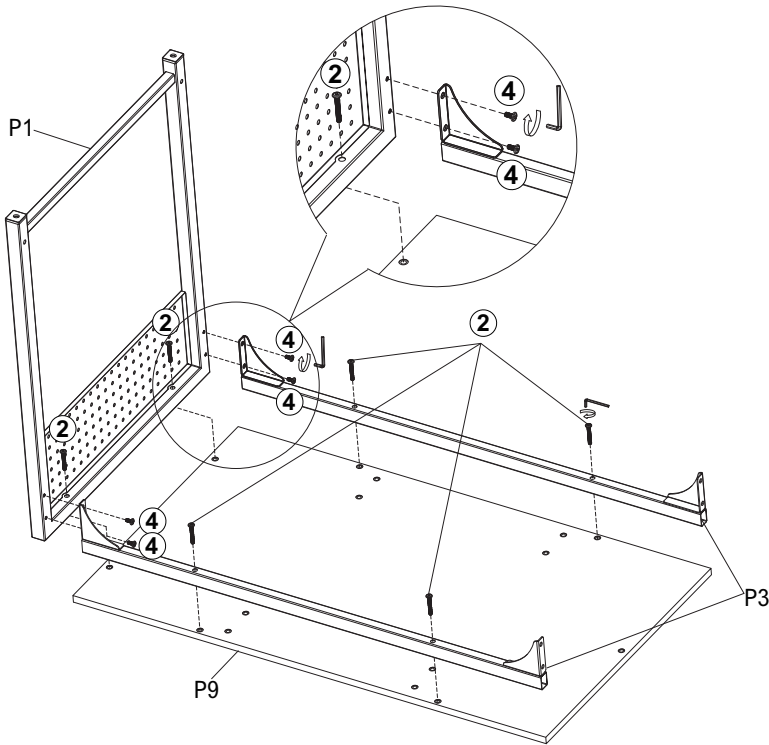

2

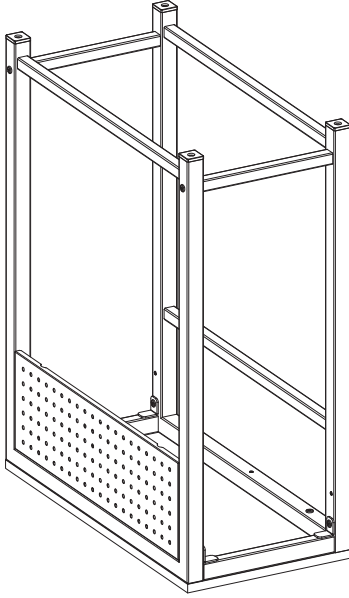
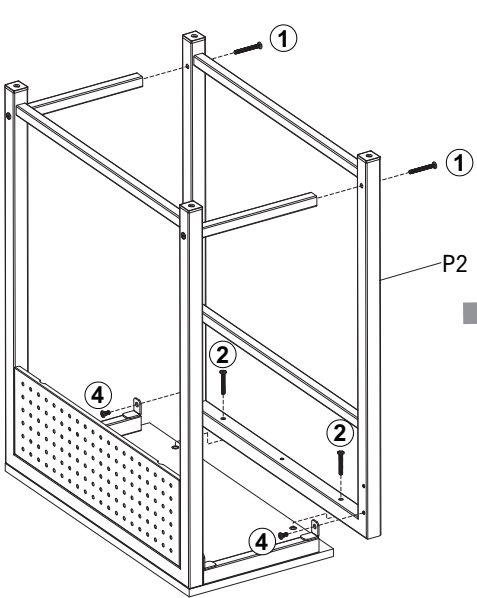
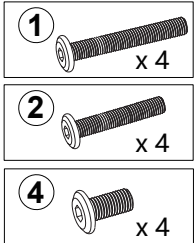
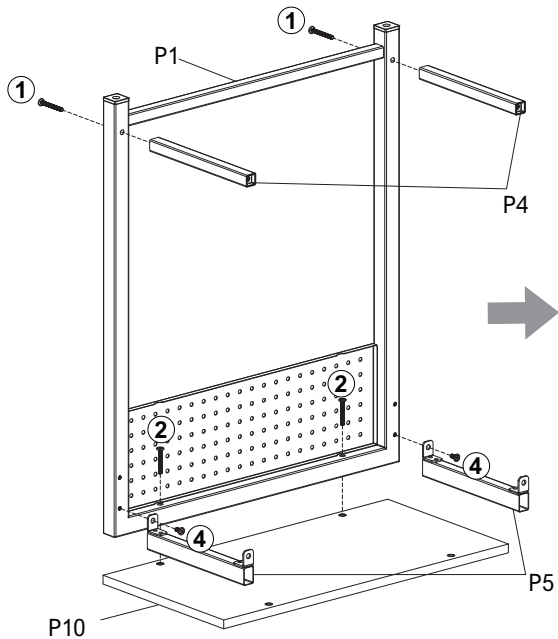

3

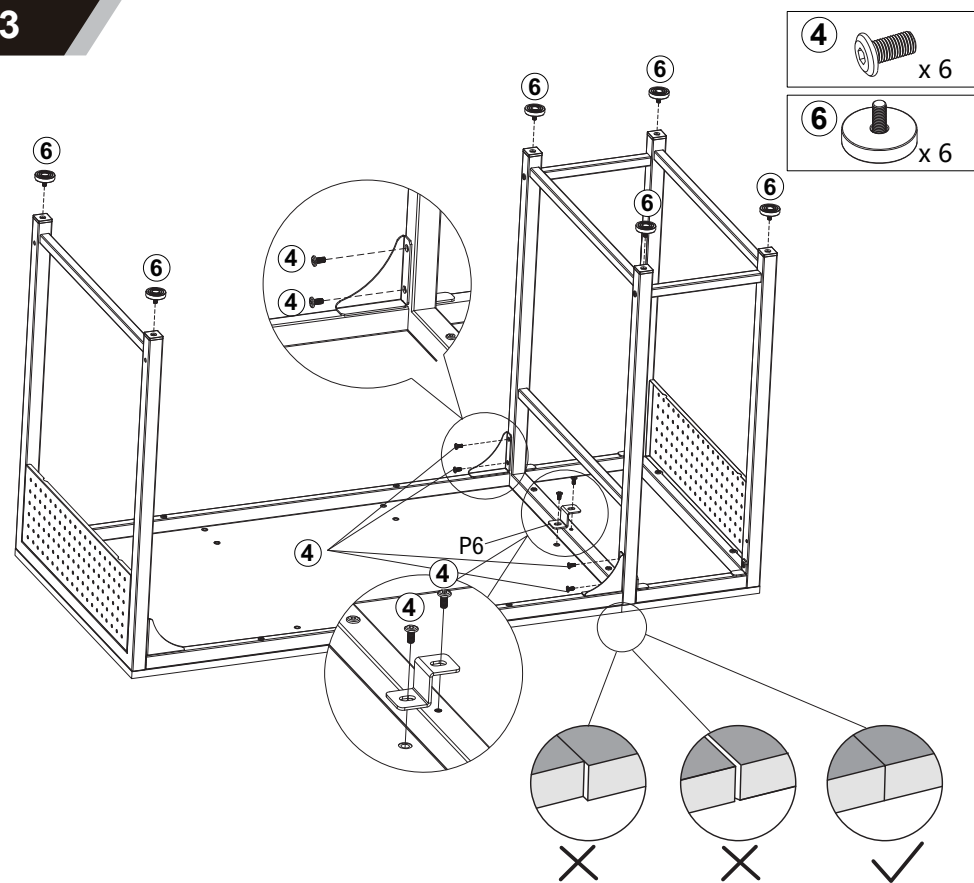

! Before tightening the screws, you must ensure that the two desktop pieces are aligned and flush against each other.

4

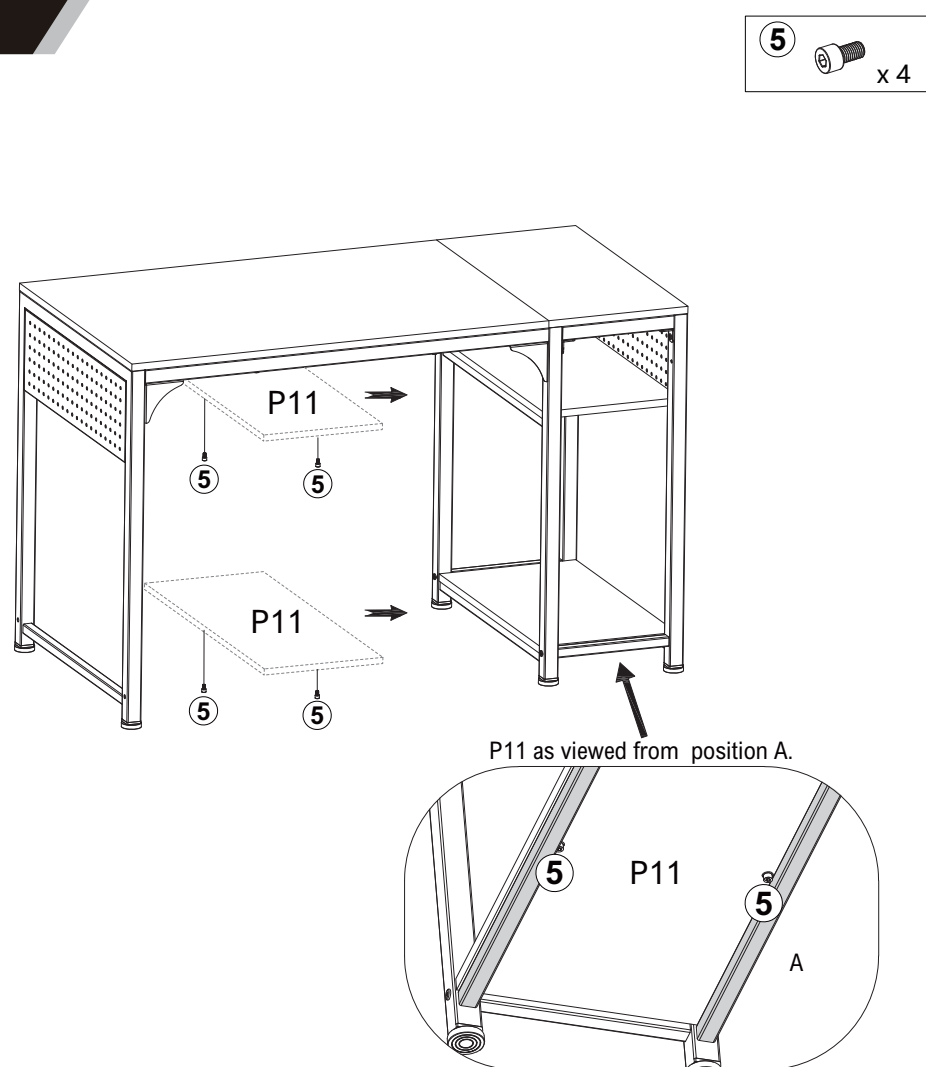

5

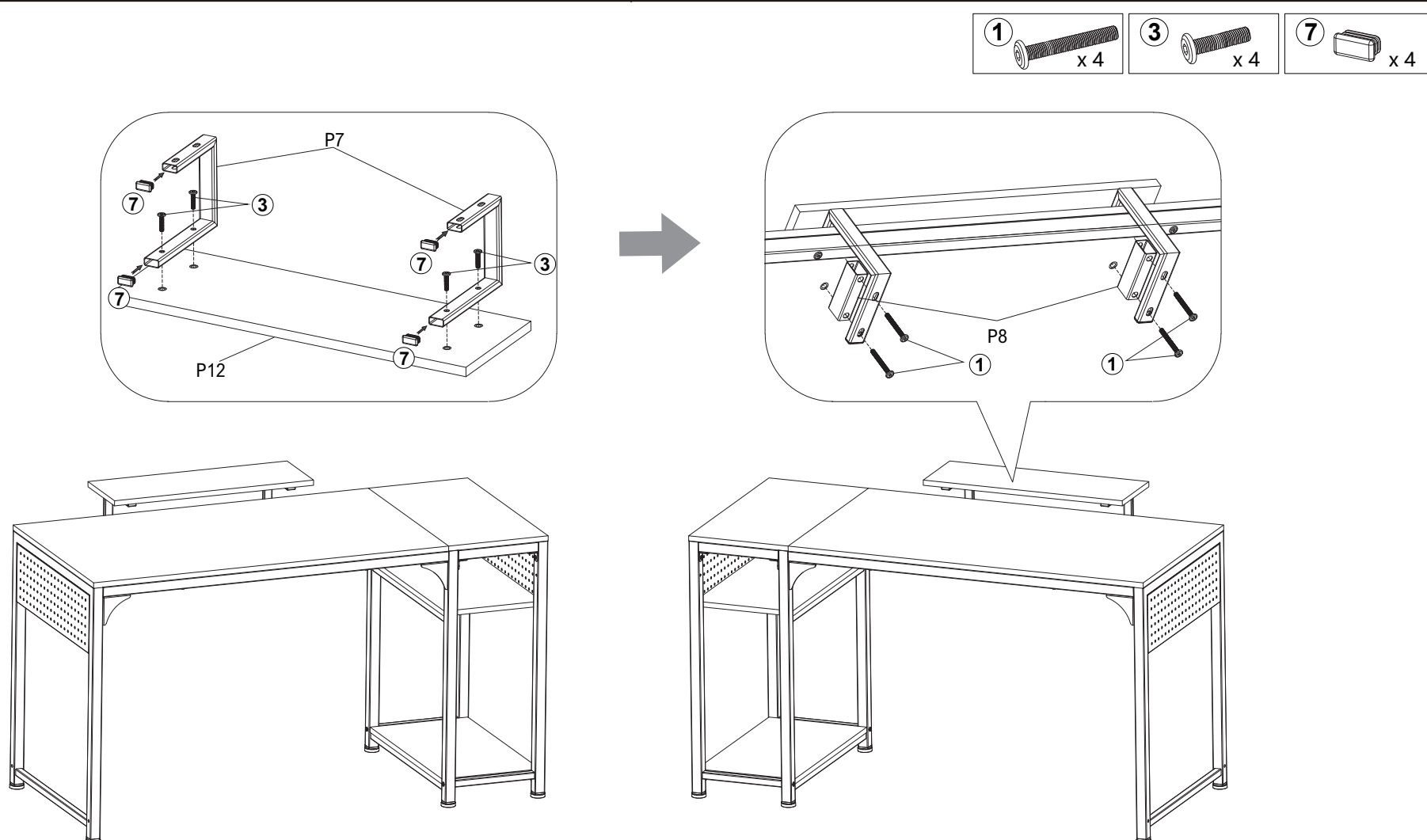

ACCESSORY

