



Our products
BASIC Time To Run The Show In Your House
 Available in a variety of styles, meeting your daily and special needs. Perfect for adding certain ambience to the space, making you the master of all occasions that require lighting.

SMART HUE-Sync With You
 Developed to meet the needs of young people, this collection introduces more fascinating color and more intelligent control experience. It not only syncs with music but syncs with you.

PREMIUM-This Is What Your Life Should Be
 This collection provides more textured lighting products to meet your rigorous needs. Perfect for elevating your beloved space and rooms to a premium level.

②

Christmas tree light instructions



- (1) Unpack to confirm whether all accessories are complete:
 A pentagram, A pentagram connecto
 A string of LED lights, A power adapter
 An infinite remote control, a manual
- (2) Hang the light string on the top of the Christmas tree, untie the rope at the bottom, and arrange the light bars in an orderly manner. This step must be patient to avoid the light bars from knotting.
- (3) Finally, install the five-pointed star on the top of the Christmas tree, and then turn on the power.

★ Before using this product, you need to equip yourself with a Christmas tree of the corresponding height.

- (1) Search for iDeal Led on the App Store for Apple mobile phones, and search for iDeal Led on Google Play for Android phones
- (2) Use the mobile browser to scan the QR code, go directly to the download page, and select and install the APP according to the mobile phone type.
- (3) When installing the APP for the first time, the option "Do you allow browser" to install apps? will appear, please check the "Allow".

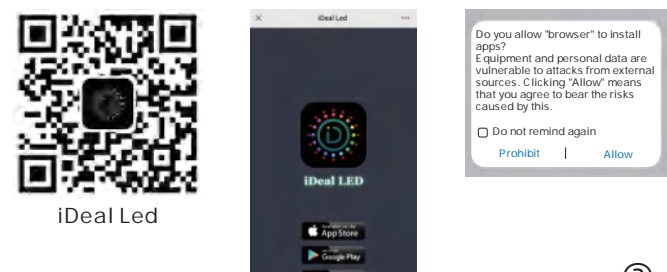

③

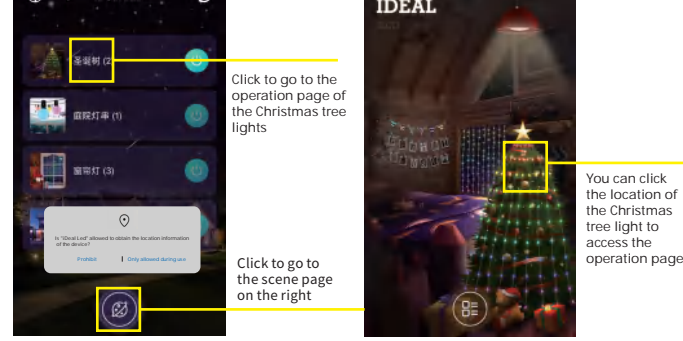

Note: When you first enter APP, is the "iDealLed" option available to get device location information? Will emerge. Please select Allow only when in use.

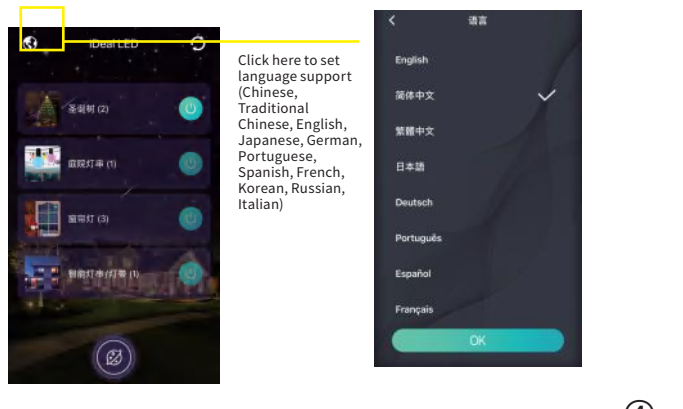

④

- First of all, you must turn on the wireless and location functions of your mobile phone.
- Open the APP and click the button ① to connect to the Christmas tree light.
- Click button ② and swipe to the right to indicate that the connection is successful
- Click button ③ to enter the light color adjustment interface.
- Click the button ④ to enter the dynamic effect display interface.
- Click button ⑤ to enter the text input interface.
- Click the button ⑥ to enter the picture and animation playback interface.
- Click the button ⑦ to enter the DIY interface.
- Click button ⑧ to enter the music rhythm and sound control interface.
- Click button ⑨ to enter the timer function interface.
- Click on the button ⑩ enter setup lamp bead color correction, and undertake lamp bead color correction, And the electronic instructions.
- Click button ⑪ to control the on and off of the light string system.
- Click button ⑫ to refresh the device
- Click button ⑬ to customize the name

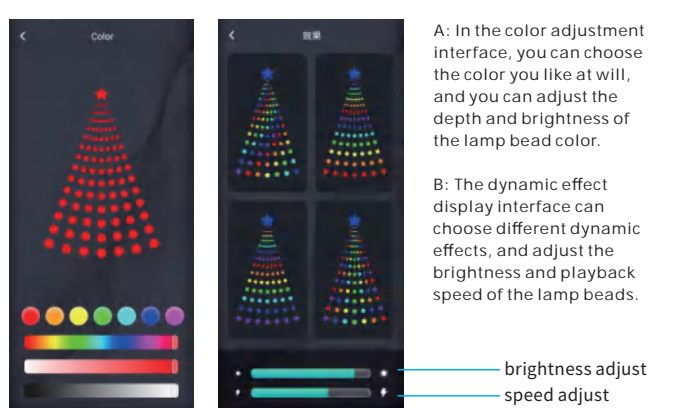

A: In the color adjustment interface, you can choose the color you like at will, and you can adjust the depth and brightness of the lamp bead color.

B: The dynamic effect display interface can choose different dynamic effects, and adjust the brightness and playback speed of the lamp beads.

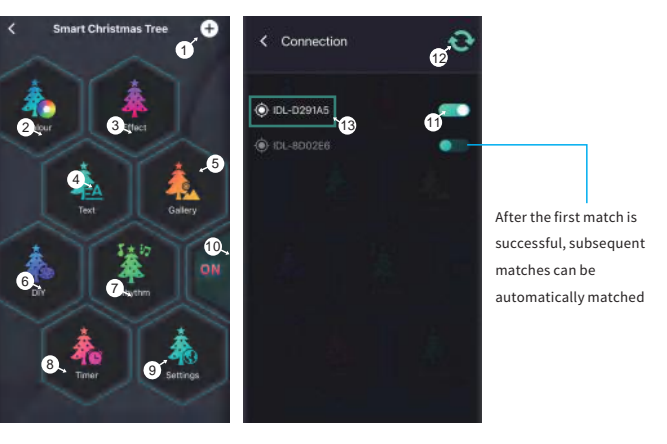

After the first match is successful, subsequent matches can be automatically matched

⑤

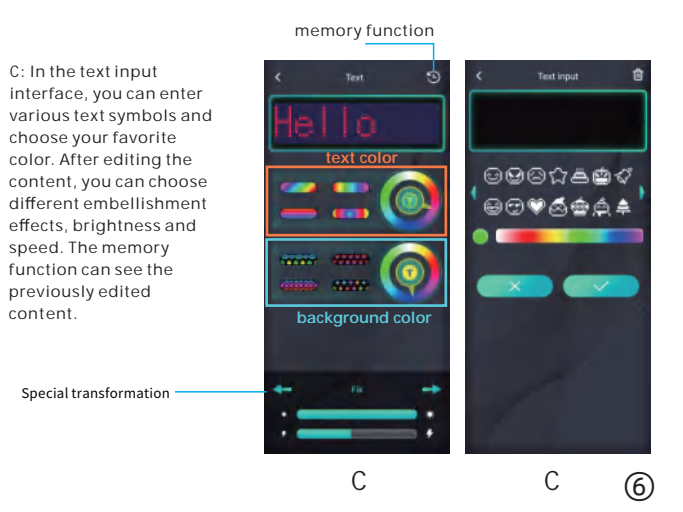

A: In the text input interface, you can enter various text symbols and choose your favorite color. After editing the content, you can choose different embellishment effects, brightness and speed. The memory function can see the previously edited content.

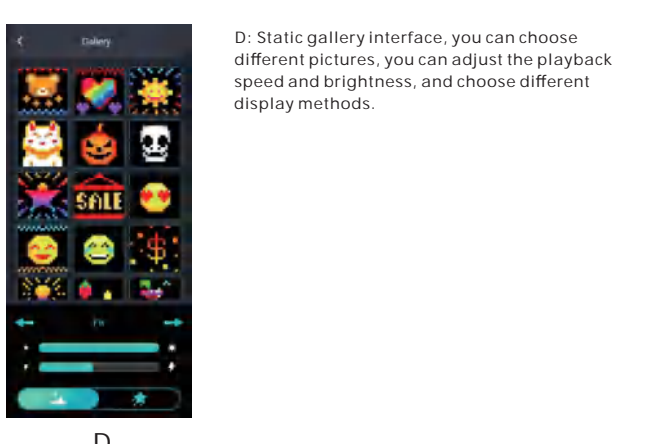

D: Static gallery interface, you can choose different pictures, you can adjust the playback speed and brightness, and choose different display methods.

D

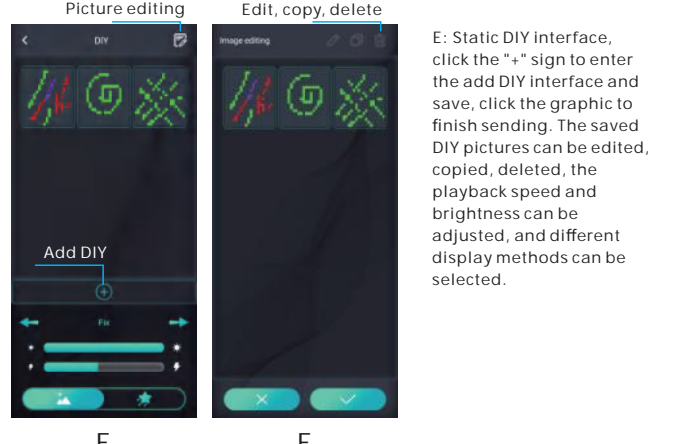

E: Static DIY interface, click the "+" sign to enter the add DIY interface and save, click the graphic to finish sending. The saved DIY pictures can be edited, copied, deleted, the playback speed and brightness can be adjusted, and different display methods can be selected.

E

E

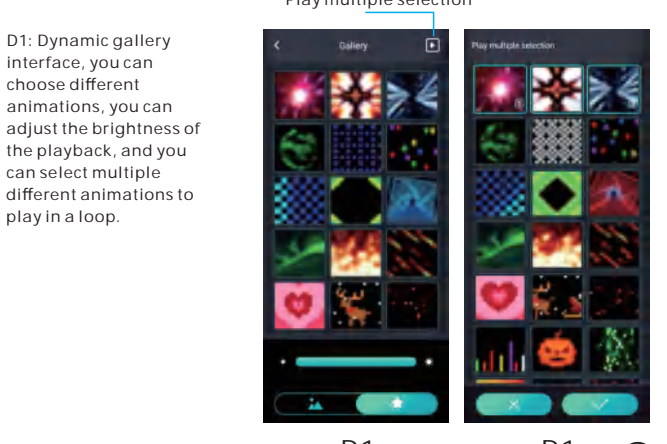

D1: Dynamic gallery interface, you can choose different animations, you can adjust the brightness of the playback, and you can select multiple different animations to play in a loop.

D1

D1

⑦

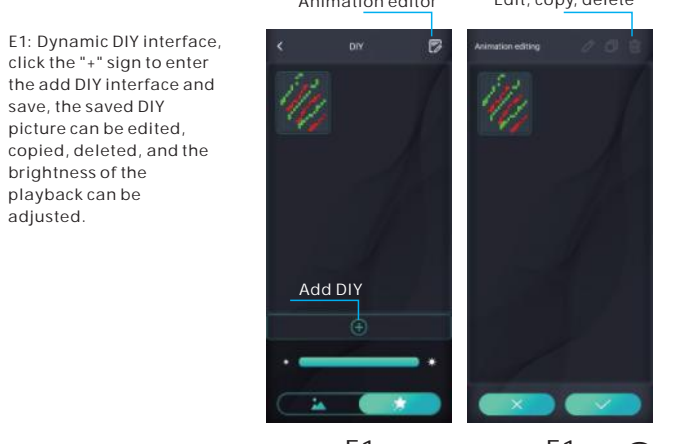

E1: Dynamic DIY interface, click the "+" sign to enter the add DIY interface and save, the saved DIY picture can be edited, copied, deleted, and the brightness of the playback can be adjusted.

E1

E1

⑧

F: Music rhythm interface. The APP will read the songs in the phone. When playing music, the Christmas tree lights will be rhythmic according to the melody of the song. You can also choose different rhythm modes.

F1: Turn on the microphone mode of the phone, the phone will recognize the surrounding sounds, and the Christmas tree lights will be rhythmic according to the volume, and you can choose different rhythms.

F2: Turn on the microphone mode of the Christmas tree lights. The sound control module of the Christmas tree lights will recognize the surrounding sounds and perform rhythmic motions according to the volume.

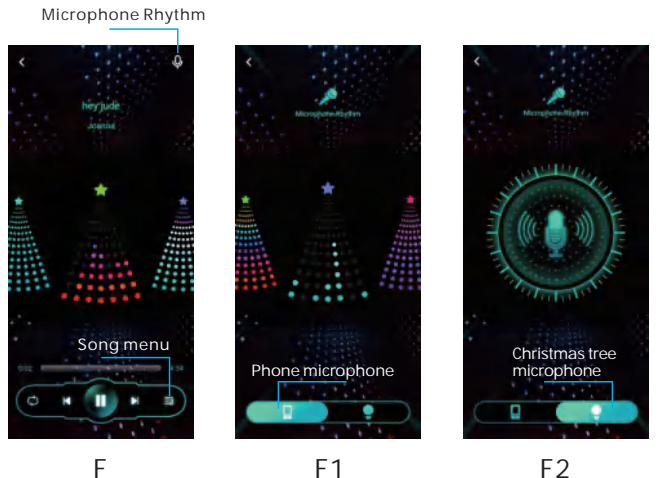

F

F1

F2

Note: The following dialog box will appear when you use the APP for the first time, please check "Allow" and proceed.

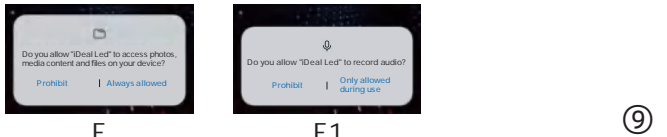

F

F1

⑨

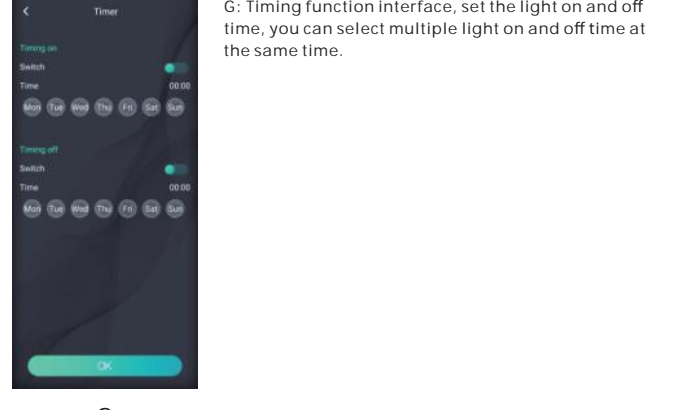

G: Timing function interface, set the light on and off time, you can select multiple light on and off time at the same time.

G

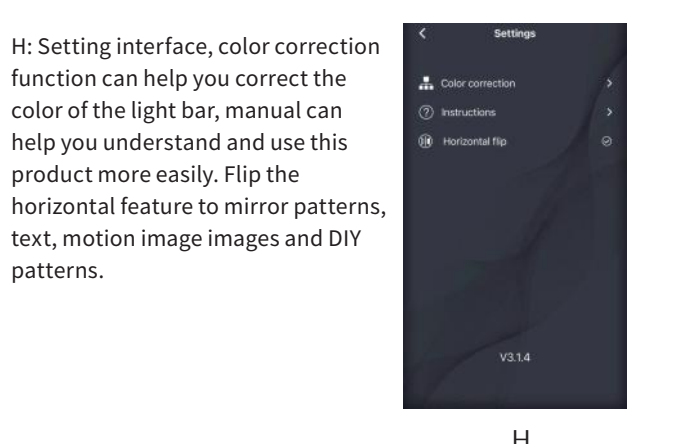

H: Setting interface, color correction function can help you correct the color of the light bar, manual can help you understand and use this product more easily. Flip the horizontal feature to mirror patterns, the horizontal feature to mirror patterns, the horizontal feature to mirror patterns, the horizontal feature to mirror patterns.

H

⑩

Remote control manual

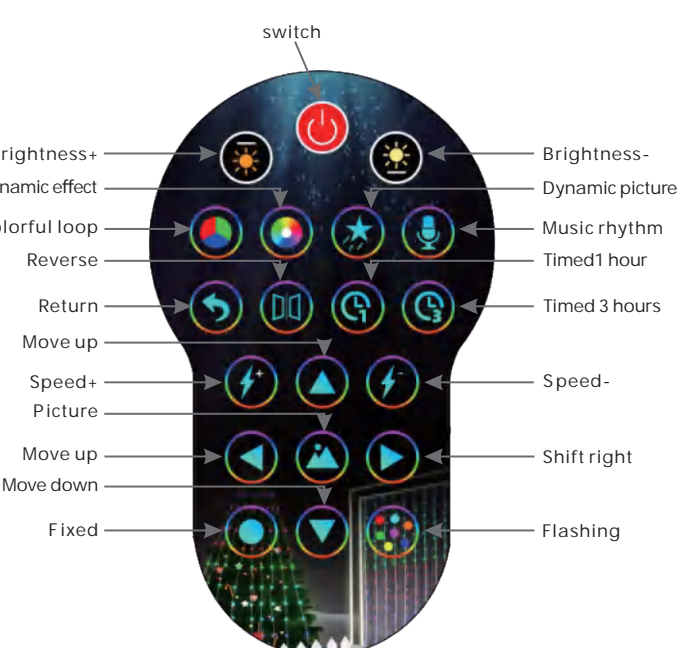

Notice:
 Do not use this product in water.
 Do not place this product near a fire source.
 If you do not use this product for a long time, you should cut off the power and place it in a cool and dry place.
 Please pay attention to children 0-6 to prevent accidental ingestion of accessories during play.
 Do not switch frequently, so as not to affect the life of the product.
 Do not disassemble this product privately. If there is a knot during use, please do not pull it vigorously.
 If the product cannot be used normally, please cut off the power first and contact the after-sales team for processing.
 We will test each set of products before shipment, but there may be damage during transportation. Please test after receiving the product. If you encounter any problems, please contact us in time, we will find the best solution.

About the crossed-out wheeled bin
 It is the WEEE symbol which indicates that this product is not home waste. You protect the environment when you recycle hazardous waste appropriately. In order to get detailed information about recycling this product please contact your retailer or a local authority.



iDeal Led
 CE RoHS
 FC ID:2A5NB-HCL-001
 MADE IN CHINA

⑪

⑫