

LED Loading Dock Light





DESCRIPTION

Romanso led loading dock light is designed for a variety of warehouse and work space conditions, led loading bay dock lights used to illuminate the full length of truck trailers.

These dock light fixtures increase safety during loading and unloading. The lamp can be run from AC100~277V supply through an integral transformer to DC24 Volts for added safety.



KEY FEATURE



20W/30W/40W/50W

- Using Epistar, high lumens up to 140LPW
- Safety yellow rugged cast aluminum housing
- Come with integral AC100~277v to DC24v transformer for safety operation
- Optional on/off switch if required
- 5ft(150cm) power cord end, optional US/EU/AU plug if required
- High light transmittance 30°PC lens, ideal for use in food warehouse
- Anti-corrosion stainless steel cage with good impact resistance
- High reliable constant current LED driver
- Available in multiple swing brackets optional
- ETL/cETL/FCC/CE/RoHS approved
- >50,000 hours lifespan, offer 5 years warranty

SPECIFICATION

Item NO.	Watt	Total Lumens	Beam Angle	LED Brand	CCT	Input Voltage	CRI	Power Factor	IP Rating
RMS-L200120	20W	2800LM± 10%	30°	Epistar	3000K 4000K 5000K 5700K 6500K	AC100~277v to DC24v transformer 50/60Hz	≥ 70+	≥ 0.9	IP65
RMS-L200130	30W	4200LM± 10%							
RMS-L200140	40W	5600LM± 10%							
RMS-L200150	50W	7000LM± 10%							

DIMENSION

Unit: inch/mm

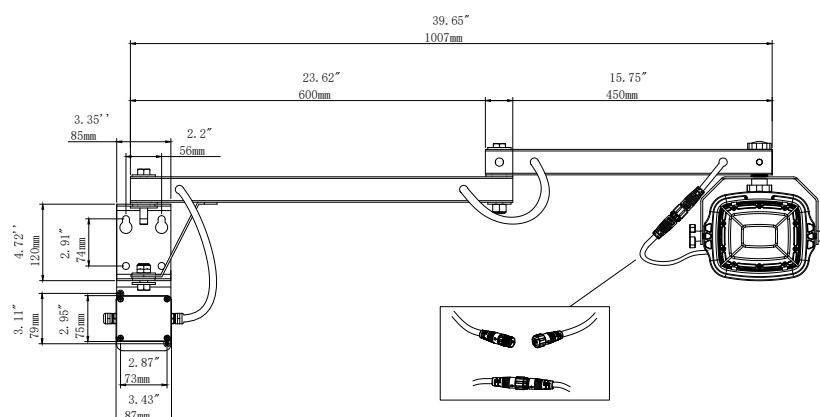



DETAILS

1/ Lumens effect up to 140LPW

Using Epistar, has a higher junction temperature, extend lifetime and lower light degradation.

EPISTAR



2/ 30° PC Lens

It is spot lighting for longer irradiation distance, suitable for illuminate the full length of truck trailers.



4/ Hand twists screw

Bracket is adjusted for different lighting direction by fixed screw



3/ Stainless steel cage

Durable design with good impact resistance, anti-corrosion



DC24V low-voltage protection from lamp head to bracket



225° vertical rotation



Weight capacity: 4kg



180° horizontal rotation



The lamp can be run from AC100~277V supply through an integral transformer to DC24 Volts for added safety.



Waterproof connectors between lamp head and arm brackets, ensure whole lamp can reach IP65 waterproof rated



360° horizontal rotation



APPLICATION

Applications include shipping and receiving loading docks, machine stations such as a stamping press, inspection stations, general work lighting, indoor and outdoor spot lighting, and other similar applications.

