

LUNAR 02



THE KEY IS ME

电池供电开关

电池供电开关在键盘底部，关闭电池供电，键盘仍可以在插线时使用无线与蓝牙模式。关闭电池供电时，电池仍然会充电，请放心我们做好了电池充电保护。

在一些特殊安检场合（如机场），请将开关拨到OFF档位，建议将本说明书共同携带以便于告知相关安检人员。乘坐飞机等情况可委托托运或随身携带请咨询当地工作人员。



有线连接模式

用数据线将键盘与设备连接好，按FN与/键切换至有线模式，或调节右侧旋钮通过屏幕选择连接方式为有线模式。



2.4G无线连接模式

打开电池供电开关，或用数据线将键盘与设备连接好。

按FN与*键切换至无线模式，*键1秒闪烁一次表示正在配对中。

当*键快速闪烁表示配对成功。若无法自动配对或配对超时，请按FN与*键3秒，直到*键指示灯将快速闪烁即进入配对模式，然后重新将无线接收器插入设备。

你也可以调节右侧旋钮通过屏幕选择连接方式为无线模式。在选择无线模式时按住旋钮即可进入配对模式。



BATTERY POWER ON/OFF SWITCH

The battery power on/off switch is located at the bottom of the keyboard, and if the battery power is turned off, the keyboard can still use 2.4Ghz wireless or the Bluetooth wireless modes. When connecting with the cable, the battery will still be in the charging mode when the batter power is turned off. Please be rest assured that we have taken care of battery charging protection.

In some special security inspection occasions (such as airports), please turn the battery power on/off switch to the OFF mode. It is recommended to carry this manual together to inform relevant security personnel. Please ask the local staff if you can check in or take the keyboard with you when you board the plane.

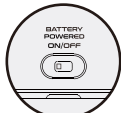

CONNECTING DEVICES

Connect the device with the cable, then press the FN and / to switch to wired mode. You can also adjust the highlighted knob to select the wired mode.



CONNECT 2.4G WIRELESS

Turn the battery power switch ON or connect the device with the cable.

Press the FN and * to switch to wireless mode. The * light will start flashing once when pairing.

Connect the dongle to the device.

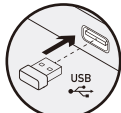

The * light will start flashing quickly when the pairing is successful. If the pairing cannot be performed or the pairing times out, please press FN and * (for 3 seconds) until the * light quickly flashes to enter pairing mode again, and then reinsert the dongle into the device.

You can also adjust the right knob to select the wireless mode. When selecting wireless mode, press and hold the knob to enter the pairing mode.

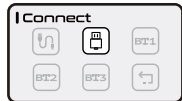

CONNECT TO BLUETOOTH WIRELESS

Turn the battery power switch ON or connect the device with the cable.

Bluetooth mode can connect up to three devices. Press FN and 7/8/9 to switch devices. Press FN and 7/8/9 (for 3 seconds) and pair with device named KEYSME Lunar 02. The 7/8/9 light flashing once a second when pairing. The light will start flashing quickly when pairing is successful.

You can also adjust the right knobs to select the Bluetooth wireless mode. When selecting Bluetooth wireless mode, press and hold the knob to enter into pairing mode.

TIME AND ANIMATION ON THE SCREEN

After the battery runs out or the battery power switch is turned off, the time displayed on the screen will be incorrect. Please connect the windows system computer with the cable and use the driver to synchronize the time.

You can customize an animation to display on the screen. Please connect the windows system computer with the cable and use the driver to set it up. Downloading the animation to the keyboard will take a few minutes, please keep the keyboard and computer connected stably.

ADJUST TYPING FEEL

Place a towel on the table, place the keyboard upside down on the towel, and insert the attached crowbar into the reserved quick disassembly kit, pry open the shell in the direction as shown in the figure and remove the bottom case.

As shown in the figure, the bottom case of the keyboard has 4 gasket slots, you can use other materials for replacement to obtain the desired elastic feel.

Warning: Please store the removed parts carefully, keep parts out of reach of children to prevent any accidents and choking hazards.



蓝牙连接模式

打开电池供电开关，或用数据线将键盘与设备连接好。

蓝牙模式可连接三个设备，按FN与7/8/9切换设备。按住FN与7/8/9 3秒进入配对模式，键盘配名为：KEYSME Lunar 02，7/8/9键的灯光1秒闪烁一次表示正在配对中，当灯光快速闪烁后表示配对成功。

你也可以调节右侧旋钮通过屏幕选择连接方式为蓝牙模式。在选择蓝牙模式时按住旋钮即可进入配对模式。



屏幕时间与动画

在电池没电或电池供电开关关闭后，屏幕显示时间将会错误，请用数据线将键盘与装有windows系统的电脑连接好，使用驱动同步正确的时间。

你可以自定义一个动画显示在屏幕上，请用数据线将键盘与装有windows系统的电脑连接好，使用驱动进行设置，下载动画至键盘将需要几分钟的时间，请保持键盘与电脑连接稳定。

调整手感

在桌面上垫一张毛巾，将键盘背面朝上放置在毛巾上，使用附送的撬棒插入预留的快拆口，按如图的方向撬开外壳，将下盖取下。

如图，键盘下盖有4个垫片槽，您可以使用其它材料进行替换，获得想要的弹性手感。

警告：请小心的收纳好拆下的零件，将其放在儿童接触不到的地方，以防发生意外伤害隐患。

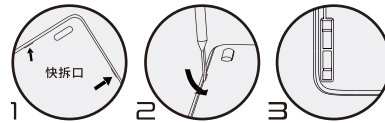

KEYBOARD SHORTCUTS AND KNOB

Left knob

Previous track
Next track
Play/Pause

FN + . = Open the Calculator

FN + / = Wired Model

FN + * = Wireless Model

Press for 3 seconds and pair with wireless.

FN + 7 = BT Channel 1 - Press for 3 seconds and pair with BT Channel 1
FN + 8 = BT Channel 2 - Press for 3 seconds and pair with BT Channel 2
FN + 9 = BT Channel 3 - Press for 3 seconds and pair with BT Channel 3

Right knob

Rotate to switch options
Press to confirm the option

FN + ← = Switch backlight mode

FN + → = Switch backlight color

FN + ↻ = Switch backlight brightness

Battery&Charging

This keyboard contains one lithium battery, total capacity is 700mAh/3.7V/2.59Wh.

It can be charged when the keyboard is connected to the power with a cable. Use USB3.0 or 5V/2A DC adapter to speed up charging.

When using 5V/2A DC adapter, the keyboard is expected to take 3 hours to be fully charged.

Note: This product supports up to 5V charging voltage and 2A charging current, and it must be charged with a DC power. We will not be responsible for any problems caused by improper charging.

REMAP KEYS AND MACRO

Please download software running on windows from www.keysme.com.

RESET TO FACTORY SETTINGS

FN + + + ← for 3 seconds.

键盘快捷键与旋钮

FN + 7 = 蓝牙通道1 — 长按3秒进入蓝牙通道1配对模式
FN + 8 = 蓝牙通道2 — 长按3秒进入蓝牙通道2配对模式
FN + 9 = 蓝牙通道3 — 长按3秒进入蓝牙通道3配对模式

左侧旋钮

(旋钮左旋) 上一曲
(旋钮右旋) 下一曲
(旋钮按下) 播放/暂停

右侧旋钮

旋转切换选项
按下确认选项

FN + . = 计算器

FN + / = 有线模式

FN + * = 无线模式
(长按3秒进入无线配对模式)

FN + ← = 切换灯光模式

FN + → = 切换灯光颜色

FN + ↻ = 切换灯光亮度

电池与充电

本键盘内含有一块锂电池，总容量700mAh/3.7V/2.59Wh。

用数据线将键盘与开机的设备连接时即可充电，若要加快充电时间，建议使用USB3.0插口或使用5V/2A直流电源适配器进行充电。

以5V/2A直流电源适配器为例，键盘没电自动关机情况下充满预计3小时。

注意：本产品使用直流电源进行充电，充电电压不得高于5V，充电电流不得高于2A，因使用超过限制的电源适配器进行充电而产生问题，我们概不负责。

按键自定义与宏

请前往www.keysme.com下载驱动。

恢复出厂设置

FN + + + ← 按住三秒左右

BATTERY SAVER

When keyboard connects with 2.4G wireless or Bluetooth wireless, it will enter into battery saver mode:

- When keyboard is inactive for 10 minutes
- After the keyboard goes into sleep mode or it is turned off
- Keyboard disconnected from device

When keyboard connects device with the cable, it won't enter into battery saver mode.

WIRELESS TRANSMISSION

It is not recommended that use the keyboard more than 10 meters from the device. There are metal frame objects between the keyboard and the device, blocked by walls, or the keyboard is resting on the metal surface, which may affect the signal effect.

It is recommended to use Cable/OFF mode or 2.4G mode for games. The polling rate of Cable and the 2.4G wireless connection is 1000Hz, this will improve your gaming experience.

HUB

There is a HUB interface on the top of the keyboard that can be used to connect to a device with the cable. HUB is a standard USB2.0 interface. When using HUB, it is recommended to plug the cable of the keyboard into a USB 3.0 or higher USB port.

SEARCHLIGHT

Note: It is forbidden to insert the Searchlight into the charger or USB interface with fast charging function (the output voltage may be higher than 5V). We are not responsible for the damage of the Searchlight caused by power exceeding voltage limit.

The Searchlight can be plugged into the 5V power supply USB interface, and the light can be turned on or off by touching the back of the luminous area. The USB interface at the rear of the Searchlight can be used for data transmission.

As shown in the figure, the Searchlight has two angles that can be adjusted. The luminous area can rotate 359 degrees, and the long arm can rotate 180 degrees. When reaching the limit area, it will not be able to rotate. Do not rotate with excess force, we are not responsible for the damage of the Searchlight caused by rotation with excess force.

休眠

当键盘使用2.4G无线/蓝牙连接时，以下情况键盘将进入休眠状态：

- 键盘连续10分钟无任何操作
- 与键盘连接的设备休眠/关机后
- 键盘与设备断开连接

按下任何按键将唤醒键盘

当键盘使用有线连接时，不会休眠。

无线传输

建议键盘与设备之间不超过10米使用。键盘与设备之间有金属框架物品、墙壁遮挡或键盘置于金属表面上可能影响信号效果。

建议使用有线或2.4G模式进行游戏，有线或2.4G模式回报率为1000Hz，您的游戏体验将会更好。

HUB

键盘顶部有一个HUB接口，用数据线将键盘与设备连接好可以使用。HUB为标准USB2.0接口。使用HUB时，建议将键盘的数据线插在USB3.0及以上版本的插口。

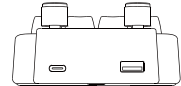

探照灯

探照灯可插在5V供电的USB接口上，触摸发光区域背面即可开启或关闭灯光。探照灯尾部的USB接口可以进行数据传输。

如图，探照灯有两个角度可供调节，发光区域可359度旋转，长臂可180度旋转，当到达限位区域将无法进行转动，请勿暴力旋转，因暴力旋转而造成探照灯损坏，我们概不负责。

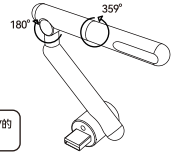

注意：探照灯禁止插在带有快充功能的充电头或USB接口上（即输出电压可能高于5V的USB接口），因插入超过电压限制的USB接口而造成探照灯损坏，我们概不负责。

LUNAR 02



THE KEY IS ME