



KEYSME

LUNAR 01

Connect Wired

Connect wired device with the cable, then turn the switch to the **Cable/OFF** mode.

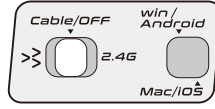

Connect 2.4G Wireless

Connect the dongle to the device. Turn the switch to the **2.4G** mode. The indicator light will start flashing once a second when pairing. The indicator light will start flashing quickly and the light will stay on when pairing is successful.

If the pairing cannot be performed or the pairing times out, please repeat the above steps. Press **FN+*** (for 3 seconds) until pairing is successful.

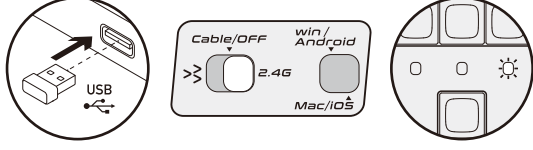

Connect Bluetooth

Turn the switch to the **BT** mode. Bluetooth mode can connect up to three devices. Press **FN+1**, **FN+2** and **FN+3** to switch devices. Press **FN+1**, **FN+2** or **FN+3** (for 3 seconds) and pair with device named **KEYSME Lunar 01**. The indicator light will light up red, green and blue to correspond to the three channels. The indicator light flashing once a second when pairing. The indicator light flashing quickly and the light will stay on when pairing is successful.

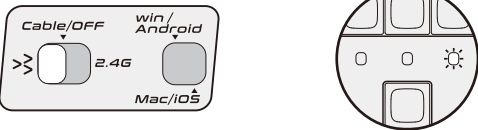

Knob Set

Press the knob once to switch the pickup lamp mode. Turn the pickup lamp on or off when press for 1 second.

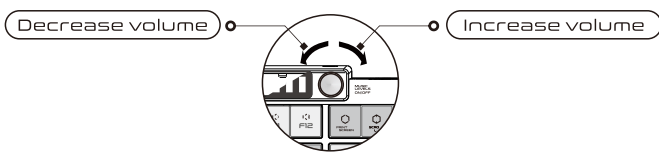

Compatibility Windows/Android

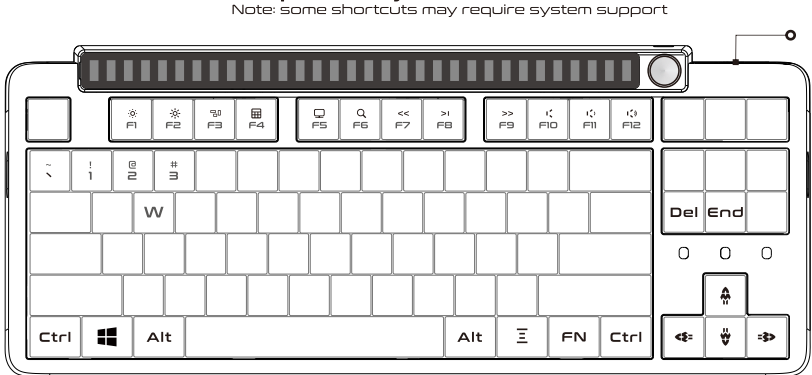

- | | | |
|--|---|---|
| <p>win/Android mode shortcuts</p> <p>FN+F1 Decrease screen brightness
FN+F2 Increase screen brightness
FN+F3 Open the mission control
FN+F4 Open the calculator
FN+F5 Open the computer window
FN+F6 Previous track
FN+F7 Play/Pause
FN+F8 Next track
FN+F9 Mute
FN+F10 Decrease volume
FN+F11 Increase volume</p> | <p>FN+F12 Increase volume
FN+↑ Increase backlight brightness
FN+↓ Decrease backlight brightness
FN+← Increase backlight speed
FN+→ Decrease backlight speed
FN+DEL Switch backlight mode
FN+END Switch backlight color
FN+W Interchange positions of WASD and ↑↓←→
FN+WIN The WIN key is disabled. The WIN key's light will turn off</p> | <p>FN+* 2.4G Model
Press for 3 seconds and pair with 2.4G</p> <p>FN+1 BT Channel 1
Press for 3 seconds and pair with BT Channel 1</p> <p>FN+2 BT Channel 2
Press for 3 seconds and pair with BT Channel 2</p> <p>FN+3 BT Channel 3
Press for 3 seconds and pair with BT Channel 3</p> |
|--|---|---|

Compatibility Mac/iOS

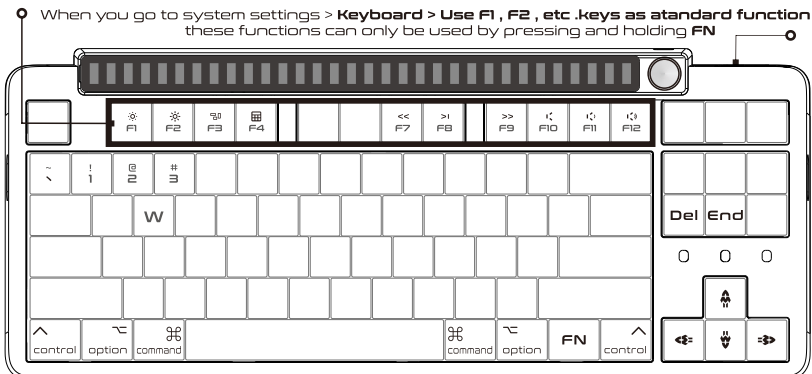

- | | | |
|--|--|---|
| <p>Mac/iOS mode shortcuts</p> <p>FN+F1 Decrease screen brightness
FN+F2 Increase screen brightness
FN+F3 Open the mission control
FN+F4 Open the Launchpad
FN+F5 Previous track
FN+F6 Play/Pause
FN+F7 Next track
FN+F8 Mute
FN+F9 Decrease volume
FN+F10 Increase volume</p> | <p>FN+F12 Increase volume
FN+↑ Increase backlight brightness
FN+↓ Decrease backlight brightness
FN+← Increase backlight speed
FN+→ Decrease backlight speed
FN+DEL Switch backlight mode
FN+END Switch backlight color
FN+W Interchange positions of WASD and ↑↓←→</p> | <p>FN+* 2.4G Model
Press for 3 seconds and pair with 2.4G</p> <p>FN+1 BT Channel 1
Press for 3 seconds and pair with BT Channel 1</p> <p>FN+2 BT Channel 2
Press for 3 seconds and pair with BT Channel 2</p> <p>FN+3 BT Channel 3
Press for 3 seconds and pair with BT Channel 3</p> |
|--|--|---|

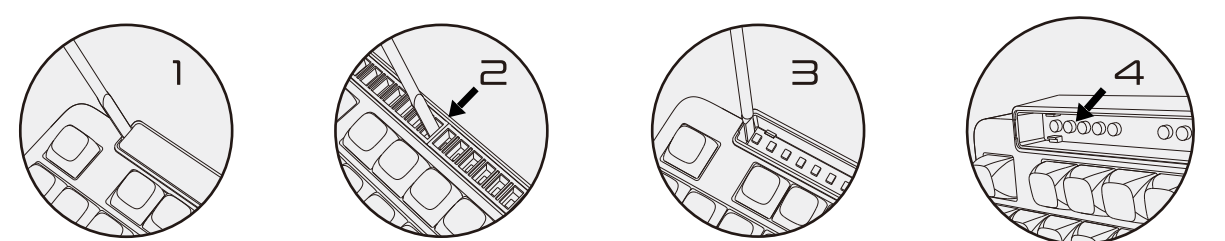

PHONE / PAD STAND MODE

Use the attached crowbar to tilt up the cover plate, body and PCBAs on the pickup lamp to remove it.

Once the pickup lamp has been removed you will then be able to use a tablet or phone instead. You can also match your favorite building block toys to make your keyboard unique.

Warning: Please store the removed parts carefully, keep parts out of reach of children to prevent any accidents and choking hazards.



KEYSME

LUNAR 01

有线连接

用数据线将键盘与设备连接好, 将开关拨到Cable/OFF档位。

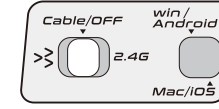

2.4G无线连接

将无线接收器与设备连接好, 将开关拨到2.4G档位, 指示灯1秒闪烁一次表示正在配对中, 当指示灯快速闪烁后常亮表示配对成功, 若无法自动配对或配对超时, 请重复上述步骤, 并按FN+* 3秒进入配对模式。

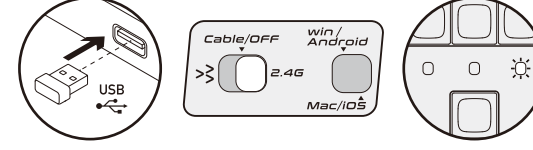

蓝牙连接

将开关拨到蓝牙 BT 档位。

蓝牙模式可连接三个设备, 按FN+1, FN+2, FN+3切换设备, 按FN+1, FN+2, FN+3 3秒进入配对模式, 键盘指示灯为: KEYSME Lunar 01, 指示灯红色、绿色、蓝色对应三个通道, 1秒内闪烁一次表示正在配对中, 当指示灯快速闪烁后常亮表示配对成功。

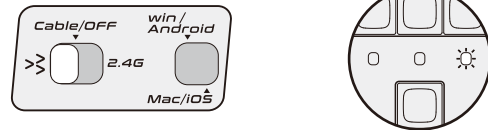

旋钮设置

旋钮按下一次拾音灯模式切换, 按住1秒拾音灯开关机。

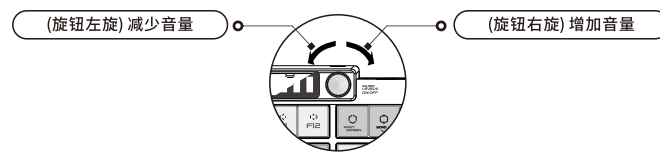

键盘快捷键 Windows/Android

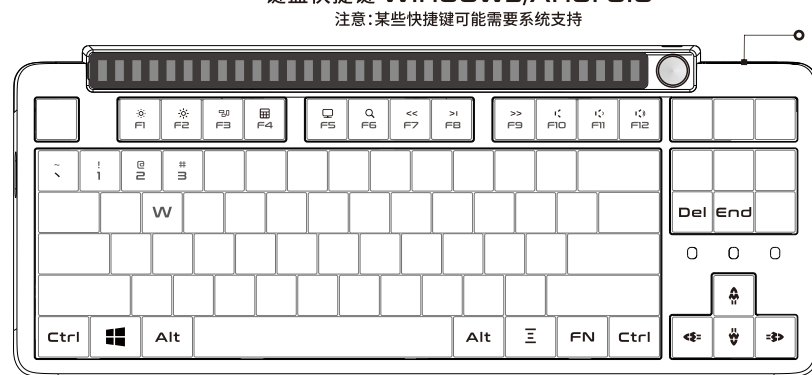

- | | | |
|---|---|--|
| <p>win/Android 快捷键</p> <p>FN+F1 屏幕亮度降低
FN+F2 屏幕亮度升高
FN+F3 打开控制中心
FN+F4 打开资源管理
FN+F5 打开计算器
FN+F6 播放/暂停
FN+F7 上一曲
FN+F8 播放/暂停
FN+F9 静音
FN+F10 音量减小
FN+F11 音量增加
FN+F12 增加音量</p> | <p>FN+↑ 增加背光亮度
FN+↓ 减少背光亮度
FN+← 增加背光速度
FN+→ 减少背光速度
FN+DEL 切换背光模式
FN+END 切换背光颜色
FN+W 交换 WASD 和 ↑↓←→ 的位置
FN+WIN WIN 键禁用, WIN 键灯熄灭</p> | <p>FN+* 2.4G 模式
长按 3 秒进入 2.4G 配对模式</p> <p>FN+1 BT 通道 1
长按 3 秒进入 BT 通道 1 配对模式</p> <p>FN+2 BT 通道 2
长按 3 秒进入 BT 通道 2 配对模式</p> <p>FN+3 BT 通道 3
长按 3 秒进入 BT 通道 3 配对模式</p> |
|---|---|--|

键盘快捷键 Mac/iOS

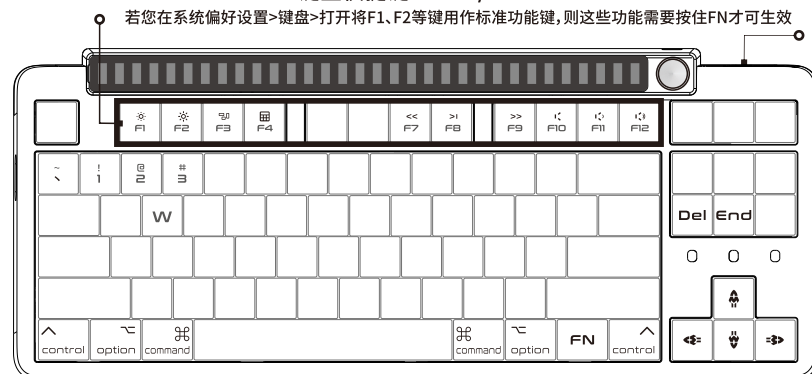

- | | | |
|---|---|--|
| <p>Mac/iOS 快捷键</p> <p>FN+F1 屏幕亮度降低
FN+F2 屏幕亮度升高
FN+F3 MAC 控制中心
FN+F4 MAC 启动台
FN+F5 上一曲
FN+F6 播放/暂停
FN+F7 音量减小
FN+F8 音量增加
FN+F9 增加音量</p> | <p>FN+↑ 增加背光亮度
FN+↓ 减少背光亮度
FN+← 增加背光速度
FN+→ 减少背光速度
FN+DEL 切换背光模式
FN+END 切换背光颜色
FN+W 交换 WASD 和 ↑↓←→ 的位置</p> | <p>FN+* 2.4G 模式
长按 3 秒进入 2.4G 配对模式</p> <p>FN+1 蓝牙通道 1, 长按 3 秒进入蓝牙通道 1 配对模式</p> <p>FN+2 蓝牙通道 2, 长按 3 秒进入蓝牙通道 2 配对模式</p> <p>FN+3 蓝牙通道 3, 长按 3 秒进入蓝牙通道 3 配对模式</p> |
|---|---|--|

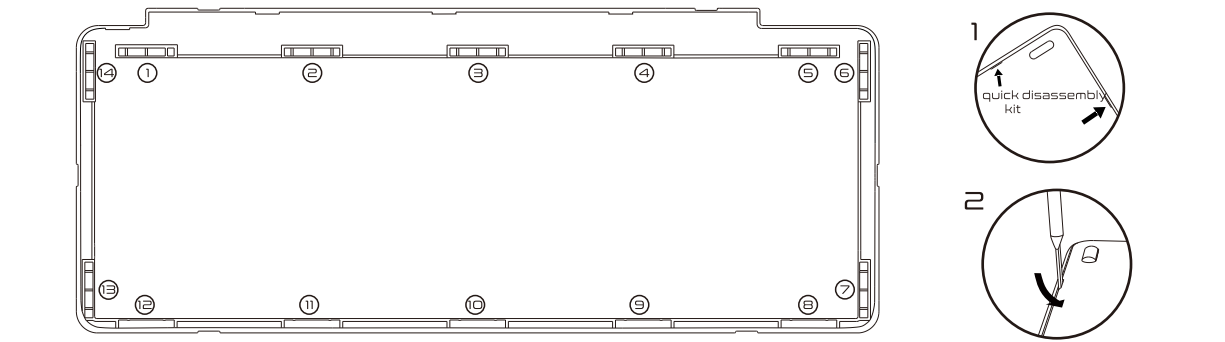

Adjust Typing feel

Place a towel on the table, place the keyboard back up on the towel, and insert the attached crowbar into the reserved quick disassembly kit, pry the shell in the direction as shown in the figure and remove the bottom case.

As shown in the figure, the bottom case of the keyboard has 14 gasket slots, you can use the silicone gasket supplied in the package for replacement, or adjust the quantity and position of the gasket to obtain the desired elastic feel.

Warning: Please store the removed parts carefully, keep parts out of reach of children to prevent any accidents and choking hazards.

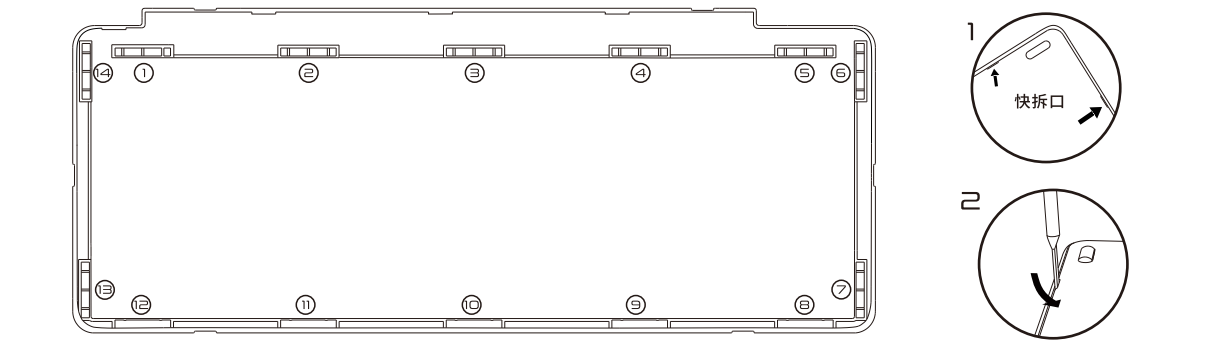

调整打字手感/打字音

在桌面上垫一张毛巾, 将键盘背面朝上放置在毛巾上, 使用附送的撬棒插入预留的快拆口, 按如图的方向撬开外壳, 将下盖取下。

如图, 键盘下盖有 14 个垫片槽, 您可以使用包装内附送的硅胶垫片进行替换, 或调整垫片数量及位置, 获得想要的弹性手感。

警告: 请小心的收纳好拆下的零件, 将其放在儿童接触不到的地方, 以防发生意外引发窒息。

Battery & Charging

This keyboard contains two lithium batteries, total capacity 4000mAh/3.7V/14.8Wh.

The indicator light is breathing during charging, the indicator light lights on when the battery is not charged.

Note: this product supports up to 5V charging voltage and 2A charging current, and it must be charged with a DC adapter. We are not responsible for any problems caused by improper charging.

The indicator light lights **Green** when high battery, **Orange** when middle battery, **Red** when low battery, **Blue** after being fully charged.

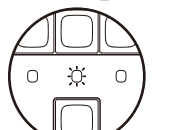

Travel NOTE: In some special security inspection occasions (such as airports), please turn the keyboard to the **Cable/OFF** mode and do not connect the cable. It is recommended to carry this manual together to inform relevant security personnel. Please ask the local staff if you can check in or take the keyboard with you when you fly.

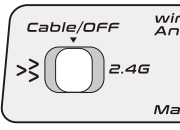

电池与充电

本键盘内含两块锂电池, 总容量 4000mAh/3.7V/14.8Wh。

指示灯状态: 充电时呼吸, 未充电时常亮

注意: 本产品需使用直流电源进行充电, 充电电压不得高于 5V, 充电电流不得高于 2A, 因使用超过限制的电源适配器进行充电而产生的问题, 将不属于产品质量问题。

当键盘使用有线连接时, 不会休眠。

当键盘使用 2.4G 无线/蓝牙连接时, 以下情况键盘将进入休眠状态:

1. 键盘连续 10 分钟无任何操作。
2. 与键盘连接的设备休眠/关机后。
3. 键盘与设备断开连接。

按下任何按键将唤醒键盘。

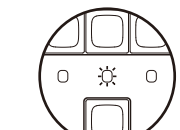

旅行建议:

在一些特殊安检场合 (如机场) 请将开关拨到 Cable/OFF 档位, 并不插入数据线, 建议将本说明书共同携带, 以便于告知相关安保人员。乘坐飞机等情况可否托运或随身携带, 请咨询当地工作人员。

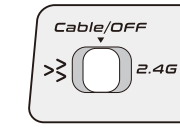

Battery saver

When keyboard connects device with the cable, it won't enter into battery saver mode. When keyboard connects device with 2.4G wireless or bluetooth, it will enter into battery saver mode:

1. When keyboard is inactive for 10 minutes.
2. After sleep / shutdown of the device connected to the keyboard.
3. Keyboard disconnected from device.

You can tap any button to wake the keyboard.

Remap keys and macro

Please download software running on windows from www.keysmeme.com.

Factory reset

Press and hold **FN + M + K** for 3 seconds.

Wireless transmission

It is not recommended that use the keyboard more than 10 meters from the device. There are metal frame objects between the keyboard and the device, blocked by walls, or the keyboard is resting on the metal surface, which may affect the signal effect.

It is recommended to use **Cable/OFF** mode or **2.4G** mode for games. The polling rate of Cable and 2.4G wireless mode connection is 1000Hz, this may add your gaming experience.



休眠功能

当键盘使用有线连接时, 不会休眠。

当键盘使用 2.4G 无线/蓝牙连接时, 以下情况键盘将进入休眠状态:

1. 键盘连续 10 分钟无任何操作。
2. 与键盘连接的设备休眠/关机后。
3. 键盘与设备断开连接。

按下任何按键将唤醒键盘。

按自定义与宏功能

请访问 www.keysmeme.com 下载驱动。

恢复出厂设置

按住 **FN + K + M** 三秒。

无线传输

建议键盘与设备之间不超过 10 米进行使用, 键盘与设备之间有金属框架物品、墙壁遮挡或键盘置于金属表面上可能影响信号效果。

建议使用有线或 2.4G 模式进行游戏, 有线或 2.4G 模式回报率 1000Hz, 您的游戏体验将会更好。

