

材质：封面200g 双铜 覆亚膜      内页128g双铜

尺寸：长12cm-宽12cm

**Tailulu**

# AIR HUMIDIFIER

**Model: DS9L USER MANUAL**

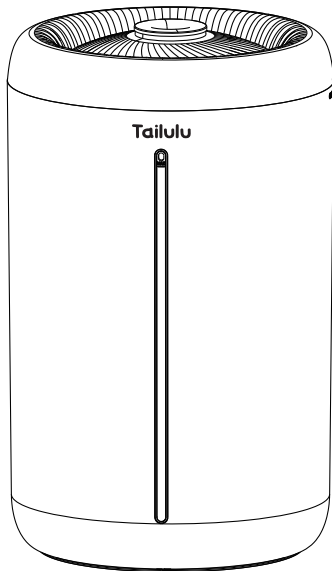

Auto Shut Off



4.5L Water Tank



Night Light



3 Mist Settings



## **CUSTOMER SERVICE**

Our customer service team is standing by to assist you  
if you have any questions or concerns.



[www.tailulu.com](http://www.tailulu.com)



[support@tailulu.com](mailto:support@tailulu.com)



1-833-368-8825

# CONTENT

SAFETY NOTICE .....	01
PRODUCT DESCRIPTION .....	03
PRODUCT OVERVIEW .....	04
BEFORE USING .....	05
HOW TO USE .....	07
USE THE HUMIDIFIER .....	08
MAINTENANCE .....	09
PRECAUTIONS .....	12
SPECIFICATIONS .....	16
TROUBLESHOOTING .....	17

## SAFETY NOTICE 1

Please read this manual carefully before using the appliance.

Retain it for future use.

1. To avoid electric shock, do not plug or unplug the power plug with wet hands.
2. Do not dismantle, repair, or modify this product without prior authorization.
3. The power cable must not be knotted, damaged, crushed by heavy objects, or changed in any way before use, as this might result in electric shock, short circuit, or fire.
4. Do not detach the top of water tank from the barrel and do not touch the water and any other parts in the tank while the humidifier is working to prevent electric shock.
5. Not intended for outdoor use.
6. Unplug the power cord during thunderstorms or when not in use for an extended period of time.
7. To avoid damaging the internal electronic components, do not flip the machine over while it is turned on or with water inside.
8. This appliance can be used by children aged from 8 years and above and persons with reduced physical, sensory or mental capabilities or lack of experience and knowledge if they have been given supervision or

## 2 SAFETY NOTICE

instruction concerning use of the appliance in a safe way and understand the hazards involved.

9. If there is any abnormal phenomenon in the use of the product, please unplug the power plug immediately and contact the after-sales service.

**Note:** The schematic diagrams of goods, accessories, user interfaces, and other items in this manual are for reference only.

Due to product updates and upgrades, the actual product may be slightly different from the schematic diagram, please refer to the actual product.

## PRODUCT DESCRIPTION 3

### FUNCTIONAL PRINCIPLE:

To atomize water into ultra-fine particle water mist, the humidifier utilizes ultrasonic waves to generate 1.7 million high-frequency oscillations every second. The humidifier can maintain the correct humidity level in the room while also preventing static electricity from forming.

### TIP:

It is recommended to clean the humidifier once a week.

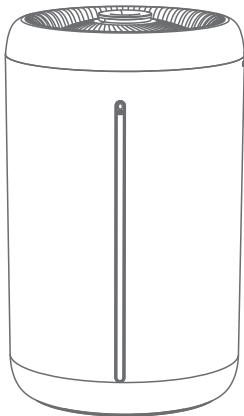



## 4 PRODUCT OVERVIEW

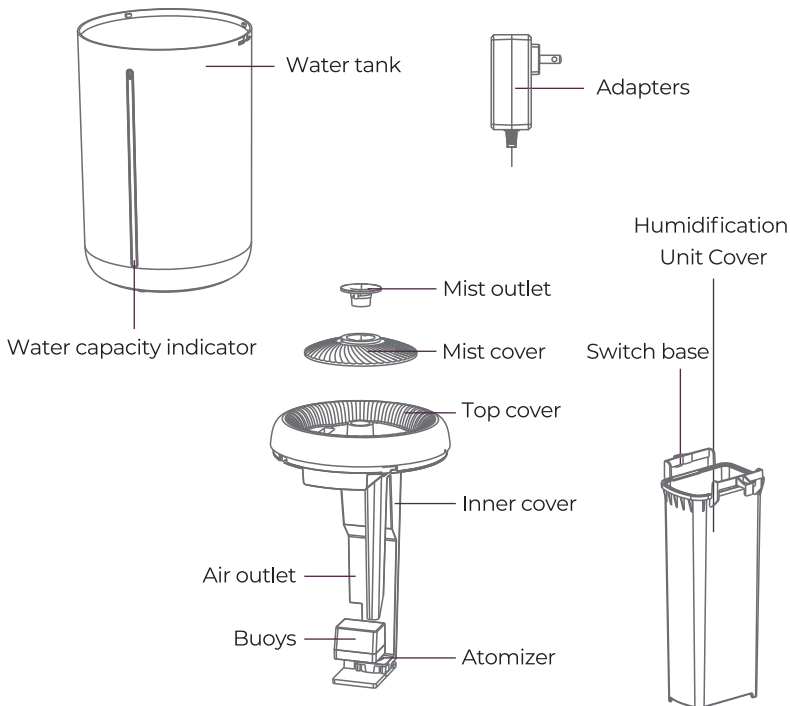

## BEFORE USING 5

Open the package, turn the top cover counterclockwise, lift the top cover module, take out the power adapter from the bucket, put back the top cover module, turn clockwise and the water tank is stuck.

### OPEN THE PACKAGE

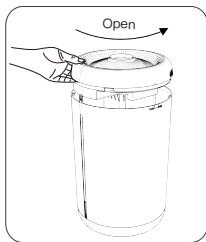

Rotate the top cover counterclockwise  
Remove top cover and humidification unit

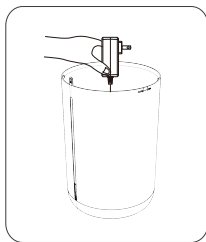

Take out the power adapter

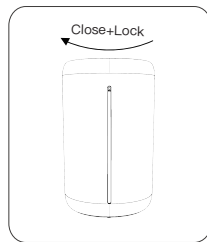

Place the humidification unit and top cover back into the water reservoir  
Rotate the top cover clockwise to fix it securely

## 6 HOW TO USE

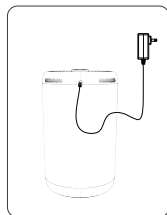
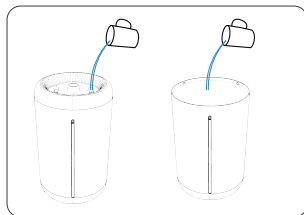

### ADD WATER:

1. Place humidifier on a solid and flat surface, remove the water tank cover.
2. Fill the tank with water or remove the dust cap on the top of the humidifier and add water to the water inlet without opening the entire top.
3. Do not exceed the max capacity mark.
4. Do not fill water from the air outlet on top of the humidifier.



## HOW TO USE 7

### POWER ON:

**NOTE :** Before connecting the humidifier , check that the voltage indicatd on the appliance matches the local power supply voltage.

Plug the DC24V adapter to turn the humidifier on.

Power indicator will lit for 1 second for self-checking. Unit enters standby mode by default.

Press the power button "  " on the top surface control panel. The humidification speed is adjusted to the highest speed preset, "  " humidification speed indicator lights up;

### MIST EVAPORATION ADJUSTMENTS:

Press the power button again, the humidification speed is adjusted to the middle speed preset, "  " humidification speed indicator lights up.

Press the power button again, the humidification speed is adjusted to the lowest speed preset (10-sec intermittent evaporation), "  " humidification speed indicator lights up.

## 8 USE THE HUMIDIFIER

Press the power button for the fourth time. All humidification speed indicators are off, the humidifier has been turned off.

**Tip:**

The fan of the humidifier will continue to run for 30 seconds, which is normal after it is turned off. The purpose is to remove the residual water mist in the water tank and ensure normal use next time

### NIGHT LIGHT

Long press (3 secs) the power button to turn the night light on/off.

### WATER SHORTAGE PROTECTION:

When the water reservoir is empty, the water shortage protection device will automatically disconnect the atomizing circuit. The humidifier turns off after night light flashes 5 times. The machine can be used normally after adding water.

## MAINTENANCE 9

1. Power off and unplug the humidifier before cleaning;
2. Rotate the upper cover counterclockwise(Figure 1), take out the upper cover module(Figure 2), use a soft damp towel to clean the upper cover. And clean the water tank under the faucet.
3. Pull out with two index fingers to open the snap, then use your thumb to lift the humidifier cover up to separate the atomizer and the middle barrel (Figure 3 and 4). Disassemble the middle barrel and the module (Figure 5), and use a towel or brush to clean the interior.
4. After cleaning, assemble the mold back, place the upper unit back into the water reservoir and rotate clockwise.
5. When not in use for a long time, please clean it, dry it and store it in the original packaging in a well-ventilated and dry place.

## 10 MAINTENANCE

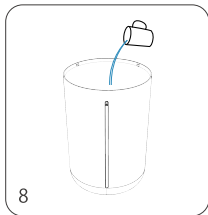
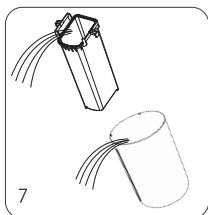
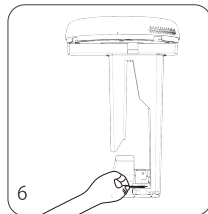
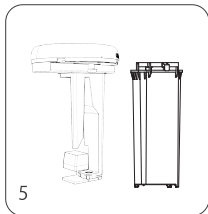
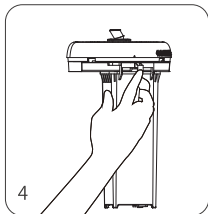
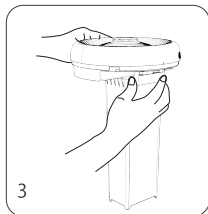
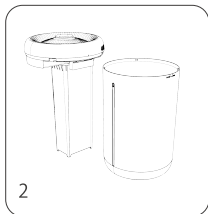
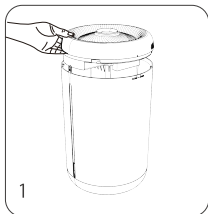

## MAINTENANCE 11

### NOTICE:

If there is too much dirt in the middle bucket, the humidifier's water intake may get clogged, resulting in the atomization effect and the phenomena of non-atomization. After cleaning, the unit can be used normally.

During operating and maintenance, it is forbidden to reverse or tilt the humidification unit to avoid short-circuit. Please do not submerge the top module in water.



1

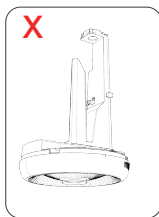

2

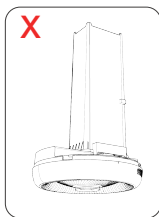

3

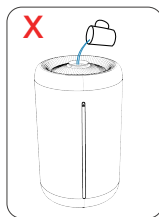

4



## 12 PRECAUTIONS

### INSTALLATION

Please read the instructions carefully before using this appliance or any operation to prevent electric shock, fire, personal injury and other damage.

- Do not connect the power supply if the unit is not assembled;
- Do not disassemble the body components arbitrarily.

### TIPS

- Turn off and unplug the humidifier before moving it.
- Please dump the remaining water in the reservoir before carrying or relocating the product.
- Please place humidifier on a solid and flat surface.
- Do not use the humidifier directly on a wooden surface to prevent it from being deformed and damaged by moisture.

## PRECAUTIONS 13

- Please place the humidifier 2 meters away from furniture and electrical appliances to avoid excessive moisture.
- Please place it away from heat sources and avoid direct sunlight.

### POWER CABLE

- If the supply cord is damaged, it must be replaced by the manufacturer, its service agent or similarly qualified persons in order to avoid a hazard.
- Do not pull the power cord.
- Unplug the unit when filling the water, relocating or cleaning.

### WATER TANK

- To avoid corrosion and damage to the product, as well as injury to the human body, do not add disinfectants or other chemicals to the water tank or base.

## 14 PRECAUTIONS

- The temperature of water must not exceed 40 °C.
- To avoid unit damage, do not allow water to leak into the upper cover module.
- Recommended humidifier operating ambient temperature: 10-40 °C, relative humidity is less than 80%RH.
- Please do not put metal items, chemicals, or detergents into the water tank or sink, as this will result in poor atomization.
- Turn off the power and unhook the power cord before emptying out the water in the sink.

## USING

- If the product produces abnormal noise, smell or high temperature, please stop using it immediately.
- Keep hair, fabrics, etc. away from the machine to avoid getting caught in or blocking the air inlet / outlet.
- Do not lean or tilt the machine.

## PRECAUTIONS 15

- When using with household gas appliances (such as gas stove, gas water heater, etc.) at the same time, please ventilate the area properly to avoid carbon monoxide poisoning.
- When the humidifier's main body is tilted, it might cause water level errors or even water overflow, thus it must be placed firmly during usage.

## 16 SPECIFICATIONS

NUMBER	project	parameter
1	Rated input voltage	AC100~240V
2	Rated input frequency	50/60Hz
3	Rated output voltage	24VDC
4	Rated output current	750 mA
5	Rated Power	18W

## 17 TROUBLESHOOTING

Problem	Blue light flashes 4 times: lack of water	Add water
	Small amount of mist: abnormal water level	Check the water level
	No mist is coming out: lack of water or abnormal power supply	Check the water level and power supply

## **CUSTOMER SERVICE**

Our customer service team is standing by to assist you  
if you have any questions or concerns.



[www.tailulu.com](http://www.tailulu.com)



[support@tailulu.com](mailto:support@tailulu.com)



1-833-368-8825







# Tailulu

 [www.tailulu.com](http://www.tailulu.com)

 [support@tailulu.com](mailto:support@tailulu.com)

 1-833-368-8825

   
Made in China