

HOME HUMIDIFIER

Model: DS9H

USER MANUAL

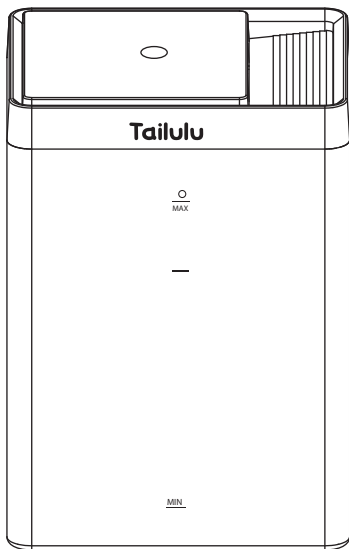

Auto Shut Off



7.5L Water Tank



Night Light



3 Mist Settings



Time Setting

CUSTOMER SERVICE

Our customer service team is standing by to assist you
if you have any questions or concerns.



www.tailulu.com



support@tailulu.com



1-833-368-8825

CONTENT:

SAFETY NOTICE	01
PRODUCT OVERVIEW	03
BEFORE USING	04
CONTROL PANEL AND FUNCTIONS	05
HOW TO USE	06
USE THE HUMIDIFIER	07
MAINTENANCE	08
PRECAUTIONS	10
SPECIFICATIONS	13
TROUBLESHOOTING	13

Please read this manual carefully before using the appliance, retain it for future use.

1 SAFETY NOTICE

1. To avoid electric shock, do not plug or unplug the power plug with wet hands.
2. Without prior authorization, do not dismantle, repair, or modify this product.
3. Do not cover the mist nozzle.
4. The power cable must not be knotted, damaged, crushed by heavy objects, or changed in any way before use, as this might cause an electric shock, short circuit, or fire.
5. Do not detach the top of the water tank from the barrel during work, and do not touch the water or any of the water tank's components.
6. Not suitable for outdoor use.
7. Unplug the power cord during thunderstorms or when not in use for long periods of time.
8. To avoid damaging the internal electronic components, do not flip the machine over while it is turned on or with water inside.

9. This appliance can be used by children aged from 8 years and above and persons with reduced physical, sensory or mental capabilities or lack of experience and knowledge if they have been given supervision or instruction concerning use of the appliance in a safe way and understand the hazards involved.
10. If there is any abnormal phenomenon in the use of the product, please unplug the power plug immediately and contact the after-sales service.
11. Do not add essential oils to the humidifier to prevent the humidifier from being corroded by essential oils.

Note: The schematic diagrams of goods, accessories, user interfaces, and other items in this manual are for reference only.

Due to product updates and upgrades, the actual product may be slightly different from the schematic diagram, please refer to the actual product.

2 PRODUCT OVERVIEW

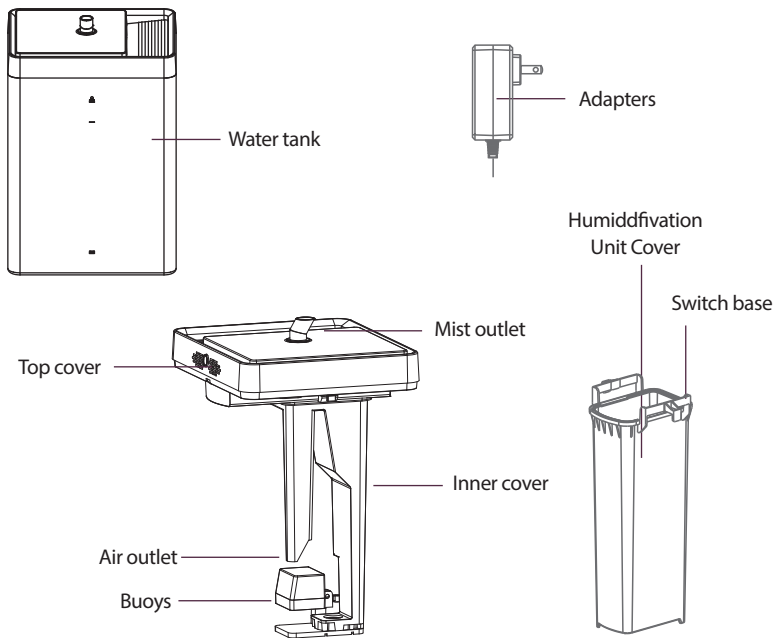

3 BEFORE USING

Open the package lift the top cover module, take out the power adapter from the bucket, put back the top cover module, water tank is stuck.

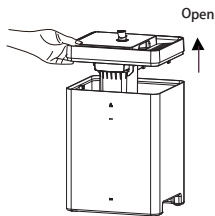

Remove the top cover



Take out the adapter

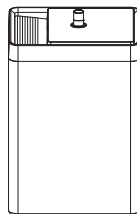

Reset successfully

Tip: Please remove the cover first and take out the adapter in the water tank before you use the item.

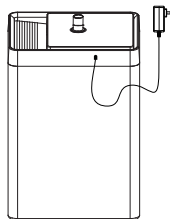
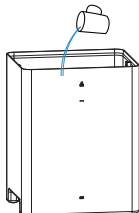
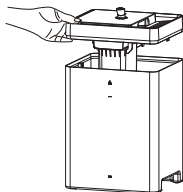

ADD WATER:

1. Place humidifier on a solid and smooth surface, remove the water tank cover.
2. Fill the tank with water.
3. Do not exceed the max capacity mark.
4. Do not fill water from the air outlet on top of the humidifier.
5. Put the tank cap on, make sure all parts are fastened firmly, connect the power and turn on the device.

4 CONTROL PANEL AND FUNCTIONS

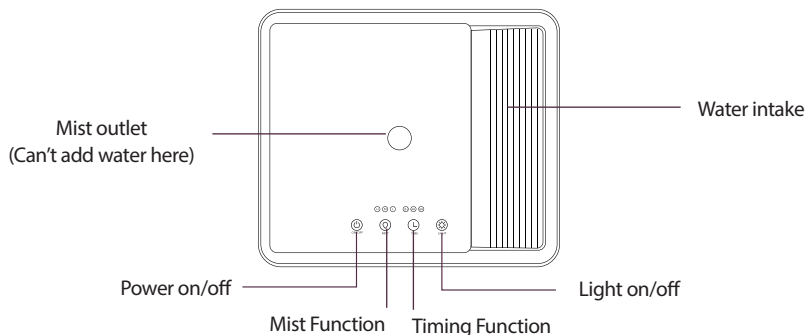

5 HOW TO USE

POWER ON:

Notice: Before connecting the humidifier, check that the voltage indicatd on the appliance matches the the local power supply voltage.

1. Plug the DC24V power on the back of the humidifier and tum it on. At this time, the power indicator lights up (about 0.1 seconds), indicating that the humidifier is already in power-on standby state.Press the "ON/OFF" button againcan turn off the humidifier.
- 2.Press the "ON/OFF" button to switch on the humidifier, the atomization starts, it is in a continuous working state with high humidification speed. "H" indicator light lights up.
3. Press the " MIST" button to adjust the mist level (H,L,S) and choose the most comfortable one for you. If select "S" the humidifier works for 10 seconds and stops for 10 seconds, which is ideal for sleeping.
4. Press the "TIME" button to pick the required operating time (2, 4, 8hours). Air humidifier shuts off automatically at the end of the selected period.
5. Press the "LIGHT" button to turn on/off the dreamy blue night light.

Tip:

The fan of the humidifier will continue to run for 30 seconds, which is normal after it is turned off. The purpose is to remove the residual water mist in the water tank and ensure normal use next time

WATER SHORTAGE PROTECTION:

When the water reservoir is empty, the water shortage protection device will automatically disconnect the atomizing circuit. The humidifier turns off after night light flashes 5 times. The machine can be used normally after adding water.

6. MAINTENANCE

1. Power off and unplug the humidifier before cleaning.
2. Use a soft damp towel to clean the upper cover. The water tank can be cleaned under the faucet and use the brush included.
3. Pull out with two index fingers to open the snap, then use your thumb to lift the humidifier cover up to separate the atomizer and the middle barrel. and use a towel or brush to clean the interior.

4. After cleaning, assemble the mold back, place the upper unit back into the water reservoir.
5. When not in use for a long time, clean it, dry it and store it in the original packaging in a well-ventilated and dry place.

7 MAINTENANCE

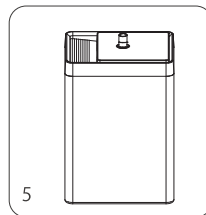
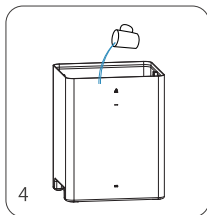
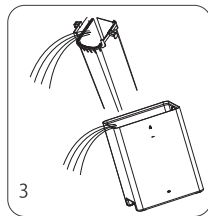
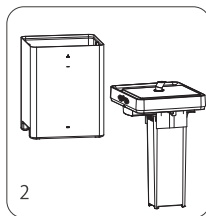
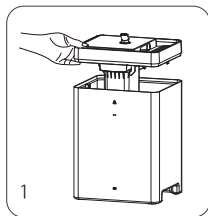

NOTICE:

If there is too much dirt in the middle bucket, the humidifier's water intake may get clogged, resulting in the atomization effect and the phenomena of non-atomization. After cleaning, the unit can be used normally.

During operating and maintenance, it is forbidden to reverse or tilt the humidification unit to avoid short-circuit. Please do not submerge the top module in water.

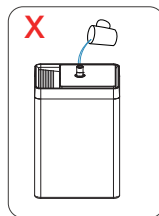
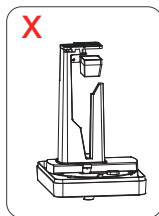
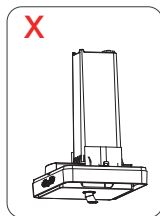
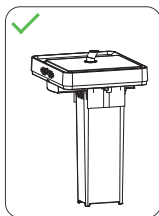

8 PRECAUTIONS

INSTALLATION

Please read the instructions carefully before using this appliance or any operation to prevent electric shock , fire, personal injury and other damage.

- Do not connect the power supply if the unit is not assembled;
- Do not disassemble the body components arbitrarily.

TIP

- Turn off and unplug the humidifier before moving it.
- Please place humidifier on a solid and smooth surface.
- Filling the tank with purified water is recommended.
- Please dump the remaining water in the reservoir before carrying or relocating the product.
- Do not use the humidifier directly on a wooden surface to prevent it from being deformed and damaged by moisture.
- Please place the humidifier 2 meters away from furniture and electrical appliances to avoid excessive moisture.

- Please place it away from heat sources and avoid direct sunlight.
- The water tank must be drained when its left unattended.

POWER CABLE

- . If the supply cord is damaged, it must be replaced by the manufacturer, its service agent or similarly qualified persons in order to avoid a hazard.
- . Do not pull the power cord.
- . Unplug the unit when filling the water, relocating or cleaning.

WATER TANK

- To avoid corrosion and damage to the product, as well as injury to the human body, do not add disinfectants , essential oil or other chemicals to the water tank or base.
- The temperature of water must not exceed 40 .
- To avoid unit damage, do not allow water to leak into the upper cover module.
- Recommended humidifier operating ambient temperature: 15-40 , relative humidity is less than 80%RH.
- Please do not put metal items, chemicals, or detergents into the water tank or sink, as this will result in poor atomization.
- Turn off the power and unhook the power cord before emptying out the water in the sink.

USING

- If the product produces abnormal noise, smell or high temperature, please stop using it immediately.
- Keep hair, fabrics, etc. away from the machine to avoid getting caught in or blocking the air inlet / outlet.
- Do not lean or tilt the machine.
- When using with household gas appliances (such as gas stove, gas water heater, etc.) at the same time, please ventilate the area properly to avoid carbon monoxide poisoning.
- When the humidifier's main body is tilted, it might cause water level errors or even water overflow, thus it must be placed firmly during usage.

9 SPECIFICATIONS

NUMBER	Project	Parameter
1	Rated input voltage	AC 100-240 V
2	Rated input frequency	50/60 Hz
3	Rated output voltage	DC 24V
4	Rated output current	0.75A
5	Rated Power	18 W

10 TROUBLESHOOTING

Problem	Blue light flashes 4 times: lack of water	Add water
	Small amount of mist: abnormal water level	Check the water level
	No mist is coming out: lack of water or abnormal power supply	Check the water level and power supply

CUSTOMER SERVICE

Our customer service team is standing by to assist you
if you have any questions or concerns.

 www.tailulu.com

 support@tailulu.com

 1-833-368-8825

Tailulu



www.tailulu.com



support@tailulu.com



1-833-368-8825



Made in China