

TAB

Product User Manual

Model:
T9-Pro

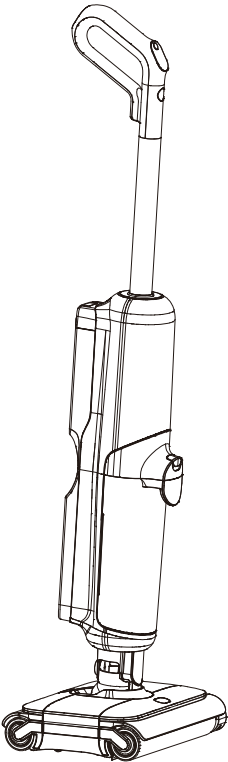

- Please read this manual carefully before use
- The company reserves the right to interpret the manual
- The appearance of the product is subject to the real product
- Please keep it properly with the invoice after reading it
- In case of product technology or software upgrade, there shall not be prior notice

Packing list

Accessories of main unit

Before using this product, please check whether the package contains the following items. Please contact our customer service for any missing.

The pictures are for reference only. Please refer to the real product received.

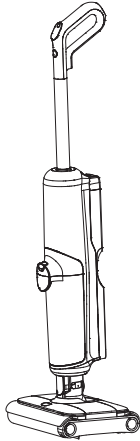

Main unit x1

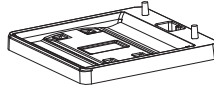

Charging base assembly A x1

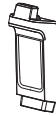

Charging base assembly B x1



Screw x4



Filter x1



Screwdriver x1

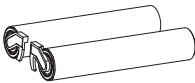

Rolling brush x2

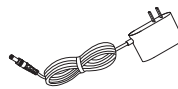

Adaptor x1

x1



Ground cleanser x1

(Be suitable for cleaning all kinds of ground stains)



Cleaning tool x1

(Be suitable for cleaning residual stains in dirty-water tank of floor scrubber and hair wound by the rolling brush)

Contents

Safety instruction	1
Product Introduction	3
Product Installation	4
How to Use	7
Product Maintenance	11
Product Parameters/Description of hazardous substances in the product	13
Failure Recovery	14
Warranty Card/Warranty Terms	15

Safety instruction

1. This product is only used on indoor surfaces. It is forbidden to install, charge and use this product outdoors, in bathrooms and around swimming pools.
2. This product may not be used by people with physical, sensory or intellectual disabilities and people without relevant experience and knowledge (including children), unless there is a guardian's care or guidance to ensure that they can use this product safely.
3. Please do not let children use this product as a toy.
4. Please do not touch the plug or any live parts of the product with wet hands to avoid electric shock.
5. Please do not move this product from the power cord or other cables, otherwise it may cause danger.
6. If the charger or plug is damaged, please stop using it. Please call the professional maintenance personnel of our company to replace it, so as to avoid harm.
7. When using, if leakage or excessive motor temperature and abnormal sound are found, such as overheating of the unit, abnormal sound, peculiar smell and weak suction, please immediately stop using it and call our professional maintenance personnel.
8. When charging, please use the charger specially designed by our company for charging. Other types of chargers may cause battery failure or extreme thermal effect.
9. If this product is not used for a long time, please turn off the power supply and unplug the charging socket.
10. Please do not use this product near or on the surface of inflammable and explosive objects, which may lead to fire and explosion.
11. Please do not use this product near the working fireplace or heater to prevent the machine shell from being deformed.
12. Please do not use this product to absorb high-temperature substances (unlit cigarette butts, matches or hot ashes, etc.), superfine substances (such as lime, cement, wood chips, gypsum powder, ashes and carbon powder, etc.), sharp fragments (such as glass, nails and pins, etc.), dangerous goods (such as solvents and detergents, etc.), chemical substances (such as acid substances and detergents, etc.), flammable and explosive liquids (gasoline, alcoholic products) and other substances with uncertain physical characteristics.
13. Shoe polish, paint, pigment and other stains with strong grease, strong stickiness or strong dyeability are not within the scope of use of this product.

Safety instruction

14. Please clean according to the instructions of the detergent. If a large amount of cleaning solution is added, more foam will be generated during use, which may penetrate into the motor and cause danger. It is recommended to use the detergent produced by our company and the manufacturer approved by our company, and it must not contain acid, alkali solution or substances harmful to the environment.
15. Please keep the detergent out of the reach of children. If the cleaning solution accidentally enters the eyes, rinse thoroughly with clean water; if you accidentally eat, you should seek medical attention immediately.
16. Please do not disassemble the closed machine by yourself. There are no parts in the machine that customers can repair by themselves, and do not try to change the performance of the machine, otherwise it will lead to danger.
17. Please do not use the voltage that does not correspond to the specifications of this product, otherwise it will damage the motor, and it is more likely to hurt the users.
18. Please do not shake the machine up and down or collide violently, and do not tilt the machine to one side or lay flat to prevent sewage from flowing into the motor.
19. The main body and floor brush of this product contain electrical components, which should not be soaked in water or washed, otherwise fire and electric shock accidents may occur due to short circuit of the machine.
20. It is forbidden to use this product without installing the rolling brush, clean-water tank, dirty-water tank and filter element.
21. Please make sure to replace the rolling brush after turning off the machine.
22. After using the machine, please clean up the dirty-water tank in time to keep the ventilation path unblocked, so as to avoid the suction drop and motor heating caused by blockage, thus affecting the service life of the machine.
23. After using the machine, please keep it in a dry place. Humid places will affect the insulation and service life of electrical appliances.
24. In order to prevent tripping, the machine should be placed against the wall after use.
25. Please check the smoothness of the suction nozzle regularly. If there is any blockage, please clear it in time, so as to avoid the decrease of suction caused by blockage and affect the service performance of the machine.
26. When the machine breaks down, please do not repair it yourself. Please call the after-sales department of our company for help.

Product Introduction

Main unit

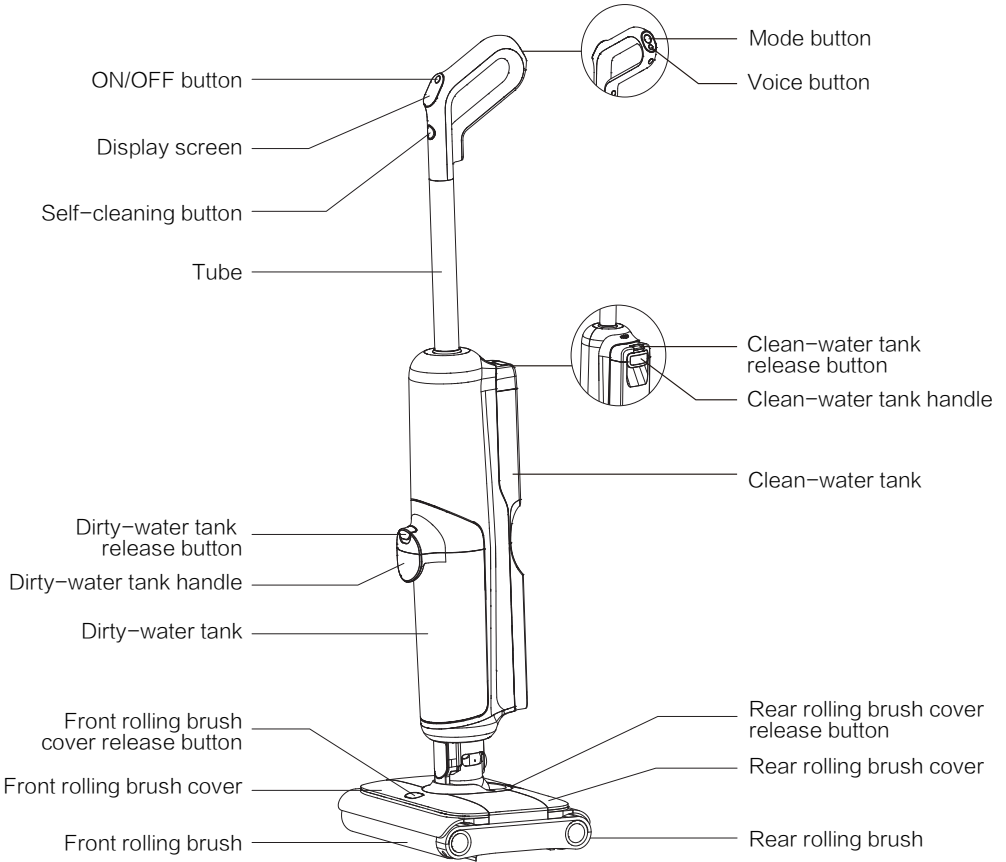

Product Installation

1. Handle installation and disassembly

1.1 Installation:

Insert the end of the handle assembly vertically into the port on the top of the body according to the direction shown in the figure, and the it is successfully.

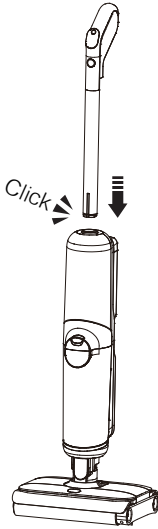

1.2 Disassembly:

Firstly take down the clean-water tank, then put a pen-like hard object into the hole on the back of the body to press the shrapnel, and pull out the handle of the main unit upwards at the same.

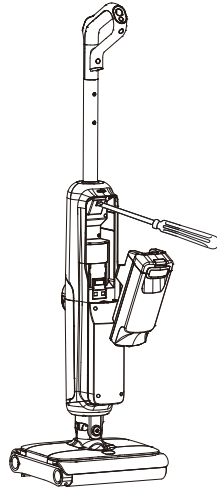

2. Installation of charging base:

Insert the charging base assembly B into the card slot of the charging base assembly A, and fix it with 4 screws on the back of the assembly A; if it is needed to disassemble, please unscrew the screw to separate the upper and lower parts.

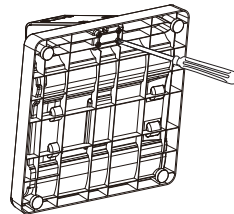
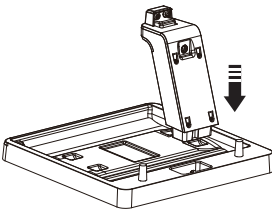

Product Installation

3. Clean-water tank installation and disassembly

3.1 Installation:

Firstly, put the bottom of the clean-water tank into the opening support position of the machine body, then gently push the clean-water tank, and it is successfully installed after hearing the click sound.

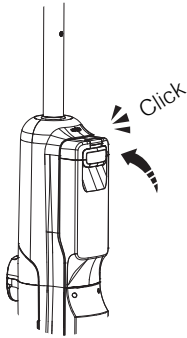

3.2 Disassembly:

Hold the machine body with one hand and press the button of the clean-water tank with the other hand, and then pull it out to take out the tank..

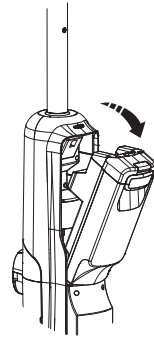

4. Dirty-water tank installation and disassembly

4.1 Installation:

Firstly, put the bottom of the dirty-water tank into the opening support position of the machine body, then gently push the dirty-water tank, and it is successfully installed after hearing the click sound.

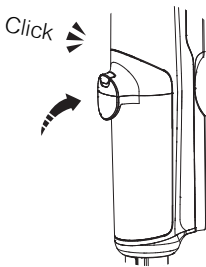

4.2 Disassembly:

Hold the machine body with one hand and press the button of the dirty-water tank with the other hand, and then pull it out to take out the tank.

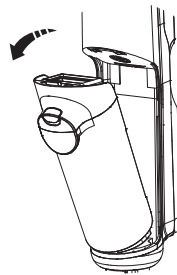

Product Installation

5. Installation and disassembly of rolling brush cover

5.1 Installation of the rolling brush cover: press down the protrusion corresponding to the notch of the rolling brush cover and it is successfully installed after hearing the click sound (as shown in Figure 1).

5.2 Disassembly of the rolling brush cover: press the center of the button on the front rolling brush cover, the rolling brush cover will automatically pop up and take out the rolling brush cover (as shown in Figure 2).

5.3 The installation and disassembly of the front and rear covers of the rolling brush are consistent.

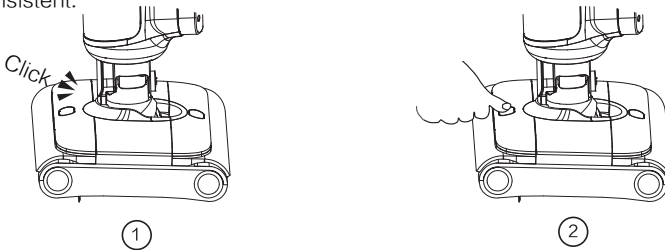

6. Installation and disassembly of rolling brush assembly

6.1 Installation of rolling brush assembly: hold the handle of the rolling brush by hand, firstly align the right end of the rolling brush with the rolling brush shaft, then put the left handle of the rolling brush into the groove, and then install the rolling brush cover (as shown in Figure 1).

6.2 Disassembly of rolling brush assembly: firstly remove the rolling brush cover, then pull up the left rolling brush handle by hand, and then pull it out to the left to remove it (as shown in Figure 2).

6.3 The installation and disassembly of the rolling brush are consistent.

6.4 Rolling brush A is correspondingly installed to the letter A side of the floor brush, and rolling brush B is correspondingly installed to the letter B side of the floor brush.

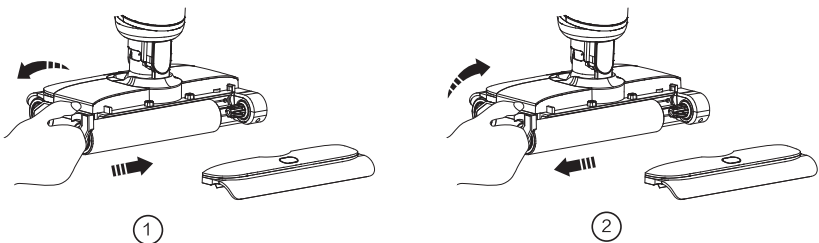

How to Use

* Tip: Please try to complete a complete charging and discharging process before using the product to ensure the accuracy of the electric quantity program.

1. Water injection of clean-water tank

1.1 Hold down the disassembly button of the clean-water tank and remove the clean-water tank (as shown in Figure 1).

1.2 Turn the bottom of the clean-water tank upward, open the clean-water tank cover, and inject clean water. Different water levels can be selected according to the clean area. If deep cleaning is required, it is recommended to add the specified cleanser in proportion (as shown in Figure 2).

1.3 Cover the clean-water tank cover and make sure it is in place (as shown in Figure 3).

1.4 Tilt the clean-water tank, firstly put the bottom in place, and then push it inward to ensure that it is installed in place (as shown in Figure 4).

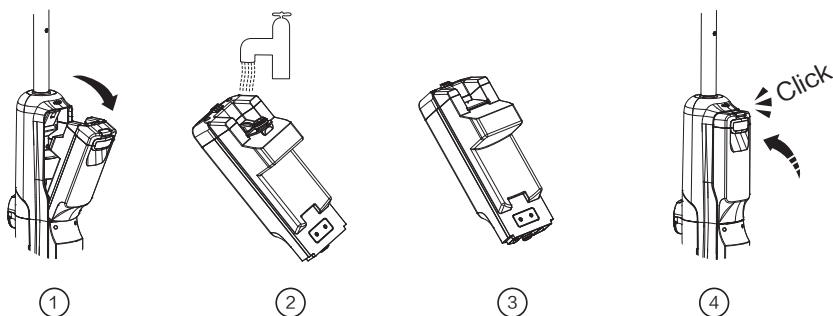

Note:

- Please do not add non-designated cleanser or disinfectant to avoid corrosion of the machine.
- Please add special cleanser according to the specified proportion, and do not add too much.
- Please do not add hot water over 60°C to avoid deformation of the clean-water tank.

How to Use

2.Start using

2.1 Step on the upper cover of the floor brush, tilt the machine body to a suitable angle, press the ON/OFF button and start the floor scrubber. At this time, the center of the screen displays the current electric quantity and mode, and the power adjustment indicator belt at the bottom of the screen shows that the machine intelligently adjusts the power and water quantity according to the dirt.

2.2 Please do not put the machine body flat or dump it to avoid dirty water flowing out.

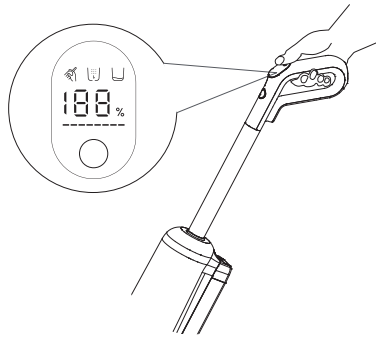

* Tip: Pressing the ON/OFF button in the charging state will not run.

3.Switch mode

Start the smart gear by default, and press the mode button to adjust the mode (smart mode, quick-drying mode).

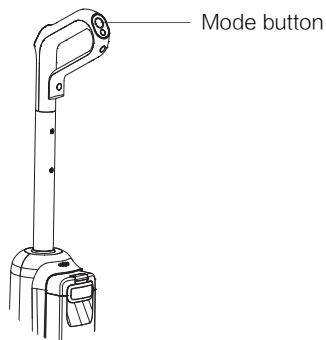

4.Stop operation

Press the ON/OFF button during operation, and the floor scrubber will stop operation and return to standby mode.

How to Use

5. Water adding and pouring

During use, when the clean water in the clean-water tank runs out, the machine will prompt by voice and screen: “The clean-water tank is short of water, please add water” . At this time, it is necessary to turn off the switch and add clean water. When the amount of water in the dirty-water tank reaches the upper limit, the floor scrubber will automatically stop and prompt by voice and screen: “The dirty-water tank is full, please clean the dirty-water tank” . At this time, it is necessary to dump the sewage in the dirty-water tank before continuing to use it.

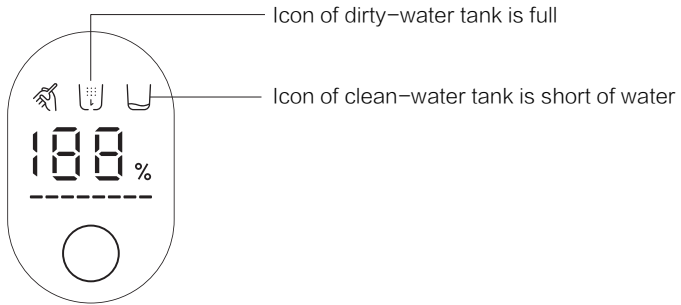

6. Dump the dirty-water tank

6.1 Hold down the button for disassembling the dirty-water tank and remove the dirty-water tank (as shown in Figure 1).

6.2 Hold the handle of the dirty-water tank with one hand, and gently pull out the dirty-water tank cover with the other hand (as shown in Figure 2).

6.3 After the sewage is poured out, install the dirty-water tank back to the machine body, and it is successfully installed after hearing the click sound (as shown in Figure 3).

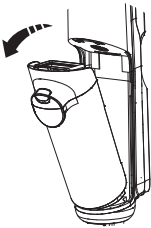

①

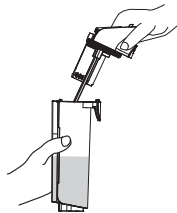

②

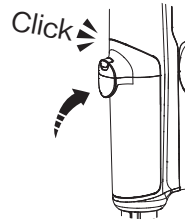

③

How to Use

7. Charging and self-cleaning

Lift the machine vertically, put it into the charging base, and hear the voice prompt “Charging”, which means that it is in place.

1) Put the floor scrubber into the charging base for charging, and ensure that there is more clean water in the clean-water tank. Press the self-cleaning button at the top of the handle to start self-cleaning, which takes about 150 seconds.

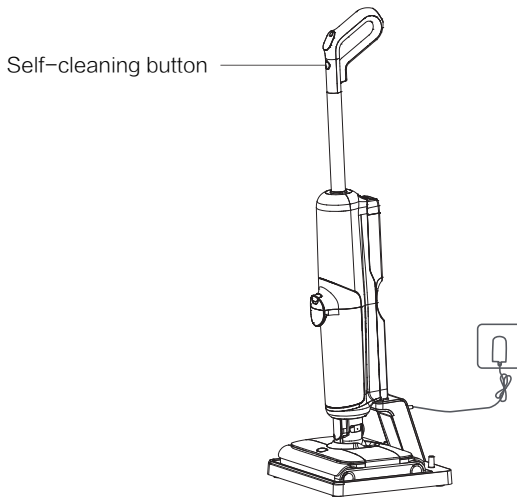

* Tip: It is recommended to self-clean after each use.

8. Voice closing/opening

Press the voice button briefly to turn off/on the voice reminding function.

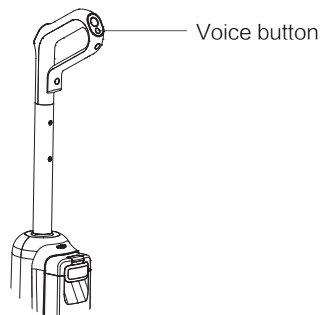

Product Care and Maintenance

1. Product care and maintenance

1.1 Please be sure to use the original parts, or you may not enjoy the warranty service.

1.2 If this product is not used for a long time, please unplug the power adapter after being fully charged and put it in a cool and dry place, and do not put it in direct sunlight or humid environment. Charge at least once every 3 months to avoid overdischarge of the battery.

2. Cleaning of the main unit

Wipe and clean the main unit with a soft dry cloth. Before cleaning, please disconnect the power adapter and ensure that the main unit stops working.

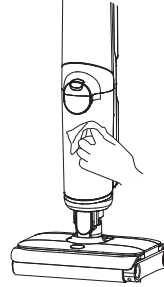

3. Cleaning of dirty-water tank and filter screen

3.1 Remove the dirty-water tank, pull out the dirty-water tank cover, and separate the upper cover of the dirty-water tank cover from the filter.

3.2 Brush the dirt on the dirty-water tank, dirty-water tank cover and filter with the attached cleaning tools, and rinse it with cold water (as shown in Figure 1).

3.3 Clean up the rubbish attached to the filter screen. If the filter screen is dirty, rinse it with cold water, and then get rid of the residual water (as shown in Figure 2).

3.4 Dry all parts thoroughly and put them back.

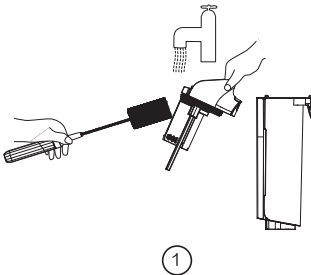

①



②

* Tips: 1) It is recommended to replace the filter screen once every six months.

2) It takes a long time for the filter screens to dry, and two filters can be used alternately.

3) It is forbidden to touch the surface of the filter screen with hands, brushes or sharp objects to avoid damaging the filter screen.

Product Care and Maintenance

4. Cleaning of rolling brush

4.1 Remove the rolling brush cover firstly, pull up the handle of the left rolling brush and then remove the rolling brush (as shown in Figure 1).

4.2 Use the attached cleaning tools to remove the hair and/or debris from the brush head (as shown in Figure 2).

4.3 Then rinse the rolling brush with clean water (as shown in Figure 3).

4.4 After cleaning, install the rolling brush back (as shown in Figure 4).

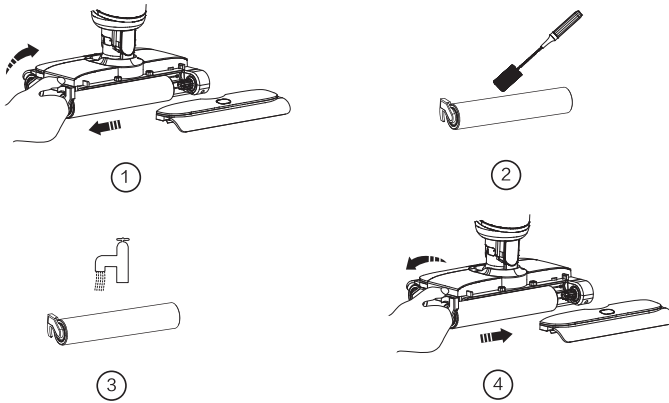

* Tips: 1) It is recommended to dry the rolling brush after cleaning.

2) It is recommended to replace the rolling brush once every six months.

8. Cleaning of dirty water pipes

Please remove the dirty-water tank, wipe the dirt in the pipe with a wet rag, and clean the rolling brush tank and dirty water pipe with cleaning tools before using it.

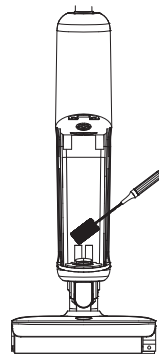

Product Parameters

Working voltage: 25.2V 

Rated power: 230W

Battery capacity: 4000mAh

Capacity of clean-water tank: about 800ml

Capacity of dirty-water tank : about 600ml

Net weight: about 5.3kg

Product dimension: 235*288*1100mm

Noise: about 78dBA

Adapter input: 100-240V~50/60Hz 0.8A

Adapter output: 31V  1A

Charging time: 4~4.5h

Endurance: smart gear about 35min

*The above data comes from our laboratory, and the actual usage may be different according to the change of usage environment, please refer to the actual usage.

* Our company reserves the right to make any technical and design changes to the products due to the continuous improvement of the products, and the right of interpretation belongs to the company.

Description of hazardous substances in the product

Component Name	Hazardous substance					
	Pb	Hg	Cd	Cr(VI)	PBB	PBDE
Plastic	○	○	○	X	○	○
Metal	○	○	○	○	○	○
PCBA	○	○	○	○	○	○
Other metal structural components	○	○	○	X	○	○
Standard parts (screws / washers, etc.)	○	○	○	X	○	○
<p>This form is compiled according to SJ/T 11364-2014.</p> <p>○ indicates that the content of the hazardous substance in all homogeneous materials of the part is below the limit specified in GB/T 26572-2011.</p> <p>X indicates that the content of the hazardous substance in at least one homogeneous material of the component exceeds the limit specified in GB/T 26572-2011.</p> <p>X component shows that due to the current global technical and technological level limitations, it is impossible to completely replace non-environmental substances or elements, which will be gradually improved with the technical improvement.</p> <p>※ means that only some model parts contain this part.</p>						



Failure Recovery

Common failure	Possible reason	Solution
Main unit does not work	Handle not installed in place	Please reinstall to ensure that it is in place before use
	The main unit has no power or insufficient power	Please fully charge the main unit before using it
	The rolling brush is not installed in place/the rolling brush is entangled with hair and stops rotating	Reinstall or clean the rolling brush
	Dirty-water tank is not installed in place	Reinstall the dirty-water tank
	Dirty-water tank is full	Dump the dirty water in the dirty-water tank before use
Machine suction is weakened	Filter element blockage	Please clean the filter element
	Rolling brush cover, filter element and clean-water tank are not installed in place.	Confirm whether it is installed in place before use
	The rolling brush is entangled with hair	Remove the winding of the rolling brush before use
	Foreign matter or blockage in the pipeline	Please clean the pipeline
There is abnormal noise in motor operation	Excessive dirty water in the dirty-water tank	Dump the dirty water in the dirty-water tank before use
	The suction port is blocked	Clear the obstacles in the suction port
When charging, the screen power prompt icon is not displayed	The power adapter is not connected to a power socket	Check whether the power adapter is plugged in
	The connection between the power adapter and the charging base is not in place	Check whether it is in good connection
	The docking between the main unit and the charging base is not in place	Please confirm that the main unit is placed correctly
No water from the main unit	Clean-water tank is not installed in place/clean-water tank is short of water	Reinstall or add water to the clean-water tank
Water leakage from air outlet	The filter element is not dried after cleaning	After cleaning, make sure to dry it before use
Self-cleaning does not work	The rolling brush may get stuck by large particles	Open the rolling brush cover for inspection and cleaning
	The machine is not charging	Ensure that the main unit starts the self-cleaning function again when it is in the charging state
	The power of the machine is less than 10% and cannot start self-cleaning	In the charging state, start the self-cleaning function when the power is greater than 10%
	Dirty-water tank is not installed in place/dirty-water tank is full of water	Reinstall or dispose of the dirty-water tank

Warranty Card

Thank you very much for purchasing “TAB” series of smart products! In order to guarantee your legitimate rights and interests, TAB customer center has made a standard service commitment to you, and will wholeheartedly provide you with relevant services when you need it.

Warranty Card

Model	
Purchasing date	MM/DD/YY
User name	Name
	Address
Shop of purchase	Order No.
	Name
	Tel.
	Address

Term of service

Product series	Term of service
Whole machine	2 years
Battery	12 months
Rolling brush and other easily-consumed products	No warranty

Warranty principles

01. If there are quality problems in the purchased product, it can be replaced at the purchase site within 15 days without artificial damage, dismantling or repair;
02. Purchase this product and enjoy free home repair during the warranty period.
03. If the warranty is beyond the scope of free warranty, the corresponding spare parts fee, labor fee and transportation fee shall be charged during maintenance.
04. The warranty service is only valid under normal use, and the man-made damage and the following situations are not covered by the free warranty.
 - a. The damage caused by human factors, including the damage caused by using it in abnormal working environment and not using it according to the manual, etc.;

Warranty Card

Warranty principles

- b. The machine is disassembled, repaired or modified by the user without permission or not maintained by the maintenance department of our company;
- c. Damage caused by force majeure (such as fire, earthquake and lightning strike, etc.);
- d. Without warranty card and valid purchase certificate and unable to verify the user information file.
- e. Unable to verify the date of purchase.
- f. For non-domestic use.
- g. The connection is not suitable for the accessories of this product, and the product is damaged due to transportation and other accidents.

Cautions

- 01. Please keep the warranty card of this product properly.
- 02. When you need to maintain the product, please fill in the warranty information completely to ensure that the font is neat, clear and easy to identify.
- 03. When you enjoy after-sale service, please show your product warranty card and related purchase information.
- 4. You can call our after-sale service hotline: 4006 999 999. You can also choose to download the “Haier Smart Home” APP for self-service repair service.



Warranty Terms

The after-sales service of this product strictly follows the Consumer Rights Law of the People's Republic of China and the Product Quality Law of the People's Republic of China, and the service contents are as follows:

Term of Service and Description

- 1) If there is a non-human performance failure within 7 days from the date of purchase, you can choose to return, exchange or repair it;
- 2) If there is a non-human performance failure within 15 days from the date of purchase, you can choose to exchange or repair it;
- 3) If there is a non-human performance failure within the warranty period from the date of purchase, the company promises free warranty.

Certificate of Quality

Inspector:

Qingdao TAB Robot Technology Co., Ltd.

Address: No.127, Huizhiqiao Road, High-tech Zone, Qingdao, Shandong Province

Version: Version 1 in 2022