



Wireless IP Camera

QUICK SETUP GUIDE

Content

1. What's in the Box	1
2. Working Diagram	1
2.1 Works Standalone	1
2.2 Works as an Add-on Cam	2
3. Camera Introduction	3
4. Set up the Camera	5
4.1 Set up the Camera Wirelessly	5
4.2 Set up the Camera with an Ethernet Cable	8
4.3 App Live View	11
5. Install a SD Card	12
6. Install the Camera	13
7. Pair the Camera to XMARTO NVR	15
8. Zoom and Advanced PTZ Settings	17
8.1 Digital Zoom	17
8.2 Optical Zoom	18
8.3 Advanced PTZ Settings	18
9. Troubleshooting	19
10. Notification of Compliance	20

1. What's in the Box

DISCLAIMER: The exact components of your camera, images and quantities may vary depending on your model number. While these may vary, this QSG will address the setup of your camera.

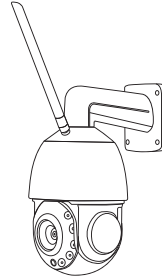
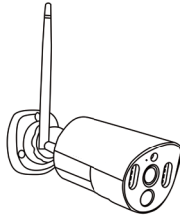
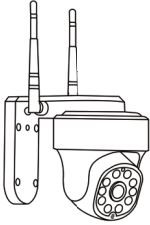

Camera

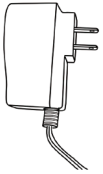

Power Adapter

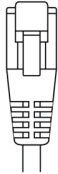

Network Cable

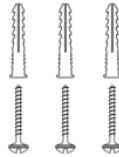

Pack of Screws



Quick Start Guide

2. Working Diagram

2.1 Works Standalone

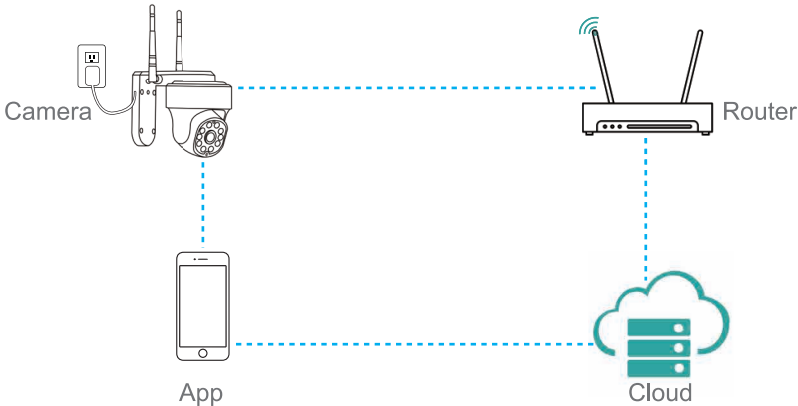

2.2 Works as an Add-on Cam

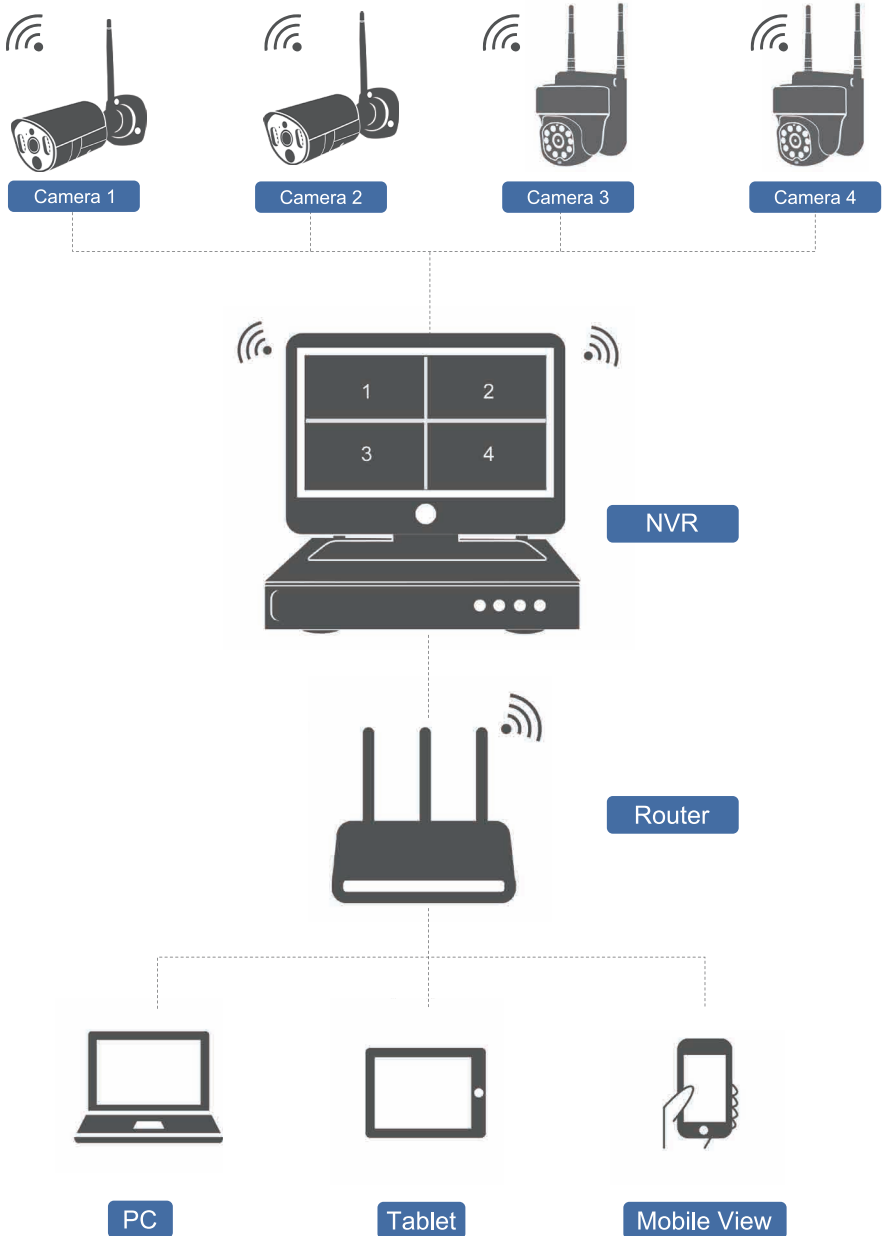

3. Camera Introduction

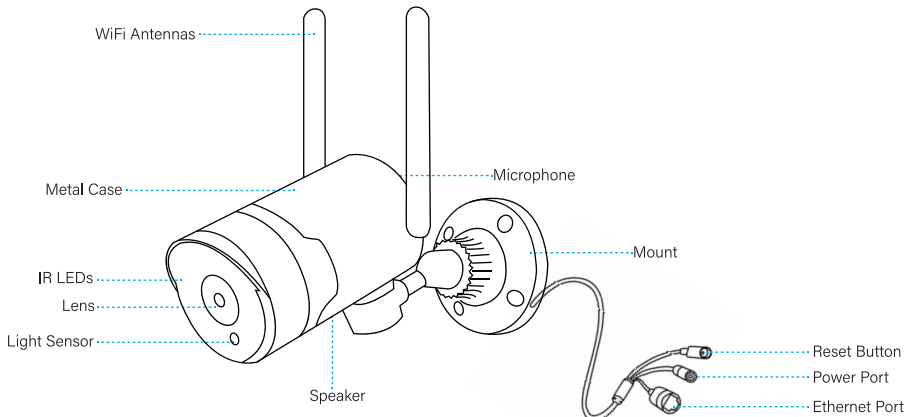
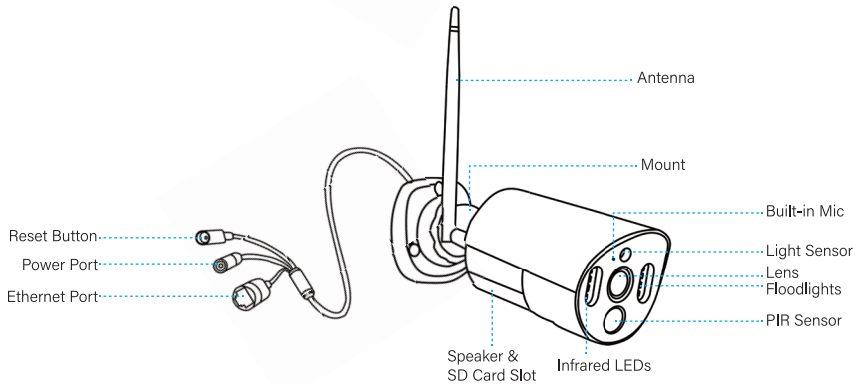
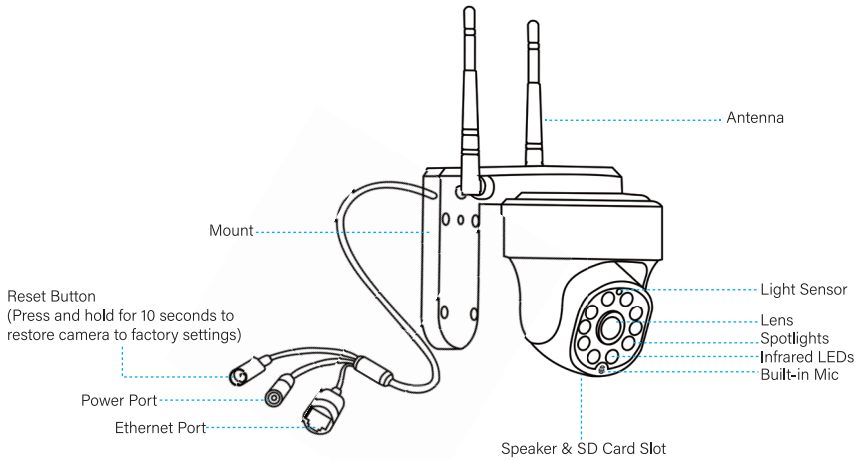

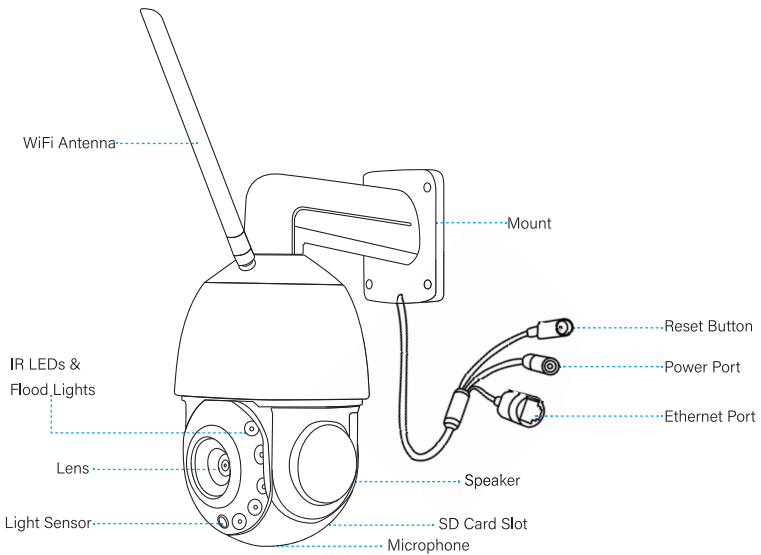
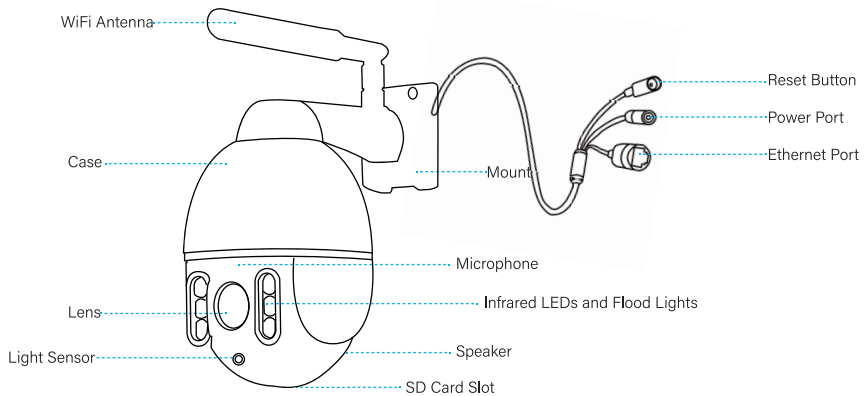

NOTE: Different types of cameras are included in this section. Please check out the camera included in the package and check out the details from the corresponding introduction above.

The actual appearance and components may vary with different models of products.

4. Set up the Camera

Preparation: Download and Install the App

1. Download the WallPixel App from the App Store or Google Play Store and install it on your smart device.

You can scan the QR code to find the App.



WallPixel



iOS



Android

2. Create an user account and login. Tap the + symbol to add a device.

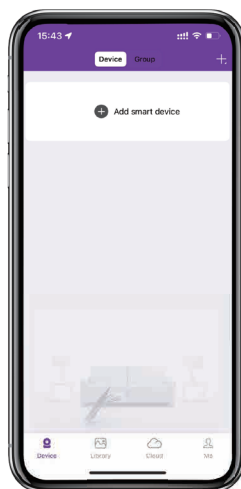
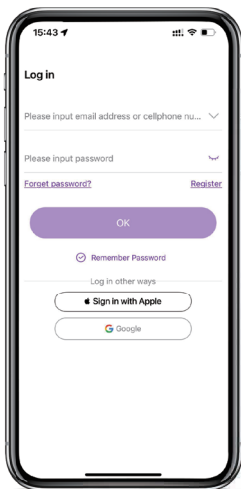

Set up the Camera

There are two methods to do the initial setup,

1. Set up the camera wirelessly
2. Set up the camera with an Ethernet cable

4.1 Set up the Camera Wirelessly

1. Bring the camera near to your router and plug it to power with the power adapter included. The camera will start to run and enters to configuration mode.

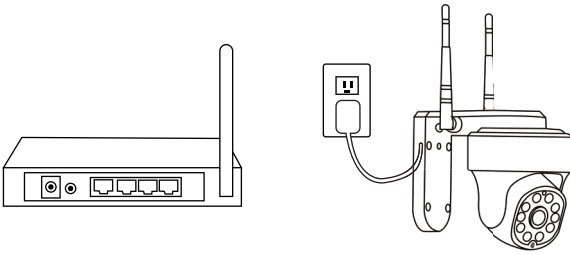

Configuration mode sign: constant beeps and LED indicator flashes.

2. In App, tap + on top right, then tap **Add**. Choose your camera type.

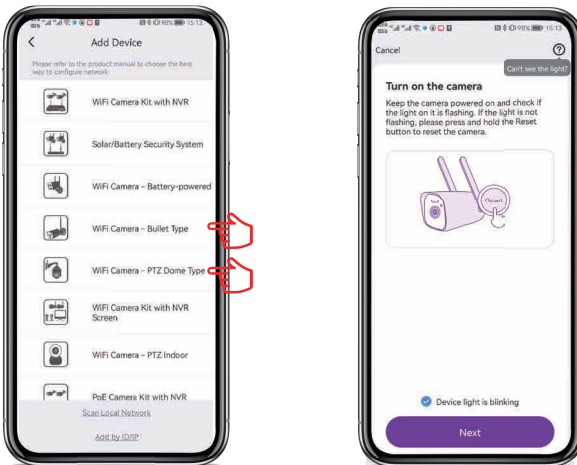

3. Follow on-screen guide, select your home Wi-Fi (2.4G) and input your Wi-Fi password, the App will generate a QR code of your Wi-Fi information.

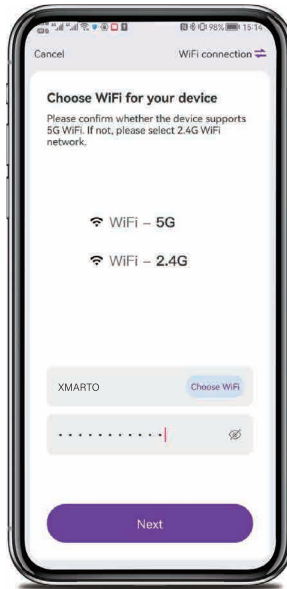

NOTE: The camera works with 2.4G Wi-Fi only.

4. Use the camera lens to scan the QR code on screen till you hear a prompt tone. Tap "Heard the prompt tone" when you hear it.

NOTE: The QR code will be generated and displayed on your phone. Please hold your phone in front of the camera at a distance of about 20cm (8 inches) and have the phone face the camera lens to let the camera scan the QR code.

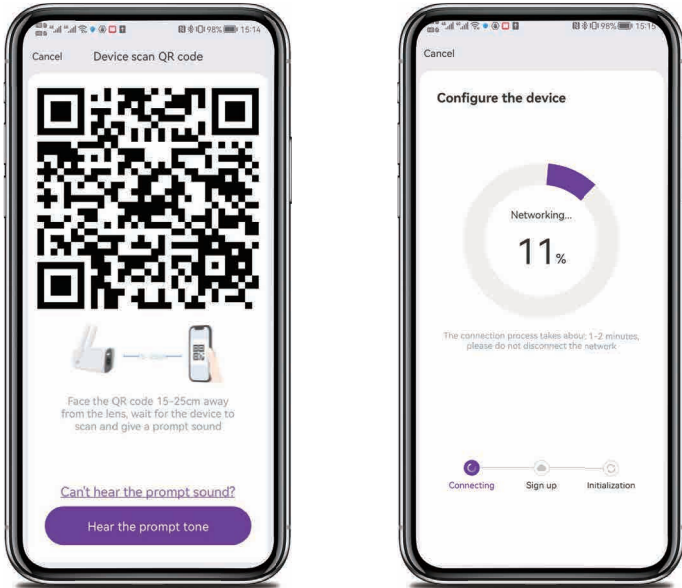

5. Then follow the on-screen steps to complete setting up the camera.

NOTE: If the camera was not added successfully, hold the reset button to reset and try again. Make sure to provide CORRECT Wi-Fi hotspot and password.

OR

4.2 Set up the Camera with an Ethernet Cable

1. Power on the camera with included DC power adapter, connect the camera to your router's LAN port with the included Ethernet cable. The camera will start to run and enters to configuration mode.

Configuration mode sign: constant beeps and LED indicator flashes.

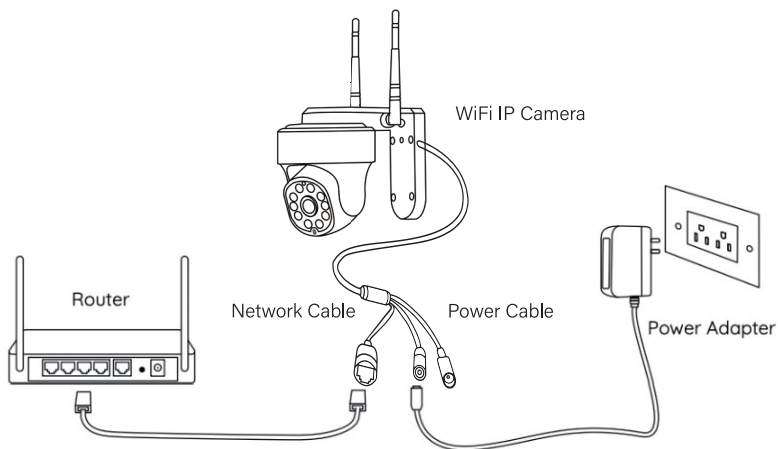

2. In App, tap + on top right. Then **Scan Local Network** or **Scan QR Code** to add the camera. (Leave admin password area empty.) You shall be able to see the camera in your device list already.

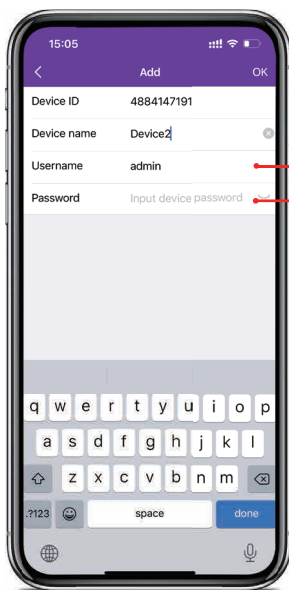
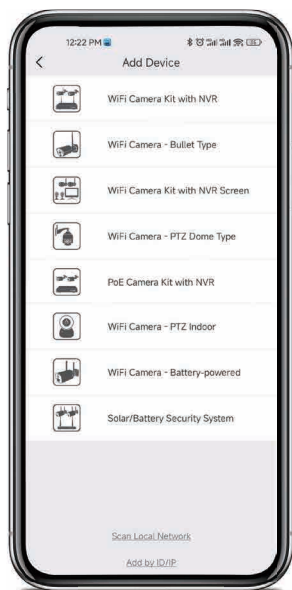

Default username is admin.

Default password is empty, leave it blank.

You can set a password for your camera later in camera's Settings.

3. Enter **Camera's Settings - Advanced Setting - Connect New Wi-Fi**, connect the camera to your Wi-Fi and then you can unplug the camera from router and mount it within Wi-Fi range.

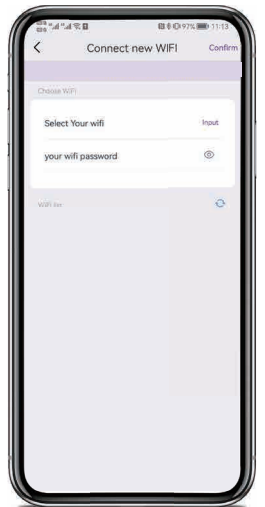
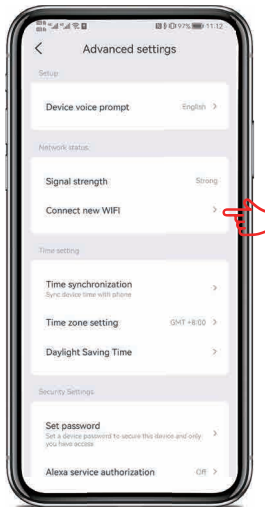
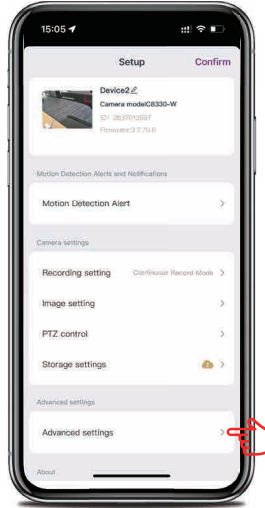
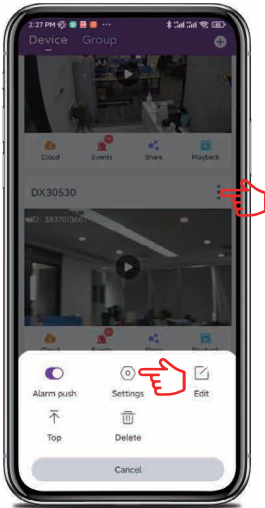

4.3 App Live View



Add Device

Add devices to your app and access your footage.

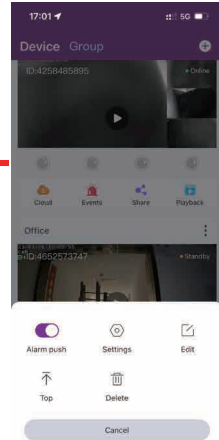
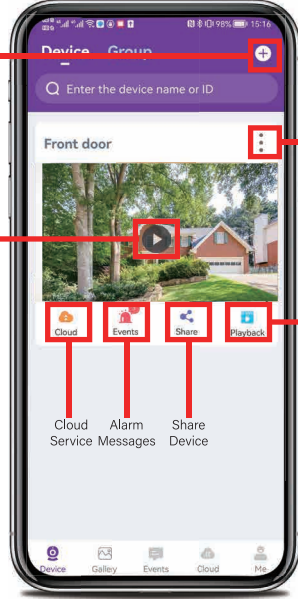

Device Setting

Edit or delete your device, turn on/off the app notifications.

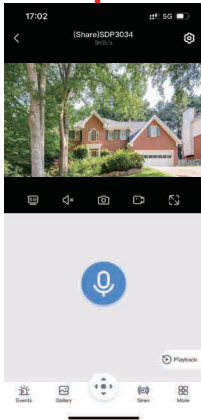

Live View

Displays real-time footage of your system.

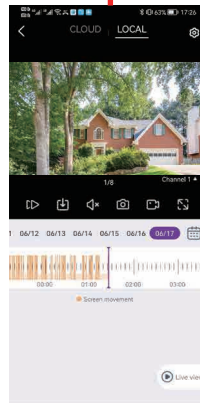

Playback

Playback recorded videos from your app.

5. Install a SD Card

Install the Micro SD Card (Optional)

Install a micro SD card to the camera for recording.
(8~512GB SD Card)

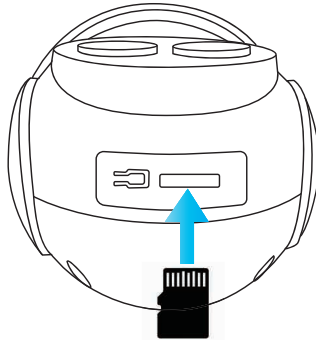
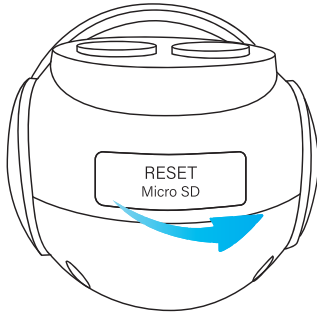

1. Remove the cover on the camera.
2. Insert a Micro SD card into the card slot. (SD card not included)
3. Place the cover back on.

NOTE: After the Micro SD card installed, please go to App - Camera's Settings to format the SD card to start recording.

6. Install the Camera

- Install the camera 2-3 meters (7-10 ft) above the ground. This height maximizes the detection range of the motion sensor.
- For dome cameras, they MUST be installed upside down for better waterproof performance and better motion sensor's efficiency.
- For better motion detection performance, please install the camera angularly.

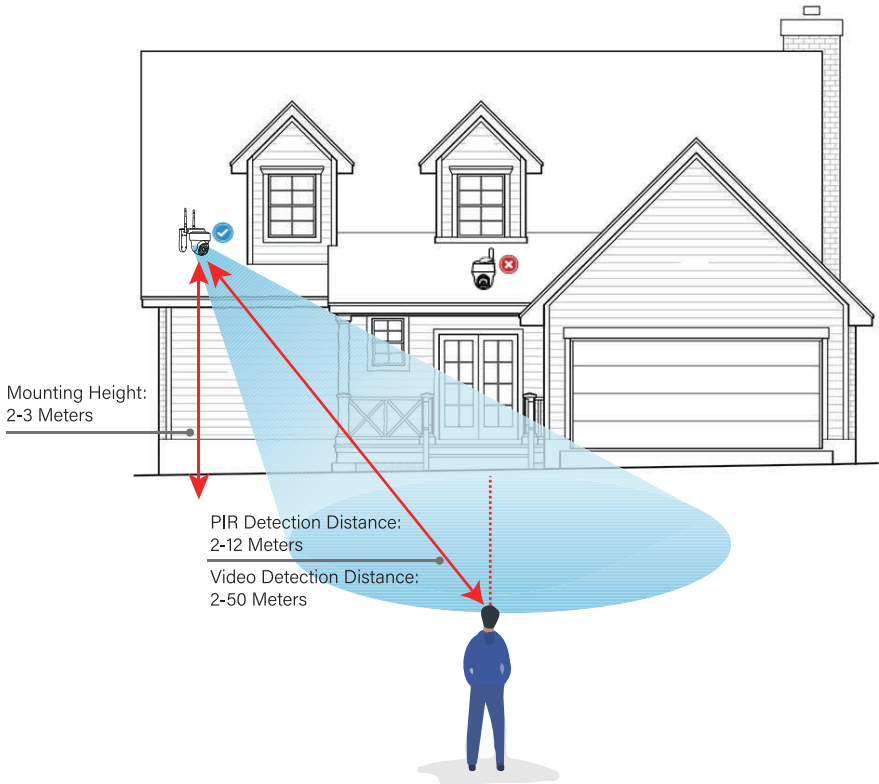

Installation Tips

- Do not face the camera towards any light sources.
- Do not point the camera towards a glass window. Or, it may result in poor image performance due to the window glare from infrared LEDs, ambient lights or status lights.
- Do not place the camera in a shaded area and point it towards a well-lit area. Or, it may result in poor image performance. For better image quality, please make sure that the lighting condition for both the camera and the captured object is the same.
- For better image quality, it's recommended to clean the lens with a soft cloth regularly.
- Make sure the power ports are not exposed to water or moisture or blocked by dirt or other elements.
- Do not install the camera in places where rain and snow may hit the lens directly.
- The camera may work in extremely cold conditions as low as -25°C as it will produce heat when powering on. You may power on the camera indoors for a few minutes before installing it outdoors.

7. Pair the Camera to XMARTO NVR

The camera works standalone. It can also work as an add-on camera. You can add it to your existing XMARTO NVR or system.

1. Bring the camera close to the NVR and plug it to power with included power adapter. Your camera will start run and enters to configuration mode soon.

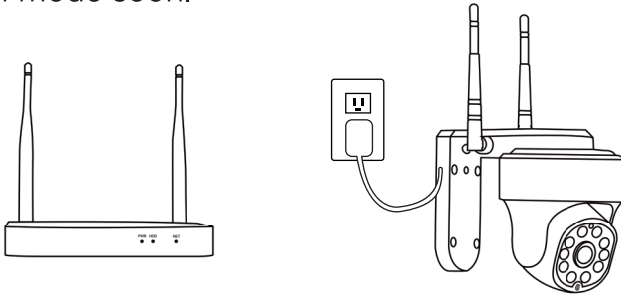

Configuration mode: constant beeps and LED indicator flashes

2. You can now start pairing the camera to NVR.

For NVR version 3.4 or earlier

Run Add Cam by WiFi on NVR monitor and follow on-screen instructions to add the camera to NVR.

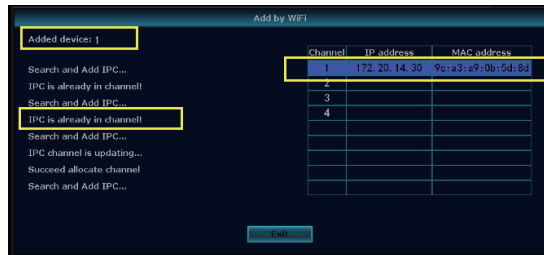
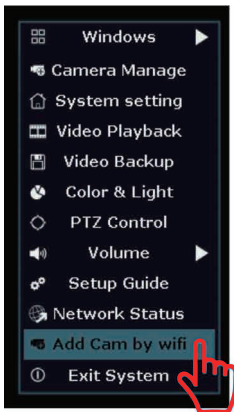

For NVR version 3.5+

Click the + icon and follow on-screen instructions to add the camera to NVR.

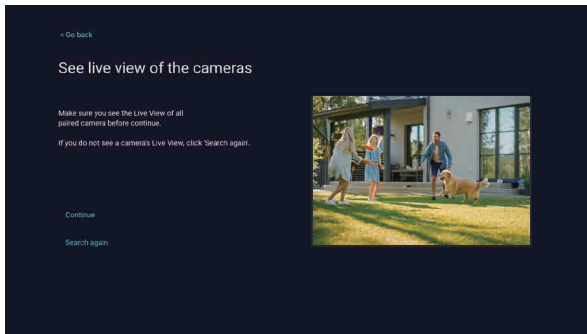
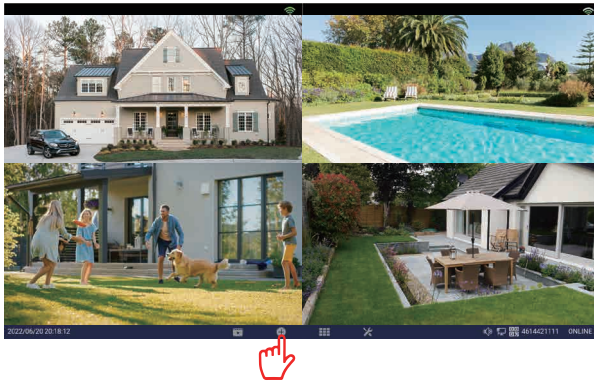

3. Once the camera is added to the NVR, you'll see it displays video on the monitor. You can then go ahead to mount the camera.

NOTE: Please mount the camera within NVR's WiFi range.

4. If you failed to add the camera to NVR, hold the camera reset button for about 10 seconds to reset the camera, then pair it to the NVR once again.

8. Zoom and Advanced PTZ Settings

8.1 Digital Zoom

While viewing the camera's image, use 2 fingers to zoom in and zoom out the image.

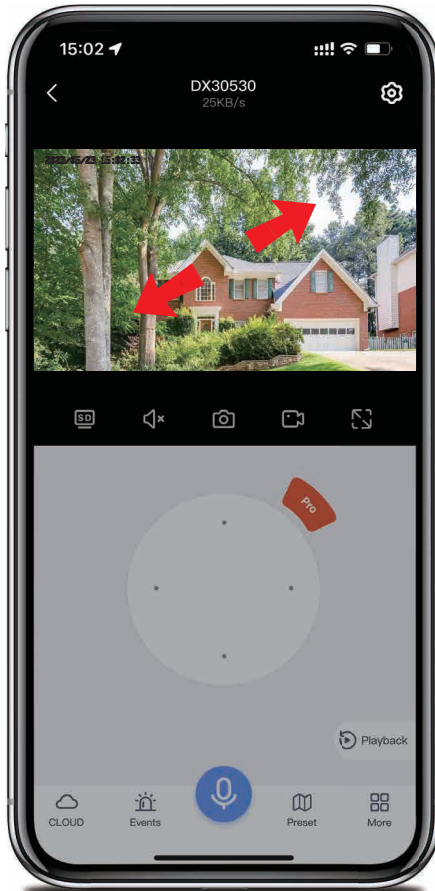

8.2 Optical Zoom

For cameras with optical zoom, tap **Pro** to enter optical zoom menu. Tap the +/- to zoom in and out.

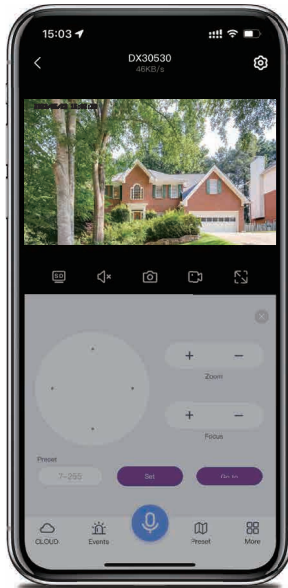

NOTE: Most cameras have only digital zoom unless otherwise advised. Optical zoom menu will not work for cameras without optical zoom.

8.3 Advanced PTZ Settings

If your camera is a PTZ camera with advanced PTZ settings, it shall come with an extra Command Code Manual. Please refer to the Command Code Manual for advanced PTZ settings.

The Command Code Manual can also be downloaded from xmarto.com.

9. Troubleshooting

Camera does not Power on

If your camera does not power on, please try the following solutions:

- Camera only supports one power extension cable, do not use two extension cables.
- Plug the camera into a different outlet and see if it works.
- Power on the camera with another working power adapter and see if it works.

Pan & Tilt is not Working

If the pan & tilt is not working, please try the following solutions:

- Make sure your camera has at least 3-bar WiFi signal.
- Power cycle the camera and see if it will automatically pan/tilt. If not, the camera may be faulty. If yes, please refer to the further steps.
- Upgrade the WallPixel App and the camera firmware to the latest version.
- Restore the camera to factory settings and check the pan/tilt again.

IR LEDs Stop Working

If you find the IR LEDs of your camera stop working, try the following solutions:

- Please go to Live View and check the night vision mode. Set the mode to Auto to activate the IR lights.
- Upgrade your camera's firmware to the latest version.
- Restore the camera to the factory settings and check the IR light settings again.

If you need further help, please contact XMARTO Support via email support@xmarto.com

10. Notification of Compliance

FCC Compliance Statement

This device complies with Part 15 of FCC Rules. Operation is subject to the following two conditions: (1) this device may not cause harmful interference, and (2) this device must accept any interference received, including interference that may cause undesired operation.

Limited Warranty

This product comes with a 1-year limited warranty that is valid only if purchased from XMARTO official stores or a XMARTO authorized reseller.

NOTE: We hope that you enjoy the new purchase. But if you are not satisfied with the product and plan to return, we strongly suggest that you reset the camera to factory default settings and take out the inserted SD card before returning.

Terms and Privacy

Use of the product is subject to your agreement to the Terms of Service and Privacy Policy at xmarto.com. Keep out of reach of children.

End User License Agreement

By using the Product Software that is embedded on the XMARTO product, you agree to the terms of this End User License Agreement ("EULA") between you and XMARTO.

ISED Radiation Exposure Statement (For WiFi Version)

This equipment complies with RSS-102 radiation exposure limits set forth for an uncontrolled environment. This equipment should be installed and operated with minimum distance 20cm between the radiator & your body.

CONTACT US

Email:

support@xmarto.com

Website:

24/7 Product Support

FAQs

How-to Videos

Manuals

www.xmarto.com

iPhone, iPad, Mac and Mac OS X are registered trademarks of Apple Inc. Windows, Windows XP, Windows Vista, Windows 7, Windows 8 and Windows 10 are registered trademarks of Microsoft Corporation in the United States and/or other countries.

FCC RADIATION NORM

FCC

This device complies with Part 15 of the FCC Rules. Operation is subject to the following two conditions: (1) this device may not cause harmful interference, and (2) this device must accept any interference received, including interference that may cause undesired operation.

FCC Compliance Statement

These limits are designed to provide reasonable protection against frequency interference in residential installation. This equipment generates, uses, and can radiate radio frequency energy, and if not installed or used in accordance with the instructions, may cause harmful interference to radio communication. However, there is no guarantee that interference will not occur in television reception, which can be determined by turning the equipment off and on. The user is encouraged to try and correct the interference by one or more of the following measures:

- Reorient or relocate the receiving antenna.
- Increase the separation between the equipment and the receiver.
- Connect the equipment into an outlet on a circuit different from that to which the receiver is connected.
- Consult the dealer or an experienced radio/TV technician for help.

CAUTION!

The Federal Communications Commission warns the user that changes or modifications to the unit not expressly approved by the party responsible for compliance could void the user's authority to operate the equipment.

This equipment should be installed and operated with a minimum distance of 8 inches between the radiator and your body.