

Projector E2 Pro

Quick Start Guide

Power on

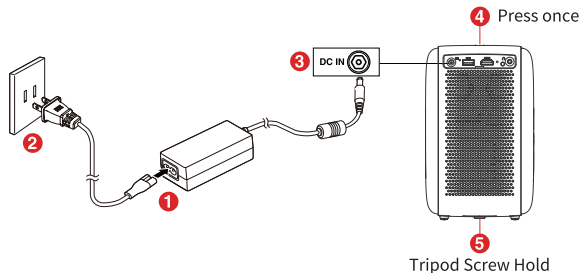

The ETOE projector has a built-in Android TV system, which is the best way to enjoy your favorite videos, TV shows, and games.

- Set up the projector: Turn on the projector, choose your language, and pair the remote.
- Set up Android TV: Follow the setup wizard on Android TV, select your language, set up a Wi-Fi connection, sign in to a Google account, and carry out other related procedures.
- When you complete the Android TV setup wizard, the Android TV home screen will appear. Now you can start watching your favorite shows by downloading streaming apps.

Remote control

The remote controls the projector and built-in Android TV system. Press to go to Android TV system. Press once to go to projector homepage.

- When the indicator turns blue, Bluetooth mode will be enabled for control of the built-in Android TV system.
- When the indicator turns red, IR mode will be enabled for control of the projector system.

1.
 - Press the button once: power on
 - Press the button twice: power off
2. Mutes the projector's audio
3. Press to confirm a selection or entry
4. Navigate menus or adjust the selected content
5. Return to the previous menu
6. Activate Google assistant, Google's voice-powered virtual assistant service
7. Press the button for once, go to Android TV homepage
8. Volume down / up
9. Preset Netflix button
10. Preset Prime Video button
11. Adjust the focus for the projector
12. Press the button once, go to projector Homepage

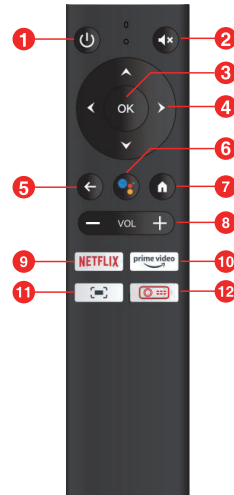

Chromecast (wireless connection)

The Chromecast feature only works while you are in the Android TV system.

- Cast from Chromecast-enabled sites/apps (for Android/iOS devices)
 - ① Make sure your device and the Android TV (HAKO mini) are connected to the same Wi-Fi network, and that you are running the latest version of the Chromecast-enabled app.
 - ② Launch the Chromecast-enabled site/app.
 - ③ Tap the cast button and choose the HAKO mini.
- Cast from Chrome browser tab (for computers)
 - ① Connect your computer and projector to the same Wi-Fi network.
 - ② Click "Cast" at the top right of the Chrome browser tab, and then choose from the sources whether you want to cast the tab or the screen.
 - ③ Choose the HAKO mini to cast.

- Mirror from Android devices
 - ① Make sure your Android device is on the same Wi-Fi network as your Android TV (HAKO mini) .
 - ② Download the "Google Home" app on your Android device.
 - ③ Open the "Google Home" app, choose "HAKO Mini."
 - ④ Tap "Cast my screen".
- Mirror from iOS devices
 - ① Make sure your iOS device is connected to the same Wi-Fi network as your Android TV (HAKO mini) .
 - ② Download the " AirScreen" app from the Google Play Store of Android TV system.
 - ③ Open the "AirScreen" app and follow the on-screen instructions on AirScreen.

Need help?
Just reach out to us directly.



support@etoe-tech.com

Wired Connections

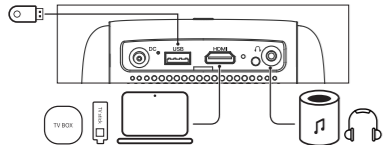

1. Connect to an HDMI playback device

This projector supports connections with various HDMI playback devices such as PC, TV stick, TV box, DVD player, set-top box (STB), game console or other devices.

- ① Connect this projector to an HDMI playback device with an HDMI cable (not provided).
- ② Press the button on remote control to go to projector homepage, select **[HDMI]**, and press.

2. Connect to a flash drive

With this projector, you can enjoy music, video, and pictures, that are stored on a USB storage device.

- ① "Plug in the USB storage device.
- ② Press the button on remote control to go to projector homepage, select **[USB]**, and press.
- ③ Select the file you plan to play from the file and folder menu.
- ④ Press **[OK]** to start playing.

3. Connect to a headphone via AUX cable

You can connect a headphone or speaker to ETOE Projector via AUX cable as well.

- ① Plug in the 3.5mm AUX cable connector to ETOE projector AUX port.
- ② Plug the other connector of the 3.5mm AUX cable to your headphone or speaker.
- ③ Play your media on projector.

Keystone correction

The keystone effect refers to when the projected image is noticeably wider at one side. It occurs when the projector is not perpendicular to the screen.

- ① To correct the keystone effect, click the switch button to go to projector homepage, and select **Settings** → **Projection Settings** → **Vertical Correction/Horizontal Correction** to adjust.

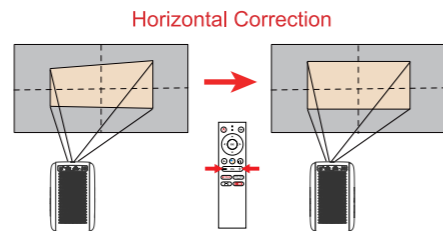
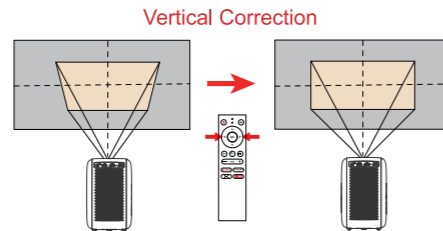

- ② If the projected image is stretched or distorted along both axes due to the angle projection, select **Settings** → **Four Point Correction**, choose the corner you want to adjust, and follow the on-screen instructions to correct the image.

Four Point Correction

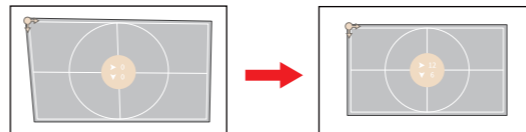

Keystone correction reset

To restore the default settings, select **Keystone Correction Reset** and press "OK"

FAQ

① Can I watch Netflix with this projector?

Yes. It has a built-in Android TV system, and Netflix is one of the default apps. You can also download other apps, such as Disney+, Hulu, and other streaming apps.

② Does it work with Dolby Audio?

No, the projector does not support Dolby Audio. If you are watching videos with Dolby Audio, please turn off all Dolby Digital-related output on your video resource (e.g., TV stick or Android TV system).

③ What's the fully sealed optical engine?

An optical engine is an important part of a projector. Most projectors use the open optical engine, while the ETOE projector applies a fully sealed optical engine. This prevents black spots from appearing on the projected picture by ensuring that dust cannot get into the optical engine. With this specialized design, ETOE projectors work longer and don't need to be disassembled and cleaned regularly for a sharp projected picture.

④ The image is blurry for some videos. Is this normal?

The sharpness of the projected image is mainly determined by the projector resolution and the video resolution. The native resolution of the ETOE projector is 1080p. If the picture is not sharp, please make sure the output resolution of the video is 1080p.

⑤ After returning to the Android TV system, there is no response when I click the remote control.

Press the to make sure that the indicator is blue. You will then be able to control the Android TV system with the remote control as normal.

⑥ Do I need to keep updating the system?

The projector has two systems. One is the Android TV system, which updates automatically on approval. The other one is the projector system, which doesn't need updating. To improve the performance of the projector system, please contact support@etoe-tech.com for instructions on how to update it.

⑦ The sound is quite low when watching videos on YouTube.

You can adjust the volume for each of the two systems. Just press to go to the projector interface and adjust the volume. Similarly, press to go to the Android TV interface to adjust the volume.

⑧ Can I connect to Bluetooth speakers/headphones?

Yes. In the Android TV system, go to **Settings** → **Remotes & Accessories** → **Add accessory**, and find and pair your Bluetooth speaker or headset.

⑨ I've lost the remote control. Where can I get a replacement?

Please contact support@etoe-tech.com for a replacement remote control. You will still be able to control the Android TV system by downloading the remote app on your smartphone.

Make sure your device is connected to the same Wi-Fi network as the projector, Bluetooth is turned on, and your Android/iOS device is updated to the newest version.

• Android devices:

Download the "Android TV Remote" app from Google Play, open the app, and connect to **HAKO mini**.

• iOS devices:

Download "Android TV" from the App Store, open the app, allow it to use the local network to set up and control your connected devices, and connect to **HAKO mini**.

⑩ Why does a video keep turning on while I am on the projector homepage?

If you are idle on the homepage for more than 5 minutes, the projector will automatically enter **Companion Mode**, which acts as a screen saver. You can mute the video or click the back button to exit. Go to **Settings** → **Other Settings** → **Screen Saver** to turn this feature off or set a timer for it.

⑪ Does the projector have a sleep timer?

Yes. Press the power button on the remote control and choose the **shutdown Timer** with the right arrow or go to **Settings** → **Shutdown timer** to set the timer.