

SDS MINI
Electric Drill Structure Diagram

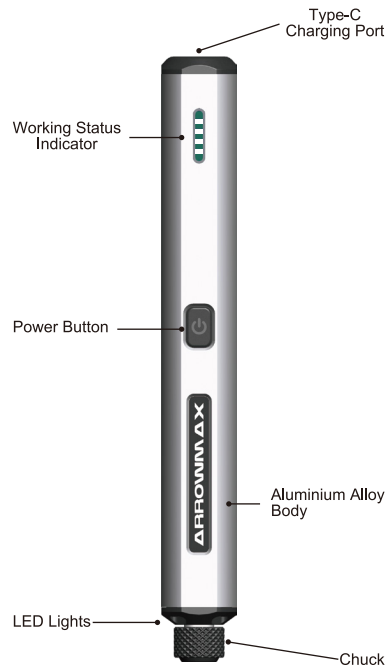

Thank you for choosing SDS MINI (Mini Electric Drill).
Please read the instructions manual carefully.

Product description:

SDS MINI design has only one power button, and light dynamic display of working status. The four LED lights on the head will light up automatically while working.

The SDS MINI handle comes in quadratic shape with curved surface to achieve the best control and grip during operation. The specially formulated high-capacity LiPo battery makes more efficient use of the internal space of the product, and the LiPo battery capacity reaches 350mAh. With wireless T-C charging design, it can be used for 2 hours when fully charged in 50 minutes. The standby time can be up to 60 days, and the LiPo battery we use has passed the US TUV certification.

SDS MINI is also quite simple to replace the drill bit, no need to use other tools, just loosen the chuck to easily remove and insert the drill bit, tighten the chuck for immediate operation.

SDS MINI comes with an aluminum alloy storage box, which is convenient for storage and manage of all accessories. Containing 10 common sizes and replaceable HSS drill bits on the market. The parts are CNC precision machined from the inside out. The concentricity of the shaft is less than 0.03mm, every job is precise and neat!

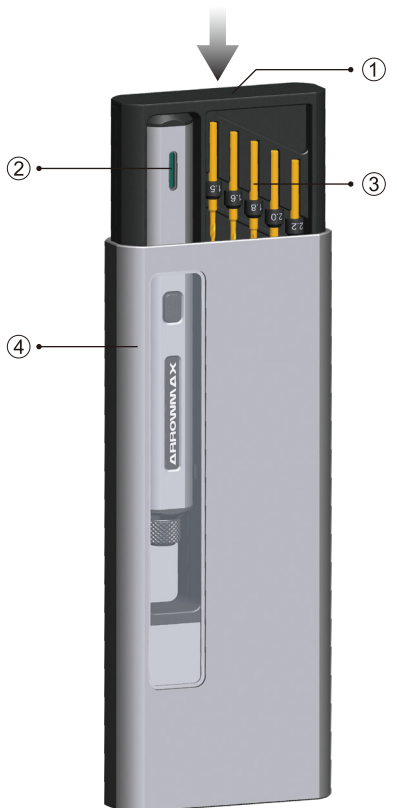

- ① - Inner Box
- ② - SDS MINI Electric Drill
- ③ - Drill Bits
- ④ - Storage Box

Storage Instructions:

- ✓ Press the top of the storage box, the inner box of the storage box pops out to open.
- ✓ Press the top of the inner box once more to close the storage box.

SDS MINI storage:

- ✓ The SDS MINI is fixed in the inner box of the storage box in the form of a buckle.
- ✓ After use, place the SDS MINI back into inner box.
- ✓ Drills are fixed in the inner box.
- ✓ After use, place the bit back into position.

Installation of bits:

- ✓ Take out the bit from the inner box of the storage box. ① Loosen the chuck. ② Place the bit. ③ Tight it up.

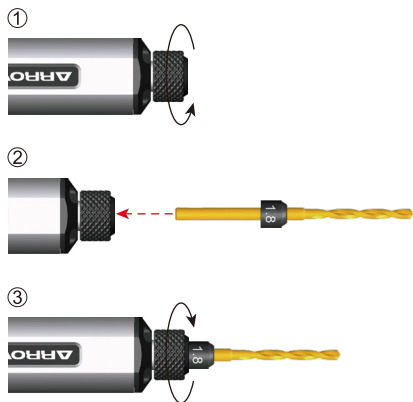

Working Status:

Press the power button, dynamic indicator lights from bottom to top, the drill bit is in forward direction.
Press the power button again, dynamic indicator lights from top to bottom, the drill bit is in reverse direction.
Press the power button again to stop. The indicator shows the current remaining battery:
4 lights (100%) / 3 lights (75%) / 2 lights (75%) / 1 light (25%).

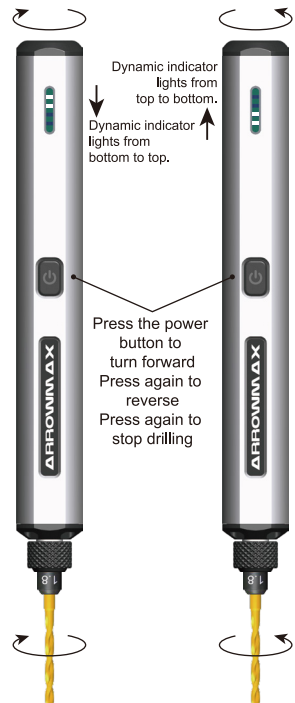

Product parameters:

Product model: SDS MINI
Battery voltage: 3.7V
Size: 15 x 15 x 120 mm
LiPo battery: 350 mAh
Weight: 48g
No-load speed: 550r/min
Electric maximum torque: 2.0kgf.cm
Charging time: 50 minutes

Product list:

(1x) SDS MINI
(1x) Aluminum alloy storage box
(1x) Manual
(10x) Drill Bits:
0.6/0.8/1.0/1.2/1.4/1.5/1.6/1.8/2.0/2.2 mm

Attention

Under drilling work, only right turn (forward direction) is preferred to drill different materials!



Users who purchased **SDS MINI PLUS**
Please follow the below steps to install the benchtop drill stand:



Warranty card:

Warranty regulations

1. The warranty period for this product is 12 months.
2. With 7 days from the date of sale, if product performance fault is found, it can be returned, replaced or maintained, please contact to our customer service.
3. If you have any questions, please contact your dealer.

The following situations are not covered by the warranty:

1. Product is damaged due to improper use, maintenance, and storage.
2. No after-sales vouchers and valid invoices.
3. The damage is caused by force majeure.

The company reserves the right to modify the above provisions, without violating relevant national laws and regulations, we have the final right of interpretation.

Maintenance information

User name: _____
Telephone: _____
E-mail: _____
Address: _____
Purchase date: _____
Maintenance reasons: _____

Manufacturer Information

Manufacturer: Freemax Technology Co.,Ltd
Address: Room 1203,12/F,Wah Shing Centre,
11-13 Shing Yip Street,Kwun Tong,Hong Kong
T: + 852 3590 9790
E: info@arrowmax-rc.com
www.arrowmax-rc.com



保修卡

保修條例

1. 本產品自售出之日起, 保修期12個月;
2. 自產品出售之日起7日內, 如發現產品性能故障, 可以選擇退貨、換貨或者維修;
3. 如有疑問, 請聯繫購買供貨商。

下列情況不在保修範圍之內

1. 消費者因使用、維護、保管不當造成損壞的;
2. 無售後憑證及有效發票的;
3. 因不可抗拒因素造成損壞的。

本公司保留修改以上規定的權利, 在不違反國家相關法規的情況下, 擁有最終解釋權。

售後信息

用戶名稱: _____

聯繫電話: _____

電子郵箱: _____

用戶地址: _____

購買日期: _____

維修原因: _____

製造商信息

製造商: 飛馬仕科技有限公司
 地址: 香港九龍觀塘成業街11-13號
 華成工商中心12樓1203室
 電話: +852 3590 9790
 郵箱: info@arrowmax-rc.com



說明書

迷你電鑽

SDS MINI

ARROWMAX

SDS MINI 電鑽結構圖

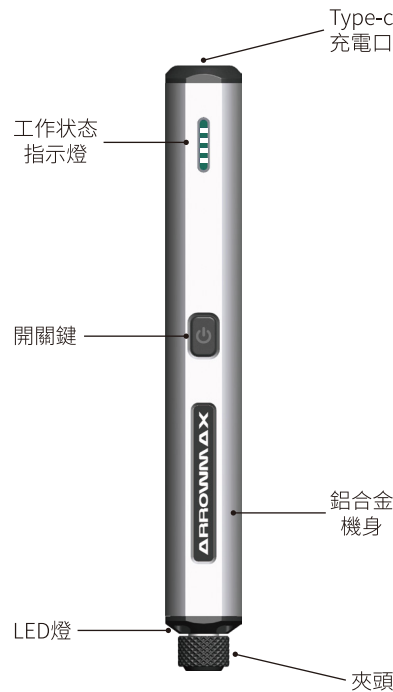

感謝您使用本公司的迷你電鑽。為了讓您更好的體驗產品, 請仔細閱讀說明書。

產品描述

SDS MINI 設計只有一個開關鍵, 並設計四顆藍色指示燈動態顯示工作狀態。頭部四顆LED燈, 在工作的時候會自動亮起。

SDS MINI 手柄採用了方形帶圓弧面的形狀, 使得工作期間更好控制電鑽, 握感更舒適。特殊配製的高容量鋰電池, 更有效地利用了產品的內部空間, 鋰電池容量達到350mAh以上, 使得SDS MINI 的工作時間比其他產品更長。採用無線T-C型充電設計, 只要充電50分鐘即可使用2小時, 不用因電線影響發揮。待機更可長達60天, 所用鋰電池更通過了美國TUV認證。

SDS MINI 在更換鑽頭時的操作也相當簡單, 不需要使用其它工具, 只要旋開夾頭即可輕鬆取出、置入鑽頭, 接著旋緊夾頭即可立即操作。

SDS MINI 採用了鋁合金收納盒, 方便所有配件的存放和管理。收納了10種市面常見尺寸, 可替換的高速鋼鑽頭, 從裡到外的零件均採用CNC精密加工, 在電腦程式準確控制之下確保一致的高品質, 低於0.03 mm的軸同心度, 更是超乎業界標準, 讓每次工作都能精準利落!

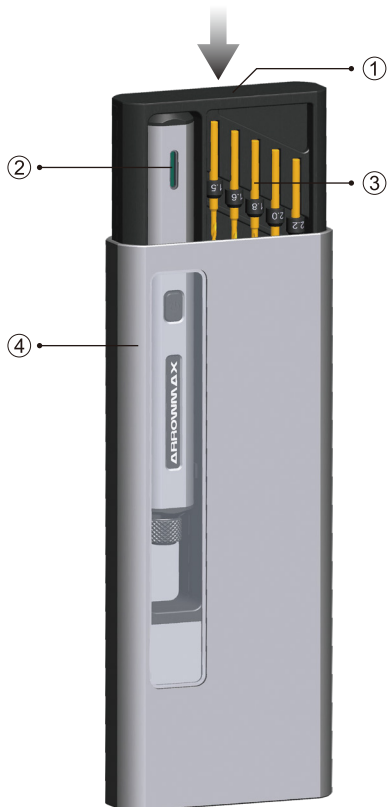

- ① - 收納盒內盒
- ② - 迷你電鑽
- ③ - 鑽頭
- ④ - 收納盒外殼

收納盒開合

按壓收納盒頂部, 收納盒內盒彈出開啓。再次按壓收納盒內盒頂部, 收納盒閉合。注意: 按壓收納盒內盒後, 內盒彈出, 此時內盒易滑落。

迷你電鑽收納

迷你電鑽以卡扣形式固定於收納盒內盒。使用完畢後, 將迷你電鑽按壓歸位。

鑽頭收納

鑽頭以卡扣形式固定於內盒中。使用完畢後, 將鑽頭按壓歸位。

鑽頭安裝

從收納盒內盒中取出鑽頭, ①向右邊旋開夾頭, ②置入鑽頭, ③接着向左邊旋緊夾頭即可立即操作。

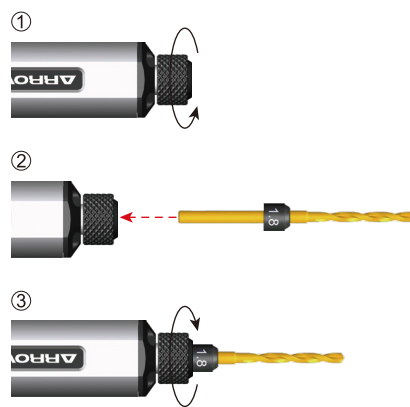

工作狀態

- 按住開關鍵, 四顆指示燈由上往下依次亮起, 動態顯示, 電鑽鑽頭正轉;
- 再按開關鍵, 四顆指示燈由下往上依次亮起, 動態顯示, 電鑽鑽頭反轉;
- 再按停止。指示燈顯示當前剩餘電量:
 4顆燈亮 (100%) / 3顆燈亮 (75%) / 2顆燈亮 (75%) / 1顆燈亮 (25%)。



產品參數

產品型號: SDS MINI
 尺寸: 15x15x120mm
 重量: 48g
 電動最大扭矩: 2.0kgf.cm

電池電壓: 3.7V
 鋰電池: 350mAh
 空載轉速: 550r/min
 充電時長: 50分鐘

產品清單

- 迷你電鑽x1
- 鋁合金收納盒x1
- 說明書x1
- 鑽頭x10支:
 0.6/0.8/1.0/1.2/1.4/1.5/1.6/1.8/2.0/2.2 mm

▲注意

工作狀態下, 只能以右轉 (即正轉) 鑽動物件!



購買 SDS MINI PLUS 的用戶
 請按以下步驟安裝臺式鑽架:

