

MUBVIEW®

A Smarter Safety Solution

QUICK START GUIDE



Bell-J9 **SMART VIDEO DOORBELL**

WIRELESS | WIFI | OUTDOOR | WATERPROOF
FCC ID: 2AUSP-BELLJ6

Warranty Service

Thanks for your shopping and trust.

We have been optimizing our products and improve our **lifetime customer service** to offer you a better shopping experience. If you have any problems, please feel free to **send us an E-mail**. We will solve your problems **within 24 hours**. In addition, your advice or suggestions will be much appreciated and welcomed.

Register via link below to get **3 Years Warranty Extension**.

<https://bit.ly/3zBSB2y>

Product Service

Email: support@mubview.com

Distributor: business@mubview.com

More About Us

Web: www.mubview.com

Facebook: www.facebook.com/mubview

Amazon Store: www.amazon.com/mubview

1. What's in the Box -----	P1
2. Meet the Doorbell -----	P2
3. Download and Install App -----	P3
4. Account Registration -----	P3
5. Add Doorbell to App -----	P4
5.1 Preparations for Connection -----	P4
5.2 Connect Doorbell to App -----	P4
6. Charge your Doorbell -----	P6
7. Set up Doorbell -----	P7
8. Pair With Your Indoor Chime -----	P8
9. Install Your Doorbell -----	P10
10. Product Specifications -----	P12

1. What's in the Box

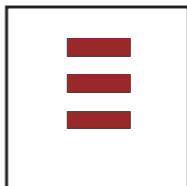
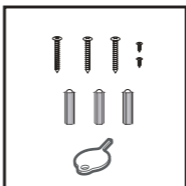

Doorbell * 1

USB Cable *1

DingDong *1

Screws Set/Screwdriver *1

Quick User Guide *1

3M Tape *2

NOTE: Micro SD card and power adapter are not included.

2. Meet the Doorbell

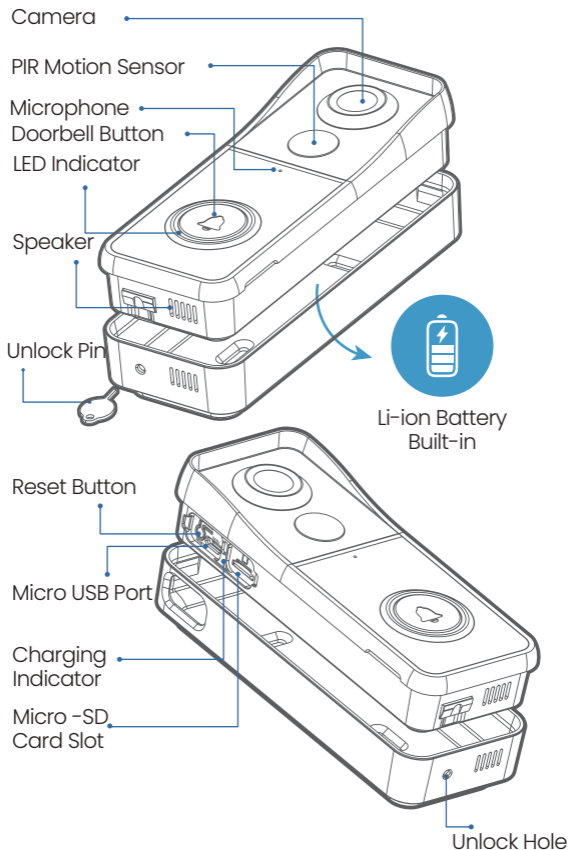

•Doorbell comes with a 4,800mAH rechargeable battery.

3. Download and Install App

Download Mubview App from Google Play™ or App Store™. Or scan the QR codes as below, with your smart phone.

*Google Play™ is a trademark of Google Inc. App Store™ is a mark of Apple Inc.



iOS



Android

NOTE: Make sure turning on both permissions below.

- ① Allow Mubview App to access mobile cellular data and wireless LAN, otherwise it will fail to connect the camera (in mobile Setting).
- ② Allow Mubview App to send messages, otherwise the phone will not receive alarms when motion is detected (in mobile Setting-Mubview).

4. Account Registration

New user needs to sign up in Mubview App with email address. Click 'Sign up' to create a New Account and follow the steps to complete registration.

5. Add Doorbell to App

5.1 Preparations for connection

- ① Insert Micro SD Card into the camera to save video clips or you can start the 3-day free cloud service. Without Micro SD Card or cloud service, no video will be saved.
- ② The camera only support 2.4GHz Wi-Fi, not support 5GHz.
- ③ When connect to the network, please take the camera close to the router (suggest within 10-15ft).

5.2 Connect Doorbell to App



Tap 'Add Device'

Select 'Doorbell Camera'

Power on the Camera

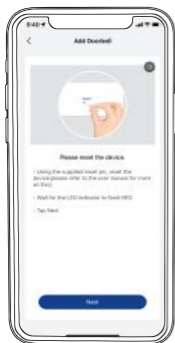

Reset the Camera



Activate the doorbell



Prepare to Scan



Scan QR Code



Wait till 100%



Perform Network Diagnosis

6. Charge your Doorbell

Prior to the doorbell installation, please charge up your doorbell for about 8-10 hours till the charging LED turns BLUE from RED.

LED STATUS	INDICATION
 Solid red	Battery charging
 Solid blue	Fully charged

Compatible charger (not provided):

USB compatible mobile phone charger (DC 5V=1A~2A).

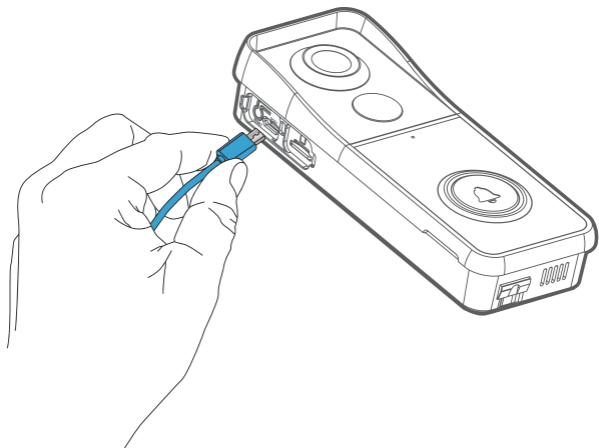

7. Set up Doorbell

- 1 Press your doorbell to activate, and you will see the LED indicator flashes red (once per second). If not press and hold reset button for 5 seconds to restore factory defaults.



2 Tips

- Please operate the setup near your Wi-Fi router.
- Make sure your phone connect to a 2.4GHz Wi-Fi.
- Make sure the doorbell is turned on and its indicator LED is flashing red. If not, press and hold RESET for 5 seconds.
- Ensure the Wi-Fi signal is good, and the Wi-Fi password is correct.

LED STATUS	INDICATION
○ Solid red	Device is abnormal
○ Flash red (once/sec)	Ready for Wi-Fi configuration
○ Flash red (twice/sec)	Connecting to Wi-Fi
○ Solid blue	Device is online
○ Flash blue (once/sec)	Live-viewing doorbell cam
○ Flash blue (twice/sec)	Firmware upgrading

8. Pair With Your Indoor Chime

- 1 Click the **SETTING** button on the chime, and the chime will be in pairing mode for 20 seconds, with its red LED flashing.

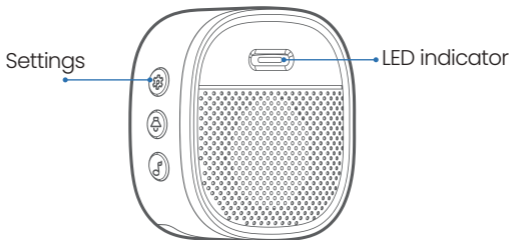

- 2 Press the doorbell button to send a pairing signal, and your chime will sound to react, together with its blue LED flashing. Chime pairing succeeds.

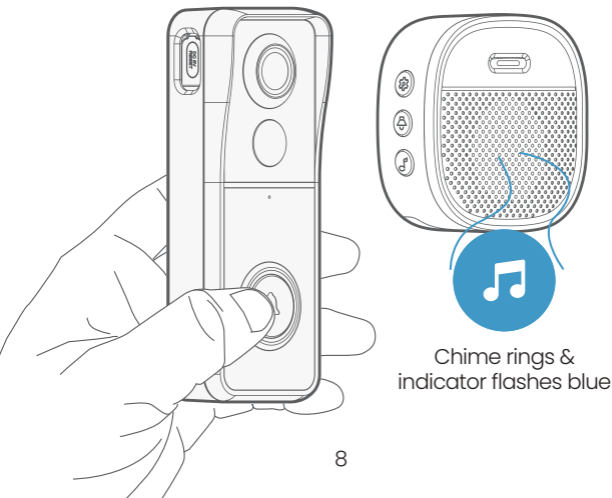

3 Chime settings.



Settings.

Click to enter/quit pairing mode;
Press & hold for 5 seconds to restore factory defaults.



Volume control button.

Click to control volume:
level 1: 110 dB; level 2: 100 dB
level 3: 90 dB; level 4: 80 dB



Ringtone selection.

Click to change ringtone (4 ringtones available).

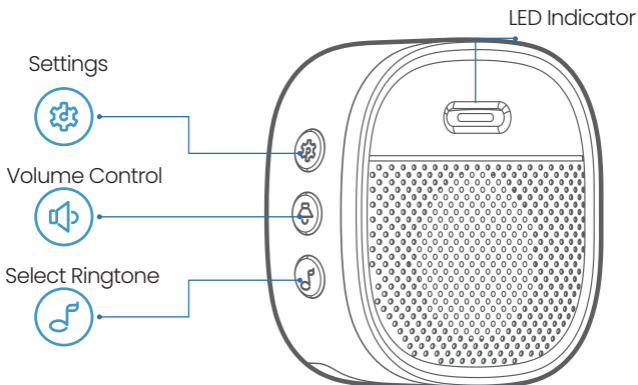

9.) Install Your Doorbell

- 1 Select location for your doorbell.

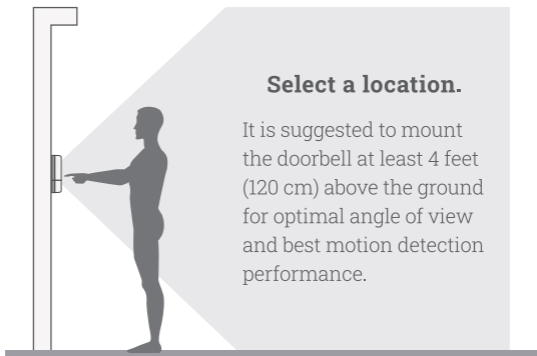

- 2 Mount your doorbell.

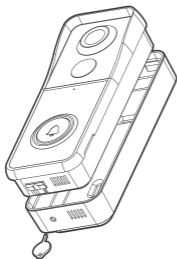

- A** Release the rear mount using the unlock pin.

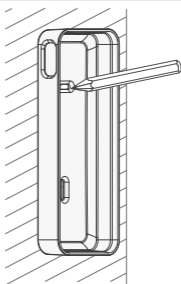

- B** Mark the screw holes with the doorbell mount.

3 Standard installation.

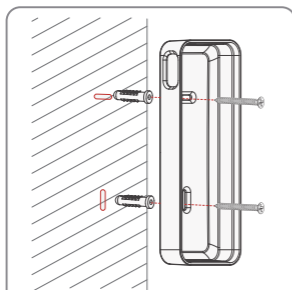

- C** Mount the rear mount to your wall with screws and tools.

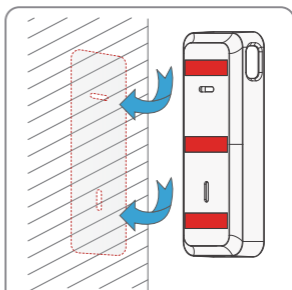

- D** Adhesive tapes are optional to mount the doorbell on flat surfaces.

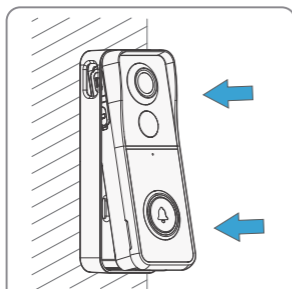

- E** Attach the doorbell to its rear mount, and push the doorbell to lock up.

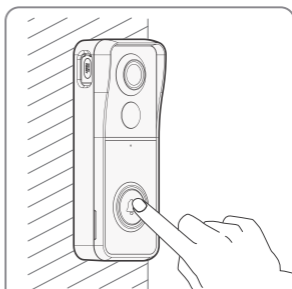

- F** Press the doorbell down again. All set!

10. Product Specifications

Video Doorbell Model No.:Bell J9

Camera	1080P Full-HD Camera
Effective pixels	1920H x 1080V
IR LED	High power dot-array IR LED x 1
View angle	120°
Motion detect range	100° (Max 5m)
Motion sensitivity	5 level sensitivity settable
Alarm trigger	Call button, motion detect
Wi-Fi	2.4 ~ 2.4835 GHz WIFI (IEEE802.11b/g/n)
Video recording	Video clips against events
Audio	Full duplex 2-way audio
Storage	SD card (Max. 128G)
Cloud storage	Yes (3-days-free trial)
Power supply	Built-in rechargeable Li-ion battery
Battery capacity	4,500mAh
Ingress protection	IP65
Operating Temp	-20 °C to 50 °C
Dimensions	56.2 x 38 x 147.5mm
Net weight	243g

Wireless Chime Model No.: Chime09

Power source 1	DC 5V 1A (from Micro USB)
Power source 2	AA LR6 1.5V battery x 3 units
Consumption	0.4W
Ringtones	4 ringtones optional
Connection type	Radio frequency 433MHz/868MHz
Place of use	Indoor
Red LED flashing	Pairing mode
Blue LED flashing	Working normally
Red LED flashing	3 times Reset factory default succeeds
Working Temp	-20 °C ~ 50 °C
Humidity	<90%, no condensation
Dimension	65.5 x 65.5 x 27mm
Weight	89.2g (Battery Included)

