

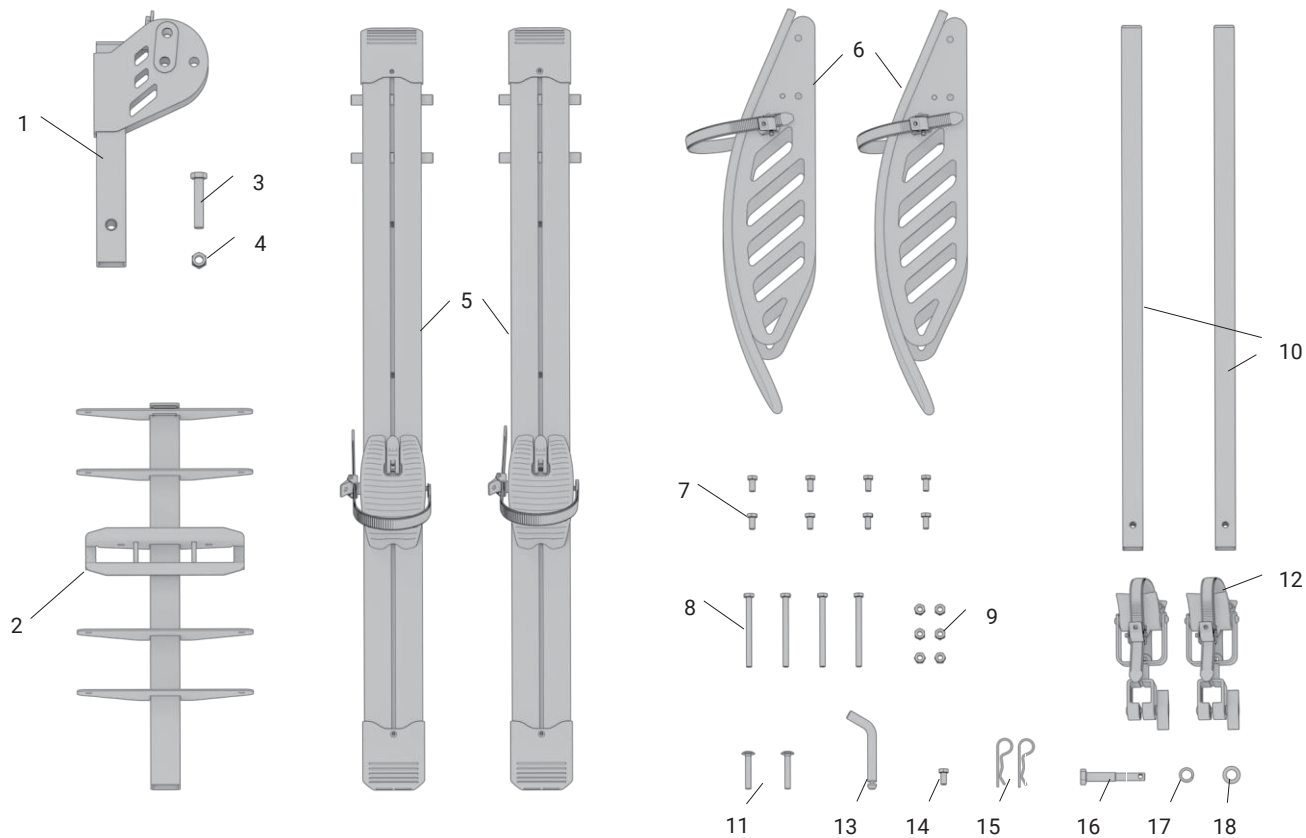

MANUAL

Hitch Bike Rack - MATE

Parts



Parts List

Part#	Description	Qty
1	Rotating Group	1
2	Bottom Fixing Bracket	1
3	M16x85 Hexagon Bolt	1
4	M16 Lock Nut	1
5	Beam Assembly	2
6	Front Wheel Holder	2
7	M10*20 Hex Bolt	8
8	M10*120 Outer Hex Bolt	4
9	M10 Lock Nut	6
10	Middle Support Tube	2
11	M10x60 Bolt	2
12	Connecting Block	2
13	φ16 Ben Pin	1
14	M10 Short Hexagon Bolts	1
15	φ3.8 Pin	2
16	M16 Shockproof Bolt	1
17	φ16 Spring Washer	1
18	φ16 Flat Washer	1

Required Tools (Not included)

Name	Imperial	Metric
Monkey Wrench	12"	300mm
Open Wrench	7/16"	11mm
Open Wrench	11/16"	17mm

STEP1

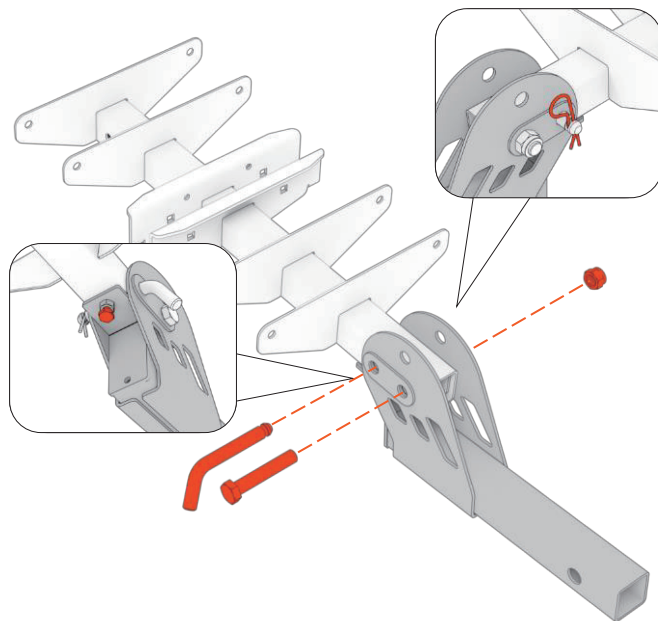

Align the **Bottom Fixing Bracket(2)** with the hole of the **Rotating Group (1)**, insert the **M16*85 Outer Hexagon Bolt (3)**, and then screw on the **M16 Lock Nut (4)**. Insert **16 Bent Pin(13)** and **φ3.8 Pin (15)** at the same time, and use **M10 Short Hexagon Bolts (14)** to screw into the **Bottom Fixing Bracket (2)** as shown in the

figure to eliminate the gap between the **Bottom fixing bracket (2)** and the **Rotating Group(1)**.

Note: Do not overtighten the bolts to prevent **Bottom Fixing Bracket (2)** and **Rotating Group (1)** components from rotating easily.

STEP2

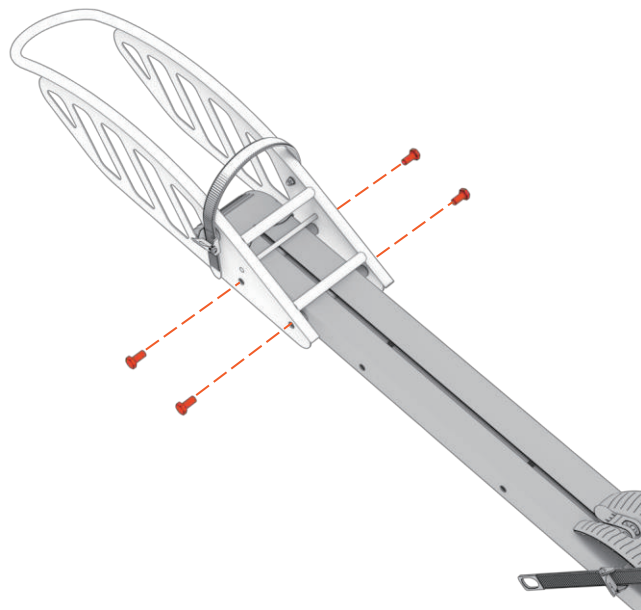

Align the holes from **Front Wheel Holder (6)** and **Beam Assembly (5)**. Then fix them with **M10*20 Hex Bolt (7)**.

STEP3

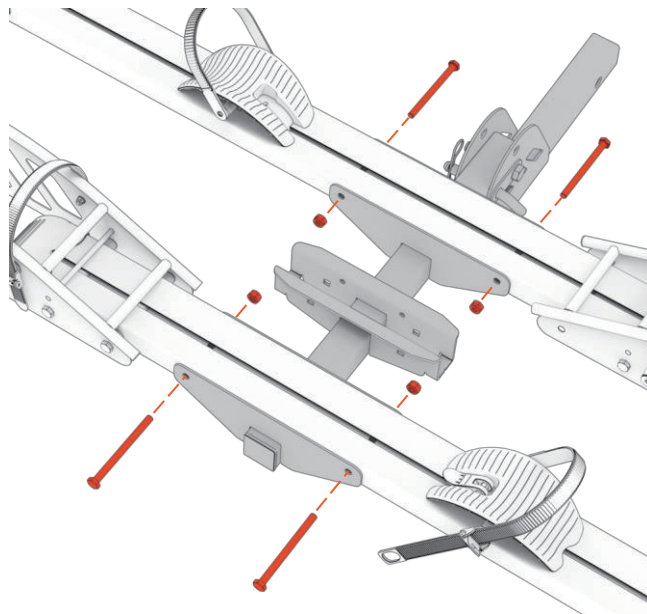

Place the components assembled in steps 2 above into the **Bottom Fixing Bracket (2)**, align the holes, install **4pc M10*120 Outer Hexagon Bolt (8)** and **4pc M10 Lock Nut (9)**, and tighten the bolts.

STEP4

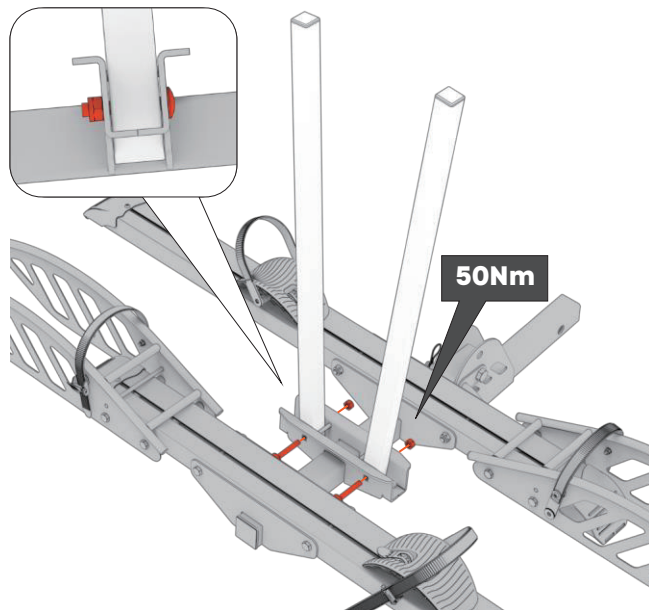

Insert **Middle Support Tube (10)** into the base of **Bottom Fixing Bracket (2)**, then fix them with **M10x60 Bolt (11)** and **M10 Lock Nut (9)**.

STEP5

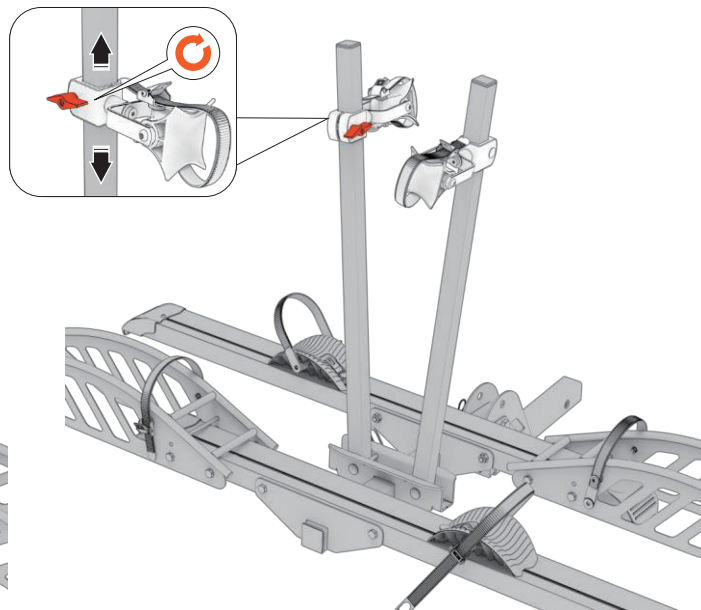

Install the adjustable **Connecting Block (12)** to the **Middle Support Tube (10)**, then tighten the knob from the **Connecting Block (12)**.

STEP6

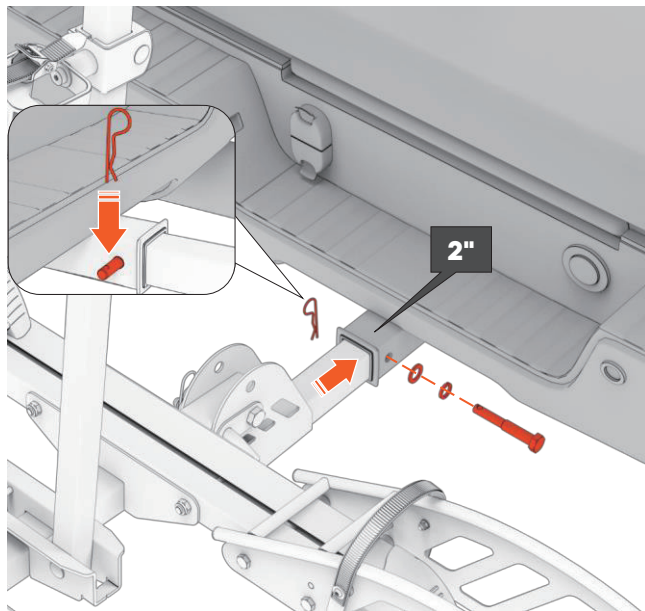

Align the holes of the folding tube with the holes on the vehicle's **2" hitch receiver**, then connect the two parts as shown below.

Place an **M16 Shockproof Bolt (16)**, through the **φ16 Spring Washer (17)**, **φ16 Flat Washer (18)** and the aligned holes. Secure the bolt in place with the **φ3.8 pin (15)**, making sure to place the pin through the holes on the bolt.

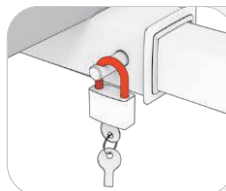

- ! The diameter of lock beam should be less than **7mm**.
- ! The lock is not included.

Folding Steps

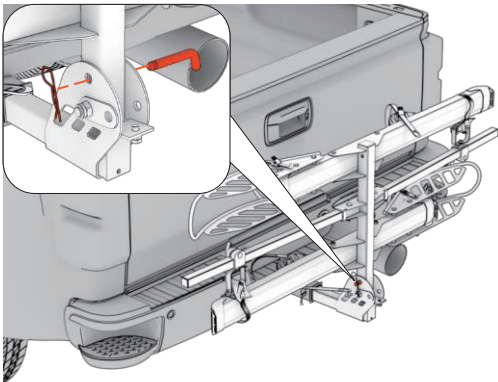
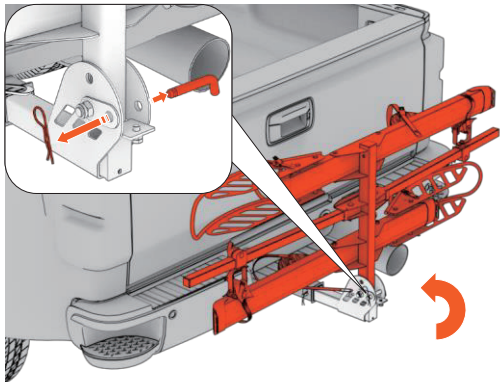
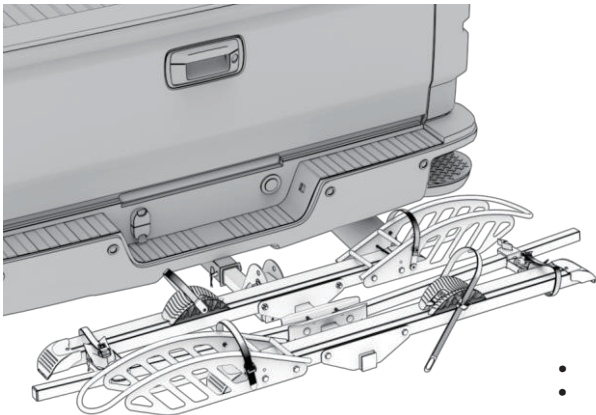
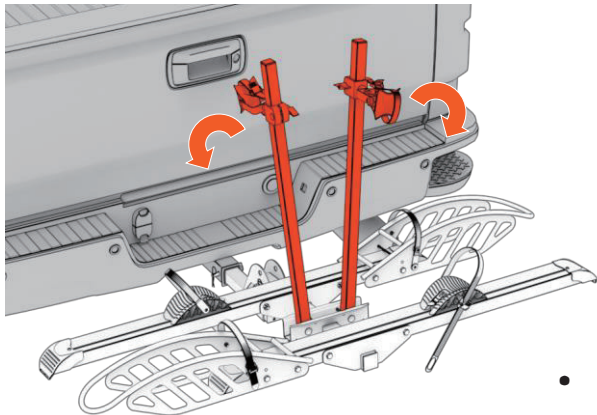

Bike Installation Instructions

❗ Snap the front tire of the ebike into the fixed frame, place the rear tire in the beam, and then use the ratchet wheel straps to fix the front wheel, rear wheel, and seat tube of the bicycle as shown in the figure below.

❗ It should place the first bike or a bike to the side which is close to the vehicle.

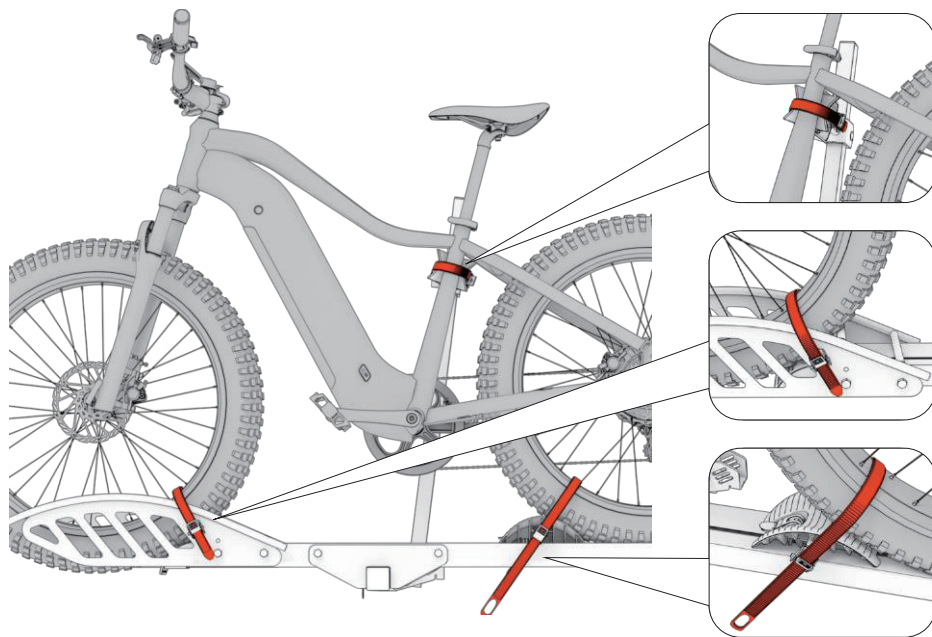

Note: Use the ratchet wheel strap to fix and tighten the seat tube or horizontal tube of the bicycle.

Note: Use the ratchet wheel strap to fix and tighten the front wheel of the bicycle.

Note: The rear tire fixing seat needs to be placed in front of the rear wheel.

How to Adjust the Wheel Cradle

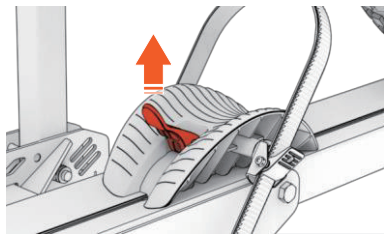

1.Pull the cam gear

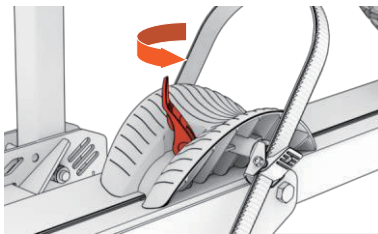

2.Turn in counterclockwise

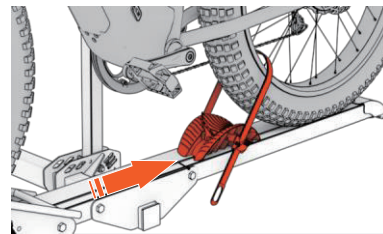

3.Slide it

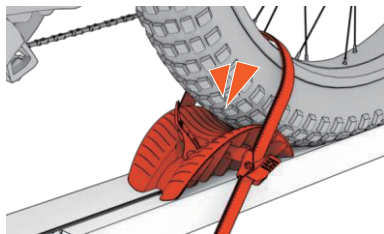

4.Until it against the tire

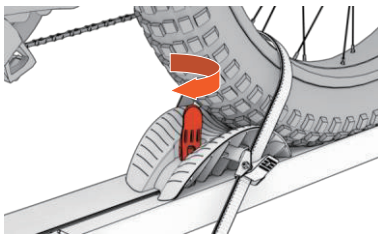

5.Turn it tighten by clockwise

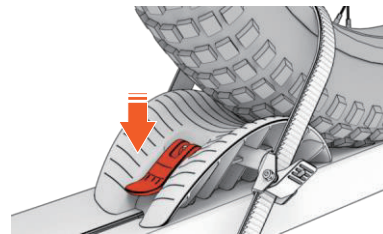

6.Press it down

Dimension

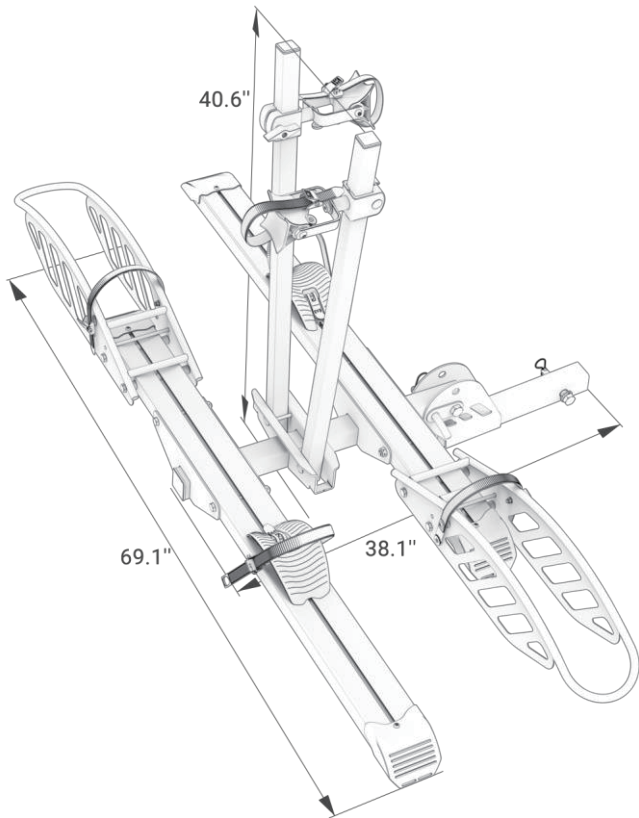

Technical Specifications

- Maximum weight bicycle capacity 200LBS
- Maximum bicycle wheelbase 50"
- Applicable Hitched Bike Types: Electric Bike/Regular Bike
- Not intended for use with mopeds, motorcycles or 3 wheels bikes
- Universal sized up to 5" wide tire

Model Name	YOUNG ELECTRIC Mate
Description	2" Hitch 2-Bike Rack
Material	Aluminum & Steel
Maximum Weight Capacity	200lbs
Applicable Vehicles	Vehicles with 2" receiver
Package Size	54.6x18.6x8.7in
Package Weight	71.0lbs

WARNINGS

- Do not overload beyond the bike rack's weight capacity of 200lbs.
- Do not carry more than 2 bikes on the carrier.
- The bike rack is not intended for transporting humans or animals.
- If you are planning to load only one bike, it is recommended to place it in the position closest to the vehicle.
- All bikes must be secured properly before operating the vehicle.
- Make sure the front of the bike(s), when mounted, are at or above the bottom of the bumper to avoid damage to the bike(s).
- Do not carry flammable items on the bike rack.
- If using the bike rack to transport electric bicycles, please remove the batteries from the bicycles prior to transporting them. This will help reduce the weight supported by the carrier.
- During long trips, frequently check the straps and bike position, especially if traveling on rough terrain.
- Please do not make alterations to the product, as it can pose potential hazards to your safety.
- Failure to heed these warnings may result in personal injury and/or property damage.
- To prevent serious injury or death, inspect the bike rack for any signs of wear, corrosion and fatigue before each use. Do not use the bicycle rack if parts are bent, broken, deformed or missing. If parts are bent, broken, damaged or missing, remove the rack from your vehicle before operating the vehicle.

Young Electric Warranty Policy

Young Electric is committed to providing our customers with a quality shopping experience, for the products we sell, we provide a 2-year warranty from the date of purchase, which includes non-artificial product defects. This warranty does not cover issues caused by normal wear and tear including (but not limited to) weather, scratches, dents, rust, accidents, unlawful vehicle operation, misuse, abuse, neglect, theft, unauthorized modifications, or unauthorized repair.

No warranty is provided for defects caused by improper fit, improper vehicle installation, installation on an "unsuitable" vehicle, incorrect installation of the bike on the rack, or overloading of the weight limit of the rack. This warranty terminates if the purchaser transfers the product to any other person.

If a product is believed to be defective, the purchaser should directly contact Young Electric Team at 888-933-8899 or through support@youngelectricbikes.com

Disclaimer of Liability: Repair or replacement of a defective product or the issuance of a refund or credit (as determined by

Young Electric) is a purchaser's exclusive remedy under this warranty.

Young Electric shall not be liable for any direct, indirect, consequential, incidental, special, punitive or any other damages in connection with the purchase, use or handling of this product.

Some states do not allow the exclusion or limitation of consequential or incidental damages, and the above limitation may not apply to you. This Limited Warranty gives you specific legal rights, and you may have other rights that vary from state to state.

Get Support



<https://youngelectricbikes.com>
support@youngelectricbikes.com
Toll Free Number: 888-933-8899

YOUNE
Electric