

## Hinge Template

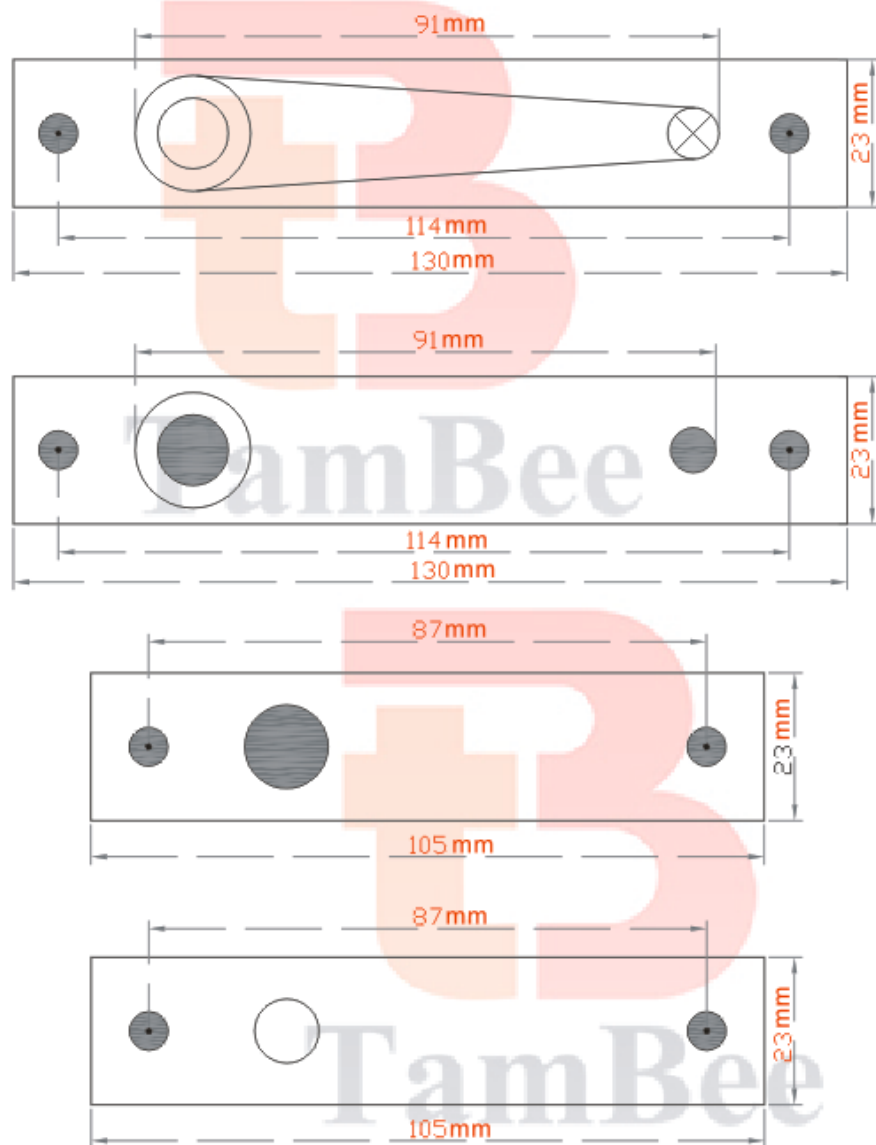

## INSTALLATION

**1.** Locate Pivot Set - Put the four parts into the corresponding positions and make sure their pivots are on the same line. Dig trenches on the door and door frame according to the template drawings and fix them with screws.



**2.** Adjust the adjustment screw of **part (1)** to the lowest position, then the cylinder will be adjusted to the highest position and is completely inside the panel.



**3.** Move the door to the door frame and make sure the cylinder of **part (4)** is in the round bearing of **part (3)**. And make the cylinder of **part (1)** correspond with the round tube of **part (2)**.



**4.** Adjust the adjusting screw of **part (1)** upwards to the highest position, so that the cylinder protrudes into the round tube of **part (2)**.

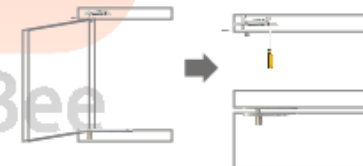

**5.** Rotate the door spindle. If it is smoothly and noiselessly when rotating, fix the screw further. If it is not smoothly when rotating, slightly adjust the position of **part (3)** or **part (4)** and make it more smoothly. Then the installation is finished.



**Product package contains: pivot hinge & screws**

**Note:**

**(1)** Dismount Door (if required)

**(2)** Open the door enough to disengage the top pivot.

**(3)** Adjust the adjustment screw of part(1) to the lowest position with a screwdriver, so that the cylinder is adjusted to the highest position.

**(4)** Allow the top of the door leaning toward you, lift the door clear of the spindle.

