

# HEAT TRANSFER STICKERS FOR GARMENTS

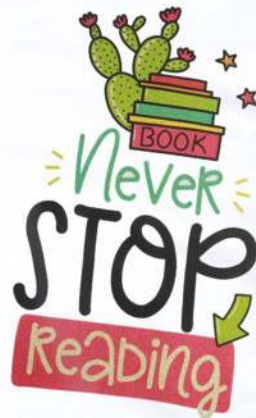

ABOUT US

*01*

OFFSET PRINTING STICKERS

*04*

SCREEN PRINTING STICKERS

*17*



CATALOGUE

# About Us

**kenteer** founded in Xiamen, Fujian, in 1996, a 30,000m<sup>2</sup> production plant was in Jinjiang, Quanzhou city, which consist of 3 workshops, 1 office building and 1 stuff dormitory, beside, the workshop has an independent R&D space consist of laboratory and test data base, guarantee the quality of products.

**01**

workshop



**02**

R & D



**03**

experiment







**KENTEER** has 24 year experience of research and development of polyester film for screen printing, digital printing, plate making. Now, it has 2 production lines, offering large capacity to demand polyester films handled every year, and give customization service to satisfy specific measurable product of clients.



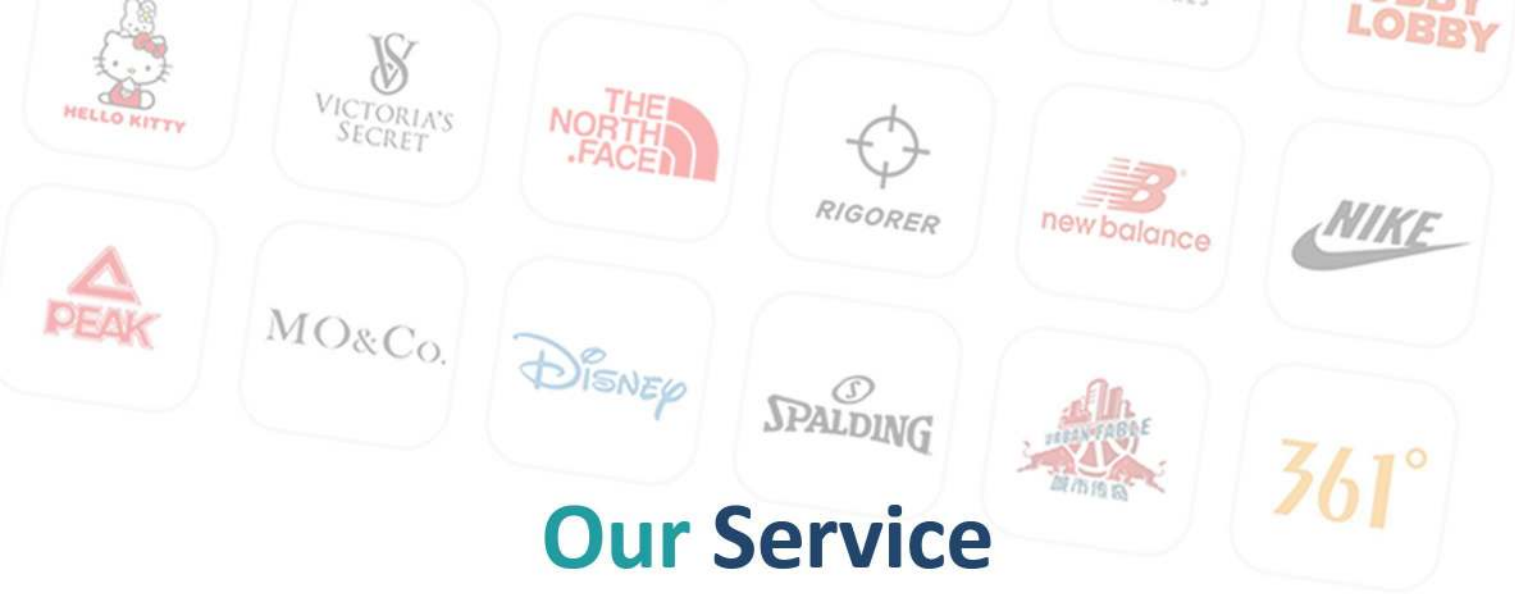

**KENTEER** has 8 professional teams, they were trained to give clients products support and technology support before and after sales, also sharing the innovation ideas and assistance of their exhibition shows. All to be the opportunity to cooperate with many international brands like Nike, Disney etc..



# OFFSET PRINTING STICKERS

- Imported flex PU materials (B class use Acrylic materials) & PET film
- Alternative size of PET film: 39\*54cm/48\*64cm
- Personalized print with vibrant color
- Printing colors through offset printing machine and printing backup & glue through screen printing machine
- Apply to cotton and polyester fabric, like high-end polo, t-shirt, sportswear







## AC01 STANDARD

- Elastic and feel soft
- Thickness: 100-120 micron
- Apply to most cotton and polyester fabrics

### HOW TO USE:



**TEMP**  
150~160°C/302~320°F



**TIME**  
10-12s



**FORCE**  
0.24 kgf/cm<sup>2</sup>



**PEEL**  
after cool / hot peeling





## AC00 ECONOMIC

- Good effect with cheaper price
- Thickness: 100-120 micron
- Apply to most cotton and polyester fabrics

### HOW TO USE:



TEMP

150~160°C/302~320°F



TIME

10-12s



FORCE

0.24 kgf/cm<sup>2</sup>



PEEL

after cool / hot peeling







## AC02 SOFTER

- Elastic and feel soft
- Thickness: 100-120 micron
- Apply to most cotton, polyester and spandex fabrics

### HOW TO USE:



#### TEMP

150~160°C/302~320°F



#### TIME

10-12s



#### FORCE

0.24 kgf/cm<sup>2</sup>



#### PEEL

after cool / hot peeling





## AC03 HIGH FLEX

- Particularly elastic
- Thickness: 100-120 micron
- Apply to most cotton, polyester and spandex fabrics



### HOW TO USE:



#### TEMP

150~160°C/302~320°F



#### TIME

10-12s



#### FORCE

0.24 kgf/cm<sup>2</sup>



#### PEEL

after cool / hot peeling





## AC04 DYE-BLOCK

- Particularly elastic
- Thickness: 140-180 micron
- Apply to dye fabric, can protect the image from dye

### HOW TO USE:



TEMP  
150~160°C/302~320°F



TIME  
10-12s



FORCE  
0.24 kgf/cm<sup>2</sup>



PEEL  
after cool / hot peeling

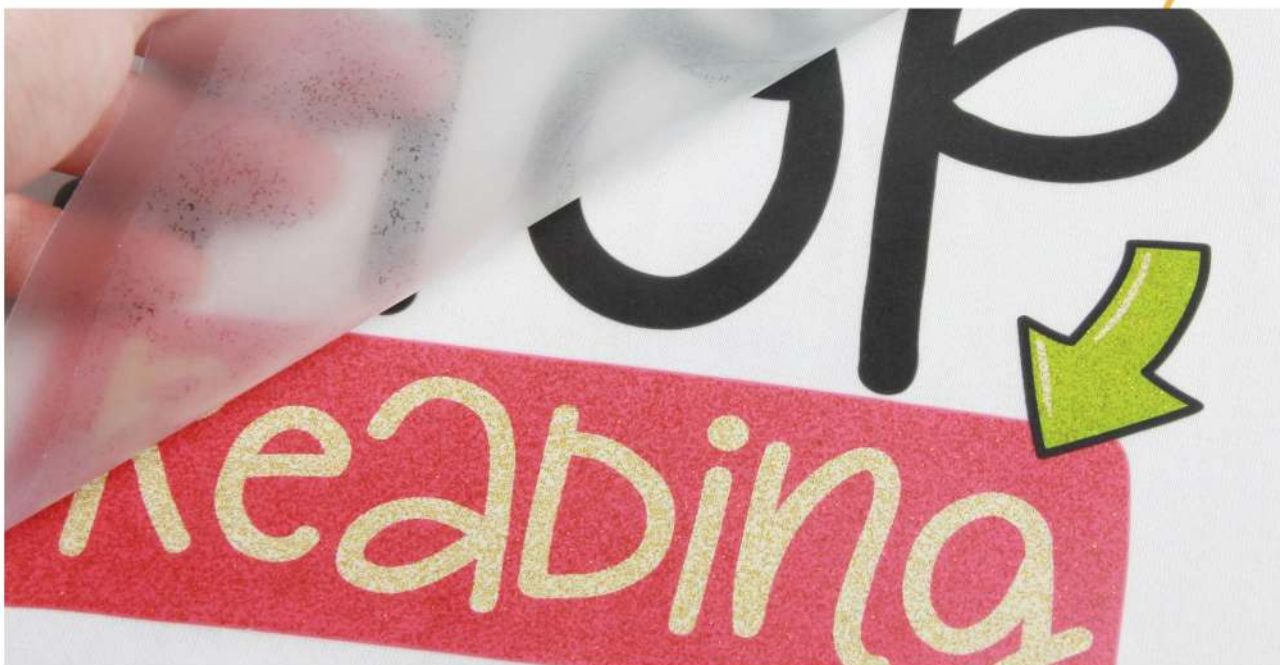

## AC05 GLITTER

- Glitter effect makes image more attractive
- Thickness: 140-180 micron

### HOW TO USE:



#### TEMP

150~160°C/302~320°F



#### TIME

10-12s



#### FORCE

0.24 kgf/cm<sup>2</sup>



#### PEEL

after cool / hot peeling







## AC06 PUFF

- Puff material makes image more stereo, got a 3D effect
- Thickness: 140-180 micron

### HOW TO USE:



#### TEMP

125~135°C/ 257-275°F



#### TIME

6-10s



#### FORCE

0.24 kgf/cm<sup>2</sup>



#### PEEL

hot peeling





## AC08 FOR SUITCASE

- Use 80-200UM PA powder instead of glue
- Thickness: 120-140 micron
- Apply to PVC or non-elastic fabric, like jean fabric, canvas, or other 300D/400D/600D fabrics

### HOW TO USE:



#### TEMP

30~140°C/266~248°F



#### TIME

6-10s



#### FORCE

0.24 kgf/cm<sup>2</sup>



#### PEEL

hot peeling





## AC/AW10 CUSTOMIZED

- Use imported flex PU materials & PET film
- Can print glitter, puff, pearl effect etc. on the pattern

### HOW TO USE:



#### TEMP

150~160°C/302~320°F



#### TIME

10-12s



#### FORCE

0.24 kgf/cm<sup>2</sup>



#### PEEL

after cool / hot peeling





## AC13 OFFSET

- Use imported high-temp PU inks and anti-heat 100 micron PET film
- Stereo effect with vibrant colors
- Thickness: 100-120 micron
- Apply to 100% cotton fabric, like high-end polo and t-shirt

### HOW TO USE:



TEMP

150~160°C/302~320°F



TIME

10-12s



FORCE

0.24 kgf/cm<sup>2</sup>



PEEL

after cool / hot peeling







## BC02 NON-WOVEN

- Use domestic water-based Acrylic ink and oil-based glue
- Thickness: 100-110 micron
- Apply to not-need-washing cloth, like non-woven fabric

### HOW TO USE:



TEMP

125~135°C/157~175°F



TIME

10-12s



FORCE

0.24 kgf/cm<sup>2</sup>



PEEL

after cool / hot peeling







## BC03 EVA/PE SANDAL

- Use domestic water-based Acrylic ink and oil-based glue
- Thickness: 100-120 micron
- Apply to good abrasion resistance and high color fastness slippers

### HOW TO USE:



TEMP

130~150°C/260~302°F



TIME

10-15s



FORCE

0.24 kgf/cm<sup>2</sup>



PEEL

after cool peeling



# SCREEN PRINTING STICKERS

- Standard screen printing stickers
- Imported flex PU materials (B class use Acrylic materials) & PET film
- Alternative size of PET film: 39\*54 cm/48\*64 cm
- Printing colors & backup & glue through screen printing machine
- Apply to regular fabric or high elastic fabric, cotton, polyester or spandex, popular apply to high-end polo, t shirt, sportswear





## AW07 STANDARD

- Only one color accepted
- Thickness: 100-120 micron
- Apply to cotton, polyester or spandex

### HOW TO USE:



#### TEMP

150~160°C/302~320°F



#### TIME

10-12s



#### FORCE

0.24 kgf/cm<sup>2</sup>



#### PEEL

after cool / hot peeling





## AW09 SUPER CARE LABEL

- Elastic and feel soft
- Thickness: 100-120 micron
- Apply to most cotton, polyester and spandex fabrics
- Achieved OEKO-TEX 100



### HOW TO USE:



TEMP

150~160°C/302~320°F



TIME

10-12s



FORCE

0.24 kgf/cm<sup>2</sup>



PEEL

after cool / hot peeling



## AW19 STANDARD CARE LABEL

- Can print 2 different colors
- The minimum size can be 0.2mm
- Apply to cotton, polyester or spandex



### HOW TO USE:



#### TEMP

150~160°C/302~320°F



#### TIME

10-12s



#### FORCE

0.24 kgf/cm<sup>2</sup>



#### PEEL

after cool / hot peeling





## AW11 GLITTER

- Glitter effect makes image more attractive
- Thickness is above 200 micron

### HOW TO USE:



#### TEMP

150~160°C/302~320°F



#### TIME

10-12s



#### FORCE

0.24 kgf/cm<sup>2</sup>



#### PEEL

after cool / hot peeling





## AW12 PLASTISOL

- Use imported high-temp plastisol silicon ink
- Thickness: 100-120 micron
- Apply to 100% cotton

### HOW TO USE:



#### TEMP

150~160°C/302~320°F



#### TIME

10-12s



#### FORCE

0.24 kgf/cm<sup>2</sup>



#### PEEL

after cool / hot peeling







## AW14 REFLECTIVE

- Use imported PU inks and reflective film
- Clear reflective film can print multi colors
- Silver reflective film can only print silver
- Apply to nightwear, security uniform

### HOW TO USE:



TEMP

150~160°C/302~320°F



TIME

10-12s



FORCE

0.24 kgf/cm<sup>2</sup>



PEEL

after cool / hot peeling



## AW15 HOT FOIL

- Use imported PU inks and hot foil film
- Good metallic effect
- Apply to lower-elastic fabrics



### HOW TO USE:



TEMP

150~160°C/302~320°F



TIME

10-12s



FORCE

0.24 kgf/cm<sup>2</sup>



PEEL

after cool / hot peeling





## AW16 HIGH DENSITY

- Use imported composite material
- Thickness is above 400 micron
- Apply to cotton, polyester or spandex



### HOW TO USE:



#### TEMP

Back/Up Side: 150°C/302°F



#### TIME

Up Side:8s / Back Side:10-12s



#### FORCE

0.24 kgf/cm<sup>2</sup>



#### PEEL

after cool peeling



## AW17 SUPER HIGH DENSITY

- Use imported composite material
- Thickness is above 400 micron
- Can combine with reflective film or hot foil film
- Apply to cotton, polyester or spandex

### HOW TO USE:



#### TEMP

Back/Up Side: 150°C/302°F



#### TIME

Up Side: 8s / Back Side: 10-12s



#### FORCE

0.24 kgf/cm<sup>2</sup>



#### PEEL

after cool peeling







## AW23 HEAT ACTIVATED

- Colors will change with temperature changing
- Personalized print with vibrant colors

### HOW TO USE:



#### TEMP

130~150°C/266~302°F



#### TIME

10-12s



#### FORCE

0.24 kgf/cm<sup>2</sup>



#### PEEL

after cool peeling



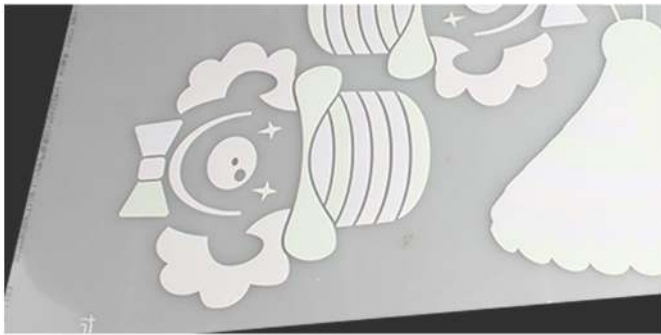
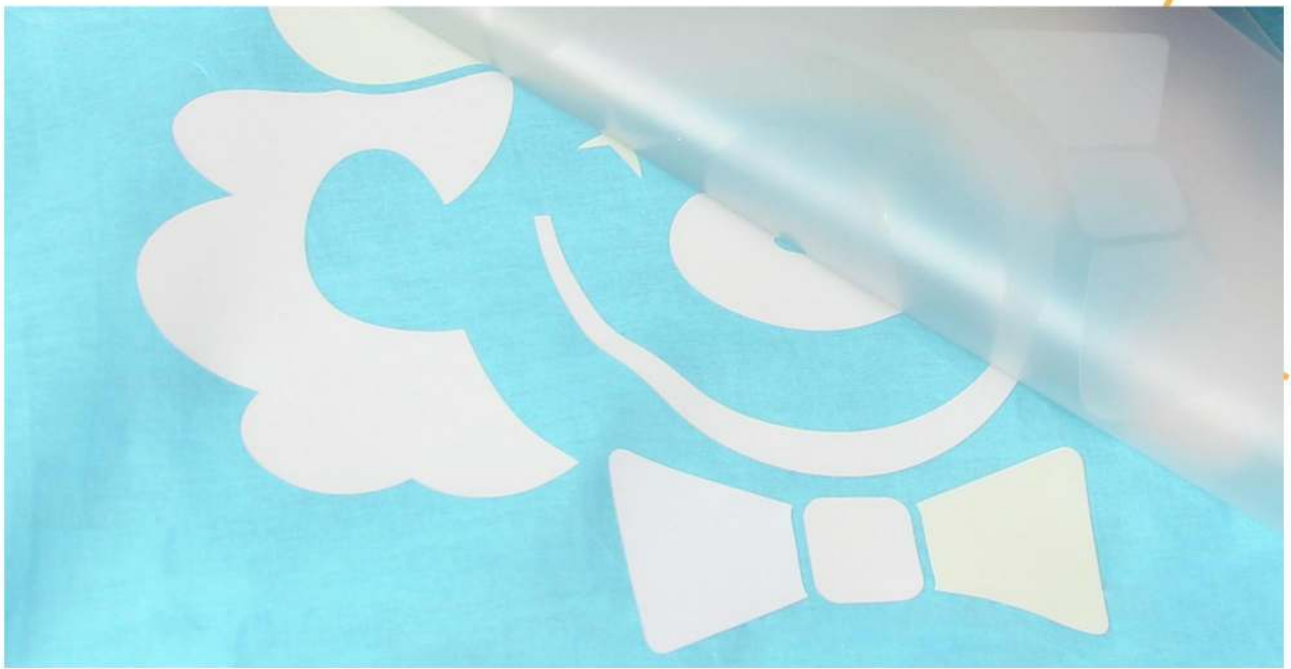

## AW24 SUN ACTIVATED

- Colors will appear when touch the sunlight
- Personalized print with vibrant colors

### HOW TO USE:



#### TEMP

130~150°C/266~302°F



#### TIME

10-12s



#### FORCE

0.24 kgf/cm<sup>2</sup>



#### PEEL

after cool peeling





## AW25 CHAMELEON

- Colors will change with different viewing angle
- Personalized print with vibrant colors

### HOW TO USE:



#### TEMP

130~150°C/266~302°F



#### TIME

10-12s



#### FORCE

0.24 kgf/cm<sup>2</sup>



#### PEEL

hot peeling





## AW30 RAINBOW REFLECTIVE

- Reflect dazzling rainbow colors under the light
- Apply to nightwear, personalized sportswear

### HOW TO USE:



TEMP

130~150°C/266~302°F



TIME

10-12s



FORCE

0.24 kgf/cm<sup>2</sup>



PEEL

after cool peeling







## AW28 SILICONE

- Use imported silicone material
- Vibrant color and 3D effect
- Apply to cotton, polyester or spandex



### HOW TO USE:



#### TEMP

Back/Up Side: 150°C/302°F



#### TIME

Up Side: 8s / Back Side: 10-12s



#### FORCE

0.24 kgf/cm<sup>2</sup>



#### PEEL

after cool peeling



## AW30 FLOCK

- 4-color is accepted
- Printing on flock sheet (39\*54cm/sheet) which made of imported nylon
- Like suede-feel and good fastness
- Apply to cap, shoes, luggage, high-end polo

### HOW TO USE:



TEMP

155~160°C/311~320°F



TIME

10-12s



FORCE

0.24 kgf/cm<sup>2</sup>



PEEL

after cool peeling





## AW31 FLOCK PATCH

- Use Imported nylon materials
- Good washing resistance and hand feelin
- Apply to Kid's clothes, knitted fabric, sportswear etc

### HOW TO USE:



#### TEMP

130~150°C/266~302°F



#### TIME

5-10s



#### FORCE

0.24 kgf/cm<sup>2</sup>





## AW36 3D LENTICULAR PRINTING

- Use a plastic sheet with many lined lenses, can see different patterns with different viewed angle
- Covered with hot melt adhesive, apply for clothes, hoodies, hat bag ect.
- The thickness and size can be customized

### HOW TO USE:



TEMP

130~150°C/266~302°F



TIME

10-15s



FORCE

0.24 kgf/cm<sup>2</sup>







## AW32 EMBROIDERY PATCH

- Instead of sewing, improve efficiency and cut down labor cost
- Good washing resistance and hand feeling
- Apply to Kid's clothes, knitted fabric, sportswear etc



### HOW TO USE:

**TEMP**  
 Up Side: 150~160°C/302~320°F  
 Back Side: 150~160°C/302~320°F

**TIME**  
 Up Side: 20s  
 Back Side: 20s

**FORCE**  
 0.24 kgf/cm<sup>2</sup>



## AW33 TOOTHBRUSH PATCH

- Use Imported nylon materials
- Good washing resistance and hand feelin
- Apply to Kid's clothes, knitted fabric, sportswear etc

### HOW TO USE:



TEMP

150~160°C/302~320°F



TIME

30-60s



FORCE

0.24 kgf/cm<sup>2</sup>





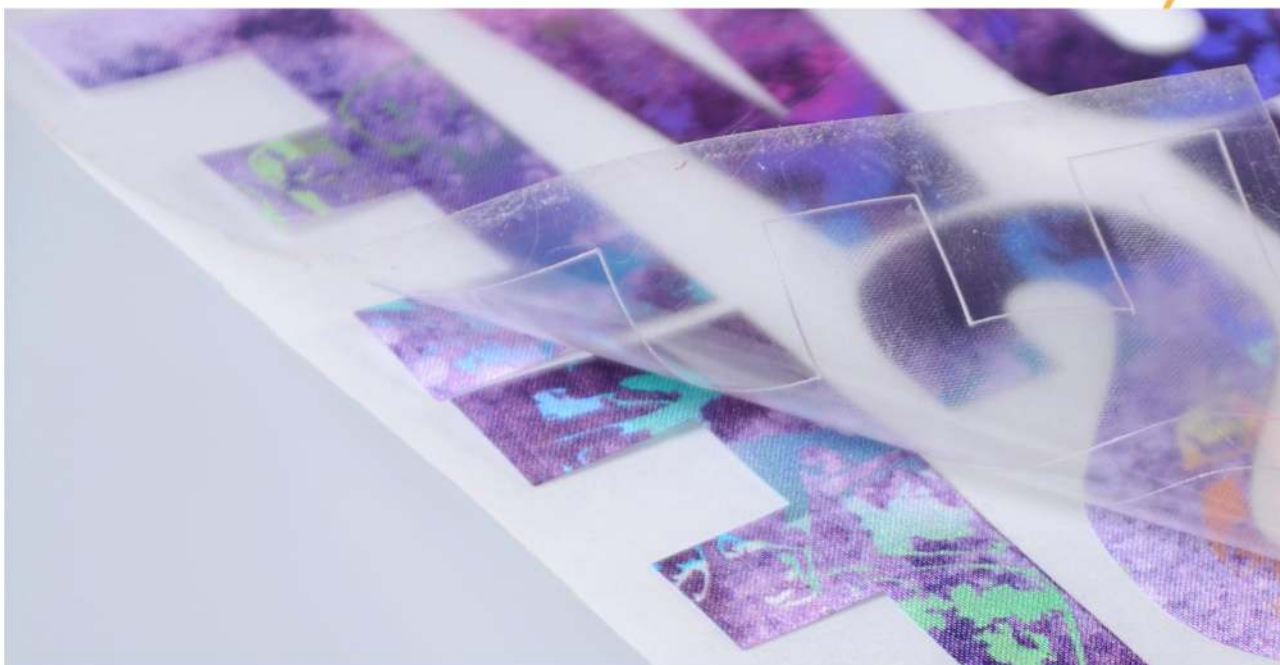

## AW34 LASER

- Colors can be customized
- Metallic, holographic effect etc. Are available
- Apply to cotton, polyester or spandex

### HOW TO USE:



TEMP

150~160°C/302~320°F



TIME

10-12s



FORCE

0.24 kgf/cm<sup>2</sup>



PEEL

after cool peeling



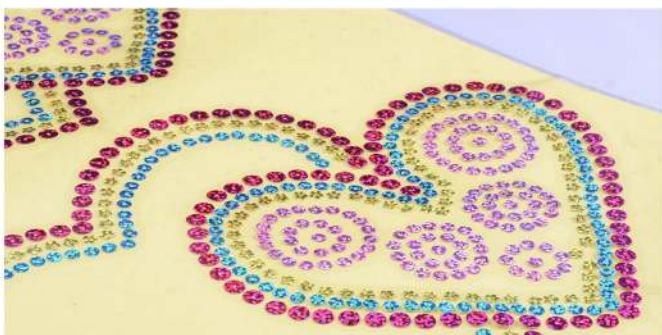

## AW35 SEQUENCE

- Use different shapes of sequences
- Bright color and eco-friendly
- Apply to shoe, cap, kid's clothes, underwear, toys etc.

### HOW TO USE:



TEMP

130~150°C/266~302°F



TIME

10-15s



FORCE

0.24 kgf/cm<sup>2</sup>



PEEL

warm peeling







XIAMEN KENTEER NEW MATERIAL SCIENCE AND TECHNOLOGY CO.,LTD.

☎ 86-592-7675770

✉ NANCY@KENTEER.COM

🌐 WWW.KENTEERHTV.COM

📍 ADD.: C301 BLDG C JIANYE BUILDING INDUSTRIAL DISTRICT,  
(XIANG'AN) TORCH HING-TECH ZONE, XIAMEN, FUJIAN, CHINA

