



Cheeeese Ultra Clean Electric Toothbrush

Please read the instructions carefully before using this product.

IMPORTANT SAFEGUARDS

When using electrical products, especially when children are present, basic safety precautions should always be followed, including the following:

READ ALL INSTRUCTIONS BEFORE USING



DANGER – To reduce the risk of electrocution:

1. Do not place or store product where it can fall or be pulled into a tub or sink.
2. Do not reach for a product that has fallen into water. Unplug immediately.



WARNING – To reduce the risk of burns, electrocution, fire, or injury to persons.

1. A product should never be left unattended when plugged in.
2. Close supervision is necessary when this product is used by, on, or near children or invalids.
3. Use this product only for its intended use as described in this manual. Do not use attachments not recommended by the manufacturer.

4. Never operate this product if it has a damaged cord or plug, if it is not working properly, if it has been dropped or damaged, or dropped into water. Return the product to a service center for examination and repair.
5. Keep the cord away from heated surfaces.
6. Never block the air openings of the product or place it on a soft surface, such as a bed or couch, where the air openings may be blocked. Keep the air openings free of lint, hair, and the like.
7. Never use while sleeping or drowsy.
8. Never drop or insert any object into any opening or hose.
9. Do not use outdoors or operate where aerosol (spray) products are being used or where oxygen is being administered.

About Me

 Powered by ultra-effect cleaning system

Usage mode: Sensitive/Clean/White

Battery specification: lithium battery/18650/3350mAh

Low power reminder: the battery indicator light flashes

Battery life: 1200mins(sensitive mode)

Charge current: $300 \pm 30\text{mA}$

Operating voltage: 5V 

Switch mode: touch the switch

Display mode: LED marquee

Charging time: 10~13hrs

Tips:

The brush head is made of food-grade materials. Please rest assured to use.

Brush head

Switch button

Mode indicator

Marquee effect

Battery indicator light

USB charging port



Cheeeese Brief Description of Battery Status

1.Cheeeese electric toothbrush equipped with a built-in super large capacity lithium battery, which provides 10-12 months of standby time after fully charged.

2.Cheeeese electric toothbrush will undergo a complete charging and discharging process before leaving the factory. However, due to the change of inventory time and natural discharge of the product, the power of the new product you purchased does not reach the full power state; but you can still use the product after unpacking, and enjoy the refreshing experience of deep tooth cleaning brought by Cheeeese electric toothbrush.

3.Cheeeese electric toothbrushes are charged with a USB standard charging interface. You can use a USB charging adapter or mobile power bank that meets national standards to charge Cheeeese electric toothbrush. However, charging with a inferior charging adapter may cause product failure or damage.

4. According to the professional test of Love-Tooth Laboratory, a complete charge takes about 10-13 hours. The specific charging time will vary due to the remaining power of the product and the impact of the charging environment.

5. When the battery indicator light on the handle flashes red, it means that the power is close to the critical value of low power. Please be sure to charge the Cheeeese electric toothbrush to prevent the built-in battery from malfunctioning due to over-discharge.

6. When the battery indicator light on the handle flashes green, it means that it is charging, and when the indicator light is steady green, it means that the battery is fully charged.

Note: to use the charging adapter and power bank, the electric toothbrush needs to be charged in the 5V/0.3A mode.

* In the laboratory environment and the battery is fully charged, the average use time of the three gears is taken, and it can be used for 10-12 months based on two minutes of use twice a day.

3 Brush Heads

1.Cheeeese 3DClean Brush Head

Bristles: USA Dupont bristles

Bristle stiffness feel: medium

Size: standard

Description: 3D intensive design, soft bristles, grinding round processing. Suitable for sensitive teeth.



2.Cheeeese SmartCare Brush Head

Bristles: USA Dupont bristles

Bristle stiffness feel: medium

Size: standard

Description: 3D intensive design, soft bristles, grinding round processing. Suitable for sensitive teeth. The color of the bristles will be faded after 3 months of use, smart reminder for brush heads replacement.



3.Cheeeese UltraCare Brush Head

Bristles: Japan super soft bristles

Bristle stiffness feel: super soft

Size: standard

Description: each bundle of bristles is made of 0.002mm soft bristles, which evenly disperse the



pressure on the gums and deeply clean the dirt on the inside of the gums. Reduce gingival discomfort, prevent gingival bleeding and other symptoms.

Start

The pentalogy for better teeth cleaning.

01 Installation

Align the interface and install the brush head.

Tips: do not twist the brush head.

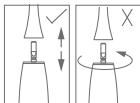

02 Wash

Rinse with clean water and squeeze an appropriate amount of toothpaste.



03 Selection

Auto-3 cleaning mode:
personalized deep tooth protection.

Tips: it is recommended to select sensitive mode for initial use.



04 Brush

Place the bristles of the brush head on your gums at a 45-degree angle

Tips: power on after the brush head placed into the mouth.

Brushing mode



Sensitive
33000/min
gentle and soft.



Clean
36000/min
clean and protect tooth.



White
37000/min
remove dental stains
with high frequency



Smart

Learn more about your tooth



5s intelligent memory
Smart and considerate,
remember your habits.



2 minutes smart timer
Brushing time, scientific
planning



1-Click mode switching
One click switching, easy and simple.



30s movement reminder
Every corner of the mouth is clean and balanced.



High-capacity battery
1 year service time.



Marquee effect
Stylish design & battery life note

Tips

5 scientific habits to protect tooth

01

Regular cleaning

Brush your teeth in the morning and evening for at least 2 minutes each time to clean your teeth in an all-round way.



02

Set a correct schedule

Brush your teeth 20 minutes after
the meal to protect the enamel.

Eating



After 20 min



03

Gum protection choice

Soft bristles recommended for sensitive gum



04

Use dental floss

Deep into the gap between the unbrushed teeth
Remove food debris and dental plaque.



05

Regular oral examination & tooth washing.

Clean the gaps with the floss pick to remove the
food debris & dental plaque.



Special

Dental health advice

Starting from becoming a good role model for children, help children protect their teeth and gums and reduce the frequency of dental caries.



Children

(for children
over 6 years old)

- Brush your teeth every morning and evening, no less than 2 minutes each time.
 - Ensure a balanced diet and control snack intake.
Use fluoride toothpaste to effectively prevent dental caries.
 - Use a special soft toothbrush for children to gently clean each side of the teeth.
 - After brushing your teeth, gently brush the tongue with bristles to effectively reduce dental plaque.
 - Regular oral inspections.
-

In order to have neat and beautiful teeth, more and more teenagers choose to wear braces, which increases the difficulty of cleaning. Therefore, daily dental care should not be careless.



Teenager

- Brush your teeth every morning and evening, no less than 2 minutes each time.
 - Use fluoride toothpaste to remove plaque and prevent dental caries.
 - Eat less sugary sticky tooth snacks and rinse your mouth after meals.
 - Use dental floss to clean food residue and dental plaque between teeth before going to bed every day.
 - Regular professional dental examinations.
-

During pregnancy, female gums are more prone to redness, swelling and sensitivity. Good oral hygiene should always be maintained to ensure the health of teeth and gums during pregnancy.



Pregnancy

- Many pregnant women will have gingivitis of pregnancy. They need to brush their teeth twice a day, floss and keep their mouth clean.
- Choose a soft toothbrush to thoroughly and gently clean the gap between teeth and around teeth to reduce gum pain.
- The acidic substances in morning sickness will erode the teeth of pregnant women. After morning sickness, rinse your mouth thoroughly with water or mouthwash.
- Drink plenty of water or chew sugar-free gum to promote saliva secretion and effectively kill oral bacteria.

Maintain correct tooth cleaning and care habits, and healthy teeth can last a lifetime. No matter how old you are, it is very important to take care of your mouth.



Elderly

- Insist on using fluoride toothpaste to prevent dental caries.
- Drink plenty of water or chew sugar-free gum to increase saliva secretion and reduce the risk of dental caries.
- Dentures also require meticulous and comprehensive cleaning.
- Gently massage your gums after brushing your teeth to promote blood circulation and keep your gums healthy.

Care

Daily maintenance



Brush head

Rinse with clean water after each use and dry naturally;
For your experience and prolong product life, please use Cheeeese original replacement brush head.



Toothbrush host

It can be directly cleaned with clean water and air-dried naturally.
Do not use water higher than 40℃ or acid cleaning solution for cleaning;

USB direct charge

- a. Before the toothbrush leaves the factory, there will be surplus electricity, please use up the surplus electricity before charging;
- b. The continuous flashing of the charging indicator indicates that the power is insufficient. Please charge in time;
- c. Please recharge after the power is used up to prolong the service life of lithium battery;
- d. During charging: the electric quantity indicator is displayed by the breathing lamp and charged;
- e. After full charge: the power indicator is always on;
- f. Completely discharge the electric toothbrush at least once a year.

Note: the power cord cannot be replaced. If the cord is damaged, the appliance should be discarded.



Do not drop

If the body or brush handle is damaged, do not use it.



Keep away from heat

The body or charging port cannot be used in a high-heat environment.



Do not disassemble or assemble by yourself

For repairs, please contact our after-sales department.



When discarding the product, please do not stack it with general household waste, but hand it to the officially designated recycling center, which is conducive to environmental protection.

Dispose of the battery

- a. The built-in rechargeable battery contains substances that may pollute the environment. When discarding the electric toothbrush, be sure to take out the battery and dispose of the battery at the official designated recycling station. Or send the electric toothbrush to officially designated recycling station.
- b. If you have problems removing the battery, you can also send the electric toothbrush to Cheeeese repair center. The staff there will remove the battery for you and dispose of it in an environmental friendly way.
- c. Remove the rechargeable battery of the electric toothbrush. You can remove the rechargeable battery only when you discard the electric toothbrush. Please make sure that the battery is completely discharged when you remove the battery.

Specific operation steps

- a. Cut off the power supply of the electric toothbrush
- b. Stop the electric toothbrush
- c. Remove rear lid
- d. Remove the battery

Note: do not connect the electric toothbrush to the power supply.

Name and content of hazardous substances in the product

Component name	Toxic and harmful substances or elements					
	Lead (Pb)	Mercury (Hg)	Cadmium (Cd)	Hexavalent Chromium [Cr(VI)]	Polybrominated biphenyls (PBBs)	Polybrominated diphenyl ether (PBDEs)
Plastic parts	O	O	O	O	O	O
Hardware parts	O	O	O	O	O	O
Circuit control components	X	O	O	O	O	O
Motor components	O	O	O	O	O	O
Battery	O	O	O	O	O	O
Power cord	O	O	O	O	O	O

This form is compiled in accordance with the provisions .

O: Indicates that the content of the hazardous substance in all homogeneous materials of the component is below the limit requirement.

X: Indicates that the content of the hazardous substance in at least one of the homogeneous materials of the component exceeds the limit requirement.



Q&A

Q: The vibration of the toothbrush seems to be getting weaker and weaker?

A: Please consider whether it needs to be charged in time due to insufficient power.

Q: I have charged it, but the battery life is still very short?

A: Please make sure whether the toothbrush is placed vertically during charging, resulting in poor charging effect; if the problem is still unsolved, it may be that the battery has reached the end of its service life, please contact our after-sales department for replacement.

Q: If the idle electric toothbrush is not used for a period of time, and the charging indicator does not light up.

A: If you don't use it for more than six months, the battery will enter the dormant state. It takes 6-20 minutes to wake up after recharging, which is a normal phenomenon. Please rest assured to use it.

Q: What should I do if the electric toothbrush cannot be started?

A: Please consider whether it can continue to be used normally after charging due to insufficient power; if it still fails to start after charging, please contact our after-sales department for repair or replacement.

Certificate of conformity

The inspector promises that this product has been strictly inspected by the quality team of Cheeeese company, please rest assured to use it.



Warranty Regulations Service Commitment

Warranty regulations

The warranty service is limited to the valid warranty period under normal use, and the non-artificial damage caused by the quality of the product itself, the following three guarantee services will be enjoyed according to the national three-guarantee regulations with the invoice and this warranty card:

- 1: If the failure occurs within 2 years from the date of purchase, the seller is responsible for free replacement.
- 2: If the failure occurs within 2 years to 3 years from the date of purchase, you can enjoy free repair service during the effective warranty period.

Please bring this certificate and valid purchase invoice when repairing. This certificate shall not be altered, otherwise it will be

regarded as an invalid certificate, and this certificate will take effect only after being sealed by the seller.

Non-warranty regulations

The following situations (but not limited to the following situations) are not within the scope of the Three Guarantees service:

- 1.The contents on the warranty card are inconsistent with the actual product label or altered.
- 2.Unauthorized maintenance, private disassembly, misuse, collision, liquid inlet and modification; or product quality problems caused by improper use, or tearing up or altering product labels, anti-counterfeiting marks, machine serial numbers, etc.
3. Damage caused by failure to use, repair and maintain according to the requirements of the product instruction manual.
4. Damage of products and accessories due to man-made reasons.
5. Damage caused by force majeure such as floods, fires, lightning strikes, etc.
6. The use of non-original accessories causes product failure or accidents.
7. There is no warranty card and valid invoice, and it cannot be proved that the goods are within the validity period of the Three Guarantees.

Warranty card

Customer name: (Mr. / Ms.) _____

Order number: _____

Customer address: _____

Postal Code: _____

Host model: _____

Commodity origin: _____

Purchase shop: _____

Purchase date: _____

Invoice number: _____