

This manual tries to keep the accuracy and rigor of the information, please in kind prevail if there is any error on images or texts, welcome to point it out for improving.
In addition: If the technical of the beard trimmer has improved, it will be edited in new specification without notice. The appearance and color of the beard trimmer take the material objects.



Brand Owner: Shenzhen Eukey E-Business Co., Ltd.
Email: support@suprent.com



NOSE HAIR TRIMMER NH5S113BX

TABLE OF CONTENTS

PRODUCT DESCRIPTION.....	1
SPECIFICATIONS.....	1
MATTERS NEED ATTENTION.....	2
CHARGING METHOD.....	2
NOSE HAIR TRIMMER INSTRUCTIONS.....	3
CLEANING AND MAINTENANCE.....	4
STORE.....	4
TROUBLESHOOTING METHODS.....	5
NO WORKING.....	5

Product Description

This electric hair trimmer is specially designed for consumers with vigorous hair in the nasal cavity. Through safe and simple nursing, it can make the face fresh, smell sensitive and comfortable and prevent bacteria from breeding.

This product uses the environmental protection fine steel inner blade and the V shape Outer blade. It is convenient to use. It doesn't hurt the skin. The USB charging design with the lithium polymer rechargeable battery. It is one hour fast charging, can be used for more than 120 minutes. The circuit board double protection function and super silent motor, it feels safe and comfortable.

Specifications

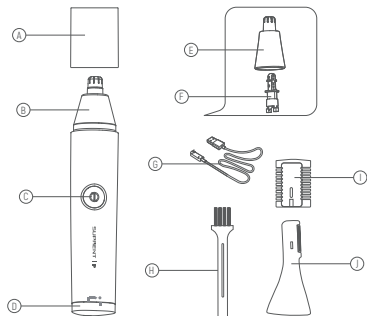

A. Nose hair trimmer head
B. Switch button
C. ON/OFF
D. Charging socket
E. Protective cover

F. Eyebrow hair trimmer head
G. USB Wire
H. Brush
I. Eyebrow trimming comb
J. Eyebrow trimming

Matters need attention

1. This product is only used for nose hair trim,ear hair trim,facial hair trim and eyebrow hair trim,don't use in other body parts.
2. This product is waterproof,you can use it directly by water.
3. Please use this product with the scope of the specification.
4. When using the product,don't insert it into the nostril and turn it on.You need to turn it on before insert into the nostril.
5. For hygiene reasons,it is recommended that each product be used by one person only.
6. Patients with any disease should consult their doctor before use.
7. If there is any pain or discomfort,please stop using immediately.
8. Skin redness,irritation,infection or skin blisters should be postponed use.
9. This product is not suitable for children,the lack of experience or visual impairment should be used under the guidance of the family.
10. Do not store the product or store it in direct sunlight.
11. Please take good care of this product. Children are not allowed to play with it.
12. Please do not disassemble this product.
13. When not in use for a long time,please store it fully charged,or charge it at least once in three months.

Charging method

1. Make sure the switch is off.
2. Open the cover of bottom, plug the power cord into the charging socket at the bottom of the product (figure 1).
3. USB interface will be plugged into the charging kit, computer interface or ordinary mobile phone charger interface (figure 2).
Note: when using the charger of Panasonic and Philips products, please check whether the output voltage of the charger is 5.0V, if it is higher than 6V, it can not be used.
4. When the red indicator light is on, the product is charging (figure 3).
5. The charging time is 1-1.5 hours. When the product is fully charged, the red indicator light changes to white light.
6. When using this product, or the product has not been used for a long time, it should be charged for 2-3 hours.

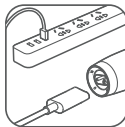

fig 1

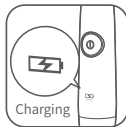

fig 2

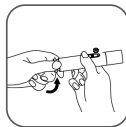

fig 3

Nose hair trimmer instructions

1. Make sure the product has enough power.
2. Pull out the protection cover vertically, press the switch gently and the product starts to work (figure 4).
3. When starting up, gently touch the trimmer head with the part to be trimmed and moved it gently (figure 5).
4. When using this product, try not to touch the switch button, to avoid the skin discomfort caused by sudden stop.
5. Repeat above steps until the hair is trimmed. Warning: When using this product, do not stay in certain area for more than 3 seconds to avoid skin discomfort.
6. Repeat the above steps.
7. Let the trimmer head 45° diagonally and gently touch the part to be trimmed (figure 6).
8. Gently shift the position until the trim is satisfactory.



fig 4



fig 5



fig 6



fig 7

Cleaning and maintenance

Warning: this product should not be rinsed under the faucet. If cleaning is needed after using this product, please follow the following steps:

Warning: this product should not be rinsed under the faucet. If cleaning is needed after using this product, please follow the following steps:

1. Touch the switch to turn the product off.
2. Use a brush to clean the hair outside the head (figure 7).
3. Remove the trimmer head assembly by counter-clockwise rotation, hold the trimmer head assembly in your hand, with the trimmer head downward, rinse under the water (figure 8).
4. After washing the trimmer head, make sure there is no water in the trimmer head assembly. It is best to wipe it clean with a dry cloth.
5. The hole position of the white plastic part inside the trimmer head should be aligned with the driving rod on the fuselage. After installation, the plastic part of the trimmer head assembly should be rotated gently in the clockwise direction, and the "click" sound should be heard (figure 9).
6. Install protection cover vertically.



fig 8



fig 9



fig 10

Store

1. Please choose a cool and dry place to keep this product.
2. Please keep the product away from children.
3. Do not place it in the direct sunlight.
4. Do not place the product at high temperature and pressure to avoid injury to human body.

Troubleshooting methods

Short of power:

Charge in time and check that the charging indicator light is on
Abnormal sound or noise: there is debris or excessive hair in the trimmer blade, please clean it in time.

NO Working:

Remove the trimmer head and check whether the trimmer head is installed in place or not. If the trimmer head is not in the right place, please reinstall the head again and make sure the trimmer blade is in the proper position.

BASIC PARAMETERS

Batteries:	500mA lithium battery
Rated voltage:	DC 5.0V
Power:	1W
Charging time:	60 minutes
Using time:	150 minutes