

USER MANUAL



Cordless Hair Clippers - HC575
IPX6 Waterproof

This user manual tries to ensure the accuracy of the information, please kindly point it out for our improvement in the future, if there are any errors on the images or the texts. We'd be very appreciative of your support and effort. In addition: If the technique of the trimmer has been improved, it will be upgraded and updated in the new version as well as the specification without announcement.

Product Introduction

The SUPRENT hair clippers provide a quick and easy way to create professional-looking haircuts. Developed to combine professional-grade blades with premium guide combs, this hair clipper enables you to achieve customized, modern looks and traditional hairstyles. To help you create those styles, and to extend the life of your hair clipper, please read all instructions before using.

Product Overview

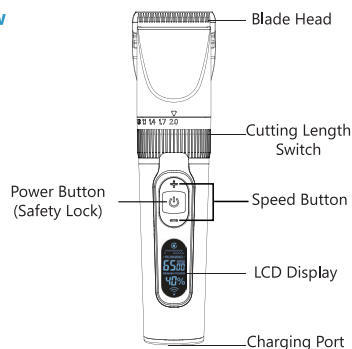

LCD Screen Function Description

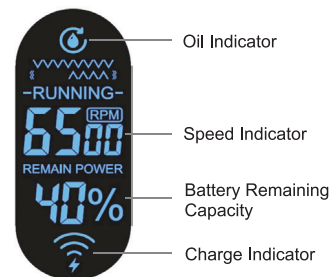

• Oiling Indication

When the product working time reaches 60 minutes in total, the oiling indicator begins to blink to remind you clean and oil the blade

• Speed Indication (RPM)

5-speed modes are available: 5000/5500/6000/6500/7000 RPM

• Battery /Charging Reminder

1. When the battery reaches 10%, 5%, 0%, it will beep 3 times.
2. When the battery reduces to 5%, the charging indicator blinks. When plugging the power adapter into the socket, there will be a "beep", the charging indicator will flash from bottom to top.
3. After the battery is fully charged, there will be a "beep" and the battery capacity reminder shows 100% and the charging light blinks at the same time.

Switch Button Function



- Power Button

Short press the power button to turn it on or off.

- Safety Lock or off

Press and hold the power button for 3 seconds, the safety lock is turned on or off.

The safety lock is designed to prevent the hair clipper from being accidentally opened.

Speed Adjustment Button



- Speed Control Button

Motor speed range:5000-7000RPM.

- “+”Or“-” Button.

Every time you press it to adjust 500RPM.

Charging Methods

This product contains a lithium battery with a capacity of 2000mAh The charging time is about 2 hours. After the product is fully charged, the running time is no less than 210 minutes.

Cutting Length Adjustment of Blade



Adjusting the ring to choose the hair length that you want to remain ranges are: 0.8/1.1/1.4/1.7/2.0 mm



Different sizes of combs are available for you to remain different length of hair, the size includes: 3/6/9/12/15mm

Product Specification

Item	Parameter
Brand	SUPRENT
Name	Cordless Hair clippers
SKU	HC575
Power Supply Input	AC 100-240V, 50/60Hz
Power Supply Output	DC 5V/1A
Power	5W
Battery Voltage	3.7V
Battery Capacity	2000mAh Li-ion
Charging Time	2 Hours
Running Time	3.5 Hours
Motor Speed	5000/5500/6000/6500/7000RPM
Attachment Guide Combs	3mm/6mm/9mm/12mm/15mm Left/Right Ear Taper
USB Cable	1.2m
Waterproof Grade	IPX6 Waterproof

Beginning the Hair Cut

Before the Hair Cut

1. Inspect the clipper, making sure that it is free of oil between the cutting blade teeth and turn the unit on to distribute the oil and to make sure it is running smoothly. Wipe off any excess oil. This should be done after each use. While using the unit, untwist the cord from time to time to avoid tangling.
2. Seat the person so their head is approximately at your eye level. This allows ease of visibility while cutting and a relaxed control of the unit.
3. Before cutting always comb the hair first so that it is tangle-free and as it is naturally worn.

Attach Guide Combs

Cutting hair requires practice so it is always better to leave the hair longer for the first few haircuts until you become used to the length to which each comb attachment cuts the hair.

Attachment Comb (see main diagram)

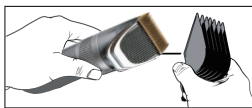

1. Guide combs should be installed by first hooking the blade teeth front side of the guide comb. Then press the back of the guide comb down until it snaps into place.
2. Ensure the comb is attached before beginning to cut hair.
3. To remove, pull the snap tab on backside of the guide comb and pull the comb off.

Notes:

The first time you cut hair, cut only a small amount of hair until you become accustomed to the length of hair each guide comb provides

- Start by attaching the largest guide comb on the clipper.
- Then use shorter guide combs if a shorter length is desired.
- For uniform cutting, cut at a slow, even speed.

Steps For Hair Cutting

Step 1-Nape of The Neck

1. Attach comb attachment 3mm or 6mm.
2. Hold the clipper cutting edge pointed up and begin the haircut, starting at the centre of the head at the base of the neck (see diagram 1).
3. Hold the clipper comfortably in your hand and hold lightly against the head with the comb teeth pointing upward. Gradually and slowly lift the clipper working upwards and outwards, through the hair, trimming just a little at a time.
4. As you cut, gradually lift the clipper head towards you. Continue to cut the back area from the bottom of the neck upwards to the top of the ears.

Step 2-Back of The Head

- Change to the next longest comb attachment 9mm or 12mm and cut the back of the head (see diagram 2).

Step 3-Side of The Head

- Change to one of the shorter combs 3mm or 6mm, trim sideburns, i.e. the hair directly in front of the ears. Change to one of the longer combs, 9mm or 12mm, and continue to cut to the top of the head (see diagram 3).

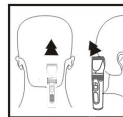

diagram 1

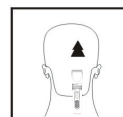

diagram 2



diagram 3

Step 4-Top of The Head

- Using the comb attachment 9mm or 12mm, cut the top of head from back to front against the direction in which the hair normally grows (see diagram 4). In some cases, this may require the reverse, or cutting from front to back.
- Comb attachments 3mm or 6mm are used to achieve a close crew cut or short cut.
- For longer hair on top, use the comb provided and lift the hair on the top of the head. Cut

over the comb, with the hair lifted or hold the hair between the fingers to lift it and cut it to the desired length (see diagrams 5 and 6). Always work from the back of the head. Hair can be cut shorter gradually by reducing the space between the comb/fingers, and the head.

Comb out trimmed hair and check for uneven strands.



diagram 4



diagram 5



diagram 6

Step 5-The Finishing Touch

- Finally, use the Taper Lever without an attachment comb for close trimming around the base of the neck, the sides of the neck and the ears.
- To produce a clean straight line at the sideburns, reverse the Clipper by turning the reverse side uppermost (see diagram 7).

- Press the Clipper at right angles to the head, tips of the blades lightly touching the skin and work downwards.

This way will obtain, as a clean-cut as would be given by a razor.



diagram 7

Short Tapered, Flat Tops and Short Cuts Hairstyle

- Starting with the longest attachment comb (12mm), cut from the back of the neck to the crown. Hold the attachment comb flat against the head and slowly move the clipper through the hair, as shown (see diagram 8).
- Use the same procedure from the lower side to the upper side of the head, as illustrated. Cut the hair against the direction in which it grows from the front to the crown and then level the cut with the sides.
- To give a 'flat top' look, the hair on top of the head must be cut over the top of a flat comb instead of using the attachment comb.



diagram 8

- Use closer cutting attachment combs to taper the hair down to the neckline as desired. Comb hair and check for uneven areas and outlining sideboards and neckline as described previously.

Cleaning and Maintenance

Blade Removal

- Unit must be off. Hold unit securely in one hand Grip blade and push with your thumb the top of the blade away from the unit.
- Use enough force to move the blade of the retaining snaps and the blade off the bottom.
- Pull blade away from the unit. Reverse order to reattach blade.



Cleaning

- Turn off clipper and detach blades.
- Use the brush included to remove the accumulated hair from the cutters.
- Rinse the inside of the cutter and blades. Clean the body of the hair clipper with a damp cloth or under running water.

Every Six Months

- At regular intervals the blade set should be removed and cleaned Brush out hairs from between the blades with a soft cleaning brush.
- Do not remove the lubricating grease on the plastic components. It is not necessary to remove the small moving blade from the unit.
- Place a few drops of clipper oil onto the blade's gliding surface. Wipe off excess oil.

Storage

Always store this appliance and cord in a moisture-free area. Do not wrap the USB charging cable around the appliance. Do not store in temperatures above 140F.

Blades Maintenance

It is recommended to oil the blades after every use. Place 2 to 3 drops of lubricating oil on the moving blade and turn on the clipper. The oil should distribute on its own and wipe off any excess oils.

Attention

1. The battery may run out during long-distant transportation. It's recommended to fully charge the device before first use.
2. The device is equipped with a Micro-USB charging cable, and a 5V/1A adapter is not included.
3. Always attach the plug to the appliance and then the adapter to the outlet. To disconnect turn all controls to OFF, remove the adapter from the outlet, then detach the power cord from the clipper for storage.
4. Please keep the body of the device away from water or other liquid.
5. To maximize battery life trimmer should be shut "OFF" immediately after use.
6. Close supervision is necessary when this appliance is used by, on, or near children or persons with special needs.
7. Use this appliance only for its intended use as described in this manual.
8. Keep the USB charging cord away from heated surfaces.
9. Before use, making certain blades are aligned properly.
10. Unplug this appliance before cleaning.

Warnings

1. This product is not suitable for the following people: people whose physical or mental ability has deteriorated, or those who lack experience and knowledge of using. So these people must be supervised by other people when using this product
3. Do not use attachments not recommended by the manufacturer.
4. Be sure to check carefully before using the product. If there is any damage, please stop using it
5. Please use, charge and store this product at a temperature between 15 °C - 30 °C.

6. Please do not use compressed gas, steel wool, abrasive cleaners or aggressive liquid (oil or acetone) to clean the device, or the device may be corroded.
7. Do not use this appliance with a damaged or broken cutter unit, as injury may occur. Always make sure blades are aligned properly.
8. Do not use this appliance with a damaged or broken comb nor with teeth missing from the blades as injury may occur.
9. Do not pull, twist, or wrap line cord around appliance. Never drop or insert any object into any opening on this appliance
10. Do not place the appliance on any surface while it is operating
11. Do not place or store the appliance where it can fall or be pulled into a tub or sink.

Manufacture information

Brand Owner: Shenzhen Eukey E-Business Co., Ltd

Customer Service



12-Month Limited Warranty



Lifetime Technical Support

Contact US



For FAQs and more information, please visit:



Website: www.suprent.com



Email: support@suprent.com

