

SUPRENT PEARL Series all-metal cordless hair trimmers for men is a new trimmer we upgraded in 2021, including green and black. Enough to meet your choice of different lengths of beard trimming with 6 different limit combs. This trimmer is also a T-outline trimmer that is very suitable for trimming details and for a popular hairstyle. The sharp blade is great at making crisp, clean lines.



Brand Owner:ShenZhen Eukey E-Business Co.,Ltd
Email:support@suprent.com

CALLUS REMOVER INSTRUCTION

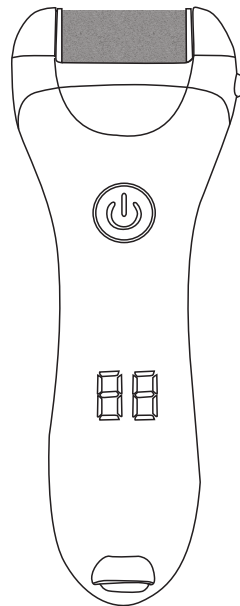

TABLE OF CONTENTS

| | |
|---|---|
| Product Structure Introduction..... | 1 |
| Caution..... | 1 |
| Using the product..... | 3 |
| Cleaning..... | 5 |
| Environmental protection and recycling..... | 6 |

1 Product Structure Introduction

Product Structure Introduction

- A. On/Off Button
- B. Mainframe
- C. Battery Capacity with LED Display
- D. Charging Interface
- E. Grinding Head Replacement Button
- F. Grinding Head
- G. Cleaning Brush
- H. USB Cable

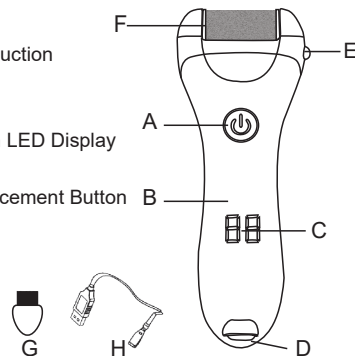

2 Caution

Before using the product, please read this manual carefully and keep it for future reference.

1. This electrical appliance can not be used as a child's toy.
2. Young children can only use it under the supervision and guidance.
3. This product can only be used as household appliances, not for industrial purposes.
4. This product can not be used in the production of corrosive or explosive gas and other special environment.

5. This product can not be used as medical appliances.
6. Please do not disassemble, repair or rebuild the products without permission.
7. Do not store in direct sunlight or where storage conditions are too hot or humid.
8. If the power cord is damaged, it must be replaced with a special component purchased from the manufacturer or maintenance department.
9. When charging, please stay away from the water source and do not charge near the water bath, tub or other liquid container. Please unplug immediately after charging.
10. Please use this product in the description of this manual. Please do not use accessories not recommended by manufacturer.
11. Do not throw the product or any foreign body into the charging socket connection, it will cause the damage of product.
12. Do not soak the charging cable in water or other liquids, and do not use it rinse under faucet.
13. The machine whole body can be washed. Do not soak the product in water for a long time.
14. Grinding head is only suitable for calluses, hard and thick dead skin, such as heels, please do not use this product on normal skin.
15. For sanitary reasons, it is recommended that each quartz grinding roller be used by one person only. It is best not to share with others.
16. If you have any skin problems or other medical problems, please use it after consulting your doctor.
17. When using, the grinding roller should not stay in one skin area for more than 3 seconds. Please use it and also move it.

18. Do not use when the skin is red, inflamed, infected or causes blisters.
19. Do not use this product on warts, ulcers or wounds of the skin.
20. If you have any pain or discomfort, please stop using immediately. Using the callus remover excessively can cause skin thinness and skin irritation. If skin irritation or bleeding is severe, please seek medical advice immediately.
21. In order to prevent accidents and harm to your body, Please keep away from your scalp, hair, eyebrows, eyelashes and clothes, wool, shoelaces, etc when using the callus remover.
22. Please keep the hand-held part away from the power cord before cleaning it in the water.

3

Using the product

Charging method

Note: please fully charge before using this product for the first time.

Charging steps: insert one head of USB cable into the charging hole of the body, connect the other end to the phone charger or computer USB jack, etc. And the charging indicator light will be on. Charging will be completed in about 3 hours, and the indicator light will stop flashing (Charging time should not exceed 12 hours).

Assemble and remove grinding head

Replace the grinding head according to the following operation. The grinding head can be selected and replaced according to the roughness of the skin and the expected effect. Before replacing the grinding head, make sure the power supply is disconnected and the machine is shut down.

1. As shown in figures, use one hand to hold the head of product and the other hand to press the grinding head replacement button. Then the grinding head will be opened and removed. (fig.1 and fig.2)

2. When replacing the grinding head, put a new grinding head into the product until you hear the sound of "click". Make sure that the newly installed grinding head has in place. If the grinding head is not connected well, do not press the product button.

Note: when opening the package, 1 grinding head has been installed on the body.

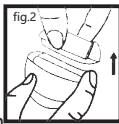
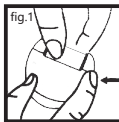

Exfoliating

This product is designed for use on dry and rough feet or heel skin, not on other parts of the body.

1. Ensure sufficient power of the product.
2. Make sure the quartz grinding head is installed in this product. If removing and replacing the grinding head, please refer to the usage preparation in the previous section.
3. Clean or soften the skin and dry the applied area to ensure the best results.

Note: Do not use if there are cuts or bleeding on the skin.

4. Press the switch.
5. Gently hold the grinding head to stay in the dry and rough skin area for 2-3 seconds. Do not press too tightly, and let the grinding head gently across the skin. If press too tight, force too much, this product will stop using. You can stop to

4

check if the exfoliation is satisfactory during use, if not, you can use it to this area again, until the skin is smooth and delicate.

Warning: Do not use the callus remover immediately, if the skin becomes painful or inflamed.

Warning: Do not apply to any part of the skin for more than 2-3 seconds.

6. Please turn off the product after use.
7. Rinse skin or use a wet towel to remove excess cutin.
8. Clean the product after use. See the cleaning section.
9. Please keep the product in a dry and ventilated shady place.

4 Cleaning

1. Remove the gringing head and clean the cutin in the callus remover with cleaning brush.
2. The grinding head can be cleaned with water separately to remove the cutin in the grinding head. After finishing, wipe the machine with a cloth and dry it. The machine whole body can be washed.
3. Note: the product must be off and make sure that it is disconnected with the charging cable and socket.

Three kinds of grinding head

Fine grinding head: suitable for calluses, dead skin and delicate skin care.

Medium grinding head: suitable for newly formed calluses and normal skin care.

Rough grinding head: suitable for years of accumulation of thick cocoon and thicker skin care.

5

Technical parameters

Charging voltage: 5V

Charging time: 3 hours

Using time: 90 minutes

Please save this instruction for future reference.

5 Environmental protection and recycling

Do not throw away the product with normal household waste at the end of its life, but hand it in at an official collection point for recycling. By doing this, you help to preserve the environment.

This product contains a built-in rechargeable battery which shall not be disposed of with normal household waste.

Follow your country's rules for the separate collection of electrical and electronic products and rechargeable batteries. Correct disposal helps prevent negative consequences for the environment and human health.

Removing the rechargeable battery

Only remove the rechargeable battery when you discard the product. Before you remove the battery, make sure that the product is disconnected from the wall socket and that the battery is completely empty.

Press the callus remover button until the callus remover stops working and drain the battery.

Take any necessary safety precautions when you handle tools to open the product and when you dispose of the rechargeable battery.

Disassemble the callus remover before you remove the battery, you must turn off the machine and disconnect the power. After removing the battery, never connect the callus remover to the charger, and be careful not to short-circuit the positive and negative terminals of the battery.



Remarks: The callus remover can be cleaned under the faucet.