

Fluke 381 Remote Display True-rms Clamp Meter iFlex Detachable Jaw & iFlex probe multimeter

FLUKE

FLUKE 381

Remote Display True-rms Clamp Meter



The Fluke 381 is the first clamp meter with a detachable, remote display and iFlex™ flexible current probe for easier, faster, safer measurements.

Specification:

- 1000 A AC/DC current measurement with fixed jaw
- 2500 A AC current measurement with iFlex flexible current probe
- 1000 V ac and dc voltage measurement

- True-RMS AC voltage and current for accurate measurements on non-linear signals
- Frequency measurement to 500 Hz with both jaw and iFlex
- 60 kΩ resistance measurement with continuity detection
- Min, max, average and inrush recording to capture variations automatically
- Wireless technology allows the display to be carried up to 30 ft away from the point of measurement for added flexibility without interference with measurement accuracy
- iFlex flexible current probe expands the measurement range to 2500 A ac while providing increased display flexibility, ability to measure awkward sized conductors and improved wire access
- CAT IV 600V, CAT III 1000 V safety rating
- Integrated low pass filter and state of the art signal processing allows for use in noisy electrical environments while providing stable readings
- Proprietary inrush measurement technology to filter out noise and capture motor starting current exactly as the circuit protection sees it
- Ergonomic design fits in your hand and can be used while wearing personal protective equipment
- Removable magnetic display
- Radio transmitter automatically turns off when the display is connected to the meter
- Large, easy to read, backlight display

Specifications			
Function	Range	Resolution	Accuracy
AC Current via jaw	999.9A	0.1A	2% ± 5 digits
AC current via iFlex	2500A	0.1A	3% ± 5 digits
DC current	999.9A	0.1A	2% ± 5 digits
AC Voltage	1000V	0.1V	1.5% ± 5 digits
DC Voltage	1000V	0.1V	1% ± 5 digits

Resistance	60,000 Ω	0.1 Ω	1% \pm 5 digits
Frequency	500 Hz	0.1 Hz	0.5% \pm 5 digits
True-RMS	Included		
Continuity	Included		
Hold	Included		
Backlight	Included		
Min/Max/Avg	Included		
Inrush	Included		
Wire capacity	750 MCM or 2-500 MCM		
Safety rating	CAT III 1000 V, CAT IV 600 V		
General Specifications			
Diameter of measurable conductor	1.3" or 34 mm max		
Operating temperature	-14 to 122°F (-10 to 50°C)		
Storage Temperature	-40 to 140°F (-40 to 60°C)		
Operating Humidity	< 90% @ 10 to 30 °C, < 75% @ 30 to 40°C		
Operating Altitude	0 to 2000m		
Temperature Coefficient	0.01% °C(<18°C or > 28°C)		
Size	10.905 x 3.464 x 1.629 in (277 x 88 x 43 mm)		
Weight	12 oz. (350g)		

Included accessories

- 18-inch iFlex™ flexible current probe
- Coated instruction card
- Safety information sheet
- Soft carrying case
- TL75 test leads

FLUKE



FLUKE



- 18-inch iFlex™ flexible current probe
- Coated instruction card
- Safety information sheet
- Soft carrying case
- TL75 test lead

FLUKE®







Simple operation instructions



QUALITY HAS NEVER BEEN SO SAFE
FLUKE HELPS YOU WORK EFFICIENTLY IN BAD CONDITIONS

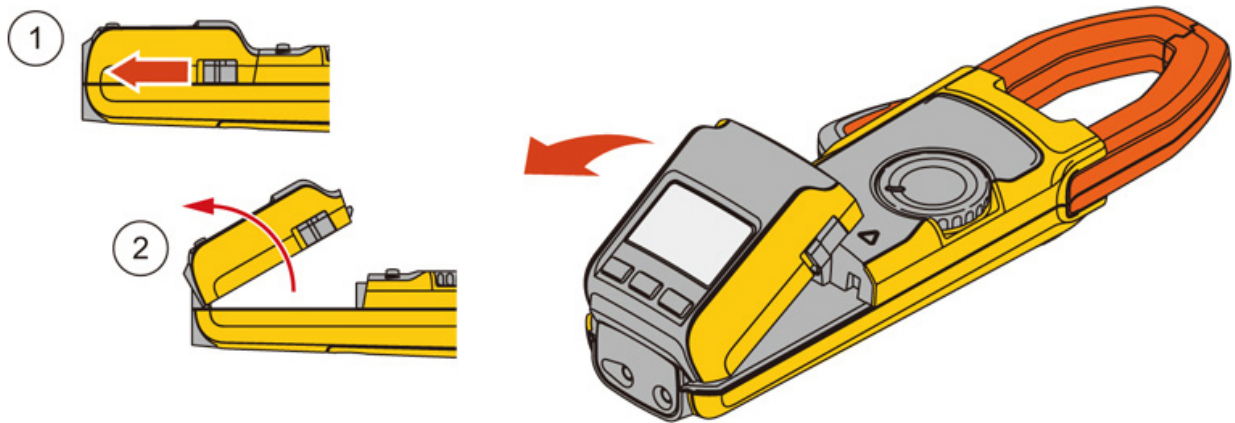

Remote display

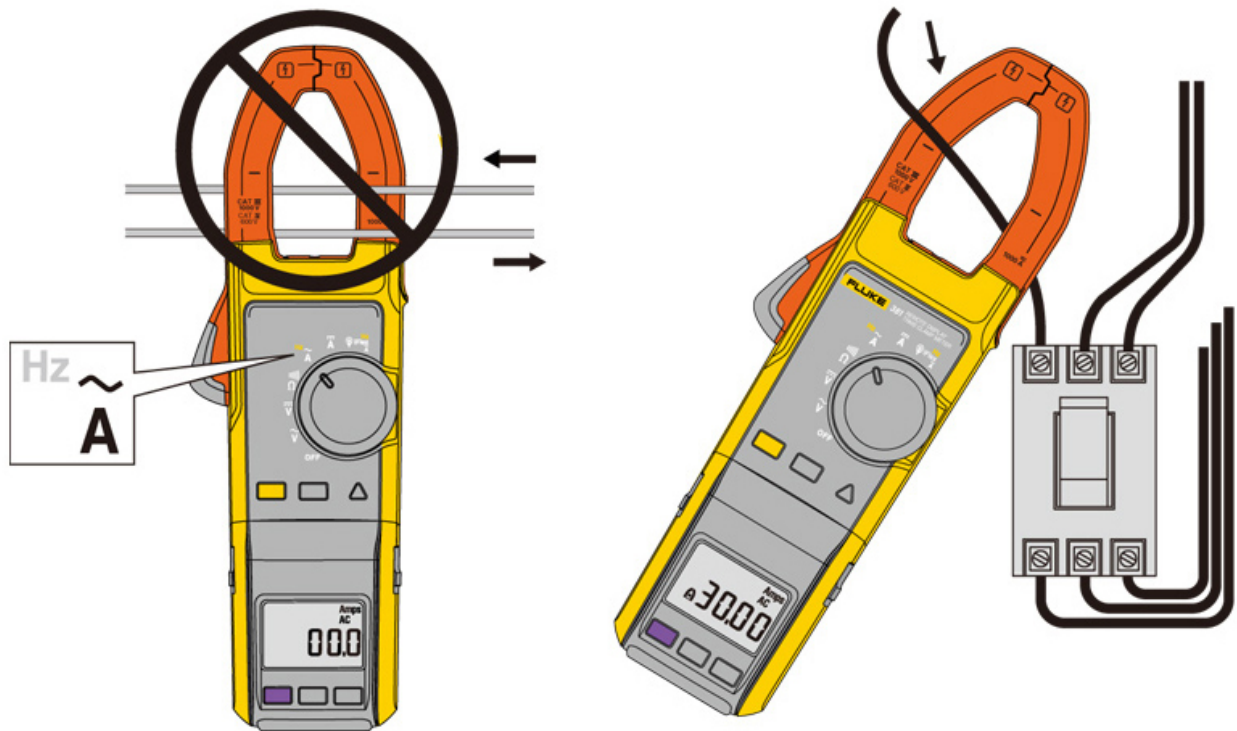

Use jaws to measure current

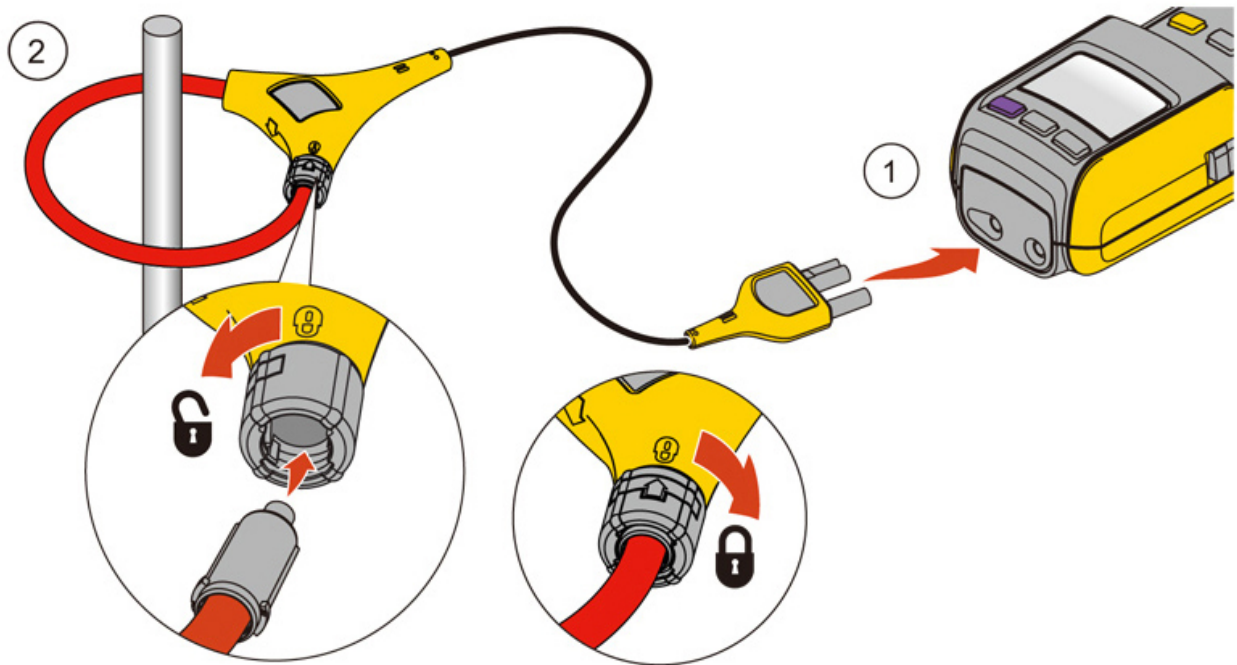

Flexible current clamp connect

Use test leads to measure (display AC voltage)

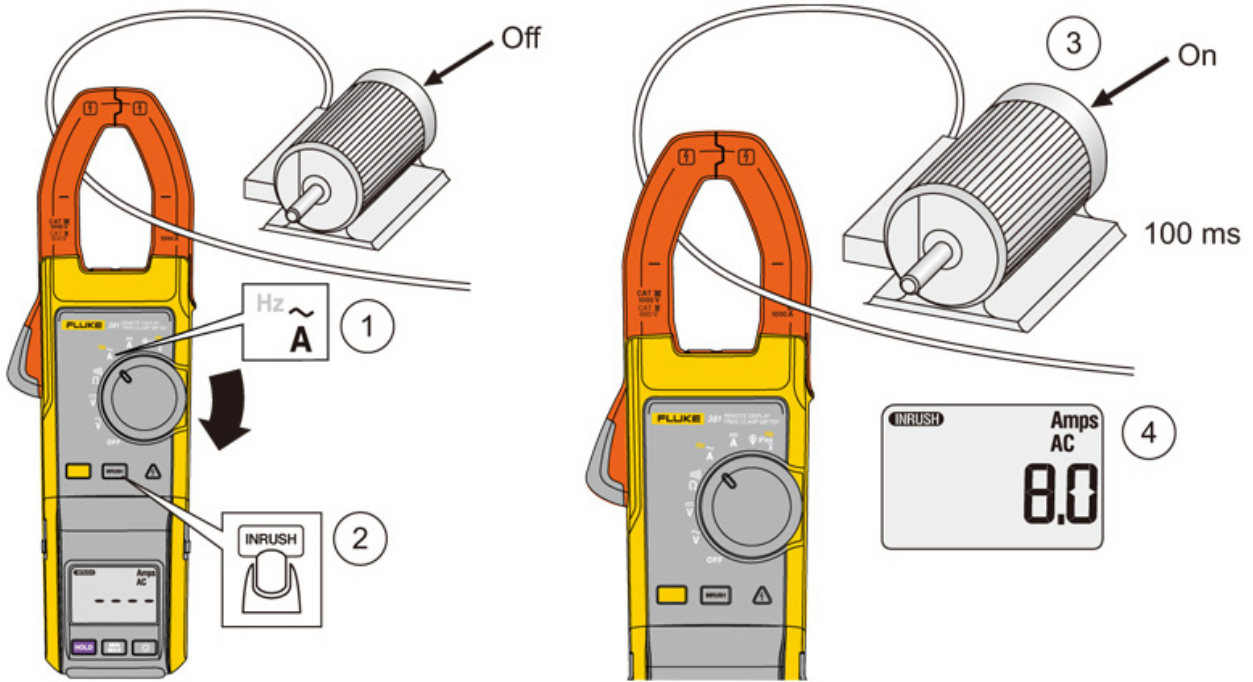

Inrush current measurement

Product accessories



QUALITY HAS NEVER BEEN SO SAFE
FLUKE HELPS YOU WORK EFFICIENTLY IN BAD CONDITIONS



Color box



F38 soft bag

18IFlexFlexible current clamp



Host machine



Battery manual



AAA battery



TL75 test lead pen



AC72 alligator clip



Probe Operating Instructions

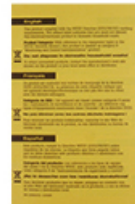
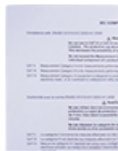

Indicates a specification statement



Registration Manual



technical manual



Warranty Card