

1PCS 12V Submersible Water Pump Bilge Pump Mini Cabin Drainage Pump Household Pumping circulation Electric Pump



The parameters параметр

Note: Please provide the pump with sufficient power supply, such as 12V5A-12V10A.

Definition of DC bilge pump:

Micro Bilge Pump (Bilge Pump) is also called micro submersible Pump, "micro DC submersible Pump", "12V micro submersible Pump" and so on. It is often referred to as a "DC bilge pump" because it is powered by DC. It is usually put in the bilge of ships such as cruise ships and fishing boats to remove the bilge water in time. Can also be used for fish tank water/water cycle/agricultural watering flowers and sprinkling water. It's usually put in water, completely or partially submerged. Usually 12V or 24V DC power supply, Marine battery and other power supply.

Note:

when working, the positive electrode of the battery is connected with the brown wire, the negative electrode is connected with the blue wire, and the customer with insufficient wire can connect 1 square wire by himself.

Model	Power	Maximum discharge	Highest lift	Voltage	Current	Outlet diameter	Electric wire
BL-2512S	0.07HP	4.2 m ³ /h 70L/MIN	5m	12V	5.4A	25mm	1.5m

NOTE

1. Don't run dry.



2. Don't dip the end of the wire in the water.



3. Be careful for the power voltage. BL-2524S is for DC-24V, BL-2512S is for DC-12V. Don't mistake voltage, also connect white wire to +(plus), black wire to -(minus). In case connecting another wire, use over 0.75mm².



4. Don't pull the wire. Don't handle roughly, Don't drop the pump.

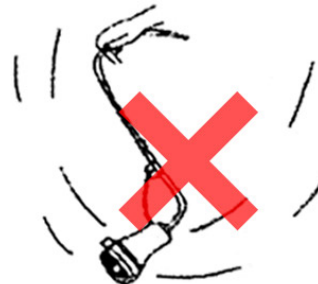

5. In case using the pump in discharging of Bilge water, the end of the delivery hose should be up of the water surface. Otherwise, by syphoning, the water will flow back into the bottom of the boat.

The end should not be in the water

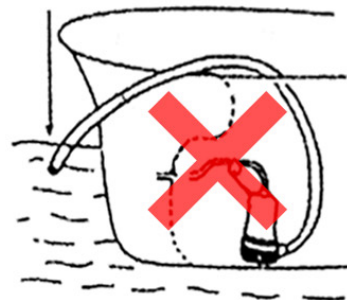

6. Can use in a little oil mixed water, but Don't use in gasoline, kerosene, machine oil and solvents.

7. Dust clogging in strainer is very often seen, this cause delivery volume decreasing. Please check the strainer occasionally.

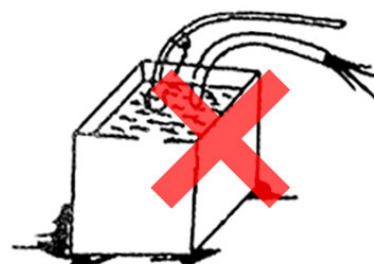

Gasoline kerosene oil solvent

NOTE

1. Don't run dry.



2. Don't dip the end of the wire in the water.



3. Be careful for the power voltage. BL-2524S is for DC-24V, BL-2512S is for DC-12V. Don't mistake voltage, also connect white wire to +(plus), black wire to -(minus). In case connecting another wire, use over 0.75mm².



4. Don't pull the wire. Don't handle roughly, Don't drop the pump.

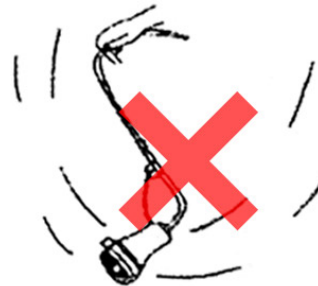

5. In case using the pump in discharging of Bilge water, the end of the delivery hose should be up of the water surface. Otherwise, by syphoning, the water will flow back into the bottom of the boat.

The end should not be in the water

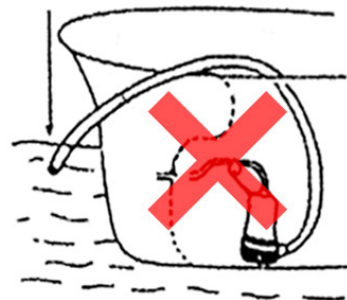

6. Can use in a little oil mixed water, but Don't use in gasoline, kerosene, machine oil and solvents.

7. Dust clogging in strainer is very often seen, this cause delivery volume decreasing. Please check the strainer occasionally.

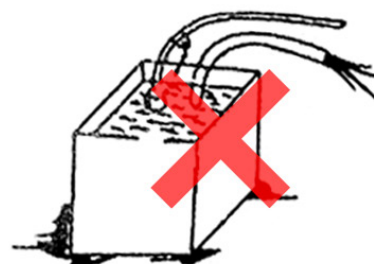

Gasoline kerosene oil solvent

CHARACTERISTICS

1. Large delivery volume, high delivery pressure, aimed the maximum of this class!
2. Continuous running in the water all right! Unique motor cooling system enables continuous running.
3. Double mechanical seal system equipped guarantees the complete shaft sealing.
4. Using 304 Stainless, saltwater-proof aluminum alloy, anti-shock PBT plastics assure long durability, perfect against saltwater corrosion.
5. Small size, light, compact easy to handle.
6. Strainer can be quickly removed without tool, makes east to clean inside.
7. Wire and pump-connection part is strengthen by chain, this protects the grand part and prevents water leakage into motor room.

CONSTRUCTION

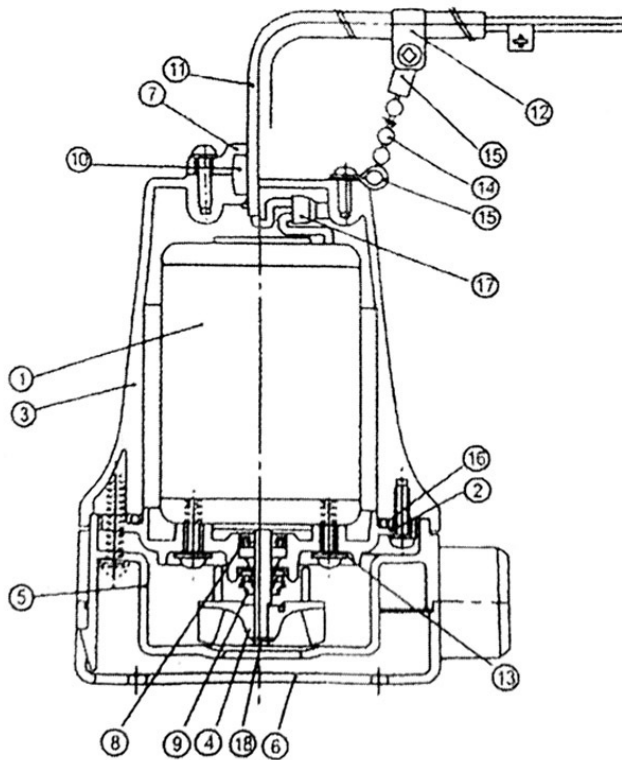

NO.	NAME	QTY
1	Motor	1
2	Motor Flange	1
3	Motor Housing	1
4	Impeller	1
5	Impeller Casing	1
6	Strainer	1
7	Gland	1
8	Oil Seal	1
9	Mechanical Seal	1
10	Wire Rubber	1
11	Wire	1
12	Wire band	1
13	Rubber Washer	2
14	Chain	1
15	Chain Stopper	2
16	O Ring	1
17	Press Terminal	2
18	Stop Ring	1

TROUBLE & REMEDY

Trouble	Causing	Remedy
Pump does not revolve	Imcorrection of wire connection Sticking of impeller Disconnection of wire	Connect securely Disassemble & clean Exchange the wire
Pumping volume is small	Miss connection of +&- Clogging of foreign substance in impeller Clogging in strainer Water leak from delivery hose Too thin or too long delivery hose Voltage down of power source Weak power source Wear of impeller Delivery head is too high	Connect correctly Disassemble & Clean Take off the strainer & clean Stop leak Thicken or shorten the hose Charge battery Exchange battery Replace impeller Make low the head
Electricity leaks	The end of the wire is dipping in the water Wire connecting part is dipping in the water Looseness of screws in gland part Break down of the mechanical seal	Pull up the wire Pull up the part Tighten the screw Change mechanical seal

How to take off the strainer cover:

You can easily find 2 hooks around the strainer cover. Push these hooks inside. then, strainer can remove by sliding.



WIRING DIAGRAM

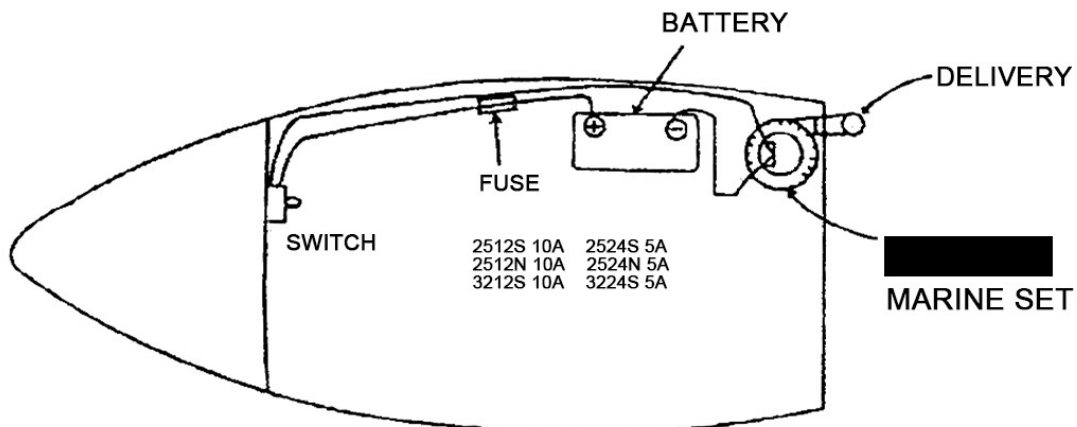

SPECIFICATION

Model	BL2524S	BL2512S	BL2524N	BL2512N	BL3224S	BL3212S
Outlet dia	25 ^{mm} / _m (1")		25 ^{mm} / _m (1")		32 ^{mm} / _m (1.2")	
Delivery Volume	70ℓ/min.18.5U.S .G/min		70ℓ/min.18.5U.S .G/min		100ℓ/min	
Delivery head	4m		6m		4m	
Water temp	0~ 60°C		0~ 60°C		0~ 60°C	
Power	DC-24V	DC-12V	DC-24V	DC-12V	DC-24V	DC-12V
Current	2.5A	5.4A	3.8A	7.8A	3.8A	7.8A
Rating	continuous		continuous		continuous	
Motor power	45W/5400rpm		60W/6800rpm		60W/6800rpm	
Weight	1kg		1kg		1kg	
Standard Accessory	Elbow 1		Elbow 1		Elbow 1	

PERFORMANCE CURVE

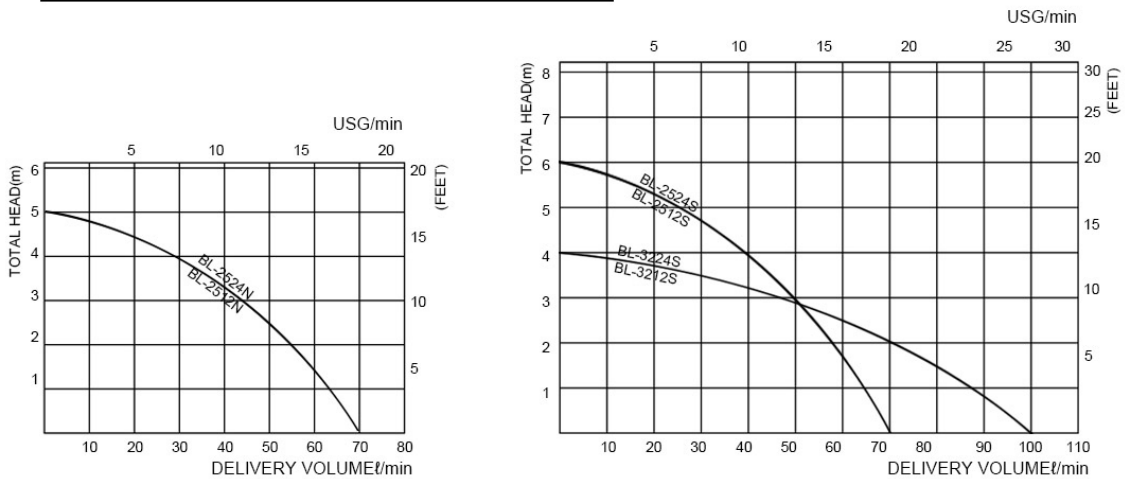

DIMENSION

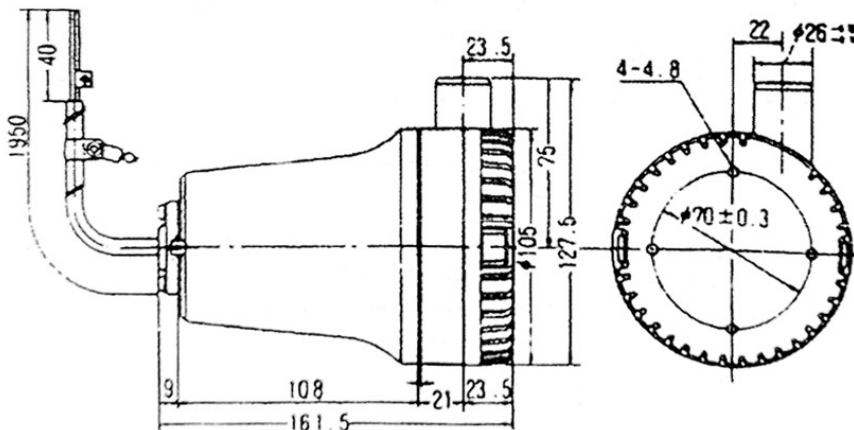

APPLICATION

- 1.Pumping out water from ice
- 2.Pumping fresh water in preserve
- 3.Discharging of Bilge water
- 4.Emergency pumping on the boat
- 5.Washing on the deck

INSTALLATION

Install the pump body (Strainer cover) on the desired locations.
Use 4-M4×12 screws to fix the body.

- 6. Water exchanging in fish farm
- 7. For camping use



 **The Description** описание

