



Hearing Aid



Hearing Aid



Charge Case



6 Sets of ear tips

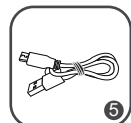

USB Cable



Cleaning tool

TURN ON/OFF

Turn ON: Take the hearing aid out of the charging case, it will enter the standby status. The hearing aid will turn on automatically in 3 seconds when you wear the hearing aid correctly in the ears.

Turn OFF: Place back to charger case to turn off.

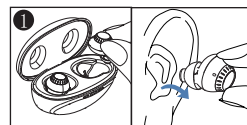

Turn on

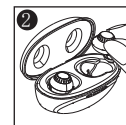

Turn off

LEFT & RIGHT HEARING AID MARKINGS

There is a L or R marking on the hearing aid. This will tell you if it is a left or a right hearing aid.



L marking for left hearing aid.

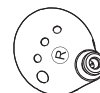

R marking for right hearing aid.

Thank you for your order!
If you need to extend the warranty period for six months. You can log in to our website and click on 'Registration' Regardless of any questions, please feel free to email me.

Web: leelpro.com
Email: support@leelpro.com

VOLUME ADJUSTMENT

UP : To increase the volume, turn the volume control towards the "+" direction (forwards).

Down: To decrease the volume, turn the volume control towards the "-" direction (backwards).

* Volume was preset to minimum to avoid whistle from factory.

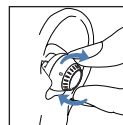
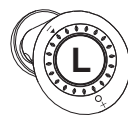

Model: JH-A51

For more details , please review the enclosed User Manual in its entirety.

VER: LEEL-A51-20210809-V01



Art. No.: JH-A610
**QUICK OPERATION
GUIDE**