

Rectal Digital Thermometer

User Manual

EMT-027

Warning :

- ⚠ Read instructions thoroughly before using the digital thermometer.
- ⚠ Choking Hazard: The thermometer cap and battery may be fatal if swallowed. Do not allow children to use this device without parental supervision.
- ⚠ Do not use the thermometer in ear. Designed use is for rectal readings only.
- ⚠ Do not place the thermometer battery near extreme heat as it may explode.
- ⚠ Note: Use of the probe cover may result in a 0.2°F (0.1°C) discrepancy from actual temperature.
- ⚠ Remove battery from the device when not in operation for a long time.
- ⚠ The use of temperature readings for self-diagnosis is dangerous. Consult your doctor for the interpretation of results. Self-diagnosis may lead to the worsening of existing disease conditions.
- ⚠ Do not attempt measurements when the thermometer is wet as it may cause inaccurate readings.
- ⚠ Do not bite the thermometer. Doing so may lead to breakage and/or injury.
- ⚠ Do not attempt to disassemble or repair the thermometer. Doing so may result in inaccurate readings.
- ⚠ Before and after each use, disinfect the thermometer especially in case the device is used by more than one person.
- ⚠ Do not force the thermometer into the rectum. Stop insertion and abort the measurement when pain is present. Failure to do so may lead to injury.
- ⚠ If the device has been stored at temperatures over 41°F ~ 104°F (5°C ~ 40°C), leave it in 41°F ~ 104°F (5°C ~ 40°C) ambient temperature for about 15 minutes before using it.

PLEASE READ CAREFULLY BEFORE USING

This digital thermometer provides a quick and highly accurate reading of an individual's body temperature. The digital thermometer is intended to measure the human body's temperature rectally,

and the device is reusable for clinical or home use on babies, young children, or when it is difficult to take an oral or underarm temperature. To better understand its functions and to provide dependable results, please read all instructions first. This appliance conforms to the following standards:
ISO 80601-2-56 Medical electrical equipment —Part 2-56:Particular requirements for basic safety and essential performance of clinical thermometers for body temperature measurement, EN 60601-1-11 Medical electrical equipment —Part 1-11: General requirements for basic safety and essential performance – Collateral Standard: Requirements for medical electrical equipment and medical electrical systems used in the home healthcare environment and complies with the requirements of EN 60601-1-2(EMC), IEC/EN60601-1(Safety) standards. And the manufacturer is ISO 13485 certified.
ASTM E1112 Standard Specification for Electronic Thermometer for Intermittent Determination of Patient Temperature.

CONTENTS

1 Thermometer, 1 User Manual, 1 Storage Case

PRODUCT ILLUSTRATION

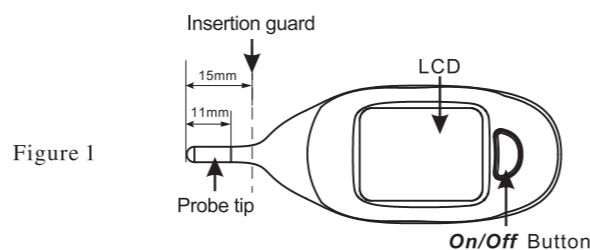

Figure 1

PRECAUTION



- * The performance of the device may be compromised should one or more of the following occur:
 - Operation outside the manufacturer's stated temperature and humidity range.
 - Storage outside the manufacturer's stated temperature and humidity range.
 - Mechanical shock (for example, drop test) or damaged sensor.
 - Patient temperature is below ambient temperature.
- * Portable and mobile RF communications can affect the device. The device needs special precautions regarding EMC according to the EMC information provided.

EXPLANATION OF SYMBOLS

- LOT Symbol for batch code
- Symbol for date of Manufacture

- Symbol for Disposal of this product and used batteries should be carried out in accordance with the national regulations for the disposal of electronic products.
- Symbol for "TYPE BF APPLIED PART"
- Symbol for "Follow operating instructions"
- Symbol for Direct Current
- Symbol for Storage and Transportation Temperature Limit: -4°F ~ 131°F (-20°C ~ 55°C)
- Symbol for Storage and Transportation Humidity Limit: 15%~95%
- Symbol for Atmospheric pressure condition: 70kPa~106kPa
- Symbol for Caution

SPECIFICATIONS

Type:	Digital Thermometer (Not Predictive)
Measure Range:	89.6°F - 109.2°F (32.0°C - 42.9°C (°C / °F switchable))
Accuracy:	+0.2°F (+0.1°C) during 95.9°F ~ 107.6°F (35.5°C ~ 42.0°C) at 64.4°F ~ 82.4°F (18°C ~ 28°C) ambient operating range; +0.4°F (+0.2°C) for other measuring and ambient operating range
Operating mode:	Direct Mode
Display:	Liquid crystal display, 3 1/2digits, with backlight
Test time:	10~15 seconds
Memory:	Last 10 memories
Battery:	One 3.0V DC button battery type CR2032
Battery life:	Approx. 200 hours of continuous operation or 1 year with 3 measurements per day
Dimension:	3.66in × 1.36in × 0.71in (9.3cm × 3.45cm × 1.8cm) (L × W × H)
Weight:	Approx. 0.917oz (26 grams) including battery
Expected service life:	Approx. 3 yrs
Ambient operating range:	Temperature: 41°F ~ 104°F (5°C ~ 40°C) Relative humidity: 15%~95%RH
Storage and transportation condition:	Temperature: -4°F ~ 131°F (-20°C ~ 55°C) Relative humidity: 15%~95%RH
Ingress Protection Rating:	IP 27
Classification:	Type BF

FEVERLINE™ INDICATING TECHNOLOGY

This digital thermometer is equipped with Feverline Indicating Technology to instantly and easily identify when a fever is present. At the completion of each measurement, the triangular arrow on the display will indicate whether the user has no fever, a slight fever, or a high fever.

Temperature	Result	Color of Feverline
T < 97.9°F (< 36.6°C)	Low Temperature	No Indication
97.9°F - 100.4°F (36.6°C - 38°C)	Normal	Green
T > 100.4°F (T > 38.0°C)	Low-grade Fever	Yellow
T > 102.0°F (T > 38.9°C)	High Fever	Red

°C / °F SWITCHABLE

Temperature readings are available in Celsius or Fahrenheit (°C / °F); located in the upper right corner of LCD. With the thermometer off, press and hold the On/Off Button for approximately 3 seconds to change the temperature display unit. The backlight display will light up with a beep. Then the display will show the current metric °C or °F, followed by the last temperature or ---°C or ---°F (if no reading is stored in memory). After this, the thermometer will be in the testing mode.

INSTRUCTIONS

- Press the On/Off Button to turn on the device. The display will show with backlight and beep tone, followed by last temperature or ---°C / ---°F (if no reading is stored in memory). The thermometer is now in testing mode.

*Note: If the ambient temperature is less than 89.6°F / 32.0°C, the LCD will display ---°C / ---°F, if the ambient temperature is higher than 109.2°F / 42.9°C, the LCD will display Hi.

- Lubricate the metal probe tip with water-soluble jelly for easier insertion. Read the label of the lubricant to be sure you are using the right kind.
- The proper position for a baby is to lay on its stomach with legs hanging down, either across your knees or at the edge of a bed or changing table. This positions the infant's rectum for safe and easy insertion of the thermometer.
- Gently insert the probe tip approximately 1.3cm (about 1/2") into the rectum. The guard above the tip (see figure 1) is designed to prevent over-insertion. If you detect resistance, stop. Hold the thermometer in place during measurement.

*What is "Normal" temperature?

Although the generally accepted "normal" temperature reading is 98.6°F/37°C, a temperature, taken rectally, ranging between 97.9°F-100.4°F (36.6°C-38°C) is also considered normal. The best method to determine your baby's normal temperature is to use the thermometer when he or she is feeling well. Record the temperature twice a day (early morning and late afternoon). The average of the two temperatures is considered your baby's normal body temperature. Any variation from it may indicate some sort of illness and you should consult your pediatrician.

- It takes about 10~15 seconds to finish the measurement, which will be indicated by "Bi-Bi-Bi-Bi" buzz then the backlit light will light up and the measurement will show on the screen. Do not stop the measuring until the buzz sound is finished.

*Note: Normally the buzzes are "Bi-Bi-Bi- Bi-"; Alarm beeps more rapidly when temperature reaches 100.5°F (38.1°C) or higher, and the buzzes are "Bi-Bi-Bi--- Bi-Bi-Bi----- Bi-Bi-Bi"

*Reminder: Clean and disinfect the thermometer as recommended before placing it back in the storage case. See Cleaning and Disinfection instructions.

- After the test is complete (once the beeping stops), keep the thermometer powered on; hold the On/Off button for 3 seconds, the display will show "IM" entering into memory mode.
- To prolong battery life, press the On/Off Button to turn unit off after testing is complete. If no action is taken, the unit will automatically shut off after around 5 minutes.



Call your child's doctor right away if your child has a fever and:
Is younger than 3 months (12 weeks) and has a temperature of 100.4°F (38.0°C) or higher.
If, at any age, the fever rises above 102°F (38.9°C) repeatedly.

BATTERY REPLACEMENT

- Replace battery when " " appears in the lower right corner of LCD display.
- Put a thin board such as a coin on fillister of cover. Turn the battery anti-clockwise until the cover is off. (See Figure 2)
- Use a non-metal instrument such as a pen to remove old battery from the battery holder (See Figure 3). Discard battery according to local law.
- Place a new 3.0V DC button battery type CR2032 into the chamber with positive side facing up. (See Figure 4).
- Put back the cover, turning cover clockwise until the " " facing towards " ". (See Figure 5)

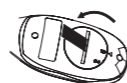

Figure 2



Figure 3



Figure 4



Figure 5

CALIBRATION

The thermometer is initially calibrated at the time of manufacture. If the thermometer is used according to the use instruction, periodic readjustment is not required.

CLEANING AND DISINFECTION

Wipe the thermometer with a cloth that has been dampened with water or a neutral detergent solution and then wipe it thoroughly. For disinfection, rubbing alcohol (70% isopropyl alcohol) can be used. Finish by wiping with a soft dry cloth.

Observe the following to prevent damage to the thermometer.

- Do not use benzene, thinner, gasoline or other strong solvents to clean the thermometer.
- Do not attempt to disinfect the sensing section (tip) of the thermometer by immersing in alcohol or in hot water (water over 122°F (50°C)).
- Do not use ultrasonic washing to clean the thermometer.

LIMITED WARRANTY

The thermometer is guaranteed for one year from the date of purchase. If the thermometer does not function properly due to defective components or poor workmanship, we will repair or replace it free of charge. All components are covered by this warranty excluding the battery. The warranty does not cover damages to your thermometer due to improper handling. To obtain warranty service, an original or copy of the sales receipt from the original retailer is required.

FCC INFORMATION

Caution: Changes or modifications to the device not expressly approved by the party responsible for compliance could void the user authority to operate the equipment.

*Note:

This equipment has been tested and found to comply with the limits for a Class B digital device, pursuant to Part 15 of the FCC Rules. These limits are designed to provide reasonable protection against harmful interference in a residential installation. This equipment generates, uses, and can radiate radio frequency energy. If this equipment does cause harmful interference to radio or television reception, which can be determined by turning the equipment off and on, the user is encouraged to try and correct the interference by one or more of the following measures:

- Reorient or relocate the receiving antenna.
- Increase the distance between the equipment and the receiver.
- Consult the dealer or an experienced radio/TV technician for help.

Healthcare-Manager.com
Questions or comments?
Please call toll-free
1-855-822-6999 M-F 9 a.m.- 5 p.m. CST
E-mail: service@healthcare-manager.com
Easy Healthcare Corporation
360 Shore Dr. Burr Ridge, IL USA 60527
Made in China