

70mm

100mm

NPET

RGB Desktop Speakers User Manual

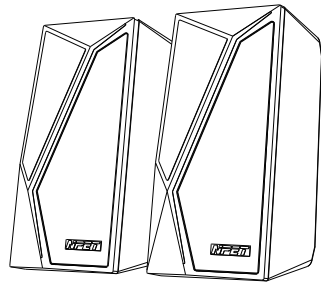

CS50

Packages

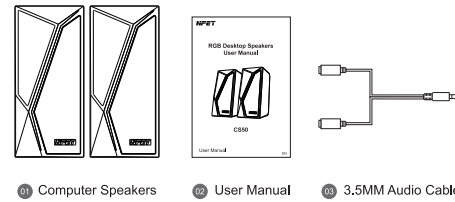

- ① Computer Speakers ② User Manual ③ 3.5MM Audio Cable

Technical Specification

Parameter		Parameter	
Output power(RMS)	6W(3W*2)	Input impedance	10K Ω
Frequency response	160Hz—20KHz	Input sensibility	700mv±50
Speaker diameter	50mm	Separation	≥85db
Power supply	5V=1A	Signal	≥45db
Dimensions	8.5*10*18cm	Weight	750g

1

Speakers Diagram

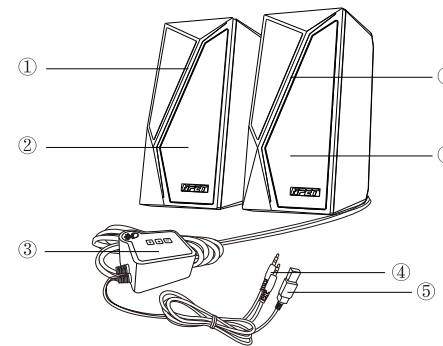

- ① RGB backlit zone
② 50mm driver
③ Speaker controller
④ Bisected 3.5mm audio cable
⑤ USB cable (only for power supply)
Note: Be sure to connect USB to use the speaker

2

Speakers Control Diagram

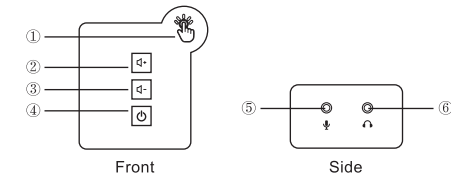

- ① Touch-control (6 RGB Backlight Modes)
② Volume up :
Short press volume up button: Stepped to increase the volume.
Long press volume up button: Keep increasing the volume.
③ Volume down :
Short press volume up button: Stepped to decrease the volume.
Long press volume up button: Keep decreasing the volume.
④ ON/OFF button :
Short press: turn on/off RGB backlit.
Long press: turn off the speakers.
⑤ Microphone connector
⑥ 3.5mm audio connector

3

Compatible Device

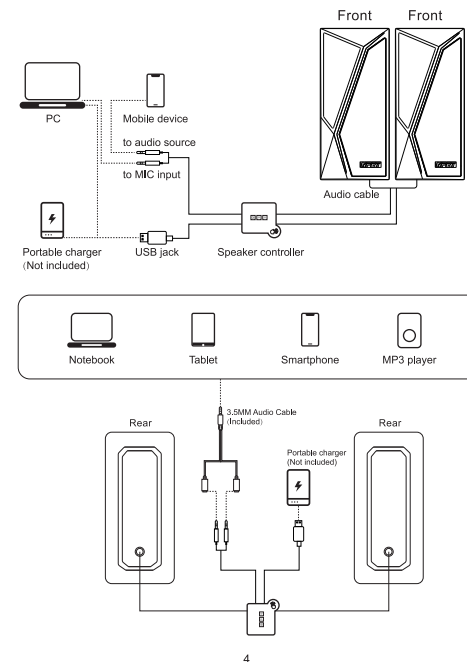

4

Setting The Default Playback Device

If you are using the NPET CS50 RGB Speakers for the first time, you may be required to set up the device as your system's default playback device.

For Windows Users

Step 1: Open your Sound settings from Control Panel > Hardware and Sound > Manage audio devices. You can also right-click your sound icon on the system tray and select Playback devices.

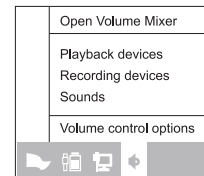

Step 2: In the Playback tab, select from the list and click the Set Default button.

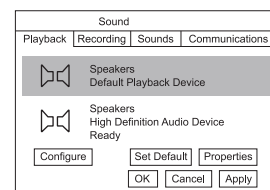

5

For MAC Users

Step 1: Open your Sound settings from System Preferences > Sound.

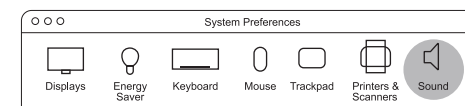

Step 2: In the Output tab, select from the list.

Name	Type
Headphones	Built-in Output
Line Out	Built-in Line Output
Default Playback Device	USB

Speaker Operation

1. Turn the ON/OFF button on by the speaker controller. The RGB will light up.
2. Short press or long-press the volume up button to increase the volume level. (The default volume of speakers is 40%)
3. Long press(2 seconds) the ON/OFF button to turn off the speakers. The RGB light goes off.

6

NOTICE

The volume can also be controlled via your computer volume settings. If the product does not play audio, ensure the audio output of your computer is not muted. The speaker has a memory function. The defaults of volume and RGB mode, depending on your last set.

Cleaning and Maintenance

- To clean, wipe with a soft, slightly moist cloth.
- Dry the product after cleaning.
- Never use corrosive detergents, wire brushes, abrasive scourers, metal, or sharp utensils to clean the product.

Troubleshooting

1. Check if the USB cable is connected to a USB port. Connect the speaker to a USB port using the USB cable. The USB cable is only for the power supply.
2. Check if the connected audio device is playing audio and press the volume up button to increase the volume level of the computer.
3. Make sure the audio cable is connected to the audio-in port on your audio device.
4. Reseat the audio cable and try again. Reseat the line-in cable and try again.
5. Check that the computer or audio device is not in sleep mode.
6. Restart the computer or Laptop and play music again.
7. Make sure the audio cable is connected firmly to your computer.
8. Test the speaker using another audio source, for example, a portable music player.
9. Clean and reseat all the cables. Make sure no loose objects are touching the speaker.

7