

LAMPAOUS[®] BarSmart[™]

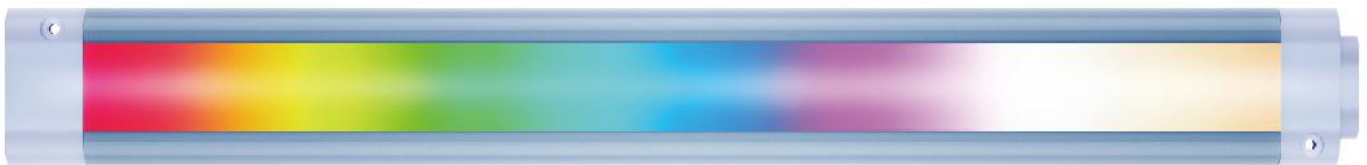

User Manual

Light What You Need



Index

I. Installation	1
II. Setting	3
III. Operation	12
IV . FAQ	20
V. Service	21

LAMPAOUS[®] BarSmart[™]

Model No	Luminous Flux	Wattage	Voltage
LPS-BS-9 (1*9")	270lm	3W	100-240VAC
LPS-BS-12 (1*12")	360lm	4W	100-240VAC
LPS-BS-18 (1*18")	720lm	8W	100-240VAC
LPS-BS-24 (1*24")	1080lm	12W	100-240VAC
LPS-BS-36 (3*12")	1080lm	12W	100-240VAC
LPS-BS-72 (6*12")	2160lm	24W	100-240VAC

I. Installation

1.1 Accessories

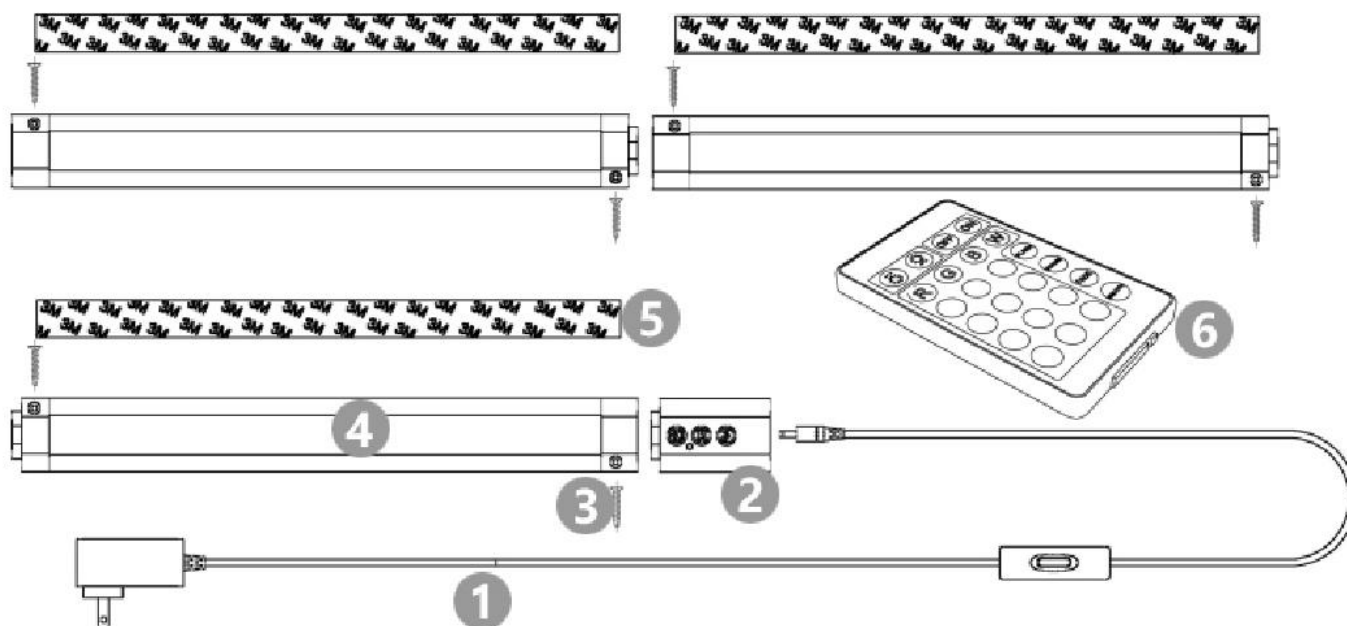

Accessories	LPS-BS-9	LPS-BS-12	LPS-BS-18	LPS-BS-24	LPS-BS-36	LPS-BS-72
1.Transformers	1	1	1	1	1	1
2.Control Box	1	1	1	1	1	1
3.Screw	2	2	2	2	6	12
4.Lights bar	1*9"	1*12"	1*18"	1*24"	3*12"	6*12"
5.Adhesive Tape	1	1	1	2	3	6
6.R. F Remote Control	1	1	1	1	1	1

1.2 Mounting

1.2.1 Mounting by Screw

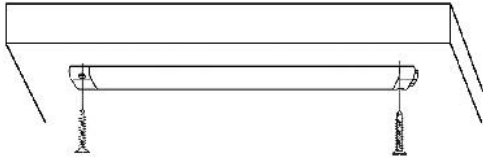

1.2.2 Mounting by adhesive tape

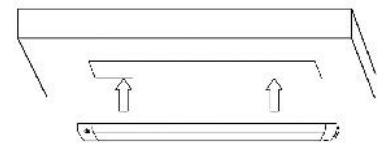
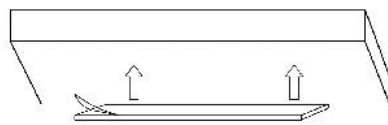
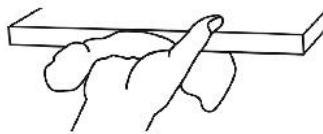

1.3 Connection

1.3.1 Direct connection

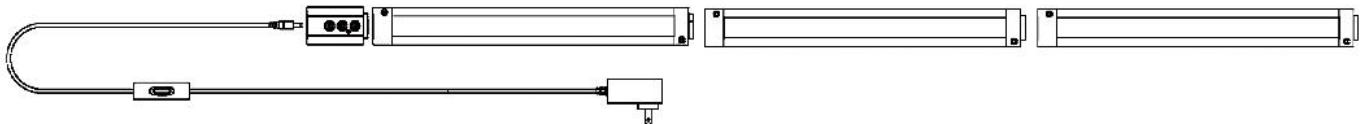
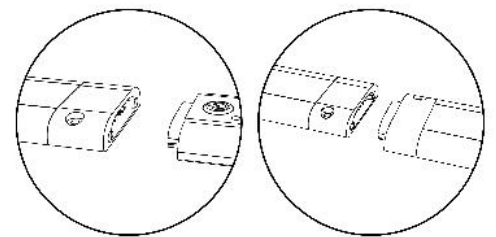

1.3.2 Link by Extension Cord

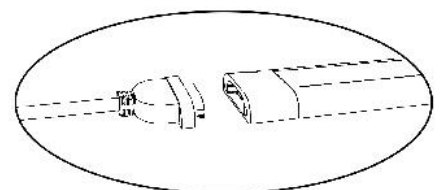
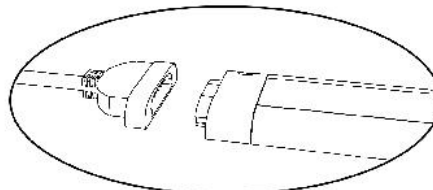
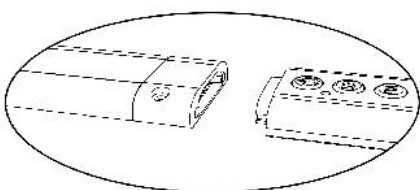
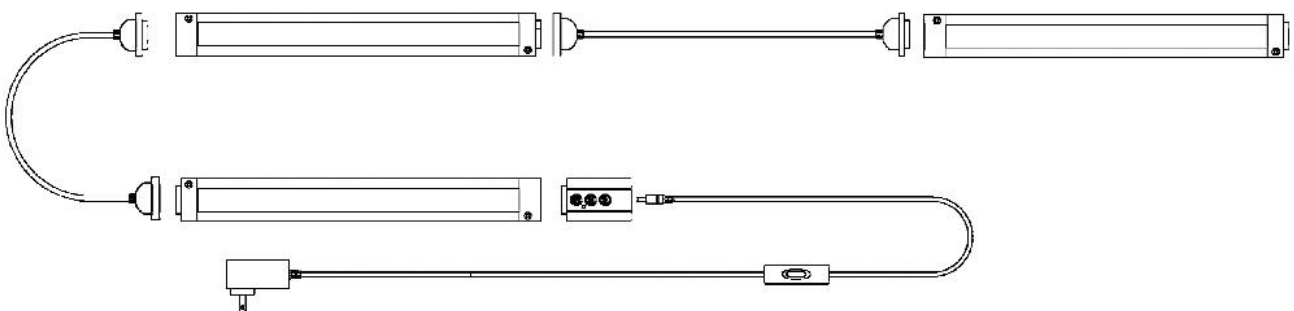

Note: The extension cord is not included ,you need to purchase it from the seller separately .

II. Setting

2.1 Download Smart Life App

To download the App, to search "SmartLife" in any app store or scan the QR code below.



amazon alexa

 **Smart life**

 **Google Assistant**

2.2 Registration/Login

If you do not have an app account, you may choose to register or log in by text message authentication. The registration process is described on this page and the next.

1. Click "Create account" to go to the Smart Living privacy policy page. Click Agree to proceed to the mobile phone number registration page.

2. The system will identify automatically the country/region you are in, or you may choose to select manually a country/region. Enter your mobile phone number or email and click "Next", as shown in Fig. 2

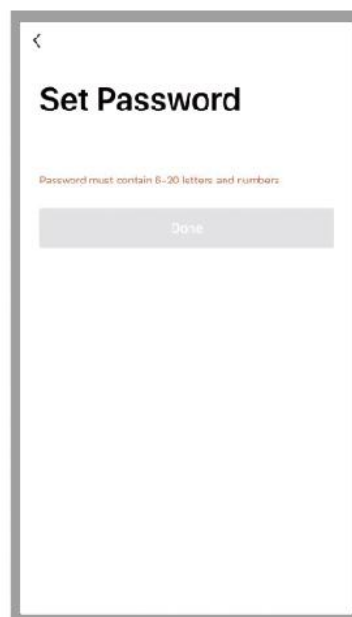
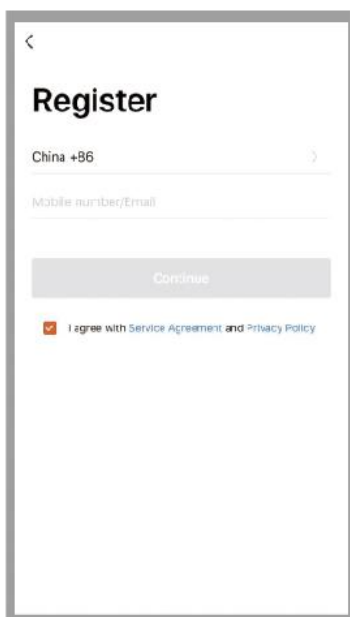

Fig 1



Fig 2

3. Enter the authentication code you received. Then enter the password and click "OK" to complete registration.



2.3 Quick Link by Blue Tooth + Wi-Fi Mode

Step 1 Please allow your smart phone to use Blue Tooth and Wi-Fi, otherwise the smart phone can't discover the light devices.(Fig 1)

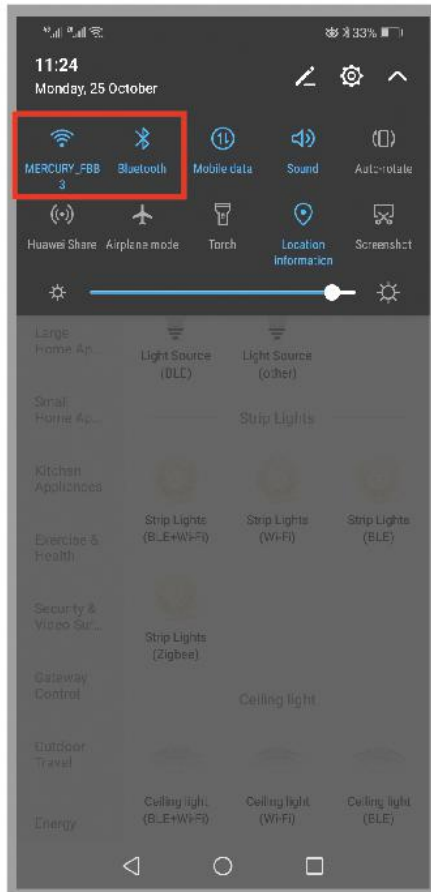

Fig 1

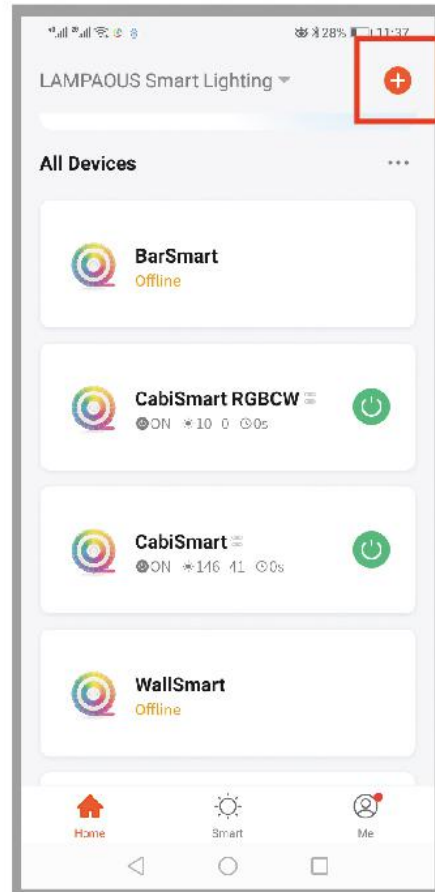

Fig 2

Step 2 App Path: Add devices or click the small “+” icon on the top right corner.(Fig 2)

Step 3 Press the EZ or AP button on the control box and wait for several seconds until the white lights blinking. If your BarSmart lights is blinking when you turn on the power please ignore this step.(Fig 3)

Step 4 Go to Add BarSmart.(Fig 4)

Step 5 Enter your Wi-Fi Code.(Fig 5)

Step 6 Added Successfully.(Fig 6 \ Fig 7)

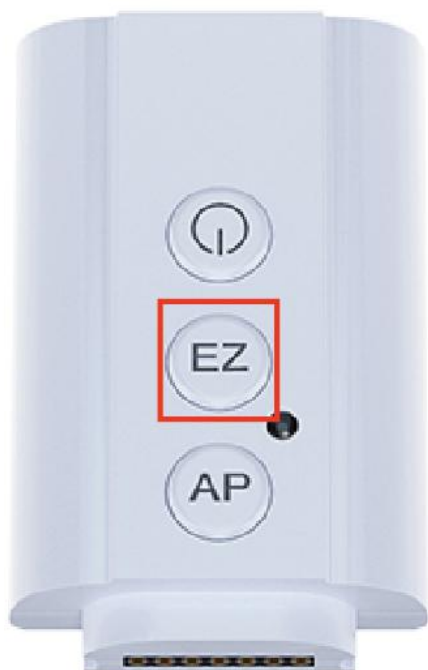

Fig 3

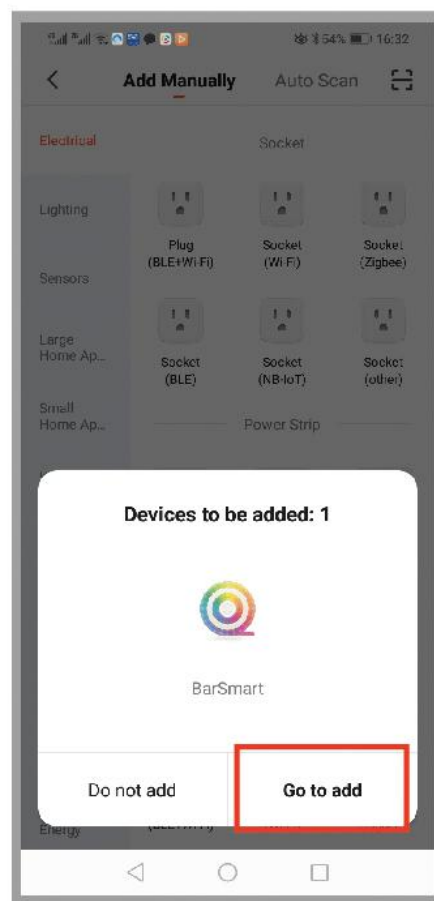

Fig 4

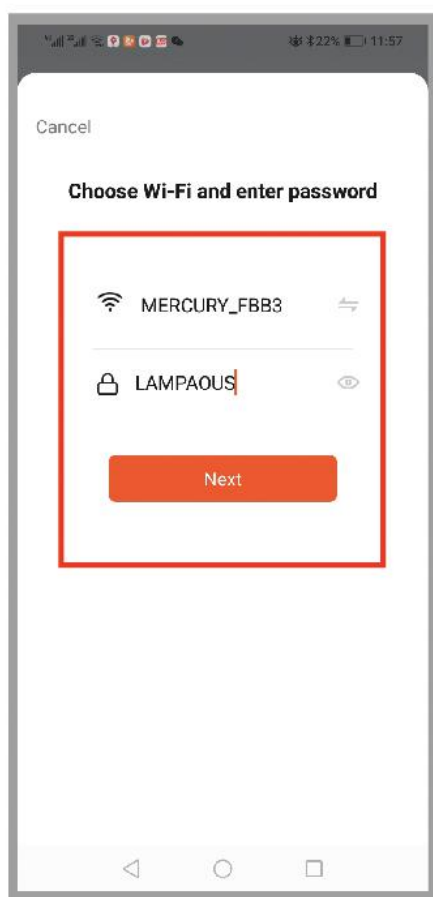

Fig 5

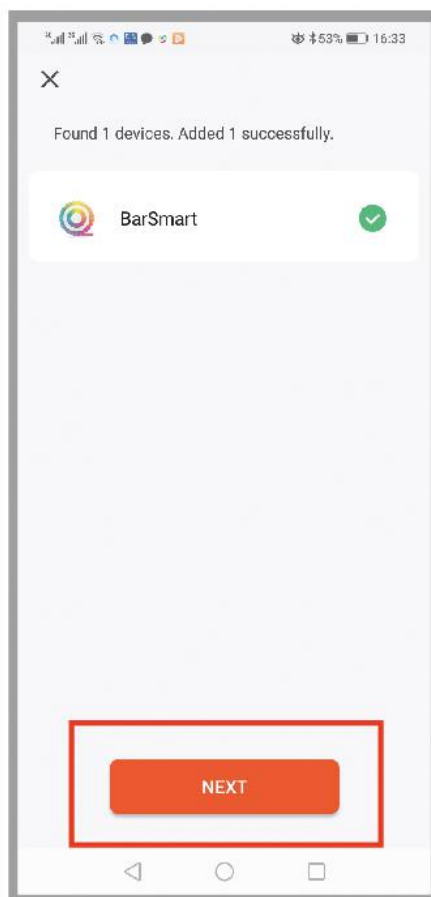

Fig 6



Fig 7

2.4 Link by EZ Mode

Please allow your Wi-Fi Permission and close Bluetooth permission of your smart phone.

Step 1 App Path: Home_Add Devices_Add Manually_Lighting_Lighting-Source(Wi-Fi) (Figure 1, Figure 2)

Step 2 Enter your Wi-Fi Code (Figure 3)

Step 3 Select EZ Mode on the top right corner(Figure 4)

Step 4 Press EZ button on the control box or Turn on-off-on-off-on of the power switch(Figure 5)

If your BarSmart is blinking when you turn on it please ignore this step.

Step 5 Confirm the lights is blinking rapidly. (Figure 6)

Step 6 Add Devices(Figure 7)

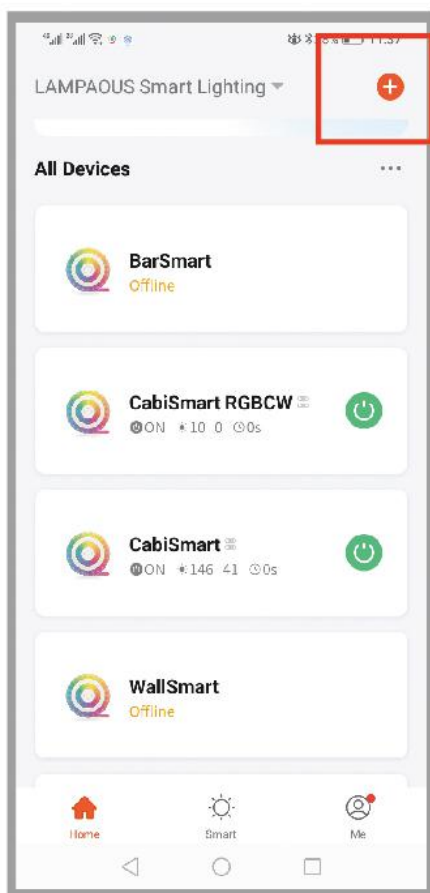

Figure 1



Figure 2



Figure 3

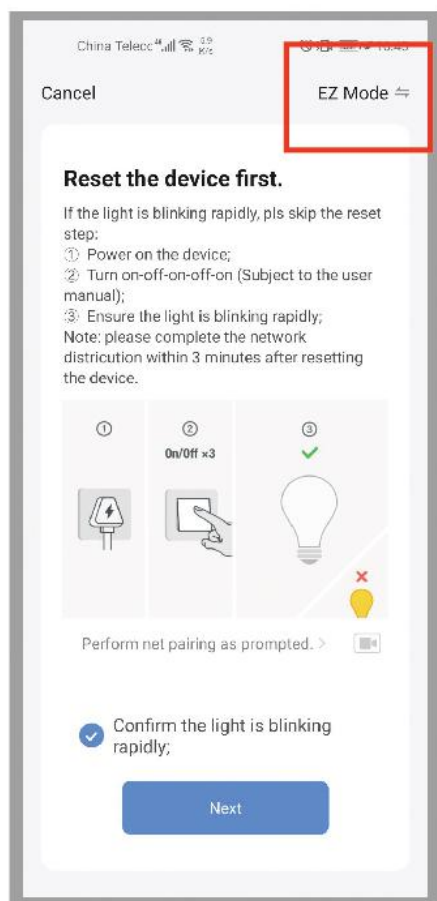

Figure 4



Figure 5

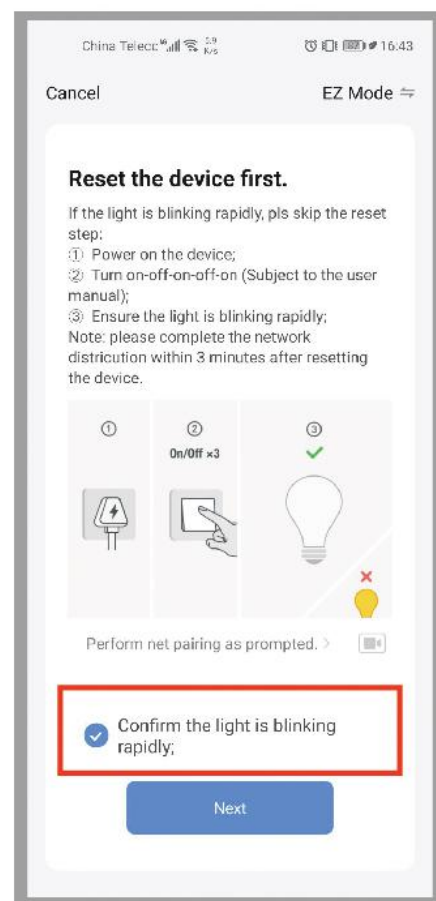

Figure 6

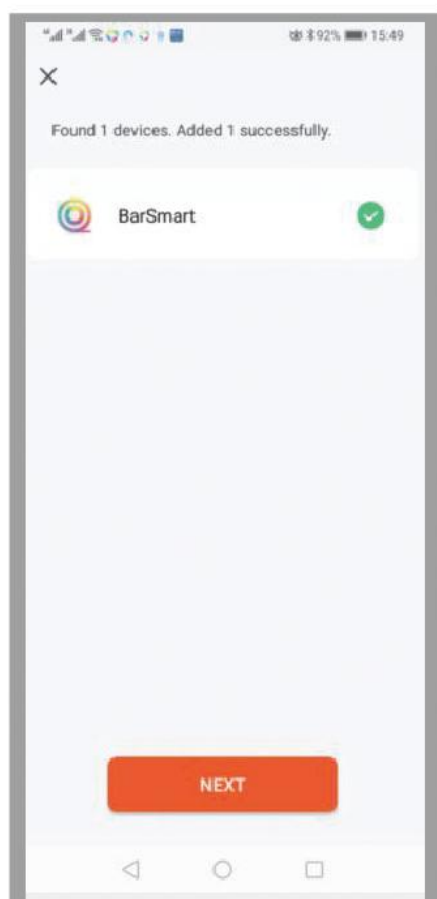

Figure 7

2.5 Link by AP Mode

Please allow your Smartphone Wi-Fi Permission and Close the Bluetooth Permission.

Step 1 App Path: Add Devices_Add Manually_Lighting_LightingSource (Wi-Fi) (Figure 1) (Figure 2)

Step 2 Enter your Wi-Fi Code (Figure 3)

Step 3 Select AP Mode on the top right corner (Figure 4)

Step 4 Press AP button on the control box or Turn on-off-on-off-on of the power switch, after the lights is blinking rapidly, switch on-off-on-off-on again (Figure 5)

Step 5 Confirm the lights is blinking slowly (Figure 6)

Step 6 Connect your mobile phone to the device hotspot SmartLife-XXXX (Figure 7, 8, 9)

Step 7 Back to WLAN (Figure 10)

Step 8 Connect the BarSmart to you App (Figure 11, 12)

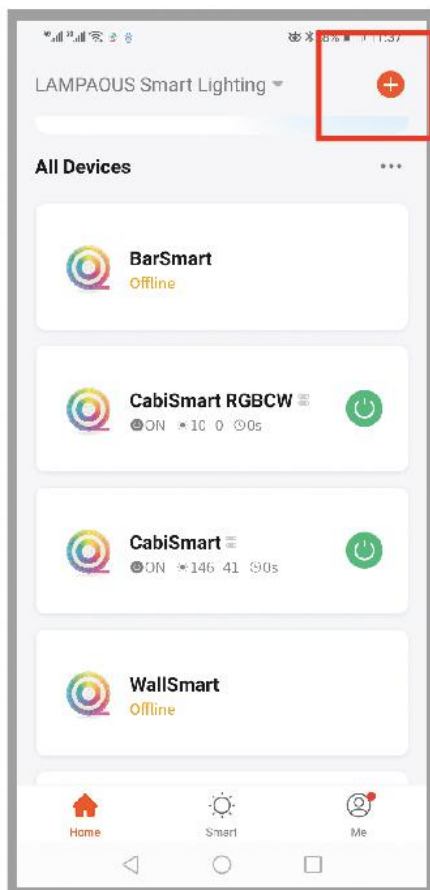

Figure 1



Figure 2



Figure 3

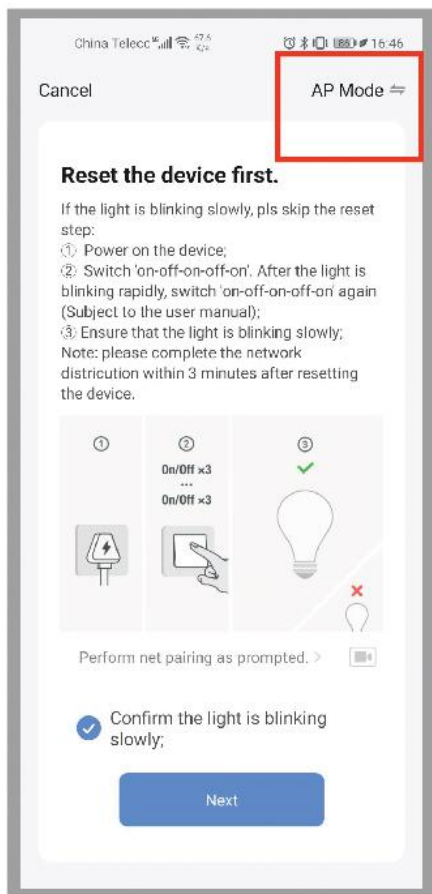

Figure 4



Figure 5

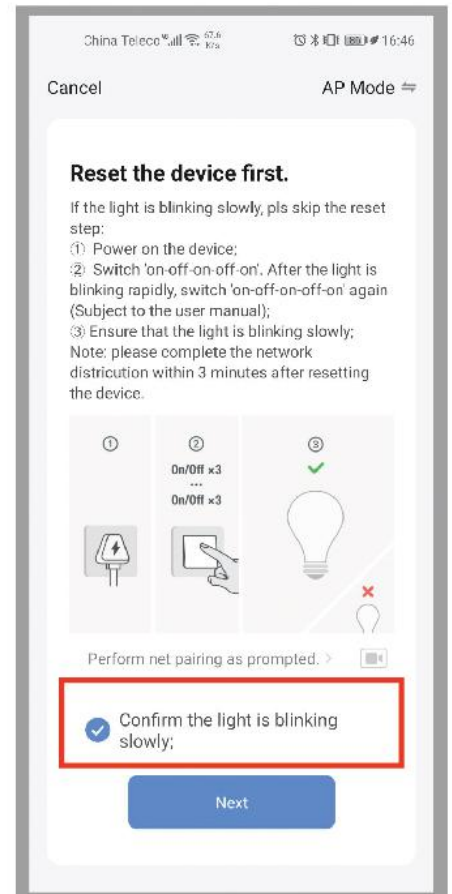

Figure 6

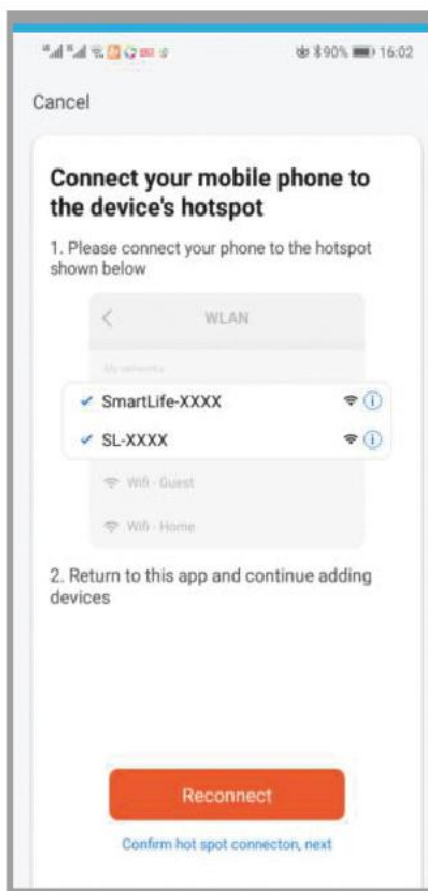

Figure 7



Figure 8

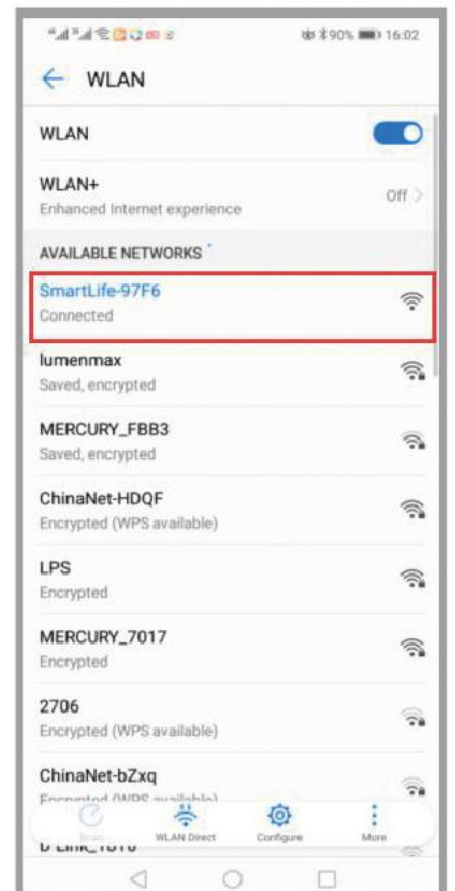

Figure 9



Figure 10

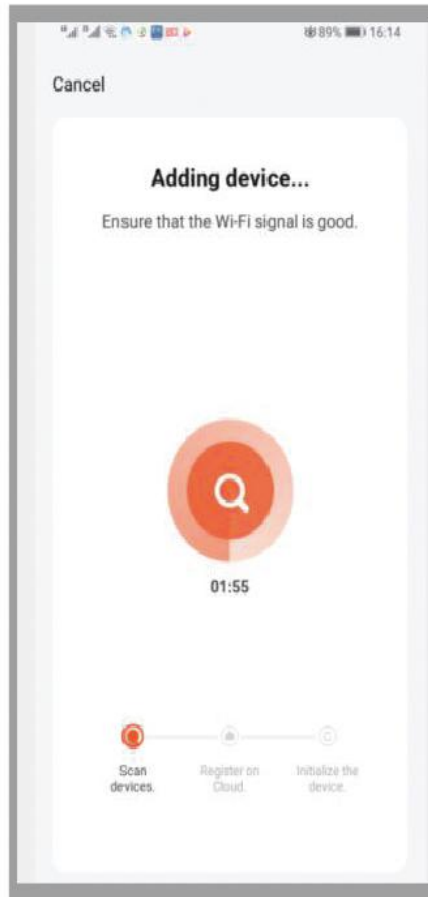



Figure 11



Figure 12

III. Operation

3.1 Rename your Device

APP Path: Home_BarSmart_Top right corner icon  _Name_rename your devices.(Figure1, 2, 3,4,5,6)

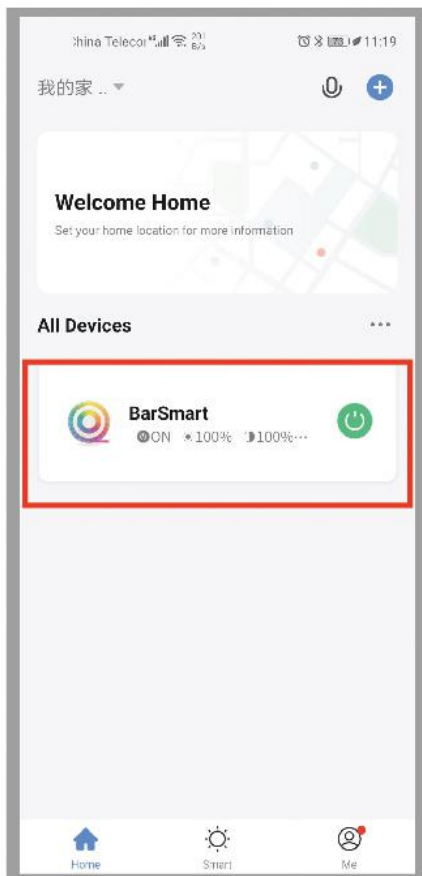

Fig 1



Fig 2

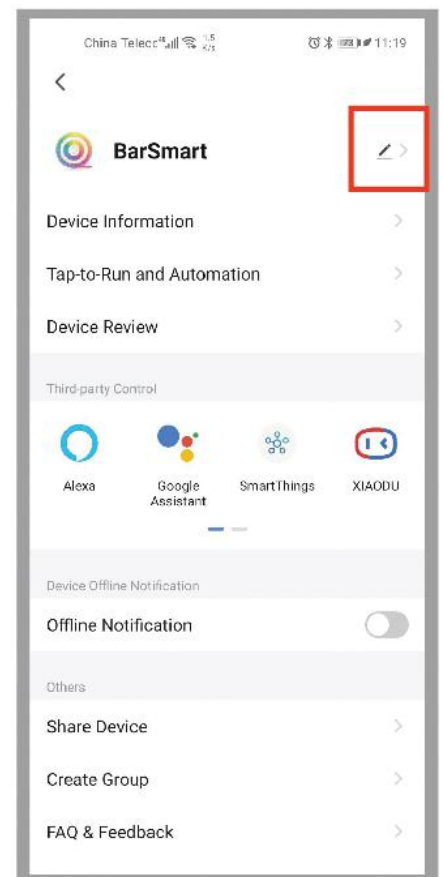

Fig 3

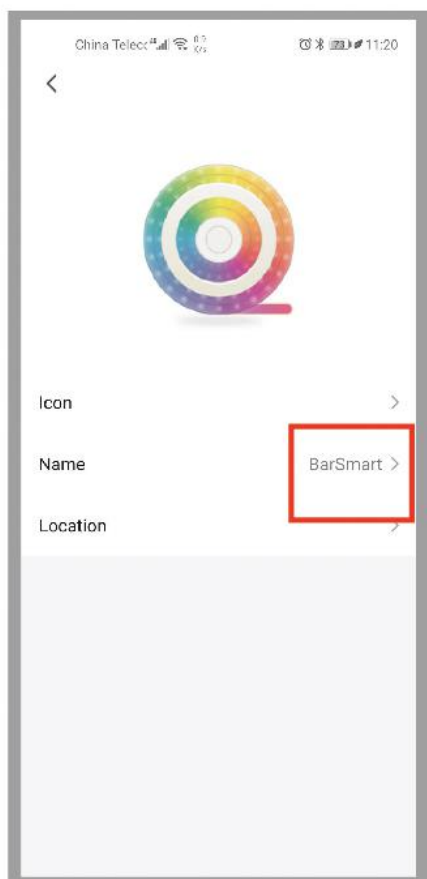

Fig 4

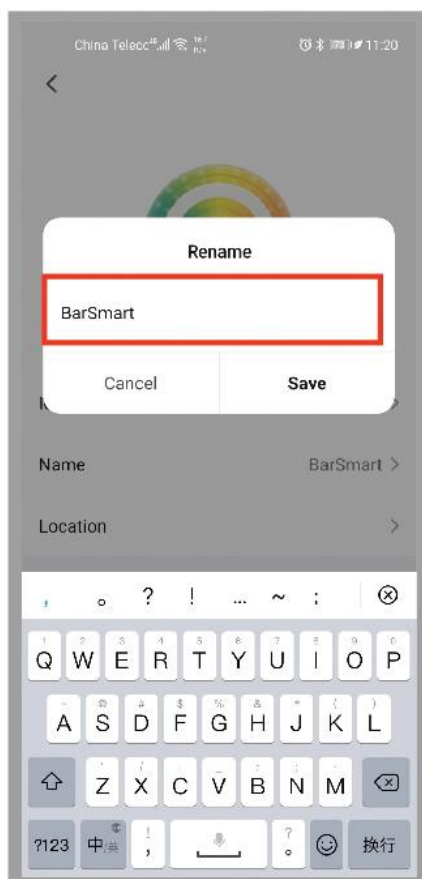

Fig 5

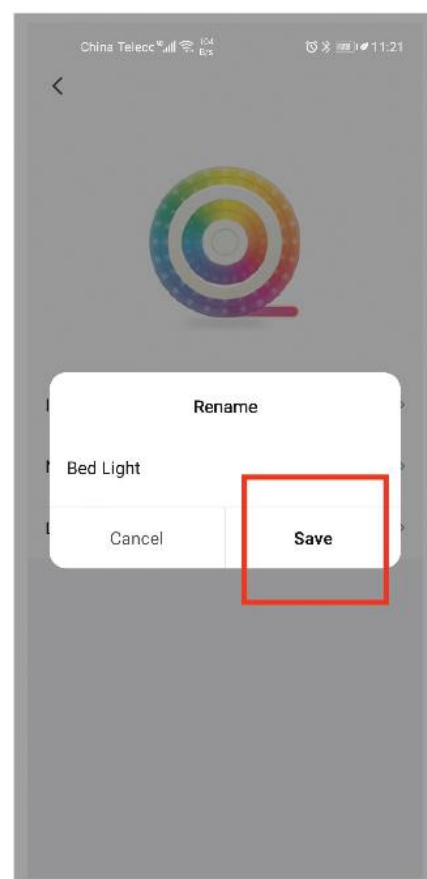

Fig 6

3.2 Group Control

Step 1 Path: Home_All devices_BarSmart_Pencil icon on the top right corner  _Creat Group.(Fig 1 \ Fig 2 \ Fig 3)

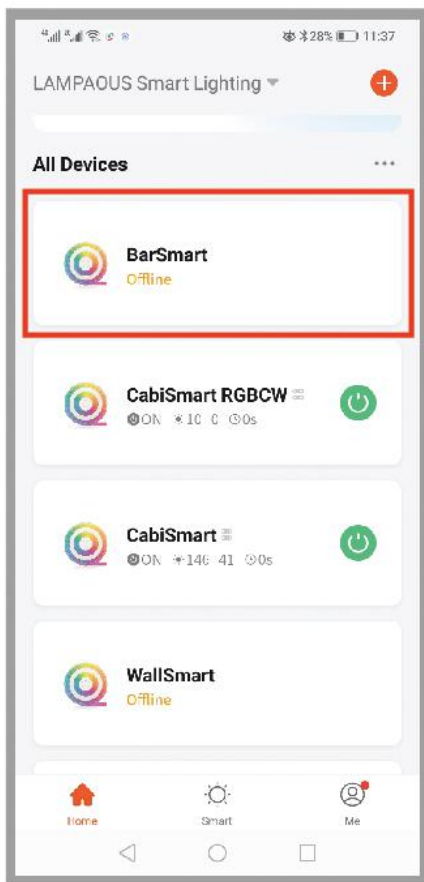

Fig 1



Fig 2

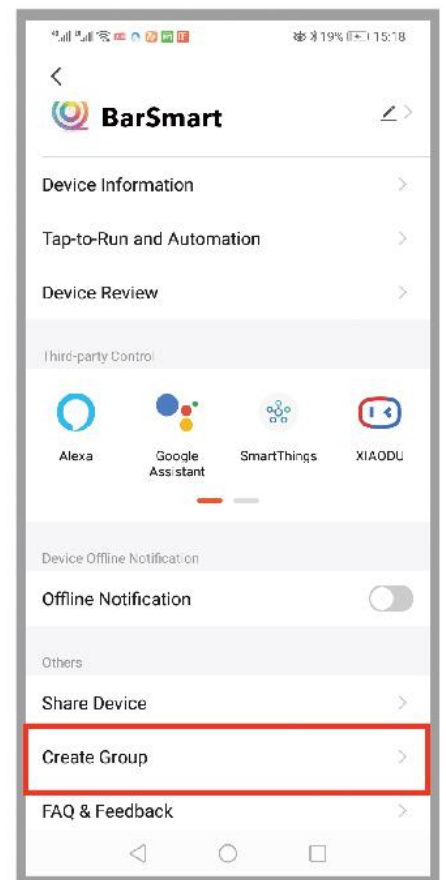

Fig 3

Step 2 Select the devices you want to added as group.(Fig 4)

Step 3 Save and enter the group name.(Fig 5)

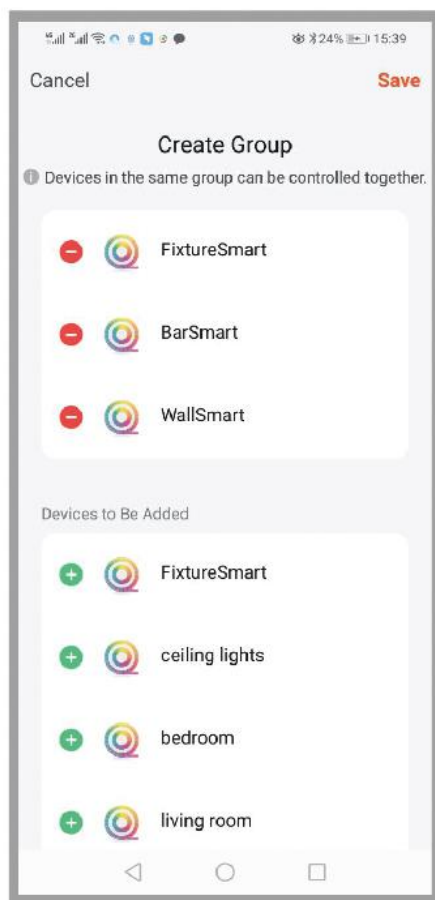

Fig 4

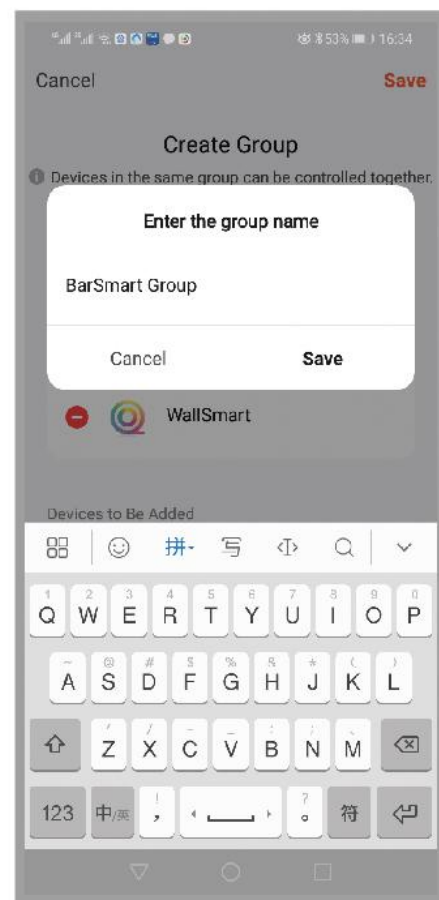



Fig 5

3.3 Third Party Control

Path: Home_All devices_BarSmart_Pencil icon on the top right corner 
_Third Party control.(Fig 1 \ Fig 2 \ Fig 3)

Alexa control Path:

Home_All devices_BarSmart_Pencil icon on the top right corner  _Alexa_
Sign in with Amazon

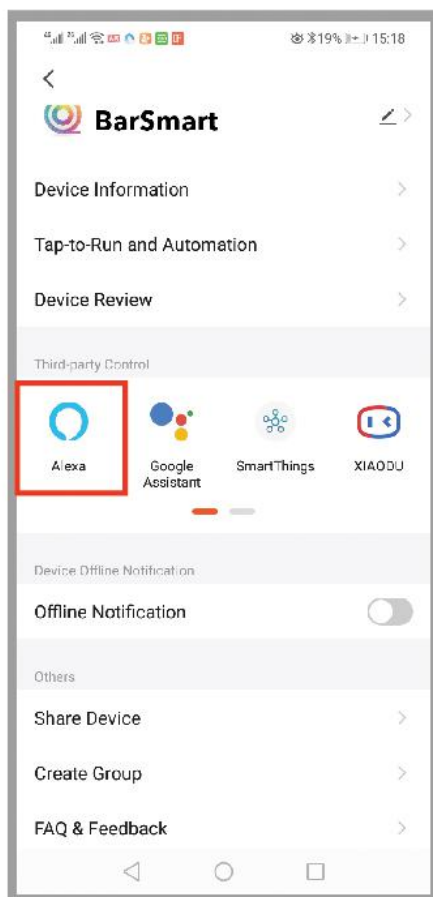

Fig 1



Fig 2



Fig 3

Google Assistant control Path: Home_Alldevices_BarSmart_Pencil icon on the top right corner  _google assistant_Link with Google Assistant.(Fig 4)

Smart things Control Path:
Home_All devices_BarSmart_Pencil icon on the top right corner  _SmartThings_Link with Account Password.(Fig 5)

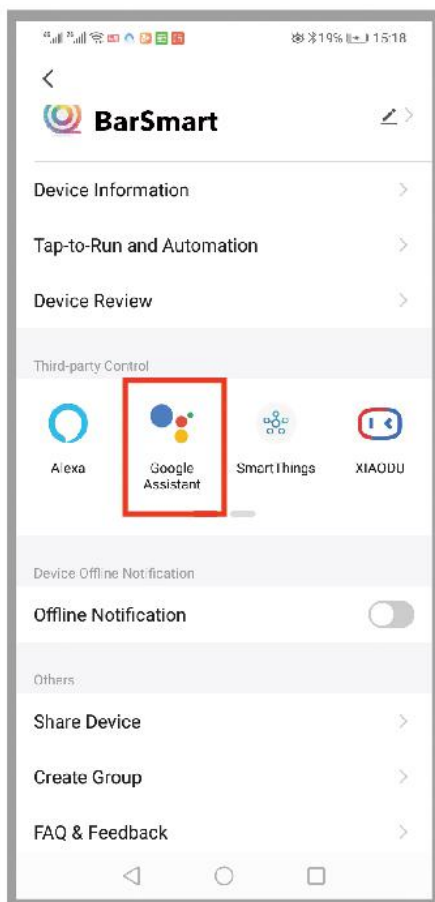

Fig 4

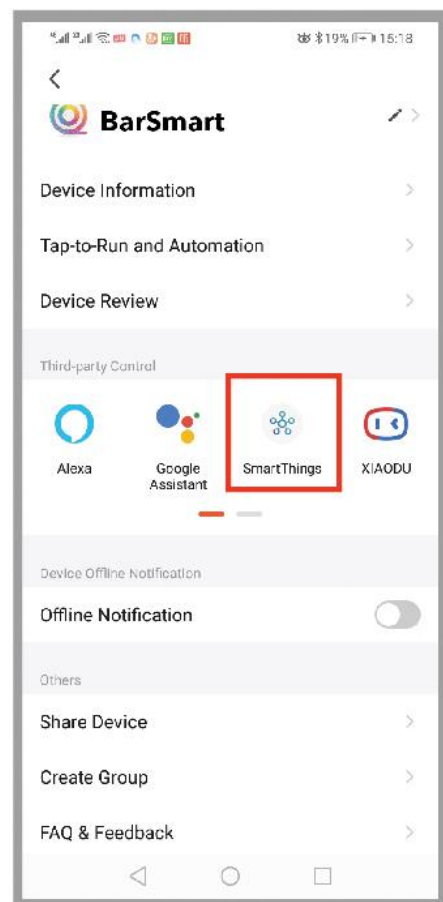

Fig 5

3.4 Voice Command

-)) Alexa(or Google), turn on [BarSmart]
Alexa(or echo), turn off [BarSmart]
Alexa(or echo), set [BarSmart] to 50 percent
-)) Alexa(or echo), increase [BarSmart] to 50 percent
Alexa(or echo), decrease [BarSmart] to 50 percent
-)) Alexa(or echo), set [BarSmart] to red
Alexa(or echo), SetBarSmart] to Warm White

3.5 R. F Remote Control

3.5.1 Please remove the small plastic cover above the battery before you use it (Figure 1)

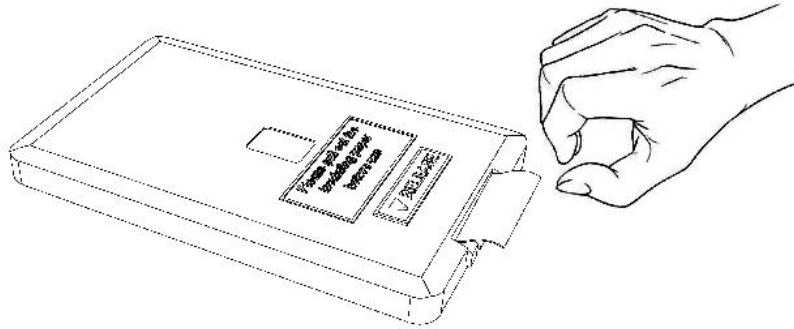

3.5.2 Please directed the remote control to the control box (Figure 2)

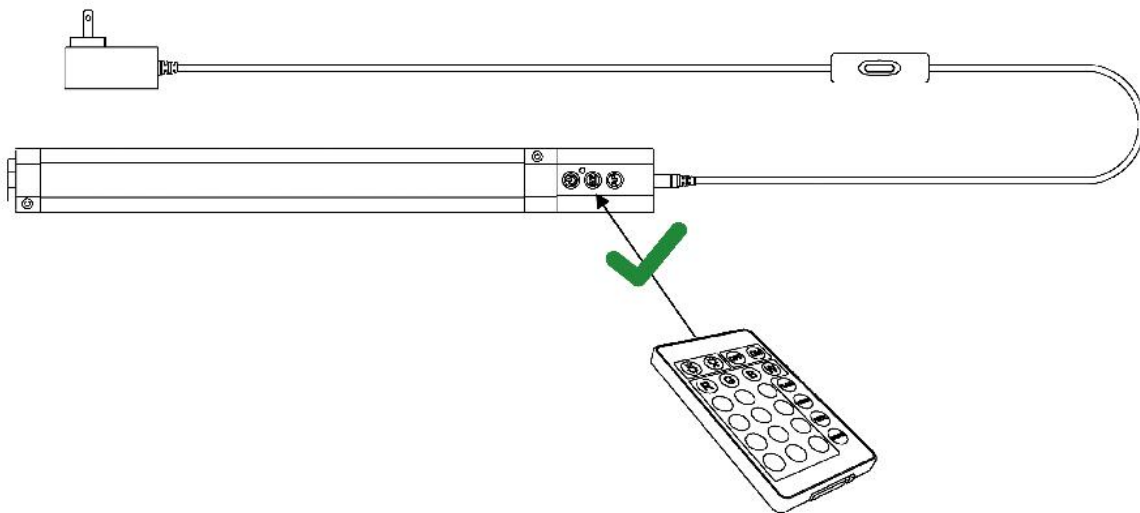

3.5.3 The control range within 2 meters or 6.5 ft (Figure 3)

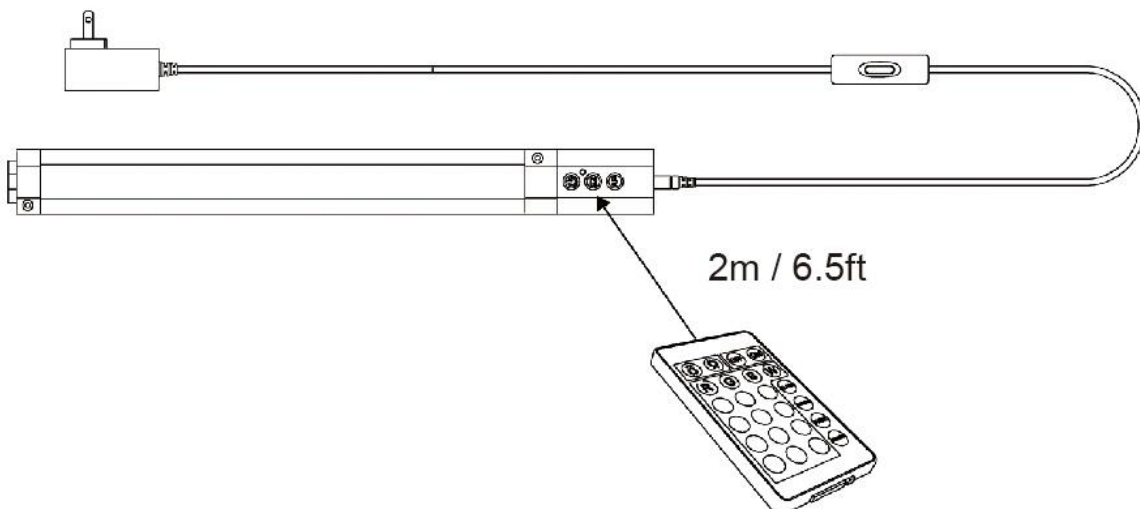

IV. FAQ

4.1 Question: The Lights can not link to SmartLife App

Answer: Please try to closer your lights , smart phone with router. Make sure the Wi-Fi is 2.4 G not 5G. Allow your smart phone Wi-Fi and Bluetooth permission.

4.2 Question: The lights system blinking suddenly after the setting.

Answer: You may switch the lights system to reset mode, please wait for 3 minutes or set the lights again with Smart Life App

4.3 Question: The lights can not activated by Alexa or Google.

Answer: If you have more than 2 BarSmart Lights system, please rename the lights systems. Alexa or Google may not detect the devices with similar names. Please make sure login your Alexa or Google account as the App instruction stated.

4.4 Question: Some lights bar do not synch with other light bars

Answer: The problem may caused by one of the defective light bars, please link the lights bar one by one to the control box directly, and find out the defective one . Contact the seller or manufacture for free replacement lights bar.

4.5 Question: I need more extension.

Answer: Please purchase it from the seller Amazon store or LAMPAOUS official website. We do not including extension cord in package.

4.6 Question: Can I add more lights bars to the 3 lights kit or 6 lights kit?

That is not recommended, as extra lights bar may reduce the brightness of other lights bars. The total brightness will not change as the transformer output is the same.

4.7 Question: Does the lights work with Apple Homekit?

Answer: No

4.8 Question : My BarSmart is offline.

Answer: First , you need to turn on the power of the BarSmart Lighting system. Second you can't link the lights by more than one App users. The BarSmart only works with the last App user. If other family members need to control the lights by their smart phone, you can share it to them.

App Path for share: Home_BarSmart_Top right corner icon  _share device

V. Service

5.1: Warranty

We provide one year warranty from the date of purchase. The return, refund and replacement policy is subject to Amazon, ebay, wish, lampaous.com or other market places. Please contact the seller or the manufacture for accessories support if you need.

5.2 Contact information

Online support (Recommend): [www.lampaous.com/contact us](http://www.lampaous.com/contact-us)

Email: info@lampaous.com

Tel No. +86 13507430400

Website

US: www.lampaous.com

UK: www.lampaous.co.uk

DE: www.lampaous.de

JP: [https:// jp.lampaous.com](https://jp.lampaous.com)

CA: [https: //ca.lampaous.com](https://ca.lampaous.com)

Address: Room 2906, Bd A1 , Hezhuang , No 758 South Furong Road.
Changsha , Hunan 410007, China



HUNAN LAMPAOUS ELECTRONIC TECHNOLOGY CO.,LTD

 Address : A1-2906 , Hezhuang, No758South Furong Road,
Changsha, Hunan 410000, China

 Web: www.lampaous.com

 Email: info@lampaous.com

Made in china

