



DAB Antenna Installation

1. Disassemble the plastic border of the right window.



2. Remove the protective paper from the black film and the transparent film on the Antenna.



3. Stick the black film on the metal frame and the transparent film on the glass. (Remember to leave space for putting the plastic border)



4. Tighten the black film and the transparent film, and fix the cable securely.



5. Put the plastic border back. (Be careful do not break the cable)



In-Car DAB/DAB+ Receiver

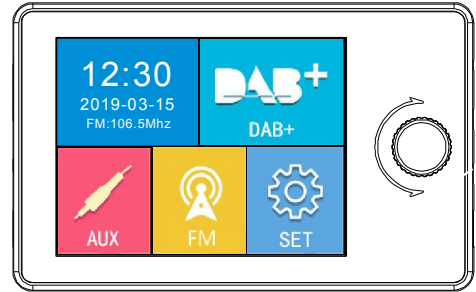

Model:X1

User manual

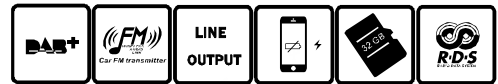

Please read this manual carefully before using the unit, and keep it for future reference.



Interface introduction

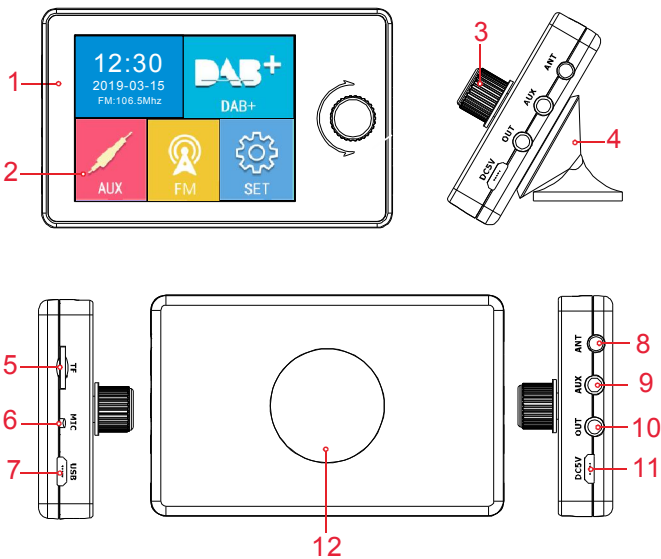

1. Audio Adapter(X1)
2. LCD Display
3. Rotary knob*
4. Bracket Magnet Suction
5. TF card(Music playing)
6. Microphone
7. USB port(Music playing)
8. DAB Antenna jack
9. Audio input jack
10. Audio output jack
11. Power input jack
12. Iron sheet

*Rotary knob button function :

- 1.Short-press : OK/Answer the phone(Bluetooth mode)
- 2.Long-press(2S) : Return/Hang up the phone(Bluetooth mode)
- 3.Double-click : Call back(Bluetooth mode)

wiring diagram

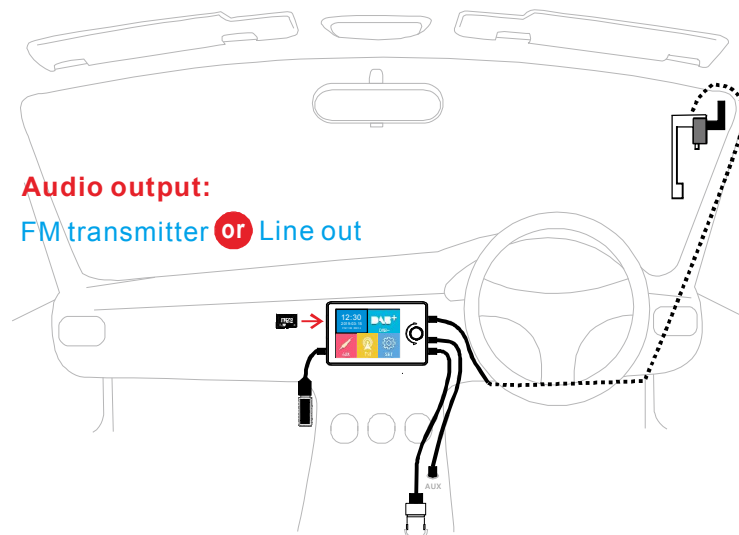

Accessories list

	X 1		X 1
	X 1		X 1
	X 1		X 1
	X 1		X 1