



Client: Shanghai Himo Electric Technology Co., Ltd.

Manufacturer: Shenzhen Sunwinon Electronics Co., Ltd.

Production plant: Shenzhen Sunwinon Electronics Co., Ltd.

Plant address: No. 6-6, Yanshan Avenue, Yanchuan

Community, Yanluo Subdistrict, Baoan District, Shenzhen



Warning: Always wear a helmet when riding!

L2 Electric Scooter

Manual

Important! Please read the Manual carefully and keep it properly for future reference.



HIMO

Contents

■ Function Introduction and Accessories.....	02
■ Operation Instructions	03
■ Braking device	03
■ Scooter Assembly	04
■ Scooter Folding	06
■ Preparations before Riding	07
■ Safety Notice	08
■ Disc Brake Commissioning	08
■ Handlebar Shake Commissioning	08
■ Tire Pumping	09
■ Warning	09
■ Safety Advice	10
■ Daily Charging	11
■ Maintenance of Electric Scooter Battery	11
■ CE Certified	12
■ Maintenance and Repair.....	12
■ Daily Cleaning of the Electric Scooter	12
■ Noise Emission	12
■ Specifications	13
■ Fault List	14

Function Introduction and Accessories

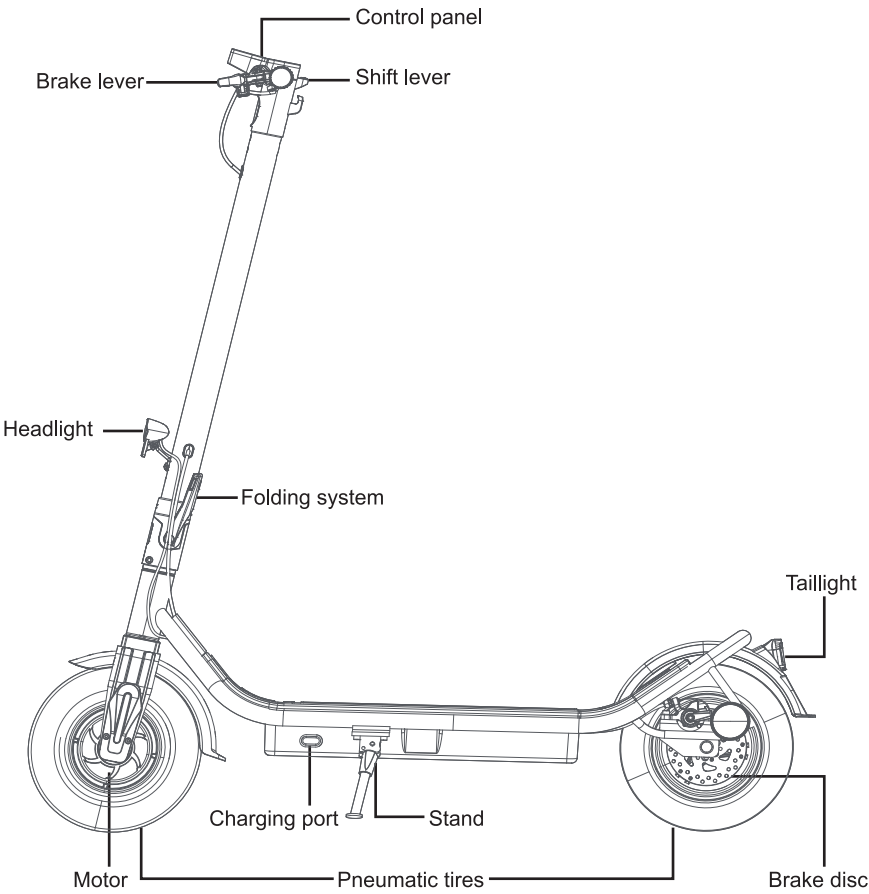

Accessories

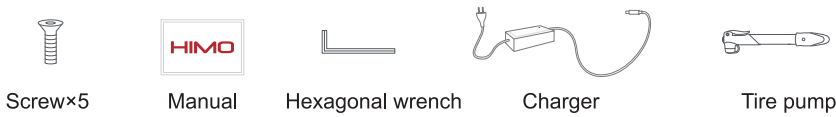

Note: The battery and the scooter are designed in one piece and can't be removed or disassembled.

Operation Instructions

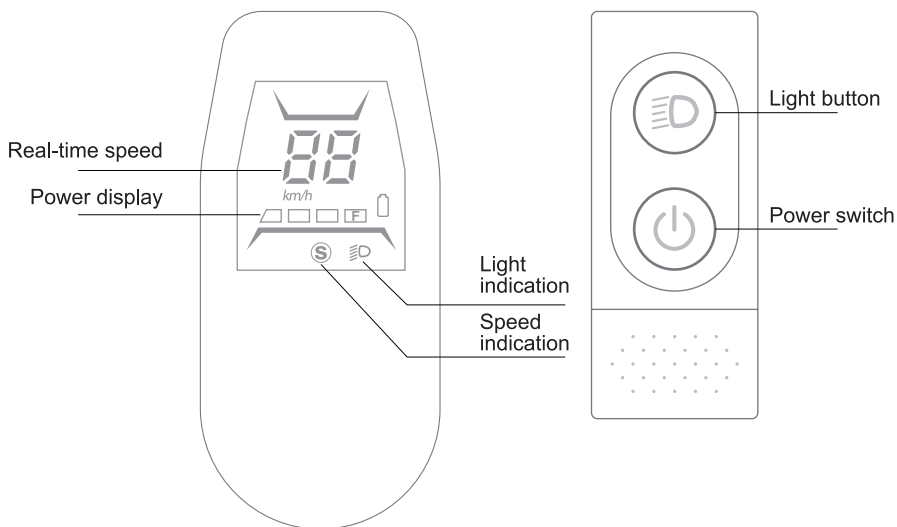

- Power switch: Press and hold for 2 seconds to turn on/off the power, and press the power switch to change the speed.
- The maximum speed is 25km/h, sliding to start or when speed ≥ 3 km/h
- Level 1: "S" on the display, light in white, maximum speed 6km/h
Level 2: "S" on the display, light in yellow, maximum speed 18km/h
Level 3: "S" on the display, light in red, maximum speed 25km/h
- Light button: Headlight, it is off when the power is turned on; press the light button to turn on/off the headlight; taillight, it is off when the power is turned on; press the light button to turn on/off the taillight; it flashes when the brake is applied.
- Auto shutdown time: The scooter doesn't move in 5 minutes.

Braking device

Two braking methods are available:

- Electronic brake: pinch the right brake lever manually
- Mechanical brake + electronic auxiliary brake system: pinch the left brake lever manually.

Please note that the braking distance will increase in wet weather.

Scooter Assembly

Install the head of the scooter vertically into the riser, fix with the four screws, and tighten the screws with the hexagonal wrench. After the scooter is assembled, press and hold the power switch to test whether it can be started normally.

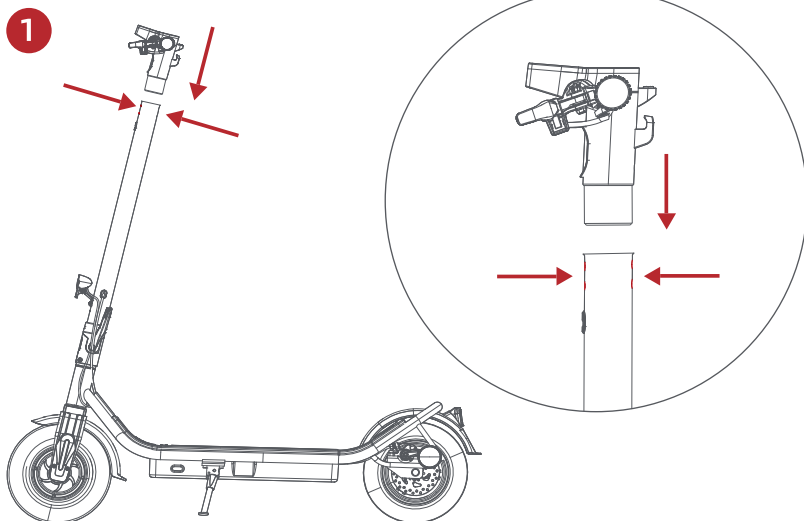

Put the riser upright and lock the handle upwards

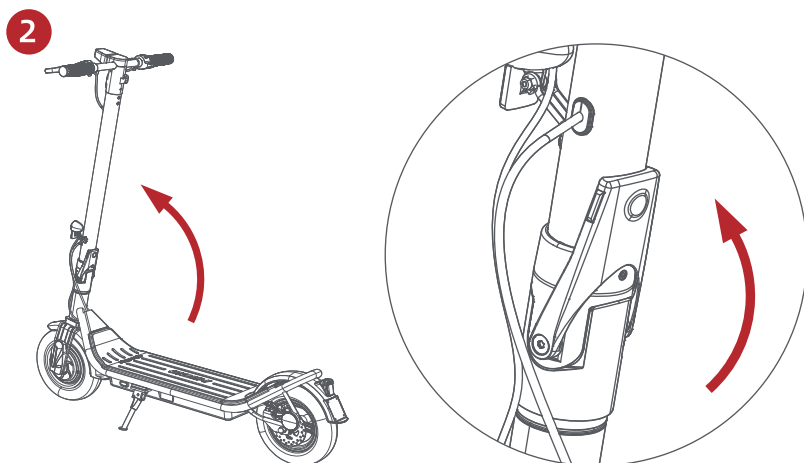

Scooter Folding

Make sure that the scooter is turned off, hold the riser with your hand, press the locking mechanism on the left side of the folding wrench and turn it clockwise to the maximum angle, slowly lower the riser, and connect the hook on the riser with the hook on the pedal to finish the folding.

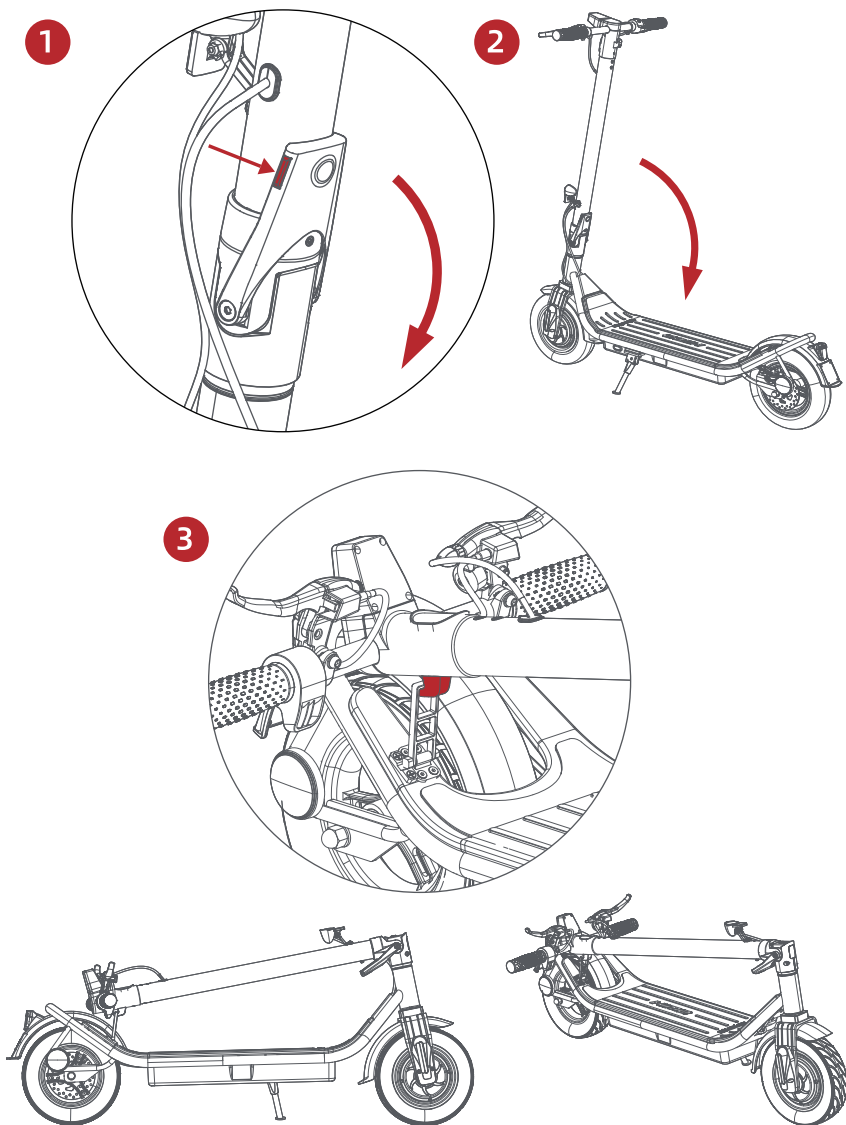

Preparations before Riding

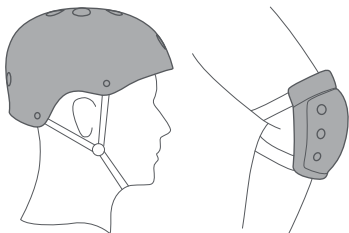

Please wear a helmet and knee pads when riding (be sure to wear shoes)

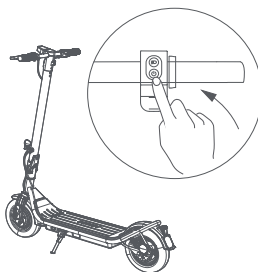

Turn on and check if the power is on



Put one foot on the pedal, and pedal the ground with the other foot to make the scooter start to slide with the help of reaction force

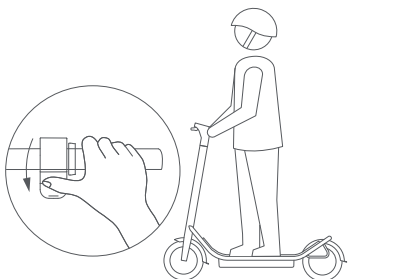

When the scooter starts to run, put the other foot on the pedal, and then press the acceleration button (when the scooter accelerates to more than 3km/h); to decelerate, release the acceleration button. The energy-saving mode is turned on when the scooter starts to slow down. To brake, pinch the brake lever on the handlebar.

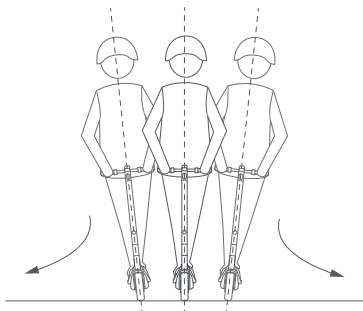

Turn the handle slowly, tilt the body slightly to the left to turn the scooter to the left, and tilt the body slightly to the right to turn the scooter to the right.

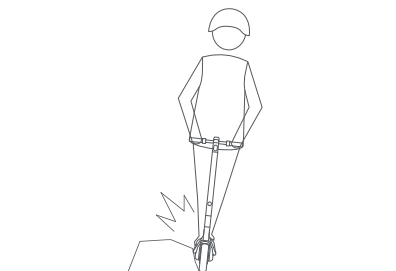

When riding, it is recommended to bypass obstacles on the road.

Safety Notice



It is not recommended to ride on rainy days



If you are riding on a rough road, it is recommended to bend your knees slightly to better adapt to the rough road and ride at a low speed (5-10km/h)

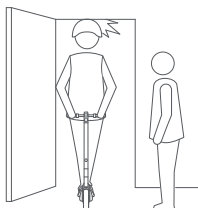

Avoid your head hitting high obstacles such as door frame and elevator



Do not accelerate when going downhill

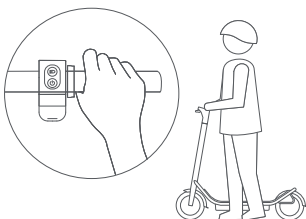

Do not press the acceleration button when you are walking and pushing the scooter



When riding, it is recommended to bypass obstacles on the road. When the riding is dangerous due to height of these obstacles or slipping, it is recommended to get off.



Do not hang backpacks or other heavy objects on the front hook



Do not put one foot on the pedal and the other foot on the ground during riding

Disc Brake Commissioning

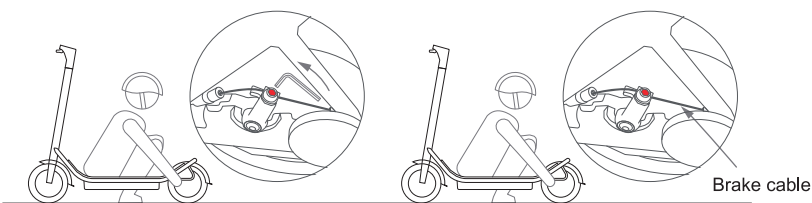

If the brake is too tight, use a 5mm hexagon wrench to loosen the screw of the pressure plate on the disc brake seat counterclockwise, return the brake cable to shorten the length of the exposed tail slightly, and then tighten the screw of the pressure plate; if the brake cable is too loose, loosen the screw of the pressure plate, drag the brake cable to slightly extend the length of the exposed tail, and then tighten the screw of the pressure plate. If necessary, re-tighten by the average torque of 20N/M.

Handlebar Shake Commissioning

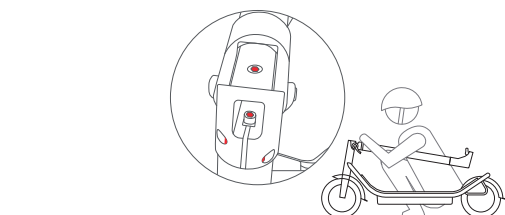

If the vertical tube of your electric scooter shakes during riding, please tighten and adjust the screws at the folding mechanism with a hexagonal wrench by 20N/M.

Tire Pumping

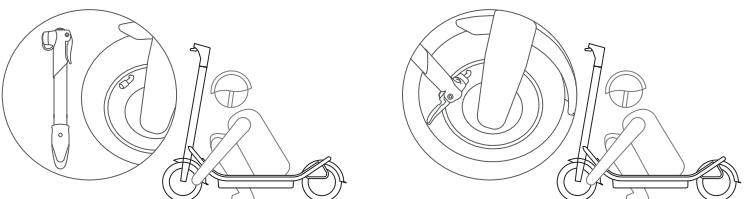

In order to prevent danger caused by high tire pressure during transportation, the air pressure of the scooter will be lowered when it is delivered; after opening the package and taking out the scooter, please use the provided tire pump to inflate the tire (tire pressure indicated on the label).

Warning

- Do not take a sudden turn in crowded areas
- It is forbidden to use the scooter outside the environment permitted by laws and regulations
- It is forbidden to use the scooter near water sources
- Overloading or riding with a child is prohibited (riding by one person only)
- Do not step on the mudguard
- The brake may become hot during use, do not touch it after use
- It is forbidden to ride the scooter to perform acrobatics
- It is forbidden to ride the scooter up and down steps or across obstacle
- If damaged, please stop using the scooter immediately
- Keep children away from plastic coverings to avoid suffocation
- Please ride on a flat, clean, dry and level road and keep a safe distance from pedestrians and vehicles.
- Please eliminate sharp edges caused by use in time to avoid injury.



Safety Advice

Take time to learn basic operations to avoid any accidents that may happen in the first few months.

Electric scooter is an entertainment device rather than a means of transportation. If you ride in public, the scooter will bring certain safety risks to you. For the safety of your own and others, be sure to strictly follow the operating instructions of the manual.

If you use the scooter in public areas, you must follow all safety guidelines. There is a possibility of collision if you violate traffic rules of pedestrians or vehicles. There is also a risk of injury if the operation is improper. Just like other types of vehicles, the faster the scooter, the greater the braking distance is. On some flat roads, emergency braking may cause the scooter to slip, lose its balance or even fall. Therefore, please maintain an appropriate speed when using the scooter, and keep a safe distance from pedestrians or other vehicles. When riding on unfamiliar road, stay alert and keep a reasonable speed. Choose a protected channel when pushing.

In any case, always abide by road laws, sidewalks and laws for vulnerable groups, predict your riding route and speed, and do not divert your attention when riding. When approach pedestrians or cyclists without being noticed or heard, remind others in time. Avoid riding in areas with heavy or crowded traffic.

When use the scooter, please strictly abide by the traffic rules of your country and also strictly abide by the regulations listed in the safety notice and advice. Violation of the above regulations may cause economic loss, personal injury, traffic accidents, legal disputes, conflicts, etc. The company does not assume any direct or joint liability.

To avoid personal injury, do not lend the scooter to any person who can't ride. Please conduct a training session before you transfer the scooter to a friend, and teach him or her to wear proper safety equipment.

Please check the scooter carefully before each use. If any part is broken, the battery life is significantly reduced, the tires are flat or have signs of excessive wear, abnormal noises or other abnormal symptoms, please stop using it immediately.

Regularly check the tightening of bolt components, especially the wheel axle, folding system, steering system and brake shaft.

Note: Any load on the handlebar will affect the stability of the scooter. Do not use accessories or any other items not approved by the manufacturer.

Daily Charging

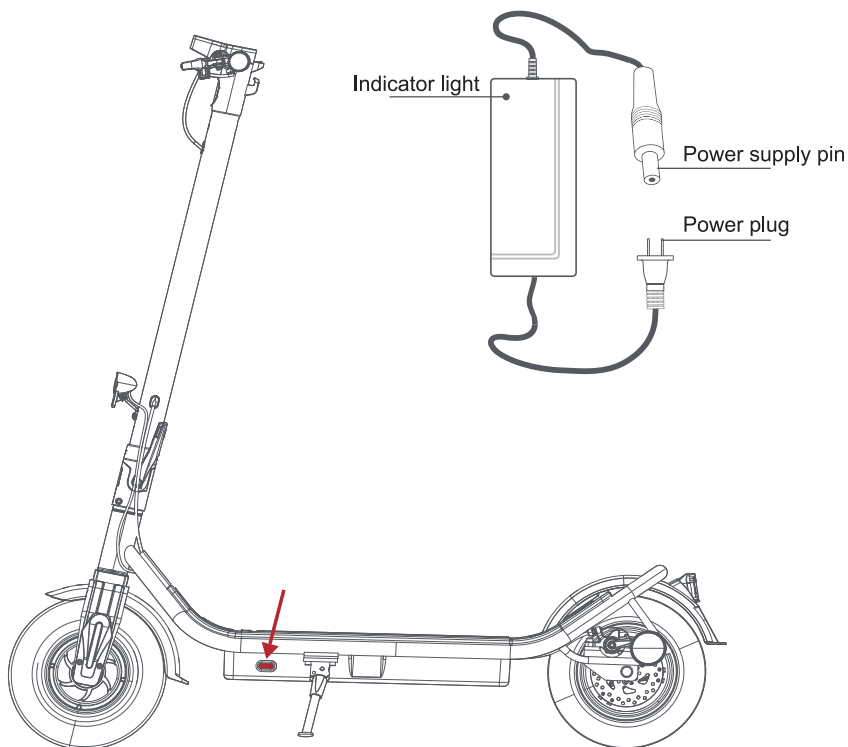

- First insert the power supply pin of the charger into the charging port of the battery, and then connect the power plug to the power source.
- In the charging state, the indicator light of the charger is red; when fully charged, it is green.
- After charging is completed, first unplug the power plug and then pull out the power supply pin of the charger.
- When charging, turn off the power of the meter.

Maintenance of Electric Scooter Battery

- Be sure to carefully check whether the rated input voltage of the charger is consistent with the voltage of local power supply before use.
- The scooter should be charged and stored in a spacious environment and away from the following environments: high temperature, high humidity, combustible materials and fire sources.
- The charger will heat up in the charging process. Do not cover the charger with any object. It is normal that the surface temperature of the charger does not exceed 60°C.
- The charging time shouldn't exceed 12 hours. Overcharging will affect battery life and pose safety hazards.
- The best working and charging temperature for lithium batteries is -20°C~40°C (25°C recommended). Charging is prohibited when the temperature is below -20°C and above 60°C.
- Keep the scooter away from fire, heat, corrosive substances, and direct sunlight.
- Do not drop, impact, or crush the battery.
- Water drenching or immersion is prohibited in the battery charging/discharging port.
- Charge according to the specified time, and charging too long will shorten the battery life.
- Please use the original charger to avoid damage caused by inferior products.
- After the battery is fully charged, cut off the power as soon as possible, and unplug the power cord and the charger cable.
- Before the battery power is completely exhausted, please charge the scooter in time to avoid damage to the battery and affecting normal use due to over-discharge of the battery.
- If the scooter is not used for a long time, it is recommended to recharge it every 2 months; the charging time is 2-3 hours.
- The scooter should be stored in a cool and dry environment and avoid connecting the positive and negative poles with conductive object directly.
- It is forbidden to disassemble or modify the battery.
- Do not throw away the used batteries after replacement. The company, distributors, and government designated outlets are responsible for recycling according to the relevant local regulations.

Note: A fully charged scooter has a standby time of 120-180 days. If the battery isn't charged for a long time, it will cause serious damage, and it is likely that the battery can't be charged. This damage is not included in the free warranty service. Only qualified personnel are allowed to disassemble the battery, or else it may cause electric shock due to short circuit.

CE Certified

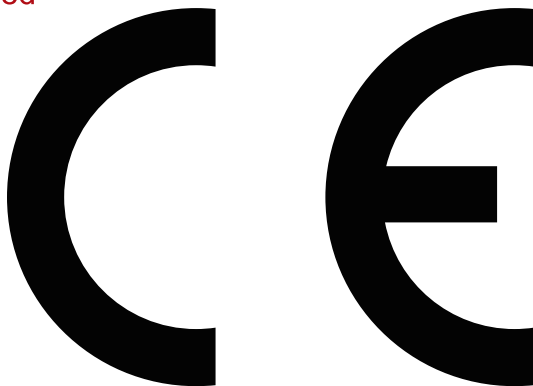

Maintenance and Repair

- Self-tightening nuts and other self-tightening fasteners may lose efficiency. Please check before each use, and re-tighten with an average torque of 20N/M if necessary.
- Whether the tire pattern is worn and cracked, whether the front and rear tire pressure is proper, and whether the drive system is smooth.
- Whether the brake system is working properly.
- Regularly check the status of parts of the scooter (frame, front fork, stem, brake, etc.).
- It is forbidden to make any modifications or alterations to the scooter.
- If you can't solve the operation (for example: replacement of wearing parts, electronic components, etc.), please go to the repair shop.

Warning! Like all mechanical parts, this scooter is subject to great stress and wear. The wear or fatigue of materials and components may be different. If the expected service life is exceeded, the component may suddenly break, posing a risk of injury to the user. Once cracks, scratches and discoloration appear in the high-stress area, it indicates that the component has exceeded its service life and should be replaced immediately.

Daily Cleaning of the Electric Scooter

If there are stains on the surface of the electric scooter, wipe with a soft cloth dipped in a small amount of clean water; if it is difficult to clean the stains, apply toothpaste and scrub repeatedly with a toothbrush, and then clean with a damp cloth. If the plastic parts are scratched, polish with sandpaper or other abrasive materials.

Tips: Do not clean with alcohol, gasoline, kerosene or other corrosive and volatile chemical solvents, or else it will seriously damage the appearance and internal structure of the scooter. It is forbidden to spray and wash with a pressure water gun, and make sure that the electric scooter is turned off, and the charging cable has been unplugged and the rubber cover of the charging port has been tightened, or else it may cause electric shock or serious failure due to water ingress.

Noise Emission

Note: The A-weighted sound pressure level of this scooter is $\leq 70\text{dB (A)}$

Specifications

Size	Scooter size	1180mm × 495mm × 1200mm
	Folded size	1180mm × 495mm × 490mm
Product weight	Weight	18.8kg
Requirements	Load bearing	≤100kg
	Suitable age	16-50
	Suitable height	120-200cm
Main parameters	Maximum speed	25km/h
	Maximum riding distance	35km
	Maximum slope	20%
	Riding road	Flat road
	Protection level	IPX4
Battery	Rated voltage	36V
	Rated capacity	10.4Ah
Motor	Motor type	Brushless DC motor
	Rated power	350W
	Maximum power	420W
Charging	Output voltage	42V DC
	Output current	2A
	Charging time	≈6h

(1) The riding distance is measured at a constant speed of 15km/h in the energy-saving mode with a load of 75kg, at a temperature of about 25°C under full power. The actual riding distance will vary depending on the load, temperature, wind speed, road surface and operating habits.

Fault List

No.	Code	Description
1	E1	Shift lever
2	E2	Brake
3	E3	Motor Hall
4	E4	Serial port
5	E5	Over temperature
6	E6	Hardware
7	E7	Motor phase wire
8	E8	Battery