

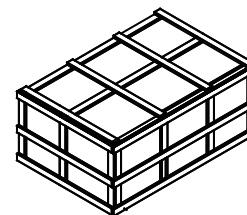

Dear Customer,  
Thank you for choosing our product. For your safe concern, please take a few minutes to read this manual before installation and use.

**WARNING**

1. Children and adolescent are only allowed to use the bathtub in accompany with an adult.
2. People with hypertension, diabetes or cardiovascular diseases are not allowed to use the bathtub.
3. Don't hit or rub the bathtub with a hard object to avoid damage and scratches.
4. To avoid stumbling, please pay attention to the drop height when go in or out of the appliance.
5. Watch out the appliance with suds to avoid slip.
6. Don't use acidic and strong alkaline detergent, acetone, ammonia and so on. Clean with alkalescent detergent and soft cloth.
7. If the sealant falls off from the glass, please glue it immediately to avoid the leakage.
8. Specifications can be varied without notice.



Please use tools to open the packing;  
Make sure all accessories are in the packing



Pillows: 2pcs

**Accessory Box :**

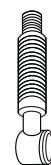

Drain 1pc



Handheld shower hose 1pc



Handheld shower 1pc

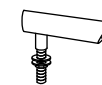

Water intake 1pc



Drain cover 1pc

**Installation Tools:(no included)**

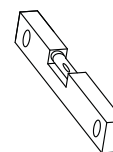

A

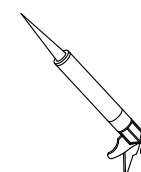

B

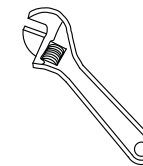

C

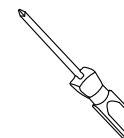

D

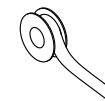

E

A: Gradient B: Sealant C: Adjustable spanner D: Screwdriver E: PTFE tape



1. Hose Connecting Way

The fittings of bathtub were already connected before shipment except faucet. Users need to install the faucet according to the back procedures, then connect the cold/hot water hose to the corresponding water supply tube, which should be in the shelter of the bathtub's back.

- A: Water intake
- B: Handheld Shower
- C: Switch of Handheld Shower and Water intake
- D: Hot Water Inlet
- E: Cold Water Inlet

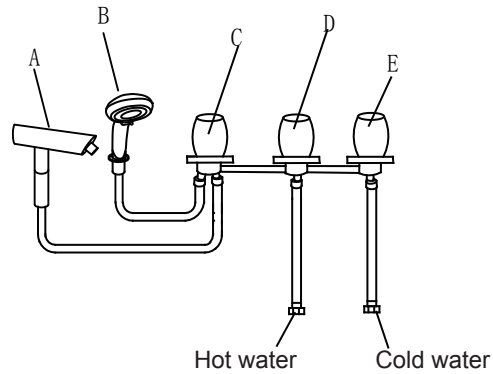

Water Inlet Faucet Connecting

2. Water Supply Chart

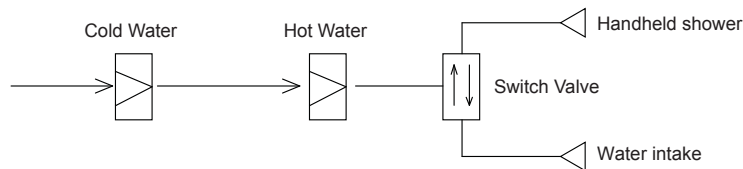

Installation of Bathtub

1. As the picture shows below, turn over the bathtub, wrap the drainer hole with thread PTFE tape, and then screw the drainer.

As picture show:

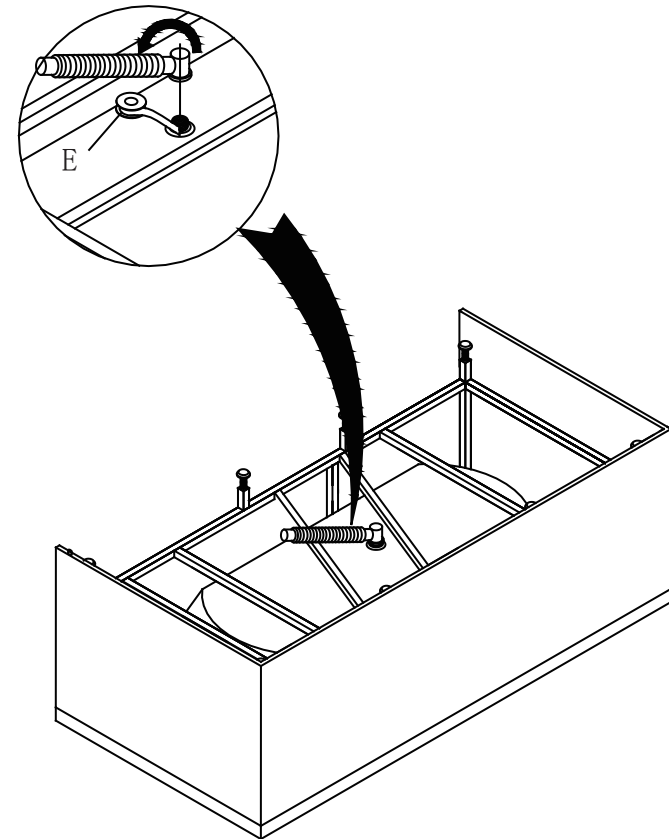

2. As the picture show: install the waterfall faucet and handheld shower, then connect to the water hose.

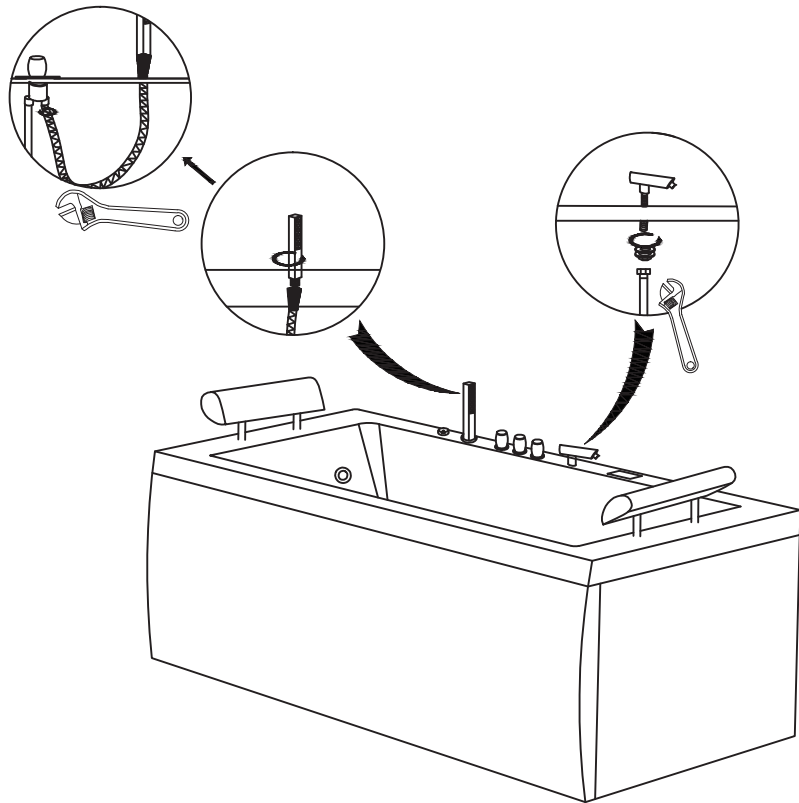

3. Adjust the tub feet to make the horizontal. Move the bathtub to the wall corner; put the drainer into sewer and seal the drainer with sealant. Seal the gap between the bathtub and the wall with sealant to avoid water leakage.

