

# Quick Operation Guide

Flying Saucer-CN430S  
In-The-Ear hearing aid

Please read the rehabilitation plan first

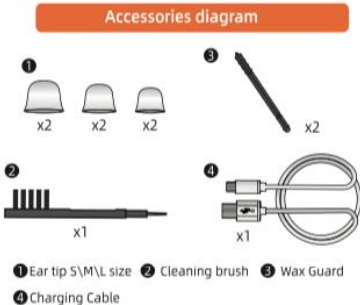
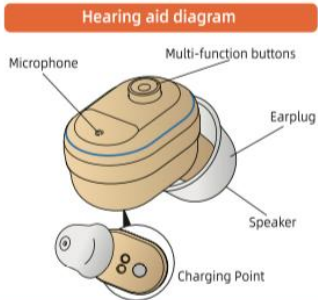

Technical Parameter			
Max.OSPL90	HF Avg.OSPL90	Max gain	HFA Gain
≤107±3dB	104±3dB	31±4dB	28±4dB
Noise Level	Frequency Range	Battery Current	Total Distort
≤32dB	500-4000Hz	≤2mA	≤3%

### Power On/Off

- Power ON: Take the device out of the charging box.
- Power OFF: Put the device into the charging box.

Please distinguish the right ear and the left ear according to the color. Blue for the left and red for the right.

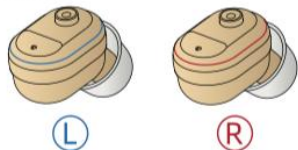

Note: For the first use, please remove the power protection sticker from the device.

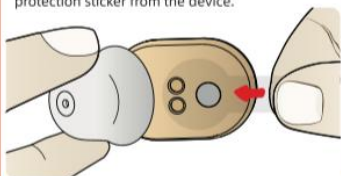

### How to replace ear tips

The M size earplugs are installed by default. If the earplugs do not fit your ears, or it is difficult for you to hear sounds, or you hear whistle, please replace the earplugs that are suitable for your ear canal.

- Turn the umbrella part of the ear tip over.
- Hold the base and pull it off. **Do not pull the umbrella because it is thin. It may be damaged.**
- Hold the body with your dominant hand.
- Insert the ear tip straight and insert it gently as far as it will go.
- Pull the ear tip lightly to make sure it is tight enough.

### How to use

- Pinch the hearing aid with your thumb and index finger, and place the earplug side in the ear canal. Rotate the hearing aid to snap it into the ear and wear it comfortably.
- Click the hearing aid button once: increase the volume by one level. Two beeps are heard, which is the highest volume level.
- Long press the hearing aid button for 3 seconds: One beep means simulation scene 1 (general mode). Two beeps mean simulation scene 2 (noise reduction). Three beeps mean simulation scene 3 (outdoors).

The hearing aid has a memory function, and there is no need to repeatedly adjust the volume and simulate the scene when it is worn next time.

### How to charge

The charging box has a power storage function, and the hearing aid can be charged after being inserted. When the charging box is out of power, a charger needs to be connected to charge the charging box and the hearing aid.

Charging box battery indicator		
100%	75%	50%
When the power of the charging box is less than 25%, the indicator light flashes.		

Hearing aid charging indicator		
L	Orange light	R
L	Orange off	R
Charging		
Fully Charging		
When the hearing aid is fully charged, it will automatically turn off the light		

	Hearing Aid	Charging Box
Battery Specifications	25mAh Lithium Battery	300mAh Lithium Battery
Charging Time	≤2H	≤2H
Rated Working Current	≤2mA	On Standby Charging One Unit Charging Two units
Rated Working Time	≥25H	10 Times for Single Unit 5 Times for Two Units

### Charging problem handling

During the use of hearing aids, it may happen that the hearing aids cannot be charged. This situation is likely to be caused by poor contact of the charging contacts, which can be solved by the following methods:

- Put the hearing aid back into the charging case and twist the hearing aid left and right.
- Clean the hearing aid charging contacts and the charging contacts of the charging box.

### How to replace the earwax guard

Please replace the ear guard once every three months. Do not reuse your ear guard once used. There is a risk of falling off.

- Insert the "removal hook side" of the ear guard holder into the ear guard of the sound amplifier.
- Pull out the earmuff bracket, the old earplugs will be pulled out along with it.
- Rotate the ear cap holder, and then push the new ear cup into the amplifier.
- Pull out the ear guard holder straight out. A new ear guard is installed on the sound amplifier.

### Low battery reminder

The hearing aid has a low battery warning signal, a electronic sound (beep, beep) sounds approximately every one minute, until the sound is abnormal, and finally no sound. If you hear a beep, please charge the hearing aid in time.

### Maintenance

Keep the sound amplifier clean at all times. After use, remove dust with the included cleaning brush, wipe off oil and moisture with tissue paper, etc., and keep the product dry.

- clean the sound entrance with a cleaning brush.
- clean the outlet of the sound with a cleaning brush.

### Troubleshooting

Problem	Possible Solution
Sound is distorted	① Decrease volume. ② Charge the product. ③ Clean the dome.
Sound is weak	① Charge the product. ② Increase volume. ③ Check the dome whether blocked or not.
The product emits whistling sounds	① Reinsert the Earplugs until it fits securely. ② Decrease volume. ③ Clean the Earplugs.
The product does not work	① Change to different size of Earplugs. ② Check whether the microphone is damaged or not. ③ Charge the product.

Consult your Hearing Care Professional or directly contact to us if you encounter further.

### Notes and Tips

- This product is not waterproof, therefore the user must take care to prevent water from entering the product.
- Do not use hairspray or hair dryer when wearing hearing aids.
- When not in use for a long time, please put the product in the charging box and charge it once every 1-2 months to avoid damage to the battery.